

GENERAL NOTES:

1. CONFORM TO NATIONAL PLUMBING CODE AND ALL LOCAL CODES AND AUTHORITY HAVING JURISDICTION FOR DESIGN, SUPPLY AND INSTALLATION OF PLUMBING SYSTEM.
2. EQUIPMENT LOCATIONS, DUCT, AND PIPE ROUTING INDICATED ON THE DRAWINGS IS APPROXIMATE ONLY. CONFIRM IN THE FIELD.
3. REROUTE PIPING AS REQUIRED TO ELIMINATE FIELD INTERFERENCES WITH BUILDING STRUCTURES, ELECTRICAL, ETC. CONFIRM CHANGES WITH CONTRACT ADMINISTRATOR. COORDINATE WORK WITH ALL SUBTRADES. WHERE DIMENSIONS ARE INDICATED FOR PIPING, DUCTWORK, DUCT SIZES, EQUIPMENT SIZES, ETC. THESE ARE FOR BIDDING PURPOSES ONLY. THE CONTRACTOR IS RESPONSIBLE TO VERIFY ALL DIMENSIONS IN THE FIELD PRIOR TO ORDERING EQUIPMENT AND COMMENCING INSTALLATION WITHOUT EXTRA CHARGES TO THE PROJECT. THE CONTRACTOR IS RESPONSIBLE TO ENSURE ALL EQUIPMENT, AND PIPING FITS IN THE SPACE AVAILABLE AND TO MAINTAIN THE GENERAL DESIGN INTENT FOR THE SYSTEMS.
4. PROVIDE NEW DRAINS AS SHOWN. SLOPE DRAINAGE PIPING AT 1/4" PER FOOT. RUN DRAIN LINES IN CEILING SPACE AND DISCHARGE OUTDOORS ON GRADE. INSTALL BUG SCREEN AT TERMINATION.
5. INSULATE RAIN WATER LEADER PIPING IN CEILING SPACE AND INSTALL PVC JACKET WHERE EXPOSED INDOORS.
6. PROVIDE ALL CUTTING AND PATCHING REQUIRED FOR PIPING. FINISH ALL PENETRATIONS AND MAKE GOOD.
7. ROOF DRAINS TO BE CONTROL FLOW TYPE.

KEYNOTES:

- 1 INSTALL AND SUPPLY NEW INSULATED AND PVC JACKETED RAIN WATER PIPING IN CEILING SPACE. RUN IN CEILING SPACE WHERE POSSIBLE AND SLOPE ACCORDING TO CODE. COORDINATE PIPE ROUTING WITH OTHER TRADES. (REFER TO VENTILATION AND MECHANICAL DRAWINGS)
- 2 RUN VERTICAL SECTION OF PIPE AGAINST WALL. PAINT TO MATCH WALL COLOUR.

LEGEND:

	NEW EQUIPMENT/PIPING
	RAIN WATER LEADER
	ROOF DRAIN
	SPLASH PAD (PROVIDED BY ARCHITECTURAL)
	PIPE REDUCER

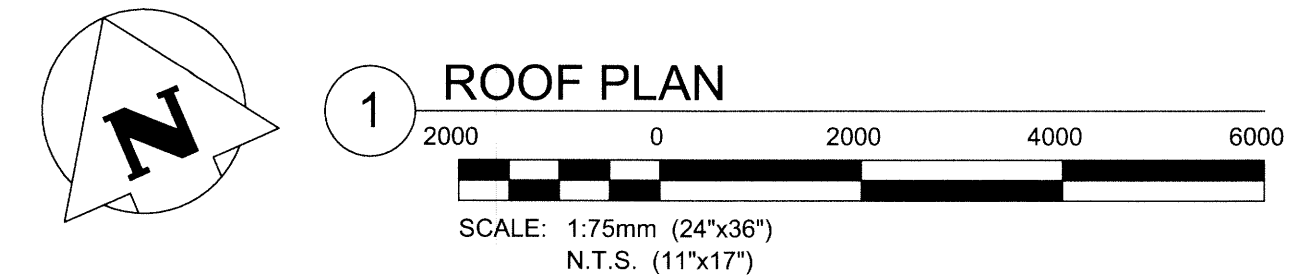

678 MAIN STREET WINNIPEG, MB R3B 1E4
 204.488.3857 tel. 204.488.0216 fax.
 www.bridemancollaborative.ca
bridemancollaborative
 ARCHITECTURE

KGS GROUP
CONSULTING ENGINEERS

Winnipeg
THE CITY OF WINNIPEG PLANNING, PROPERTY AND DEVELOPMENT DEPARTMENT
MUNICIPAL ACCOMMODATIONS DIVISION
4TH FLOOR - 185 KING STREET
R3B 1J1

Project:
EAST ELMWOOD COMMUNITY CENTRE
480 KEENEYSIDE, WINNIPEG, MB

Drawing Title:
MECHANICAL ROOF DRAIN PLAN

Issue/Revision Date
0 - ISSUED FOR TENDER 2013.12.05
1 - RE- ISSUED FOR TENDER 2014.01.02

Design By: SHC
Date: 2013.08.23
Design Check: FSS
Date: 2013.12.05
Drawn By: JFS
Date: 2013.08.26
DWG Check: SHC
Date: 2013.12.05

Sheet No: **M105**

