

# CHARLES STREET

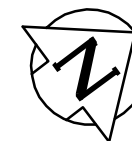

46.60 OF 600 PVC CS  
TO BE LINED S-MA00013444  
(FULLY DETERIORATED)

44.80 OF 600 BRICK CS  
TO BE LINED S-MA00013434  
(FULLY DETERIORATED)

7.00 OF 600 BRICK CS  
TO BE LINED S-MA70005497  
(FULLY DETERIORATED)

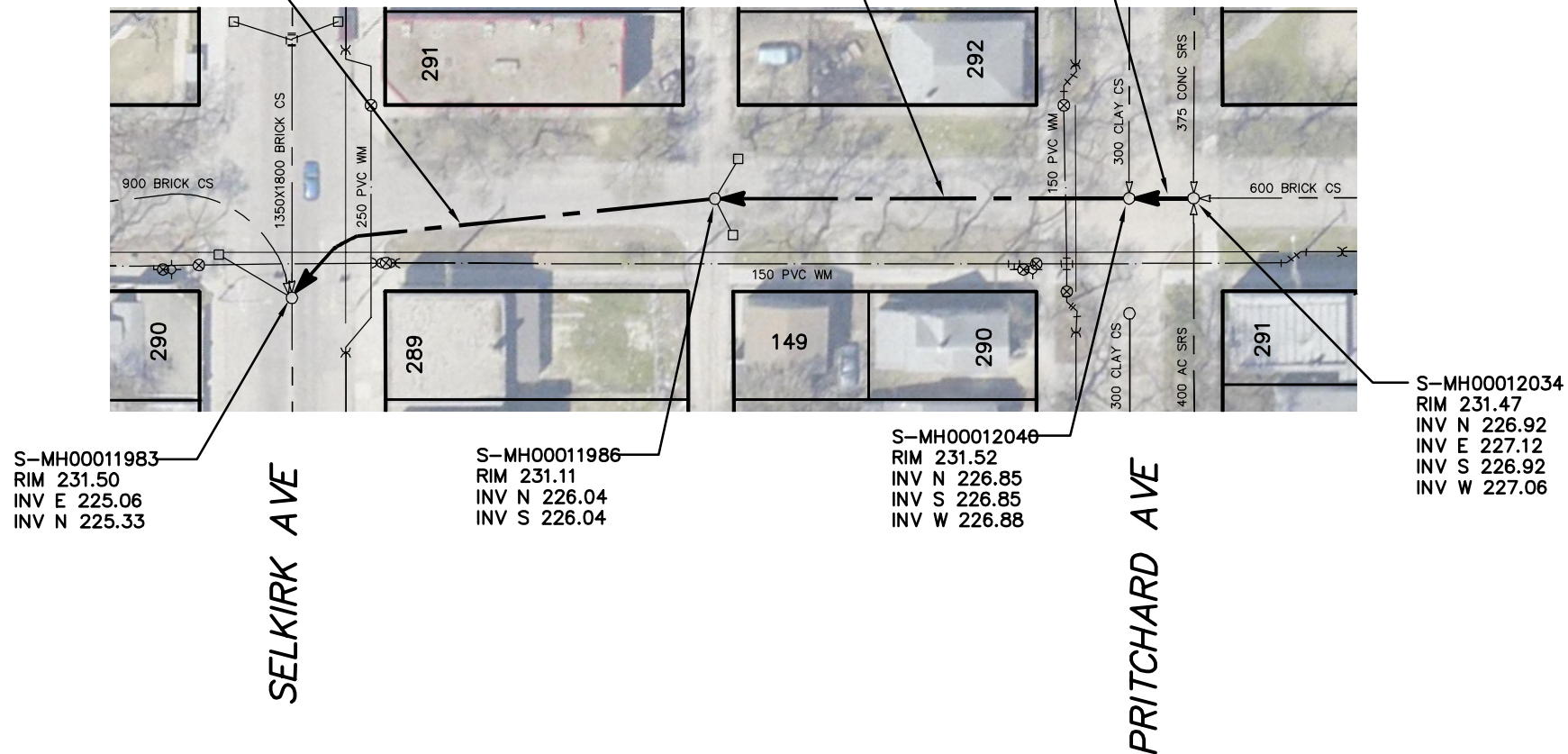

S-MH00011983  
RIM 231.50  
INV E 225.06  
INV N 225.33

S-MH00011986  
RIM 231.11  
INV N 226.04  
INV S 226.04

S-MH00012040  
RIM 231.52  
INV N 226.85  
INV S 226.85  
INV W 226.88

S-MH00012034  
RIM 231.47  
INV N 226.92  
INV E 227.12  
INV S 226.92  
INV W 227.06

SEWER JUNCTION INFORMATION FROM SEWER VIDEO INSPECTION		
SEWER ID S-MA00013444		
DISTANCE FROM MH ID S-MH00011986		
DISTANCE	DIAMETER	CLOCK
12.7	150	1
24.2	150	11

SEWER JUNCTION INFORMATION FROM SEWER VIDEO INSPECTION		
SEWER ID S-MA00013434		
DISTANCE FROM MH ID S-MH00012040		
DISTANCE	DIAMETER	CLOCK
12.0	150	11
39.8	150	11

### WARNING

IF POWER EQUIPMENT OR EXPLOSIVES ARE TO BE USED FOR EXCAVATION ON THIS PROJECT THE CONTRACTOR MUST:

- 1) NOTIFY THE GAS COMPANY OF THE PROPOSED LOCATION OF EXCAVATION.
- 2) TAKE PRECAUTION TO AVOID DAMAGE TO GAS COMPANY INSTALLATIONS.

SEE PROVINCIAL REGULATION 210/72 FOR DETAILS

### METRIC

WHOLE NUMBERS INDICATE MILLIMETRES  
DECIMALIZED NUMBERS INDICATE METRES

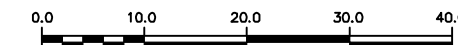

LOCATION APPROVED  
UNDERGROUND STRUCTURES

SUPV. U/G STRUCTURES COMMITTEE DATE

NOTE:

LOCATION OF UNDERGROUND STRUCTURES AS SHOWN ARE BASED ON THE BEST INFORMATION AVAILABLE BUT NO GUARANTEE IS GIVEN THAT ALL EXISTING UTILITIES ARE SHOWN OR THAT THE GIVEN LOCATIONS ARE EXACT. CONFIRMATION OF EXISTENCE AND EXACT LOCATION OF ALL SERVICES MUST BE OBTAINED FROM THE INDIVIDUAL UTILITIES BEFORE PROCEEDING WITH CONSTRUCTION.

B.M. ELEV.			
CONSTRUCTION COMPLETION DATE: YYYY MM DD			
NO.	REVISIONS	DATE	BY

DESIGNED BY	TS	CHECKED BY	SC
DRAWN BY	MA	APPROVED BY	KZ
SCALE:	1:750	RELEASED FOR CONSTRUCTION	
HORIZONTAL			
VERTICAL			
DATE	2013 10 24	DATE	

ENGINEER'S SEAL

ORIGINAL  
SIGNED BY  
S.R.J.  
COURNOYER  
13-10-24

CONSULTANT DRAWING NUMBER



**THE CITY OF WINNIPEG**  
WATER AND WASTE DEPARTMENT  
ENGINEERING DIVISION

2013 SEWER RENEWALS  
BY CIPP LINING  
**CHARLES STREET**  
MH AT PRITCHARD AVENUE (E OF C) TO  
MH AT SELKIRK AVENUE

SHEET 10 OF 46

CITY DRAWING NUMBER

10579