

ABANDON INLET & CATCHBASIN PLUG & ABANDON EX CATCHBASIN LEAD TO MANHOLE
 INSTALL NEW CATCHBASIN (SD-024)
 C/W 4.6 OF 250 CB LEAD AT 2%
 RIM 33.360
 INV 31.710, BOT 31.110

SEE DRAWING C0216

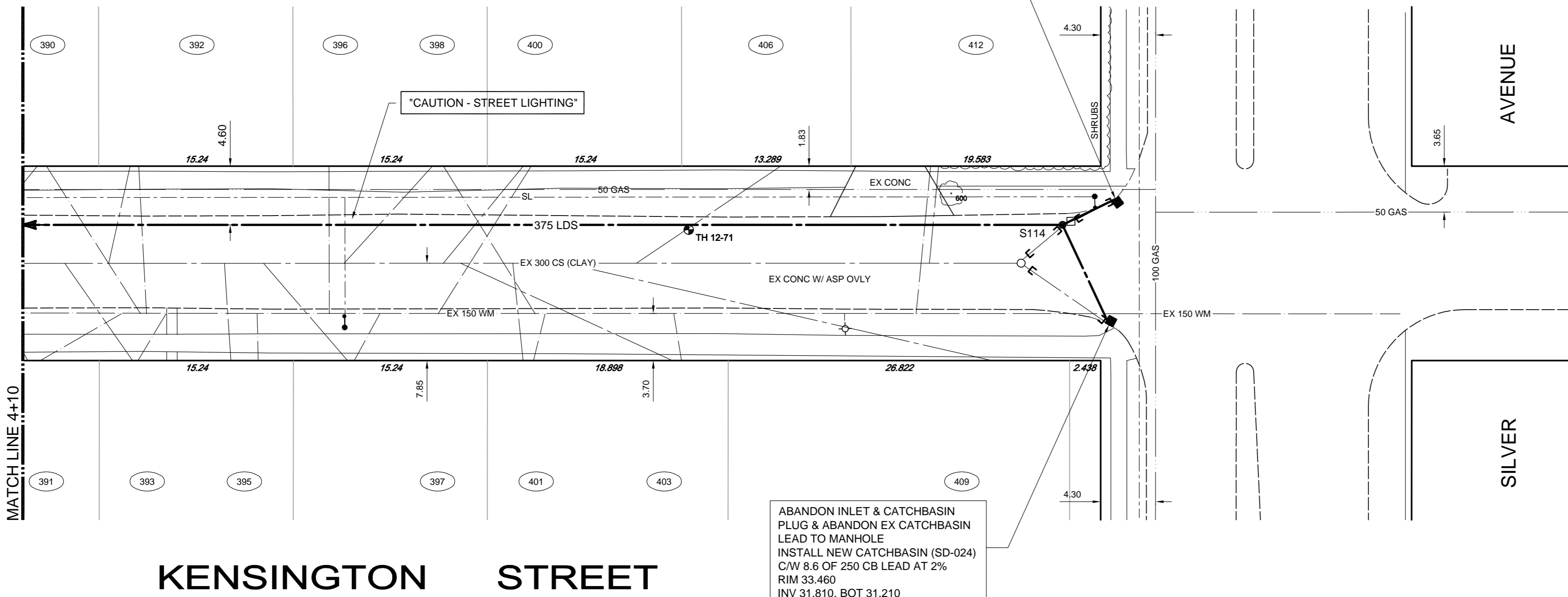

ABANDON INLET & CATCHBASIN PLUG & ABANDON EX CATCHBASIN LEAD TO MANHOLE
 INSTALL NEW CATCHBASIN (SD-024)
 C/W 8.6 OF 250 CB LEAD AT 2%
 RIM 33.460
 INV 31.810, BOT 31.210

- CONSTRUCTION NOTES:**
1. LOCATION OF ALL SEWER AND WATER LINES TO BE CONFIRMED IN THE FIELD.
 2. SEWER AND WATER SERVICES SHOWN ON DRAWINGS ARE APPROXIMATE ONLY.
 3. INSTALL NEW SEWER AND CATCHBASIN LEADS BY TRENCHLESS METHODS, UNLESS NOTED OTHERWISE.
 4. ALL SHAFTS ON NESS AVENUE TO HAVE CLASS 1 BACKFILL.
 5. INSTALL TYPE 'B' RISERS ON CATCHBASIN LEADS AS DIRECTED BY THE CONSULTANT.

- GENERAL NOTES:**
1. CHAINAGE IS ALONG WEST LIMIT OF KENSINGTON STREET.
 2. STATION 1+00 = NORTH LIMIT OF NESS AVENUE.
 3. SEE SPECIFICATIONS FOR DETAILED TEST HOLE INFORMATION.

APECM
 Certificate of Authorization
TETRA TECH WEI Inc.
 No. 5313 Date: April 30, 2014

- WARNING**
 IF POWER EQUIPMENT OR EXPLOSIVES ARE TO BE USED FOR EXCAVATION ON THIS PROJECT THE CONTRACTOR MUST:
 1. NOTIFY THE GAS COMPANY OF THE PROPOSED LOCATION OF EXCAVATION.
 2. TAKE PRECAUTION TO AVOID DAMAGE TO GAS COMPANY INSTALLATIONS. SEE PROVINCIAL REGULATION 149/92 FOR DETAILS.

KENSINGTON STREET



EXISTING	LEGEND-PLAN	PROPOSED	EXISTING	LEGEND-PLAN	PROPOSED	EXISTING	LEGEND-PLAN	PROPOSED
150 WM	WATERMAIN	150 WM	BEND	ANCHOR	LOCATION APPROVED UNDERGROUND STRUCTURES	B.M. ELEV.		
400 FM	FEEDERMAIN	400 FM	TEE	TREE	SUPV. U/G STRUCTURES COMMITTEE	DATE		
300 LDS	LAND DRAINAGE SEWER	300 LDS	CURB STOP	LEGAL DIMENSION	NOTE:			
250 WWS	WASTEWATER SEWER	250 WWS	PLUG	SURVEY BAR	LOCATION OF UNDERGROUND STRUCTURES AS SHOWN ARE BASED ON THE BEST INFORMATION AVAILABLE. BUT NO GUARANTEE IS GIVEN THAT ALL EXISTING UTILITIES ARE SHOWN OR THAT THE GIVEN LOCATIONS ARE EXACT. CONFIRMATION OF EXISTENCE AND EXACT LOCATION OF ALL SERVICES MUST BE OBTAINED FROM THE INDIVIDUAL UTILITIES BEFORE PROCEEDING WITH CONSTRUCTION.			
300 CS	COMBINED SEWER	300 CS	MANHOLE	TRAFFIC SIGNAL				
200 FCM	FORCEMAIN	200 FCM	CATCHBASIN	GAS				
	JUNCTIONS		CURB INLET	HYDRO				
	HYDRANT		ADDRESS	MTS				
	VALVE		HYDRO POLE	SIDEWALK				
	REDUCER		LIGHT STANDARD	CURB				

NO.	REVISIONS	DATE	BY
02	ISSUED FOR CONSTRUCTION	13.07.23	BLM
01	ISSUED FOR TENDER	13.05.13	BLM
00	ISSUED FOR APPROVAL	13.05.10	BLM

TETRA TECH

DESIGNED BY: KJM, GC
 CHECKED BY: BLM
 DRAWN BY: GMD
 APPROVED BY: GS
 HOR. SCALE: 1 : 250
 VERTICAL: 1 : 50
 DATE: 12.12.17

ORIGINAL DRAWING REVISION "01" SEALED BY B.L. McINTOSH 13.05.09
 CONSULTANT DRAWING NO. 1000120300-DWG-C0111

THE CITY OF WINNIPEG
 WATER AND WASTE DEPARTMENT

FERRY ROAD AND RIVERBEND COMBINED SEWER RELIEF WORKS CONTRACT 2
 KENSINGTON STREET
 85m SOUTH OF SILVER AVENUE TO SILVER AVENUE

CITY DRAWING NUMBER LD-7115
 SHEET 17 OF 17
 C0217