



PUBLIC RESERVE
"B"

MTS. EASEMENT

HYDRO POLE LINE

MTS DUCT

24" ϕ CONC PIPE

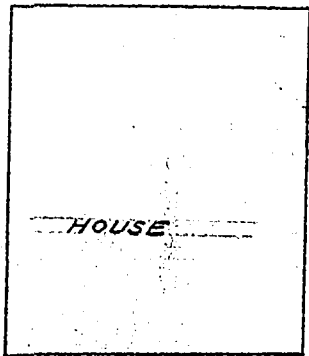

SUPER-
STRUCTURE
16' X 22'

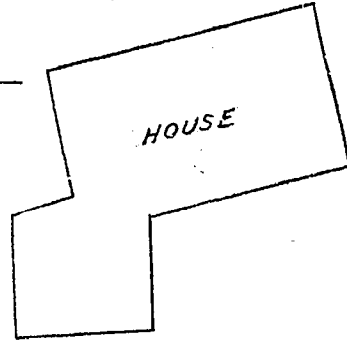

HOUSE

32'-6"

28'

20'-8"

4'-2"

0'-4"

18'-0"

9'

15'-5"

15'-10"

24'-10"

45' (R/W)

PROPOSED DRIVEWAY

AVE.

12" ϕ SEWER

ASSINIBOINE

8" ϕ W.M.
18" ϕ SEWER
10" ϕ SEWER
24" ϕ FORCE MAIN

PROPOSED INLET
SEWER TO PUMP
STATION

PUBLIC RESERVE "A"

GATE CHAMBER

THE METROPOLITAN CORPORATION OF GREATER WPG
WATERWORKS & WASTE DISPOSAL DIVISION
SEWER DISPOSAL BRANCH

ST. JAMES INTERCEPTOR
SITE PLAN
AINSLIE PUMPING STATION

- REVISIONS
- ▲ DRIVEWAY RELOCATED JUNE 20/63 V.D.
 - △ SUPERSTRUCTURE DIMENSIONS ADDED 13 MAY 64

| | | | |
|-------------|--------------------|---------------------|----------|
| APPROVED BY | DESIGNED BY | CHECKED BY | DWG. No. |
| | | | |
| | DRAWN BY V.D. | DATE MARCH 20/63 | S-265 |
| | SCALES 1" = 40' | | |