

- REFERENCE NOTES**
- A. PAVEMENT DIMENSIONS ARE TO BACK OF CURB
  - B. BASELINE IS 12.0M NORTH OF SOUTH PROPERTY LINE
  - C. PROPERTY LINES OBTAINED FROM THE CITY OF WINNIPEG L.B.I.S., AND NO SCALE FACTOR WAS APPLIED
  - D. REFER TO AECOM FIELD BOOK NO. 4821, 4822 & 4823

- CONSTRUCTION NOTES:**
1. PAVEMENT EXISTING ASPHALT AND CONSTRUCT NEW ASPHALTIC PAVEMENT OVERLAY TYPE 1A (AVERAGE THICKNESS 85mm)
  2. REMOVE EXISTING PAVEMENT AND CONSTRUCT NEW 200mm REINFORCED CONCRETE PAVEMENT c/w 85mm TYPE 1A ASPHALTIC OVERLAY
  3. REMOVE EXISTING CONCRETE SIDEWALK AND CONSTRUCT NEW 100mm SIDEWALK c/w PAVING STONE BAND (SEE DETAIL 1)
  4. RENEW EXISTING MONOLITHIC CURB RAMP (10mm HT. INTEGRAL)
  5. CONSTRUCT NEW MODIFIED BARRIER CURB (150mm AVG. HT. REVEAL SEPARATE)
  6. REMOVE EXISTING BARRIER CURB
  7. RENEW EXISTING BARRIER CURB (100mm AVG. HT. REVEAL)
  8. ADJUST EXISTING CATCH BASIN/MANHOLE TO GRADE
  9. REMOVE EXISTING FRAME AND COVER AND PLACE NEW FRAME AND COVER (AP-004 AND AP-005)
  10. INSTALL NEW CAST IRON RISER RING
  11. INSTALL NEW DETECTABLE SURFACE WARNING TILES
  12. ADJUST MTS MANHOLE FRAME AND COVER
  13. CONSTRUCT MONOLITHIC CONCRETE BULLNOSE
  14. ADJUST EXISTING CURB STOP TO GRADE
  15. INSTALL VALVE BOX EXTENTION
  16. REMOVE EXISTING CATCHBASIN AND CURB INLET
  17. INSTALL NEW CURB AND GUTTER INLET c/w CATCHBASIN (SD-024) AND CONNECT TO EXISTING LEAD
  18. REGRADE EXISTING PAVING STONES
  19. REMOVE EXISTING TREE WELL
  20. REMOVE AND INSTALL EXISTING BENCH (BY OTHERS)
  21. REMOVE AND INSTALL EXISTING GARBAGE BIN (BY OTHERS)
  22. REMOVE AND INSTALL EXISTING BUS SHELTER (BY OTHERS) TRANSIT
  23. REMOVE AND INSTALL EXISTING BIKE RACK
  24. INSTALL PAVING STONE (SEE DETAIL 2)
  25. REMOVE AND REINSTALL PAVERS
  26. EXISTING CONCRETE SLABS, MATCH GRADE

TRANSIT CONTACT FOR BUS SHELTER  
Mr. Trevor Blue  
(204) 986-3821

**METRIC**  
WHOLE NUMBERS INDICATE MILLIMETRES  
DECIMALIZED NUMBERS INDICATE METRES

**AECOM**  
Certificate of Authorization  
AECOM Canada Ltd.  
No. 4671 Date: Nov 26/14

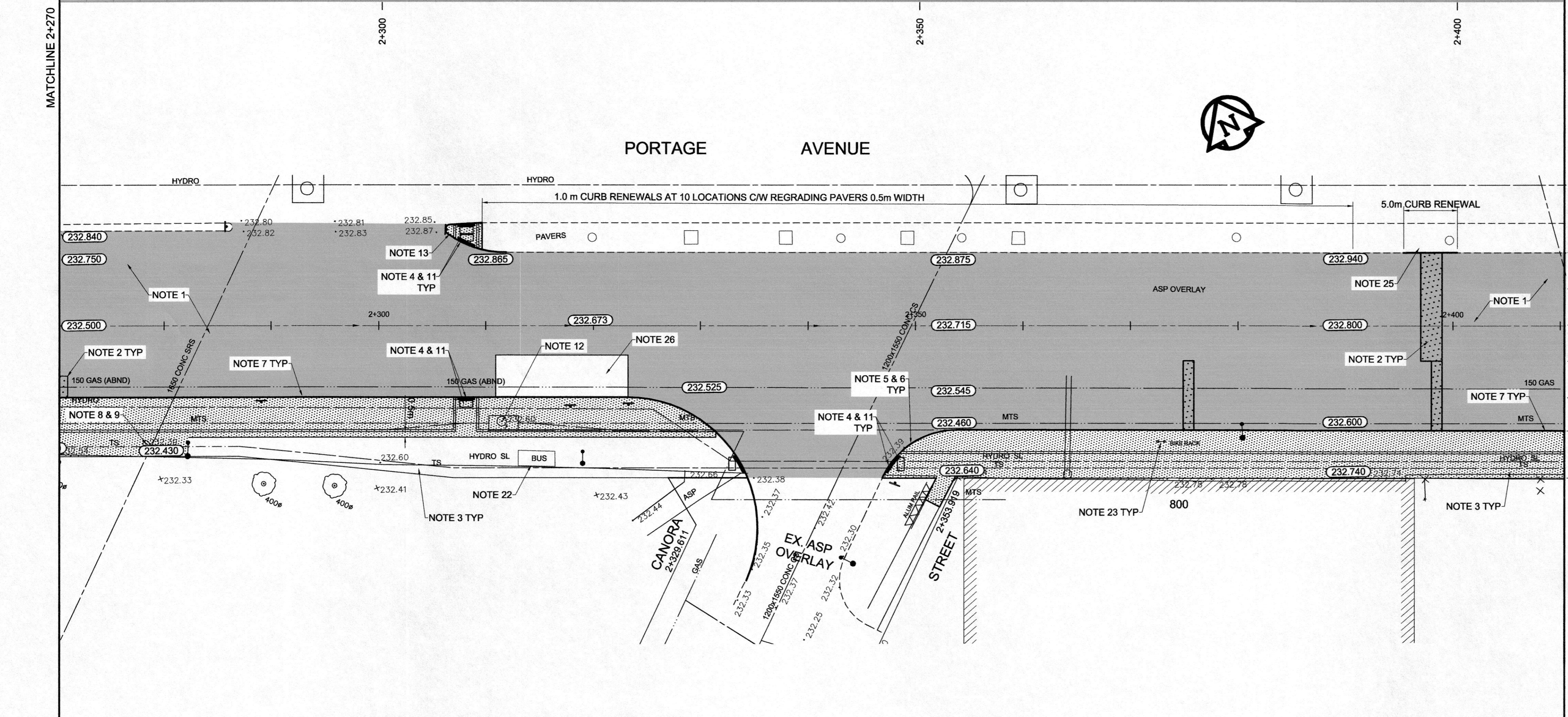

EXISTING	LEGEND - PLAN	PROPOSED	EXISTING	LEGEND - PLAN	PROPOSED	EXISTING	LEGEND - PROFILE	PROPOSED
150 mm W.M.	WATERMAIN	150 mm W.M.	---	HYDRO	---	x	C PROFILE	---
⊕	HYDRANT	⊕	---	M.T.S.	---	⊙	SOUTHEAST GUTTER	---
⊕	VALVE	⊕	---	CONCRETE	---	⊙	MEDIAN GUTTER	---
300mm L.D.S.	LAND DRAINAGE SEWER	300mm L.D.S.	---	ASPHALT	---	◇	N/W PROPERTY LINE	---
250mm W.W.S.	WASTEWATER SEWER	250mm W.W.S.	---	PROPERTY LINE	---	○	S/E PROPERTY LINE	---
○	MANHOLE	●	⊕	SURVEY BAR	---	---	---	---
□	CATCH BASIN	■	235.750	ELEVATION	(35.750)	---	---	---
▽	CURB INLET	▽	500#	TREE	---	---	---	---
---	BUILDING OUTLINE	---	---	SIDEWALK RAMP	---	---	---	---
---	CULVERT	---	---	CONCRETE SIDEWALK	---	---	---	---
---	GAS	---	---	FENCE	---	---	---	---

**LOCATION APPROVED UNDERGROUND STRUCTURES**

SUPV. U/G STRUCTURES COMMITTEE DATE

**NOTE:**  
LOCATION OF UNDERGROUND STRUCTURES AS SHOWN ARE BASED ON THE BEST INFORMATION AVAILABLE. BUT NO GUARANTEE IS GIVEN THAT ALL EXISTING UTILITIES ARE SHOWN OR THAT THE GIVEN LOCATIONS ARE EXACT. CONFIRMATION OF EXISTENCE AND EXACT LOCATION OF ALL SERVICES MUST BE OBTAINED FROM THE INDIVIDUAL UTILITIES BEFORE PROCEEDING WITH CONSTRUCTION.

NO.	REVISIONS	DATE	BY
0	ISSUED FOR TENDER	11/27/2014	KWR

**AECOM**

DESIGNED BY: BC  
DRAWN BY: RT, PB  
HOR. SCALE: 1:250  
VERTICAL: 1:10

CHECKED BY: KWR  
APPROVED BY: [Signature]  
RELEASED FOR CONSTRUCTION BY: [Signature]

DATE: 2014/06/26

ENGINEER'S SEAL  
PROVINCE OF MANITOBA  
K.W. RAE  
REGISTERED PROFESSIONAL ENGINEER

CONSULTANT DRAWING NO. CT-08

**THE CITY OF WINNIPEG**  
PUBLIC WORKS DEPARTMENT  
ENGINEERING DIVISION

PORTAGE AVENUE REHABILITATION:  
PART A- EASTBOUND FROM SHERBURN ST. TO MARYLAND ST.  
PART B- WESTBOUND FROM EMPRESS ST. TO MINTO ST.

PLAN / PROFILE PART A  
STATION 2+270 TO STATION 2+410

CITY DRAWING NUMBER P-3359-08  
SHEET 8 OF 21