

- REFERENCE NOTES**
- A. PAVEMENT DIMENSIONS ARE TO BACK OF CURB
 - B. BASELINE IS 12.0M NORTH OF SOUTH PROPERTY LINE
 - C. PROPERTY LINES OBTAINED FROM THE CITY OF WINNIPEG L.B.I.S., AND NO SCALE FACTOR WAS APPLIED
 - D. REFER TO AECOM FIELD BOOK NO. 4821, 4822 & 4823
- CONSTRUCTION NOTES:**
1. PLANE EXISTING ASPHALT AND CONSTRUCT NEW ASPHALTIC PAVEMENT OVERLAY TYPE 1A (AVERAGE THICKNESS 85mm)
 2. REMOVE EXISTING PAVEMENT AND CONSTRUCT NEW 200mm REINFORCED CONCRETE PAVEMENT c/w 85mm TYPE 1A ASPHALT OVERLAY
 3. REMOVE EXISTING CONCRETE SIDEWALK AND CONSTRUCT NEW 100mm SIDEWALK c/w PAVING STONE BAND (SEE DETAIL 1)
 4. RENEW EXISTING MONOLITHIC CURB RAMP (10mm HT. INTEGRAL) CONSTRUCT NEW MODIFIED BARRIER CURB (150mm AVG. HT. REVEAL SEPARATE)
 5. REMOVE EXISTING BARRIER CURB
 6. RENEW EXISTING BARRIER CURB (100mm AVG. HT. REVEAL)
 7. ADJUST EXISTING CATCH BASIN/MANHOLE TO GRADE
 8. REMOVE EXISTING FRAME AND COVER AND PLACE NEW FRAME AND COVER (AP-004 AND AP-005)
 9. INSTALL NEW CAST IRON RISER RING
 10. INSTALL NEW DETECTABLE SURFACE WARNING TILES
 11. ADJUST MTS MANHOLE FRAME AND COVER c/w 50mm CAST IRON RISER RING
 12. ADJUST SIGNAL SERVICE BOX
 13. ADJUST EXISTING CURB STOP TO GRADE
 14. INSTALL VALVE BOX EXTENSION
 15. REMOVE EXISTING CATCHBASIN
 16. INSTALL NEW CURB AND GUTTER INLET c/w CATCHPI (SD-023) AND CONNECT TO EXISTING LEAD
 17. INSTALL NEW CURB AND GUTTER INLET c/w CATCHBASIN (SD-024) AND CONNECT TO EXISTING LEAD
 18. REMOVE EXISTING CURB INLET
 19. REMOVE AND REINSTALL PAVERS

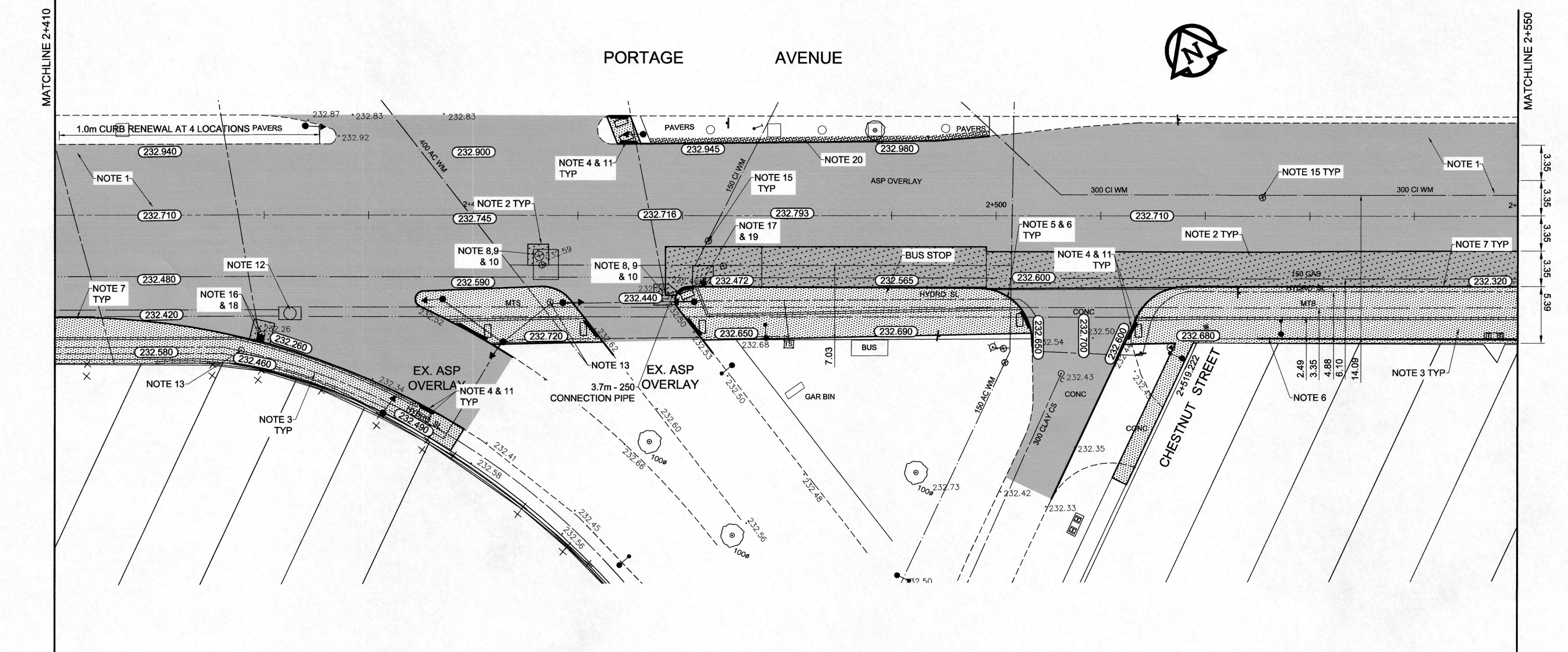

METRIC
WHOLE NUMBERS INDICATE MILLIMETRES
DECIMALIZED NUMBERS INDICATE METRES

AECOM
Certificate of Authorization
AECOM Canada Ltd.
No. 4671 Date: 16/26/14

| EXISTING | LEGEND - PLAN | PROPOSED | EXISTING | LEGEND - PLAN | PROPOSED | EXISTING | LEGEND - PROFILE | PROPOSED |
|-------------------------|---------------------|--------------------------|-------------------|------------------|----------|----------|-------------------|----------|
| 150 mm W.M. | WATERMAIN | 150 mm W.M. | HYDRO | M.T.S. | --- | --- | C PROFILE | --- |
| Hydrant symbol | HYDRANT | Valve symbol | Valve symbol | CONCRETE ASPHALT | --- | --- | SOUTH/EAST GUTTER | --- |
| 300mm L.D.S. | LAND DRAINAGE SEWER | 300mm L.D.S. | CONCRETE ASPHALT | --- | --- | --- | MEDIAN GUTTER | --- |
| 250mm W.W.S. | WASTEWATER SEWER | 250mm W.W.S. | PROPERTY LINE | --- | --- | --- | N/W PROPERTY LINE | --- |
| Manhole symbol | MANHOLE | Survey bar symbol | SURVEY BAR | --- | --- | --- | S/E PROPERTY LINE | --- |
| Catch basin symbol | CATCH BASIN | Elevation symbol | ELEVATION | (35.750) | --- | --- | --- | --- |
| Curb inlet symbol | CURB INLET | Tree symbol | TREE | --- | --- | --- | --- | --- |
| Building outline symbol | BUILDING OUTLINE | Sidewalk ramp symbol | SIDEWALK RAMP | --- | --- | --- | --- | --- |
| Culvert symbol | CULVERT | Concrete sidewalk symbol | CONCRETE SIDEWALK | --- | --- | --- | --- | --- |
| Gas symbol | GAS | Fence symbol | FENCE | --- | --- | --- | --- | --- |

LOCATION APPROVED UNDERGROUND STRUCTURES

SUPV. U/G STRUCTURES COMMITTEE DATE

NOTE:
LOCATION OF UNDERGROUND STRUCTURES AS SHOWN ARE BASED ON THE BEST INFORMATION AVAILABLE. BUT NO GUARANTEE IS GIVEN THAT ALL EXISTING UTILITIES ARE SHOWN OR THAT THE GIVEN LOCATIONS ARE EXACT. CONFIRMATION OF EXISTENCE AND EXACT LOCATION OF ALL SERVICES MUST BE OBTAINED FROM THE INDIVIDUAL UTILITIES BEFORE PROCEEDING WITH CONSTRUCTION.

B.M. 89R581
ELEV. 232.540

S.W. corner Portage Ave. & Sprague St., Tbl. on pipe, 4.6m E. of W.L. Sprague St. produced from the W. along the S.L. of Portage Ave.

DESIGNED BY: BC
DRAWN BY: RT, PB
HOR. SCALE: 1:250
VERTICAL: 1:10

ISSUED FOR TENDER: 11/27/2014
NO. REVISIONS: 0

AECOM

DESIGNED BY: BC
CHECKED BY: KWR

DRAWN BY: RT, PB
APPROVED BY:

HOR. SCALE: 1:250
VERTICAL: 1:10

RELEASED FOR CONSTRUCTION BY:

DATE: 2014/06/26
DATE: 10/20/14

ENGINEER'S SEAL

PROVINCE OF MANITOBA
K.W. RAE
16/26/14
REGISTERED PROFESSIONAL ENGINEER

CONSULTANT DRAWING NO. CT-09

THE CITY OF WINNIPEG
PUBLIC WORKS DEPARTMENT
ENGINEERING DIVISION

PORTAGE AVENUE REHABILITATION:
PART A- EASTBOUND FROM SHERBURN ST. TO MARYLAND ST.
PART B- WESTBOUND FROM EMPRESS ST. TO MINTO ST.

CITY DRAWING NUMBER P-3359-09
SHEET 9 OF 21

PLAN / PROFILE PART A
STATION 2+410 TO STATION 2+550