

WESTBOUND

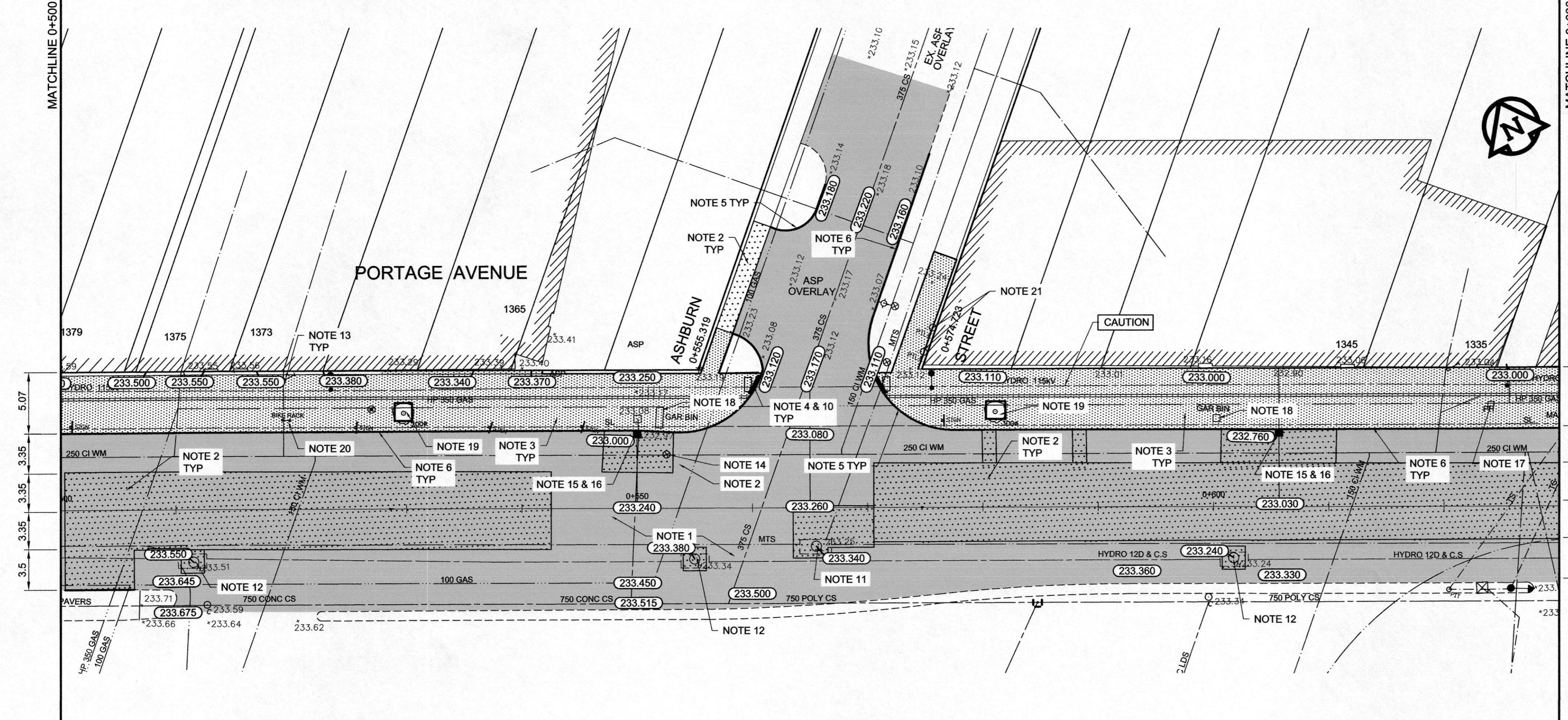

REFERENCE NOTES

- A. PAVEMENT DIMENSIONS ARE TO BACK OF CURB
- B. BASELINE IS 12.0M SOUTH OF NORTH GUTTER
- C. PROPERTY LINES OBTAINED FROM THE CITY OF WINNIPEG L.B.I.S., AND NO SCALE FACTOR WAS APPLIED
- D. REFER TO AECOM FIELD BOOK NO. 4821, 4822 & 4823

CONSTRUCTION NOTES:

1. PLANE EXISTING ASPHALT AND CONSTRUCT NEW ASPHALTIC PAVEMENT OVERLAY TYPE 1A (AVERAGE THICKNESS 85mm)
2. REMOVE EXISTING PAVEMENT AND CONSTRUCT NEW 200mm REINFORCED CONCRETE PAVEMENT c/w 85mm TYPE 1A ASPHALT OVERLAY
3. REMOVE EXISTING CONCRETE SIDEWALK AND CONSTRUCT NEW 100mm SIDEWALK c/w PAVING STONE BAND (SEE DETAIL 1)
4. CONSTRUCT NEW MONOLITHIC CURB RAMP (10mm HT. INTEGRAL)
5. CONSTRUCT NEW MODIFIED BARRIER CURB (150mm AVG. HT. REVEAL SEPARATE)
6. RENEW EXISTING BARRIER CURB (100mm AVG. HT. REVEAL)
7. ADJUST EXISTING CATCH BASIN/MANHOLE TO GRADE
8. REMOVE EXISTING FRAME AND COVER AND PLACE NEW FRAME AND COVER (AP-004 AND AP-005)
9. INSTALL NEW CAST IRON RISER RING
10. INSTALL NEW DETECTABLE SURFACE WARNING TILES
11. REMOVE AND INSTALL NEW MTS MANHOLE FRAME AND COVER c/w 50mm CAST IRON RISER RING
12. ADJUST EXISTING HYDRO MANHOLE (BY OTHERS)
13. ADJUST EXISTING CURB STOP TO GRADE
14. INSTALL NEW VALVE BOX EXTENSION
15. REMOVE EXISTING CATCHBASIN AND CURB INLET
16. INSTALL NEW CURB AND GUTTER INLET C/W CATCHBASIN (SD-024 - 1800mm) AND CONNECT TO EXISTING LEAD
17. REMOVE AND INSTALL EXISTING PHONE BOOTH (BY OTHERS)
18. REMOVE AND INSTALL EXISTING GARBAGE BIN (BY OTHERS)
19. CONSTRUCT NEW CONCRETE TREE WELL (SEE DETAIL 2)
20. REMOVE AND INSTALL EXISTING BIKE RACK (BY OTHERS)
21. REMOVE EXISTING CONCRETE PILE 1.0m BELOW GRADE

METRIC  
WHOLE NUMBERS INDICATE MILLIMETRES  
DECIMALIZED NUMBERS INDICATE METRES



EXISTING	LEGEND - PLAN	PROPOSED	EXISTING	LEGEND - PLAN	PROPOSED	EXISTING	LEGEND - PROFILE	PROPOSED
150 mm W.M.	WATERMAIN	150 mm W.M.	---	HYDRO	---	---	C PROFILE	---
300mm L.D.S.	LAND DRAINAGE SEWER	300mm L.D.S.	---	CONCRETE	---	---	NORTHWEST GUTTER	---
250mm W.W.S.	WASTEWATER SEWER	250mm W.W.S.	---	PROPERTY LINE	---	---	MEDIAN GUTTER	---
○	MANHOLE	○	---	SURVEY BAR	---	---	N/W PROPERTY LINE	---
□	CATCH BASIN	■	---	ELEVATION	(35.750)	---	S/E PROPERTY LINE	---
▽	CURB INLET	▽	---	TREE	---	---		---
+	JUNCTIONS	+	---	SIDEWALK RAMP	---	---		---
▭	CULVERT	▭	---	CONCRETE SIDEWALK	---	---		---
---	GAS	---	---	FENCE	---	---		---

LOCATION APPROVED UNDERGROUND STRUCTURES

SUPV. U/G STRUCTURES COMMITTEE DATE

NOTE: LOCATION OF UNDERGROUND STRUCTURES AS SHOWN ARE BASED ON THE BEST INFORMATION AVAILABLE. BUT NO GUARANTEE IS GIVEN THAT ALL EXISTING UTILITIES ARE SHOWN OR THAT THE GIVEN LOCATIONS ARE EXACT. CONFIRMATION OF EXISTENCE AND EXACT LOCATION OF ALL SERVICES MUST BE OBTAINED FROM THE INDIVIDUAL UTILITIES BEFORE PROCEEDING WITH CONSTRUCTION.

B.M. 89R581 S.W. corner Portage Ave. & Sprague St., Tbt. on pipe. ELEV. 232.540 4.8m E. of W.L. Sprague St. produced from the W. along the S.L. of Portage Ave.

**AECOM**

DESIGNED BY BC CHECKED BY KWR

DRAWN BY RT, PB APPROVED BY

HOR. SCALE: 1:250  
VERTICAL: 1:10

RELEASED FOR CONSTRUCTION BY:

0 ISSUED FOR TENDER 11/27/2014 KWR

NO. REVISIONS DATE BY DATE 2014/06/26



**THE CITY OF WINNIPEG**  
PUBLIC WORKS DEPARTMENT  
ENGINEERING DIVISION

PORTAGE AVENUE REHABILITATION:  
PART A- EASTBOUND FROM SHERBURN ST. TO MARYLAND ST.  
PART B- WESTBOUND FROM EMPRESS ST. TO MINTO ST.

PLAN / PROFILE PART B  
STATION 0+500 TO STATION 0+630

CITY DRAWING NUMBER P-3356-05  
SHEET 16 OF 21

CONSULTANT DRAWING NO. CT-16