

File Name: U:\FMS\14-0107-035\14-0107-035_G01.dwg - Tab: G01 Plotted By: emiguel 14/12/08 [Mon 2:29pm]
 24 x 36 PLOT SCALE:

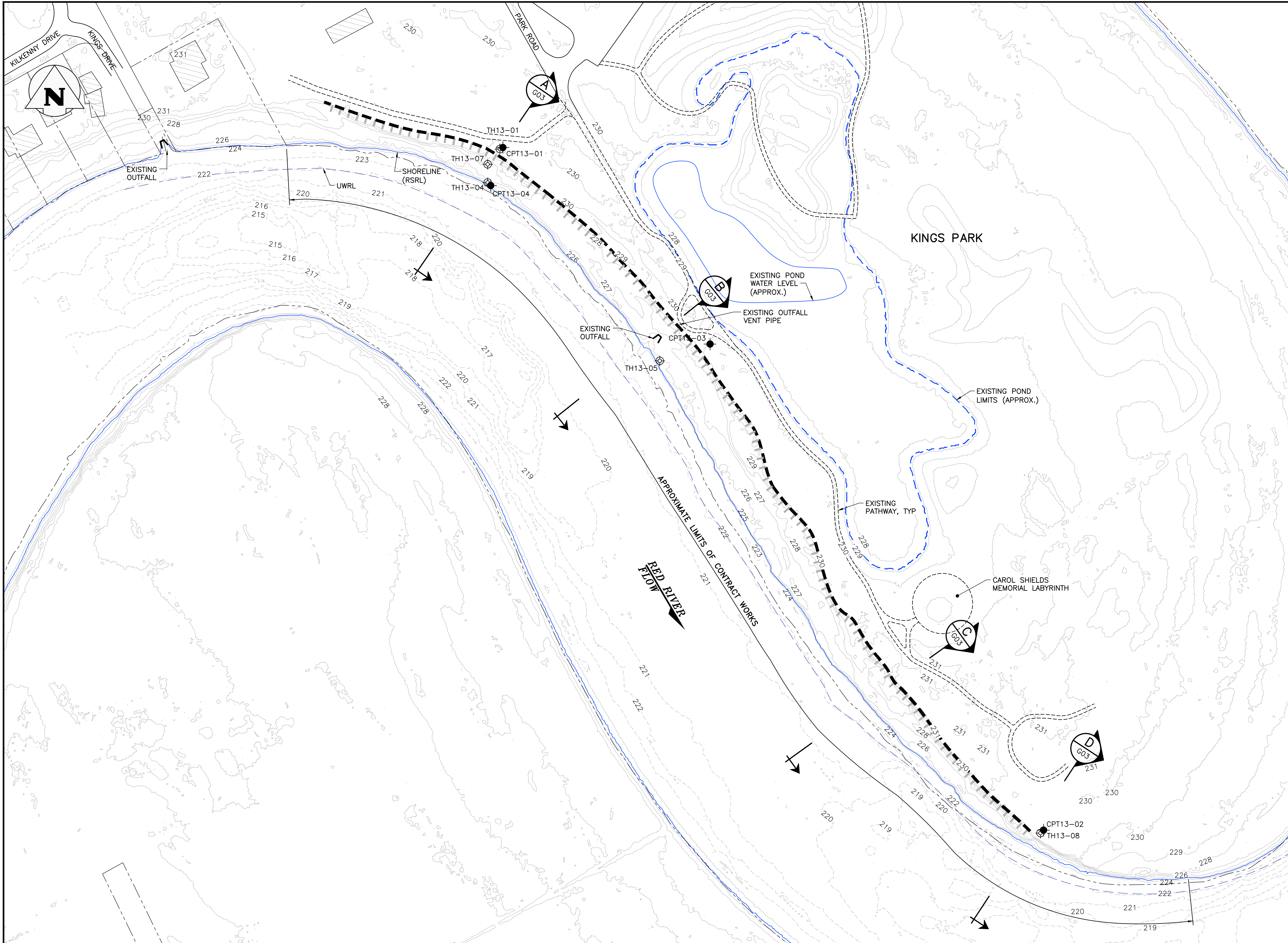

- LEGEND:**
- APPROXIMATE LOCATION OF HEAD SCARP (SEE NOTE 4)
 - PROPERTY LINE
 - RSRL REGULATED SUMMER RIVER LEVEL (EL 224.26m)
 - UWRL UNREGULATED WINTER RIVER LEVEL (EL 222.86m)

- NOTES:**
1. ALL UNITS ARE METRIC AND IN METRES UNLESS OTHERWISE SPECIFIED. TRANSVERSE MERCATOR PROJECTION, NAD 1983, ZONE 14. ELEVATIONS ARE IN METRES ABOVE SEA LEVEL (MSL).
 2. BATHYMETRIC SURVEYS/CONTOURS COMPLETED BY KGS GROUP ON JULY 17, 2013.
 3. RIVERBANK TOPOGRAPHY BASED ON CITY OF WINNIPEG LIDAR CONTOURS CAPTURED IN OCTOBER 2011 AND SUPPLEMENTED BY KGS GROUP SURVEY ON JULY 17, 2013.
 4. HISTORICAL SCARPS EXIST THROUGHOUT. FOR CLARITY, ONLY THE SCARP AT THE TOP OF BANK IS SHOWN.
 5. CONTRACTOR TO ENSURE TESTHOLE INSTRUMENTATION IS PROTECTED DURING CONSTRUCTION. DAMAGED INSTRUMENTATION SHALL BE REPAIRED OR REPLACED AT THE CONTRACTOR'S COST.

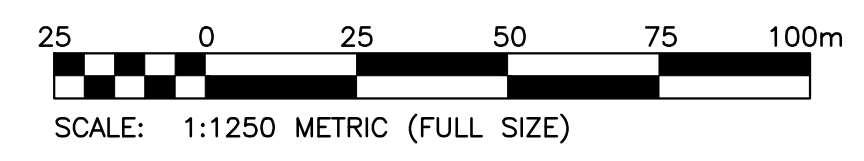

	WATERMAIN HYDRANT VALVE		HYDRO M.T.S.
	LAND DRAINAGE SEWER MANHOLE		PROPERTY LINE SURVEY BAR
	WASTE WATER SEWER CATCH BASIN		LIGHT STANDARD
	CURB INLET		HYDRO POLE
	JUNCTIONS		SIGN
	CULVERT		BUSH LINE
	GAS		FENCE LINE
	EXISTING		ELEVATION
	LEGEND-PLAN		PROPOSED

	LIDAR CONTOUR (CITY OF WPG., OCT. 2011)
	BATHYMETRY CONTOUR (KGS GROUP, JULY 2013)
	TEST HOLE (KGS GROUP, MARCH 2013)
	CONE PENETRATION TEST (CPT) (KGS GROUP, MARCH 2013)
	EXISTING BUILDING
	TREE
	TIMBER PILE
	LOCATION APPROVED
	UNDERGROUND STRUCTURES

NO.	REVISIONS	DATE	BY
00	ISSUED FOR TENDER	14/12/08	

KGS GROUP CONSULTING ENGINEERS & PROJECT MANAGERS
 WINNIPEG (204) 896-1209
 THUNDER BAY (807) 345-2233

DESIGNED BY: SGB	CHECKED BY: jS
DRAWN BY: ESsm	APPROVED BY: RKc
HOR. SCALE: AS NOTED	RELEASED FOR CONSTRUCTION:
VERTICAL: -	

ENGINEER'S SEAL
 THE ORIGINAL ISSUE REV. 0 WAS STAMPED, DATED AND SIGNED BY: R.M. KENYON, P.ENG ON 2014/12/08
 CONSULTANT DRAWING NO. 14-0107-035_G01

THE CITY OF WINNIPEG
 PLANNING, PROPERTY AND DEVELOPMENT DEPARTMENT

KINGS PARK
 RIVERBANK EROSION PROTECTION WORKS
 EXISTING SITE CONDITIONS (JULY 2013)
 PLAN

SHEET 02 OF 05
 CAD FILE DRAWING NUMBER 14-0107-035_G01
 CITY DRAWING NUMBER PPD-WAT-1144-2014-G01