

SALTER STREET

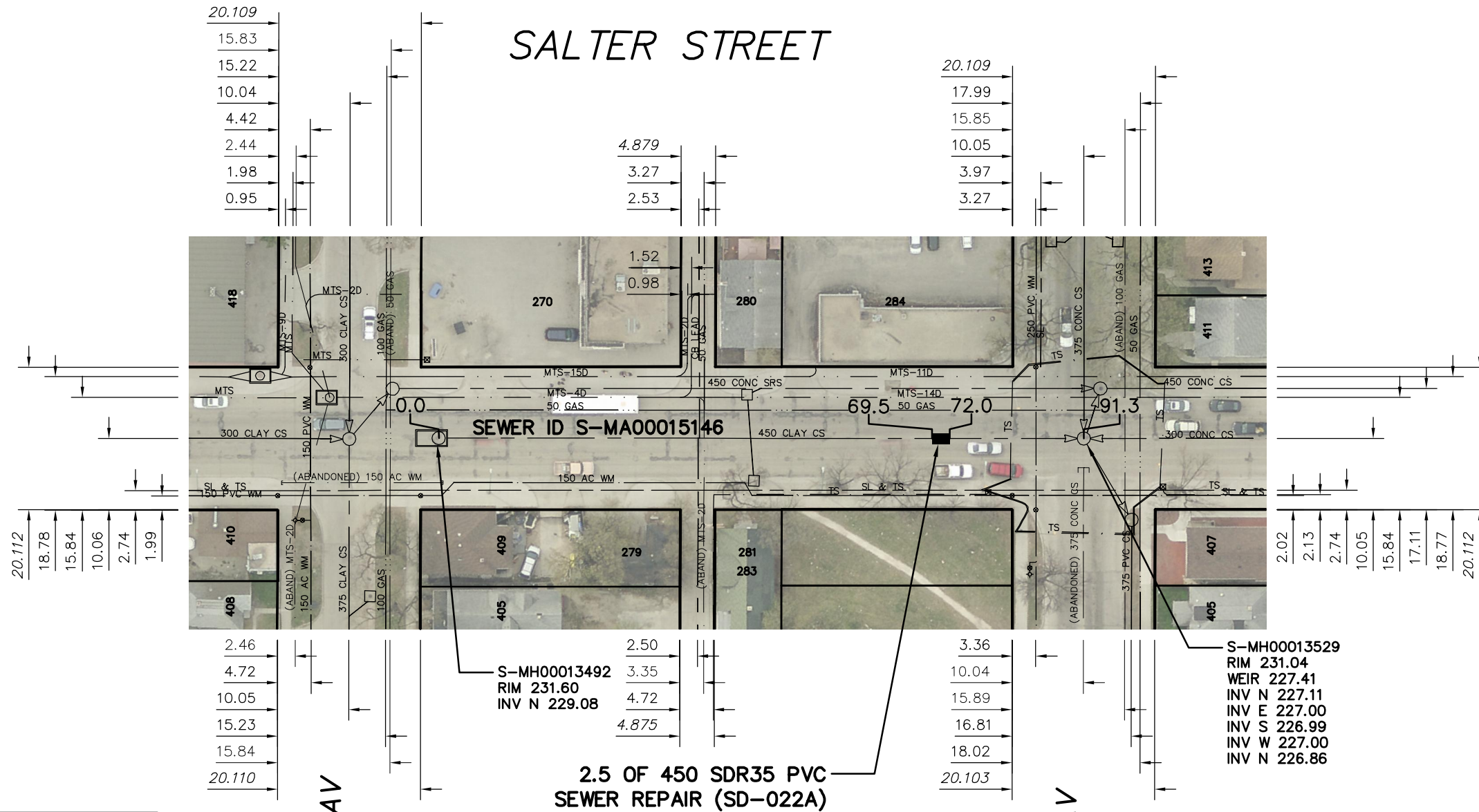

SEWER JUNCTION INFORMATION FROM SEWER VIDEO INSPECTION		
SEWER ID S-MA00015146		
DISTANCE FROM MH ID S-MH00013492		
DISTANCE	DIAMETER	CLOCK
4.8	150	3
32.8	150	1
35.9	150	9
36.0	150	2
40.8	150	1
41.4	150	11
45.8	150	2
46.3	150	10
55.5	150	9
63.0	150	2
63.3	150	10

S-MH00013492
RIM 231.04
WEIR 227.41
INV N 227.11
INV E 227.00
INV S 226.99
INV W 227.00
INV N 226.86

2.5 OF 450 SDR35 PVC SEWER REPAIR (SD-022A)

WARNING

IF POWER EQUIPMENT OR EXPLOSIVES ARE TO BE USED FOR EXCAVATION ON THIS PROJECT THE CONTRACTOR MUST:

- 1) NOTIFY THE GAS COMPANY OF THE PROPOSED LOCATION OF EXCAVATION.
- 2) TAKE PRECAUTION TO AVOID DAMAGE TO GAS COMPANY INSTALLATIONS.

SEE PROVINCIAL REGULATION 210/72 FOR DETAILS

METRIC

WHOLE NUMBERS INDICATE MILLIMETRES
DECIMALIZED NUMBERS INDICATE METRES

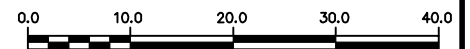

LOCATION APPROVED
UNDERGROUND STRUCTURES

SUPV. U/G STRUCTURES COMMITTEE DATE

NOTE:

LOCATION OF UNDERGROUND STRUCTURES AS SHOWN ARE BASED ON THE BEST INFORMATION AVAILABLE BUT NO GUARANTEE IS GIVEN THAT ALL EXISTING UTILITIES ARE SHOWN OR THAT THE GIVEN LOCATIONS ARE EXACT. CONFIRMATION OF EXISTENCE AND EXACT LOCATION OF ALL SERVICES MUST BE OBTAINED FROM THE INDIVIDUAL UTILITIES BEFORE PROCEEDING WITH CONSTRUCTION.

B.M. ELEV.			
CONSTRUCTION COMPLETION DATE: YYYY MM DD			
NO.	REVISIONS	DATE	BY

DESIGNED BY	TS	CHECKED BY	SC
DRAWN BY	MA	APPROVED BY	KZ
SCALE:	1:750	RELEASED FOR CONSTRUCTION	
HORIZONTAL			
VERTICAL			
DATE	2014 12 11	DATE	

ENGINEER'S SEAL
ORIGINAL SIGNED BY S.R.J. COURNOYER 14/12/10

CONSULTANT DRAWING NUMBER



THE CITY OF WINNIPEG

WATER AND WASTE DEPARTMENT
ENGINEERING DIVISION

2014 SEWER RENEWALS AND REPAIRS

SALTER STREET

MH AT ABERDEEN AVENUE (N PL) TO MH AT REDWOOD AVENUE (CL)

SHEET 27 OF 29

CITY DRAWING NUMBER

10926