

1 POWER, SYSTEMS AND LIGHTING PLAN - NEW
 SCALE: 1:50mm

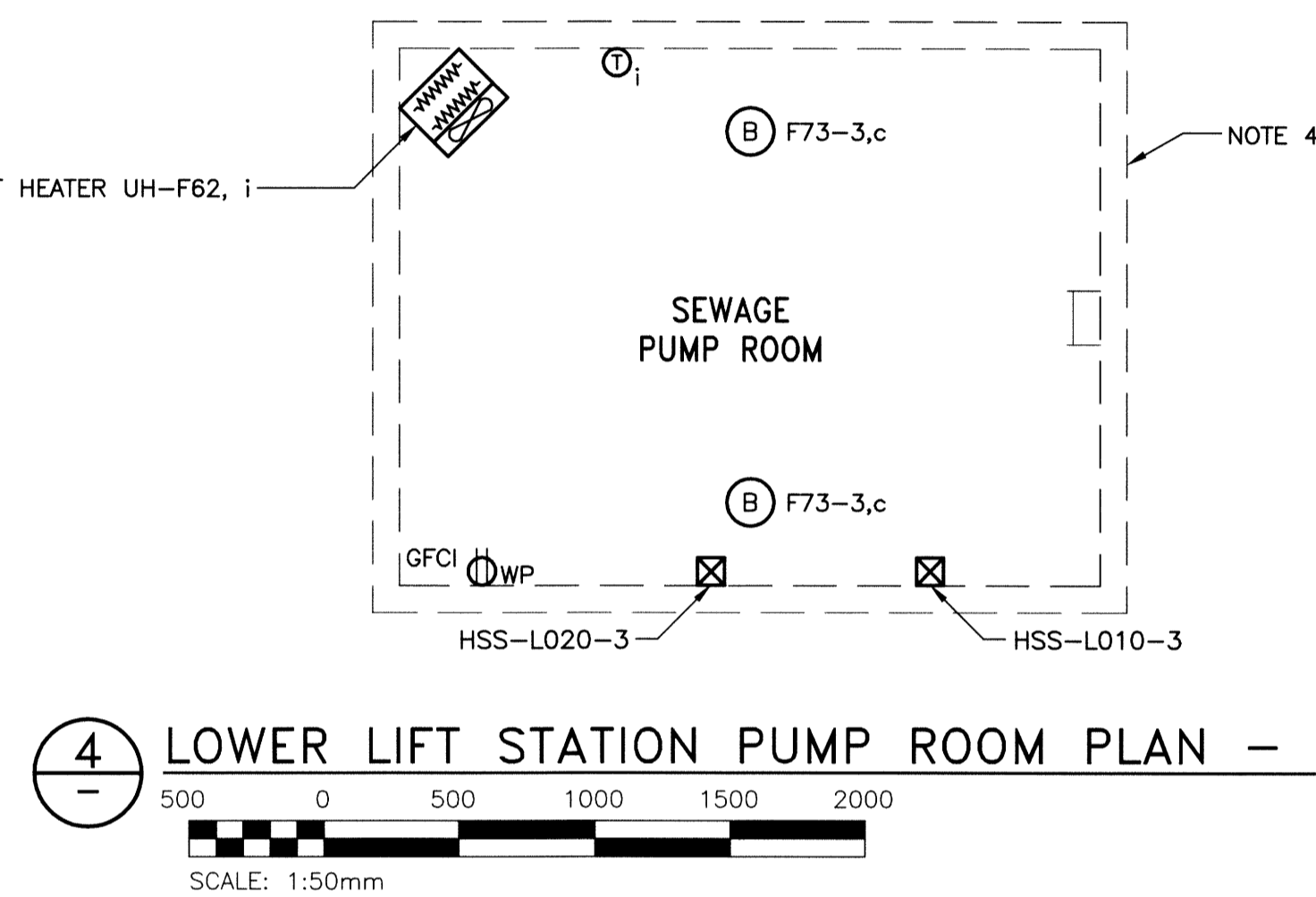

4 LOWER LIFT STATION PUMP ROOM PLAN - NEW
 SCALE: 1:50mm

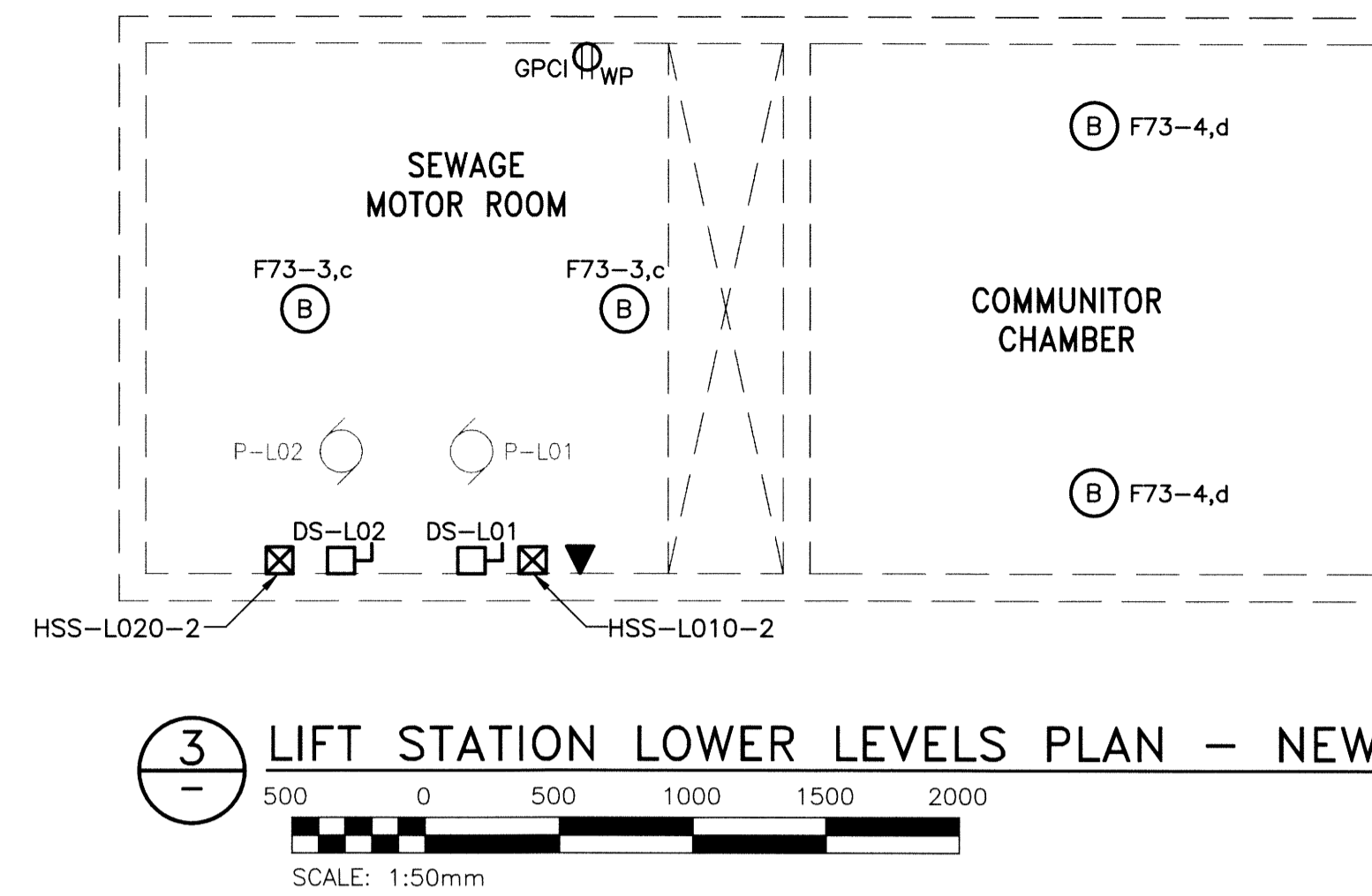
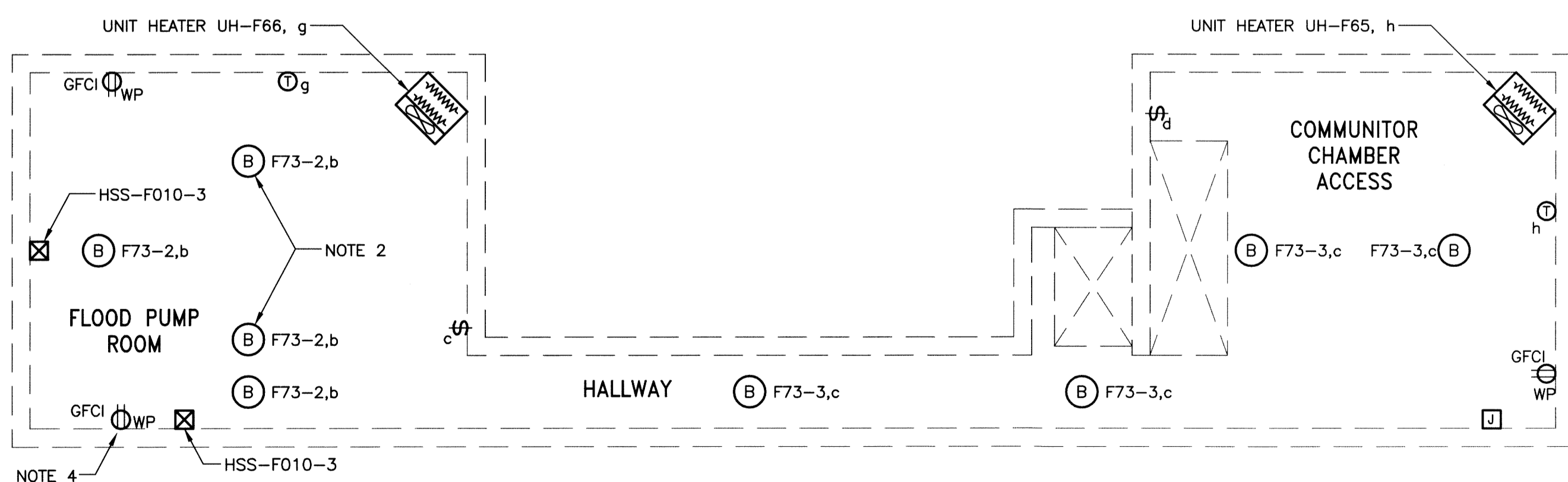

2 LOWER LEVELS PLAN - NEW
 SCALE: 1:50mm

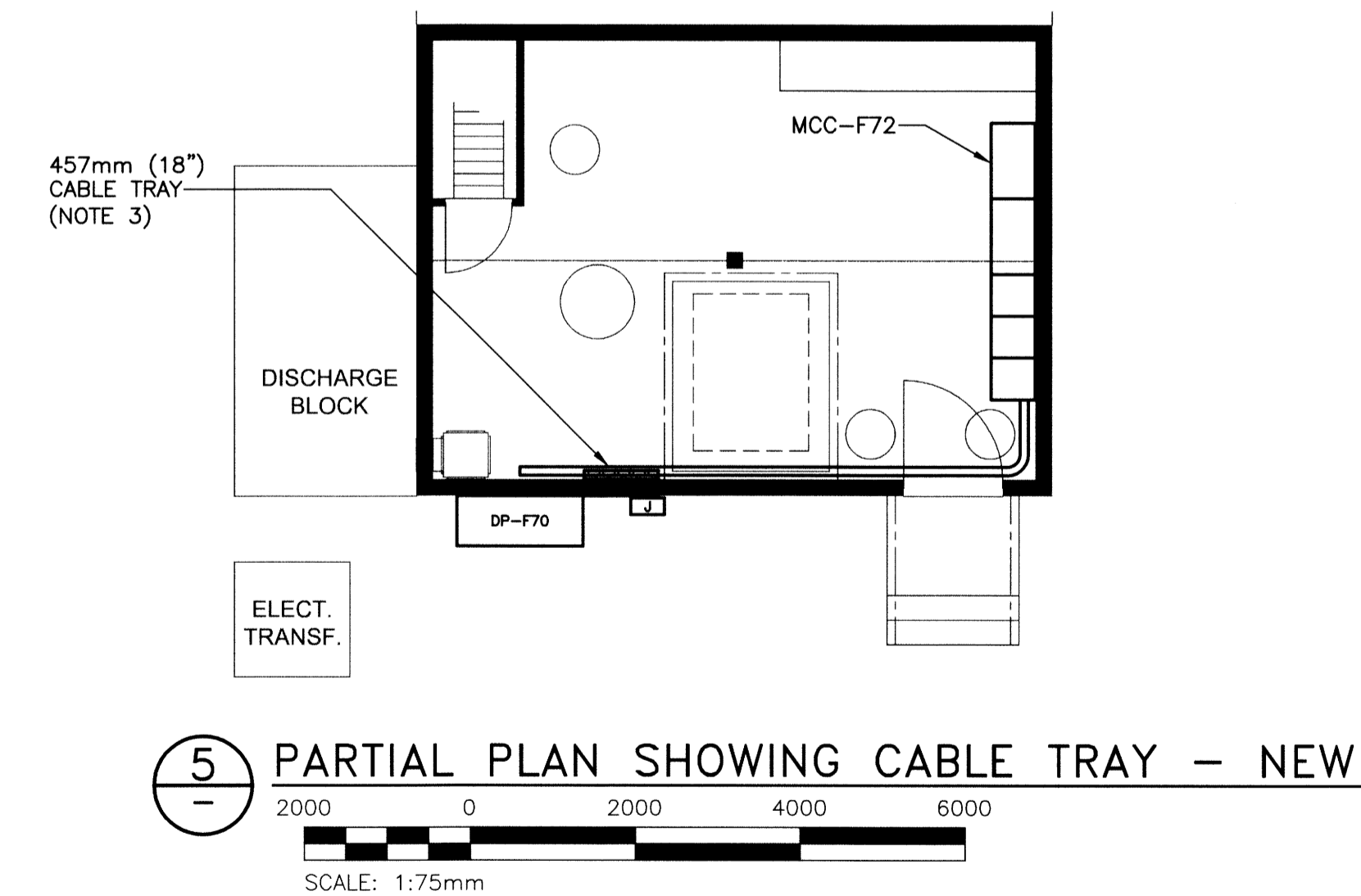

5 PARTIAL PLAN SHOWING CABLE TRAY - NEW
 SCALE: 1:75mm

NOTES:

- SUPPLY FAN IS ROOFTOP MOUNTED.
- LIGHT FIXTURES BELOW BEAM IN DRY WELL.
- INSTALL CABLE TRAY VERTICALLY ON WALL. ENSURE CABLE TRAY IS CLEAR OF ALL OTHER EQUIPMENT. FASTEN CABLES TO CABLE TRAY WITH CABLE CLAMPS.
- PROVIDE NEW SOLENOID VALVE AND PRESSURE SWITCH IN SEAL WATER PIPING FOR EACH FLOOD AND SEWAGE PUMP. WIRE BACK TO RTU.

LEGEND:

- 4' LED FIXTURE
- DENOTES:
- = CONTROLLING CIRCUIT
- = LUMINAIRE TYPE
- 240V RECEPTACLE
- DUPLEX RECEPTACLE
- TWIST-LOCK SINGLE RECEPTACLE
- SWITCH
- X DENOTES ITEM(S) CONTROLLED
- O DENOTES OCCUPANCY SWITCH
- JUNCTION BOX
- 1φ MOTOR LOAD
- 3φ MOTOR LOAD
- INCANDESCENT LIGHT
- a DENOTES CONTROLLING CIRCUIT
- LED LIGHT FIXTURE CERTIFIED FOR WET AREAS
- EMERGENCY LIGHTING BATTERY UNIT
- c/w 2 LG. HEADS
- REMOTE EMERGENCY LIGHTING HEADS
- TELEPHONE
- LOCAL DISCONNECT SWITCH
- EMERGENCY STOP PUSHBUTTON
- WELDING RECEPTACLE
- UNIT HEATER
- THERMOSTAT
- DENOTES: X = ITEM(S) CONTROLLED



FIELD BOOK #:		KGS GROUP CONSULTING ENGINEERS		ENGINEER'S SEAL
POSTED TO LBIS		DESIGNED BY DDW	CHECKED BY	
		DRAWN BY GCN	APPROVED BY	
		HDR. SCALE N.T.S.	RELEASED FOR CONSTRUCTION	D-E03
		VERTICAL N.T.S.		
0 ISSUED FOR CONSTRUCTION	14/12/15	AP	2014 01 13	
NO. REVISIONS	DATE	BY	DATE	

THE CITY OF WINNIPEG
 WATER AND WASTE DEPARTMENT

FLOOD PUMPING STATION UPGRADES
 DUMOULIN STATION
ELECTRICAL
 POWER, SYSTEMS AND LIGHTING PLAN

SHEET 1 OF 1
 CITY DRAWING NUMBER
 1-0139F-E0004-001