

MATCHLINE STATION 1+90

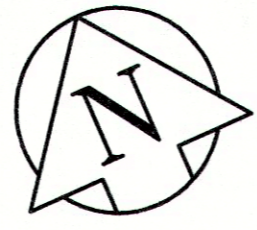

**REFERENCE NOTES**

- A. PAVEMENT DIMENSIONS ARE TO BACK OF CURB
- B. BASELINE IS CENTRE LINE RIGHT-OF-WAY
- C. PROPERTY LINES OBTAINED FROM CITY OF WINNIPEG L.B.I.S., AND NO SCALE FACTOR WAS APPLIED
- D. REFER TO AECOM FIELD BOOK NO. 4803

**CONSTRUCTION NOTES**

1. PLACE NEW ASPHALTIC PAVEMENT TYPE 1A (AVG THICKNESS 85mm)
2. REMOVE EXISTING CONCRETE PAVEMENT AND CONSTRUCT NEW 150mm REINFORCED CONCRETE PAVEMENT c/w 85mm ASPHALT OVERLAY
3. REMOVE EXISTING CONCRETE PAVEMENT AND CONSTRUCT NEW 150mm REINFORCED CONCRETE PAVEMENT
4. REMOVE EXISTING FRAME AND COVER AND INSTALL NEW FRAME AND COVER (AP-005 AND AP-004)
5. ADJUST EXISTING MANHOLE/CATCH BASIN TO GRADE
6. INSTALL NEW CAST IRON RISER RING
7. REMOVE EXISTING MOUNTABLE CURB AND CONSTRUCT NEW BARRIER CURB (100mm HT. DOWELLED)
8. REMOVE EXISTING CURB AND CONSTRUCT NEW MODIFIED BARRIER CURB (150mm HT. DOWELLED)
9. CONSTRUCT NEW BARRIER CURB (100mm HT. SEPARATE)
10. CONSTRUCT NEW CURB RAMP (10mm HT. INTEGRAL)
11. CONSTRUCT NEW BARRIER CURB (10mm REVEAL HT. DOWELLED)
12. REMOVE EXISTING CATCHBASIN AND ABANDON LEAD
13. INSTALL NEW CURB AND GUTTER INLET c/w CATCHBASIN (SD-024) AND CONNECT NEW LEAD TO EXISTING 450 CONCRETE LDS
14. RENEW EXISTING 100mm CONCRETE SIDEWALK
15. ADJUST EXISTING WATER VALVE TO GRADE
16. ADJUST EXISTING CURB STOP TO GRADE
17. REMOVE EXISTING ASPHALTIC PAVEMENT
18. REMOVE AND REINSTALL EXISTING PAVERS

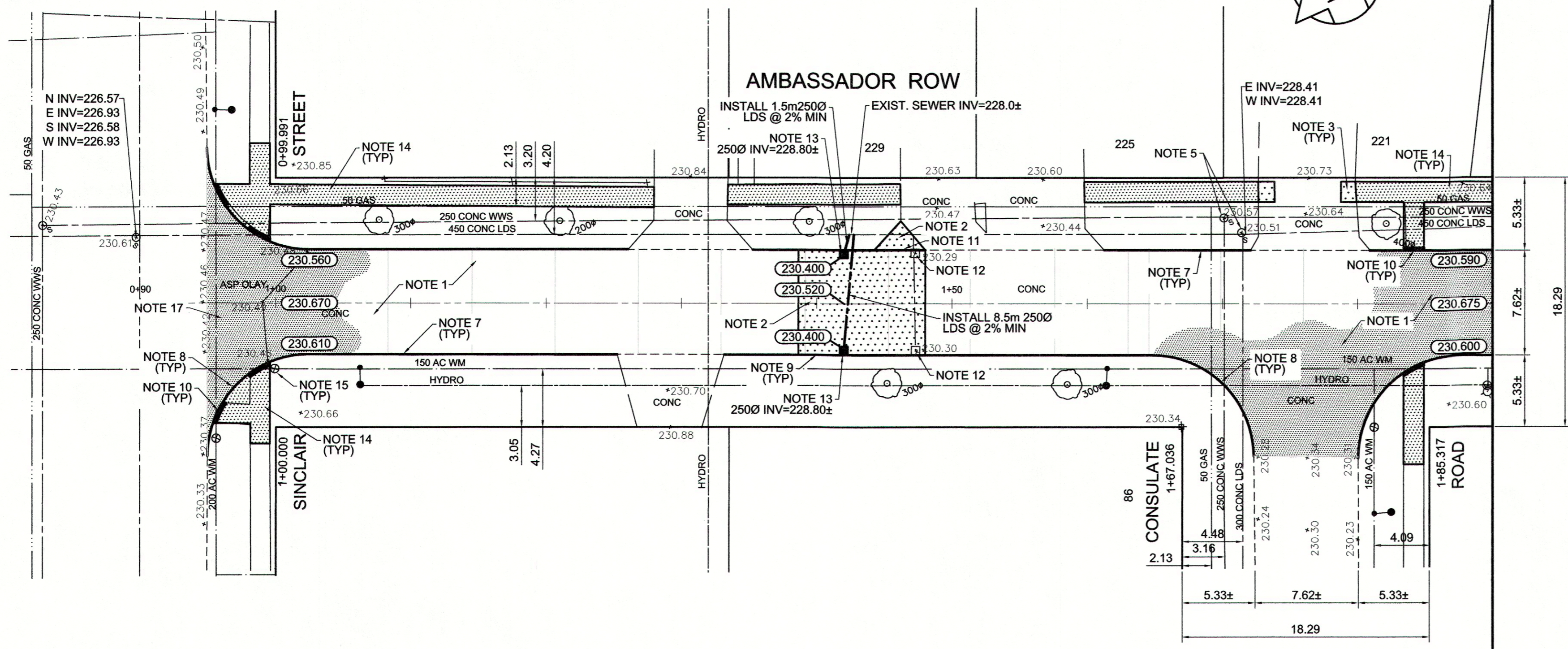

**METRIC**  
WHOLE NUMBERS INDICATE MILLIMETRES  
DECIMALIZED NUMBERS INDICATE METRES

EXISTING	LEGEND - PLAN	PROPOSED	EXISTING	LEGEND - PLAN	PROPOSED	EXISTING	LEGEND - PROFILE	PROPOSED
150 mm W.W.M.	WATERMAIN	150 mm W.W.M.	HYDRO	M.T.S.	CONCRETE	---	C PROFILE	---
300mm L.D.S.	LAND DRAINAGE SEWER	300mm L.D.S.	ASPHALT	PROPERTY LINE	---	---	NORTHWEST GUTTER	---
250mm W.W.S.	WASTEWATER SEWER	250mm W.W.S.	PROPERTY LINE	SURVEY BAR	---	---	SOUTHWEST GUTTER	---
○	MANHOLE	●	ELEVATION	(35.750)	---	---	N/W PROPERTY LINE	---
□	CATCH BASIN	■	TREE	---	---	---	S/E PROPERTY LINE	---
▽	CATCH PIT	▼	SIDEWALK RAMP	---	---	---	---	---
+	JUNCTIONS	+	CONCRETE SIDEWALK	---	---	---	---	---
▭	CULVERT	▭	FENCE	---	---	---	---	---
○	GAS	○	---	---	---	---	---	---

**LOCATION APPROVED UNDERGROUND STRUCTURES**

SUPV. U/G STRUCTURES COMMITTEE DATE

**NOTE:**  
LOCATION OF UNDERGROUND STRUCTURES AS SHOWN ARE BASED ON THE BEST INFORMATION AVAILABLE. BUT NO GUARANTEE IS GIVEN THAT ALL EXISTING UTILITIES ARE SHOWN OR THAT THE GIVEN LOCATIONS ARE EXACT. CONFIRMATION OF EXISTENCE AND EXACT LOCATION OF ALL SERVICES MUST BE OBTAINED FROM THE INDIVIDUAL UTILITIES BEFORE PROCEEDING WITH CONSTRUCTION.

B.M. ELEV.	81R913	S W corner Leila Ave & Diplomat Dr.	
	231.109	Tbl 0.02m S of S.L. Leila Ave & 5.1m E of W.L. Diplomat Dr.	
DESIGNED BY	BC/SS	CHECKED BY	KWR
DRAWN BY	PB/JT	APPROVED BY	
HOR. SCALE:	1:250	RELEASED FOR CONSTRUCTION BY:	
VERTICAL:	1:10	DATE:	Feb 10/14
ISSUED FOR TENDER	03/11/2014	BC	
ISSUED FOR REVIEW	02/28/2014	BC	
NO. REVISIONS		DATE	BY

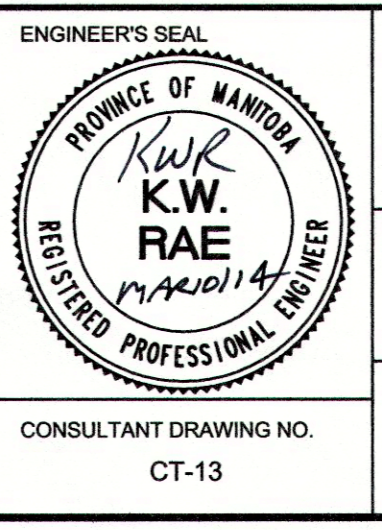

**THE CITY OF WINNIPEG**  
PUBLIC WORKS DEPARTMENT  
ENGINEERING DIVISION

2014 LOCAL STREET RENEWAL PROGRAM

AMBASSADOR ROW - SINCLAIR STREET TO LEILA AVENUE REHABILITATION  
SINCLAIR STREET TO STATION 1+90

CITY DRAWING NUMBER  
SHEET 13 OF 20

CONSULTANT DRAWING NO. CT-13