

PLAN AND SECTION
SCALE: 3/32" = 1'-0"

DETAIL PLAN - PUMP ROOM
SCALE: 1/4" = 1'-0"

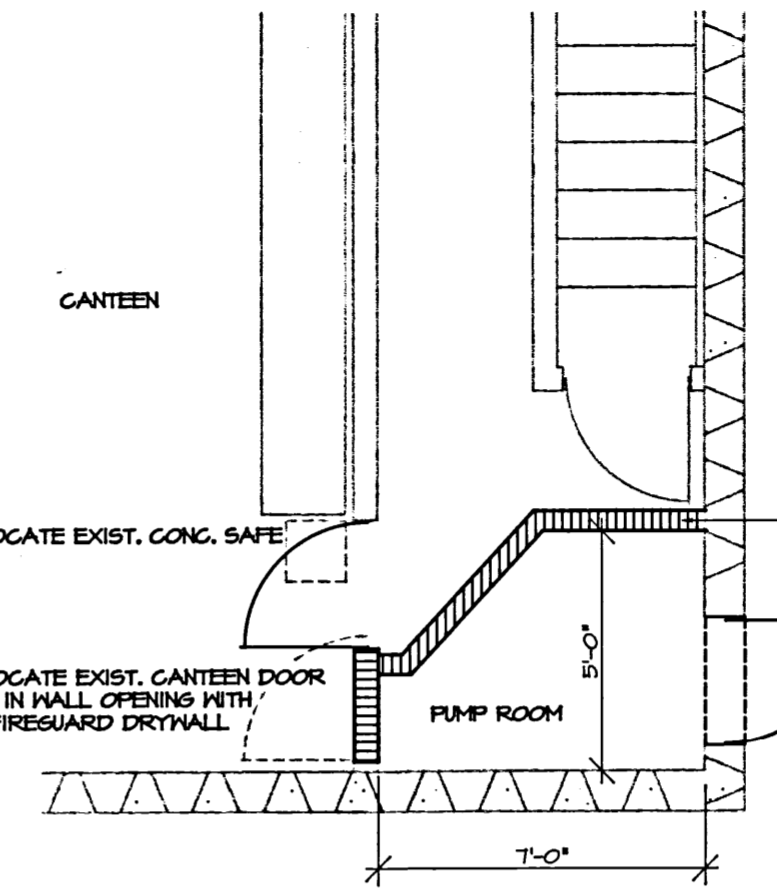

NOTES :

CONCRETE
ALL CONCRETE 30 mpa, 5% TO 7% AIR ENTRAINMENT. APPLY LIGHT BROOM FINISH TO ALL SURFACES.

CONTRACTOR SHALL ORDER SLUMP, CYLINDER, AND AIR TEST FOR EACH CONCRETE POUR. CHARGE COST OF TESTS TO CIVIC PROPERTIES ACCOUNT WITH NATIONAL TESTING LABORATORIES.

+ 59'-4" EXIST. ELEVATION
+ 59'-4" NEW ELEVATION

NEW WALL - 3/8" STEEL STUDS @ 16" O.C.
3/8" FIREGUARD BOTH SIDES TAPED
PAINTED BOTH SIDES - 3/8" FIREGUARD ON ALL
WALLS AND CEILING OF PUMP ROOM

CUT EXIST. 10" BLOCK WALL AND INSTALL
NEW COMMERCIAL STEEL DOOR C/W STEEL
FRAME, HINGES AND LOCKSET AS SPECIFIED.

NOTE: FOR MECHANICAL LAYOUT SEE DRWG. NO. 3

	GENERAL REVISIONS/CLARIFICATION	ROH 12/92
	REINFORCING STEEL REVISION	ROH 12/92
NO.	REVISION/DESCRIPTION	BY DATE
SEALS		

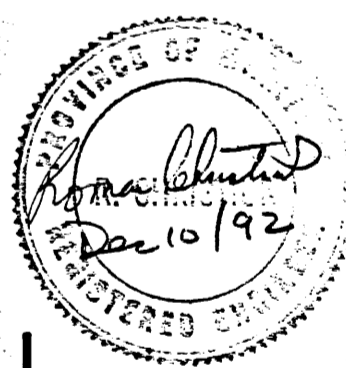

RECOMMENDED BY:
[Signature]
HEAD OF USER GROUP
[Signature]
MANAGER COMMUNITY PARKS AND RECREATION
[Signature]
DIRECTOR PLANNING AND DEVELOPMENT
PARKS AND RECREATION
[Signature]
DIRECTOR RECREATION AND COMMUNITY PARKS
[Signature]
MANAGER DEVELOPMENT CIVIC PROPERTIES

APPROVED BY:
[Signature]
GENERAL MANAGER PARKS AND RECREATION
[Signature]
DIRECTOR CIVIC PROPERTIES

DRAWN BY ROH | CHECKED BY | APPROVED
DATE NOV. 92 | USER APPROVAL

THE CITY OF WINNIPEG
CIVIC PROPERTIES DEPARTMENT
400-180 KING ST. R3B 3G8

PROJECT
**WEST KILDONAN C.C.
WADING POOL
346 PERTH AVE.**

SHEET TITLE

PLAN AND NOTES

SCALE AS SHOWN	PROJECT NO. 42-502	SHEET NO. 1 0348PE01
-------------------	-----------------------	----------------------------