

**ACCESS ROAD SECTION
(STA 1+50 TO STA 9+70)**

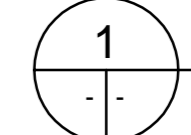

HOR 1:300, VER 1:100

NOTE:
DITCH AND SLOPE ELEVATIONS SHOWN ARE FINAL ELEVATIONS THAT INCLUDE ADDITION OF 50mm OF SOIL AMENDED MATERIAL.

NOTE:
DITCHES HAVE BEEN ROUGH GRADED BY OTHERS. CONTRACTOR TO FINISH GRADE DITCHES TO DESIGN ELEVATIONS.

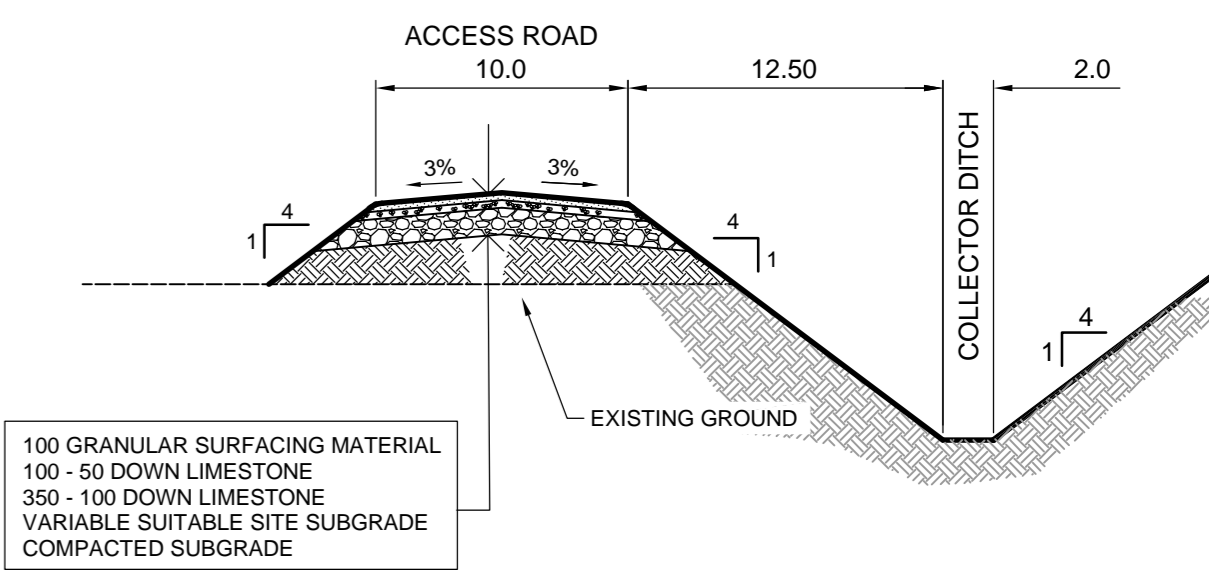

**ACCESS ROAD SECTION
(STA 9+70 TO STA 11+60)**

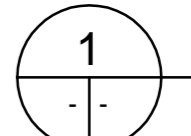

HOR 1:300, VER 1:100

NOTE:
DITCH AND SLOPE ELEVATIONS SHOWN ARE FINAL ELEVATIONS THAT INCLUDE ADDITION OF 50mm OF SOIL AMENDED MATERIAL.

NOTE:
DITCHES HAVE BEEN ROUGH GRADED BY OTHERS. CONTRACTOR TO FINISH GRADE DITCHES TO DESIGN ELEVATIONS.

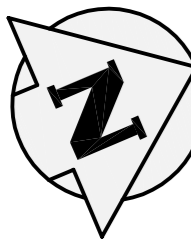

PROPOSED LANDFILL ROAD ALIGNMENT CURVE TABLE

CURVE ID	RADIUS	LENGTH	TANGENT	DELTA	BC NORTHING, EASTING	EC NORTHING, EASTING	START STATION	END STATION
C102	74.00	125.71	84.13	97.33	N5514197.83, E629332.53	N5514287.14, E629398.66	9+41.62	10+67.33

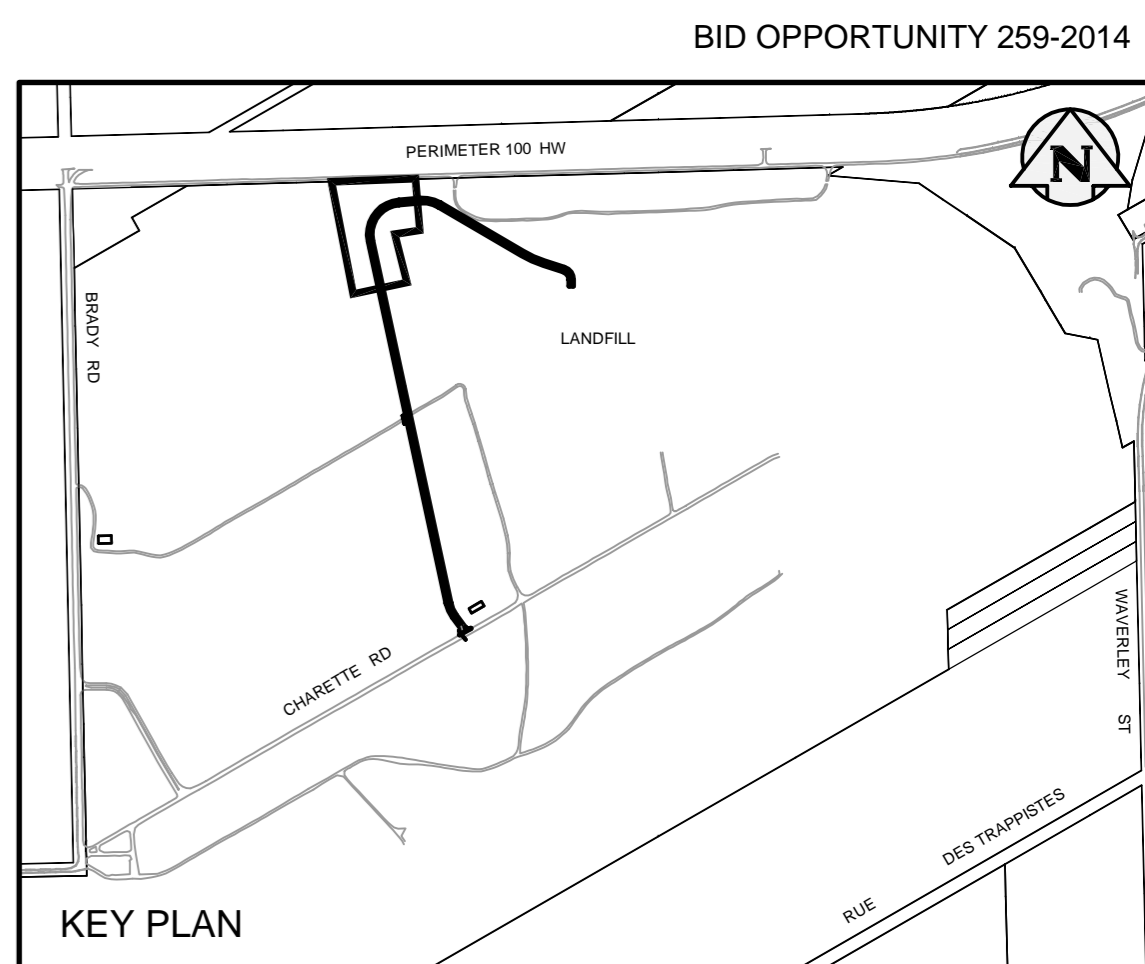
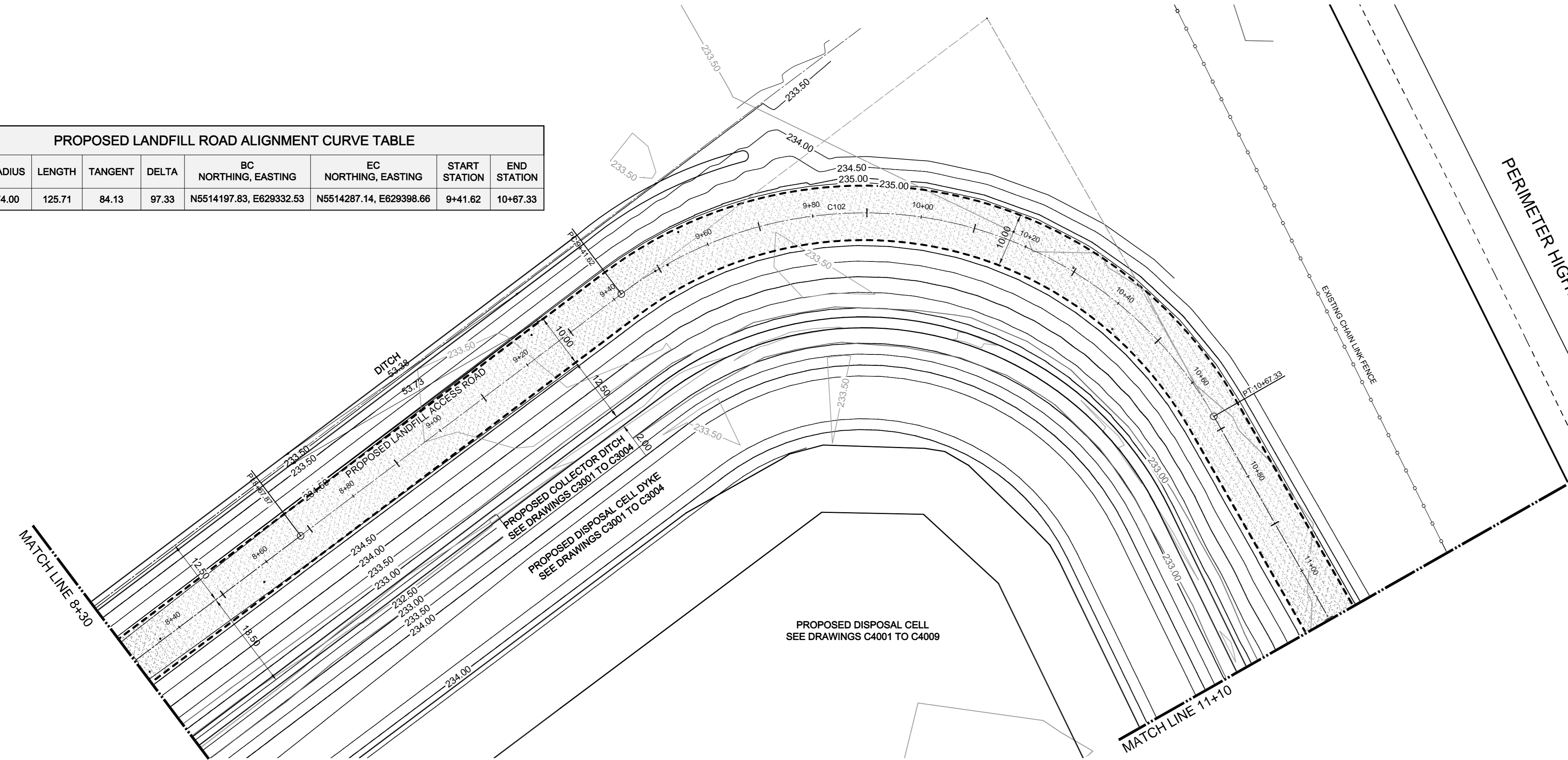

BID OPPORTUNITY 259-2014

EXISTING	LEGEND-PLAN	PROPOSED	EXISTING	LEGEND-PLAN	PROPOSED	EXISTING	LEGEND-PLAN	PROPOSED

APEGM
Certificate of Authorization
TETRA TECH WEI Inc.
No. 5313 Date: April 30, 2014

TETRA TECH

DESIGNED BY SV
DRAWN BY GMD
HOR. SCALE: 1:500
VERTICAL: 1:50
DATE 13.11.25

CHECKED BY GS, GC
APPROVED BY BLM
RELEASED FOR CONSTRUCTION
DATE

B.M. ELEV.

ISSUED FOR TENDER 14.03.26 GC
NO. REVISIONS DATE BY

PROVINCE OF MANITOBA
G.A. CHURCHILL
Member 25653
REGISTERED PROFESSIONAL ENGINEER

CONSULTANT DRAWING NO.
1300120600-DWG-C0005

THE CITY OF WINNIPEG
WATER AND WASTE DEPARTMENT

BRADY ROAD LANDFILL ACCESS ROAD AND DISPOSAL CELL
NEW PERIMETER LANDFILL ROAD
STATION 8+30 TO STATION 11+10

CITY DRAWING NUMBER
SWD-D-432
SHEET 5 OF 20
C2004