

NOTE: CHAINAGES SHOWN ARE ALONG E.  $\ell$  OF ROCH ST

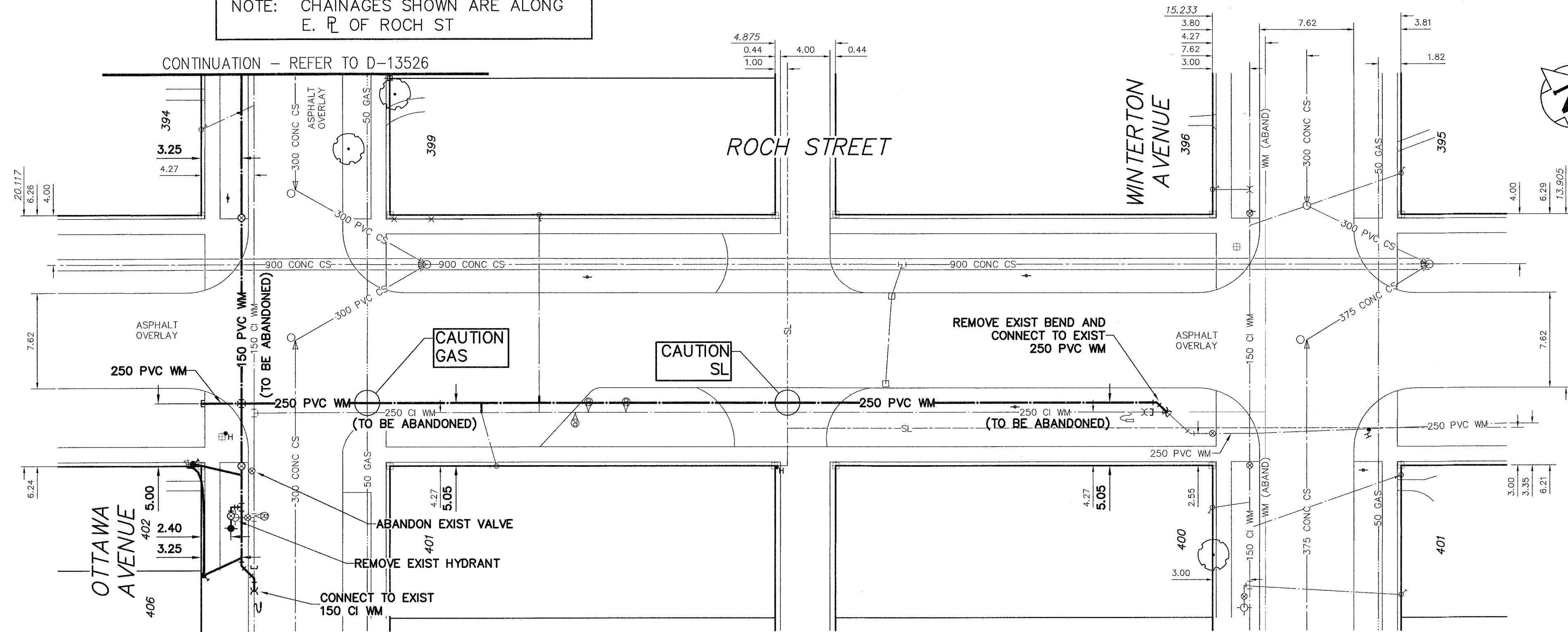

**WATER SERVICE INFORMATION**

ADDRESS	SIZE (mm) (STREET)	SIZE (mm) (PROP.)	SHORT & LONG MEASUREMENT	CORPORATION LOCATION	REMARKS
399 OTTAWA AV	-	12	4.6 N S HSE LINE		S/C: OFF ROCH
401 OTTAWA AV	20	12	4.6 S N HSE LINE	1.2 S S/C	
RESIDENTIAL	CU	LEAD			

**NOTE:** REPLACE ALL EXISTING LEAD SERVICES FROM THE PROPOSED WATERMAIN TO PROPERTY LINE. RECONNECT ALL OTHER SERVICES UNLESS NOTED. LOCATION OF WATER SERVICES SHOWN ON DRAWINGS ARE APPROXIMATE. THE CONTRACTOR SHALL FIELD LOCATE ALL WATER SERVICES PRIOR TO CONSTRUCTION.



ALL VALVES TO BE COUNTER-CLOCKWISE TO CLOSE (RED OPERATING NUT)

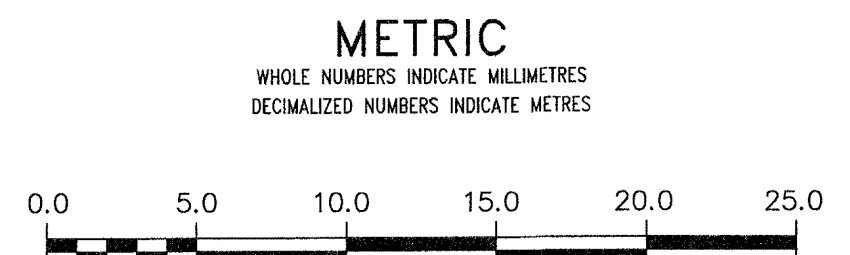

**WARNING**  
IF POWER EQUIPMENT OR EXPLOSIVES ARE TO BE USED FOR EXCAVATION ON THIS PROJECT THE CONTRACTOR MUST:  
1) NOTIFY THE GAS COMPANY OF THE PROPOSED LOCATION OF EXCAVATION.  
2) TAKE PRECAUTION TO AVOID DAMAGE TO GAS COMPANY INSTALLATIONS.  
SEE PROVINCIAL REGULATION 210/72 FOR DETAILS

**LOCATION APPROVED**  
UNDERGROUND STRUCTURES  
SUPV. U/G STRUCTURES COMMITTEE DATE  
NOTE:  
LOCATION OF UNDERGROUND STRUCTURES AS SHOWN ARE BASED ON THE BEST INFORMATION AVAILABLE BUT NO GUARANTEE IS GIVEN THAT ALL EXISTING UTILITIES ARE SHOWN OR THAT THE GIVEN LOCATIONS ARE EXACT. CONFIRMATION OF EXISTENCE AND EXACT LOCATION OF ALL SERVICES MUST BE OBTAINED FROM THE INDIVIDUAL UTILITIES BEFORE PROCEEDING WITH CONSTRUCTION.

B.M. 27-021  
ELEV. 230.493m  
85R629-S.W. Cor. Roch St. & Munroe Ave., Tbl. on top of 0.05 m dia. x 2.4 m iron pipe, 4.2 m E. of W.

NO.	REVISIONS	DATE	BY
0	ISSUED FOR TENDER	14/03/25	GSK
A	ISSUED FOR REVIEW	14/03/19	GSK

**AECOM**

DESIGNED BY: GK  
CHECKED BY: [Signature]  
DRAWN BY: JP  
APPROVED BY: [Signature]  
RELEASED FOR CONSTRUCTION: [Signature]  
DATE: [Blank]

SCALE:  
HORIZONTAL: 1:250  
VERTICAL: 1:50

PLOT DATE: 2014 03 20

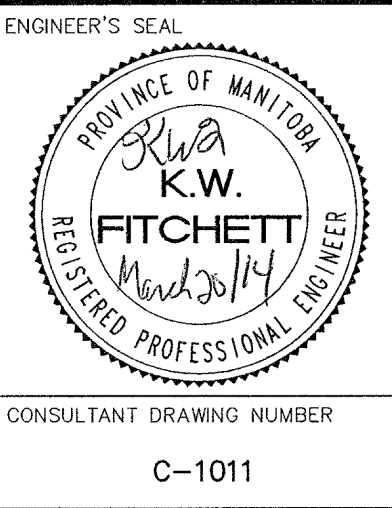

**THE CITY OF WINNIPEG**  
WATER AND WASTE DEPARTMENT  
ENGINEERING DIVISION

2014 WATERMAIN RENEWALS  
CONTRACT 2  
ROCH STREET  
OTTAWA AVENUE TO  
WINTERTON AVENUE

SHEET 12 OF 15  
CITY DRAWING NUMBER  
D-13527

CONSULTANT DRAWING NUMBER: C-1011