

NOTE: CHAINAGES SHOWN ARE ALONG
 C OF EASEMENT E-784

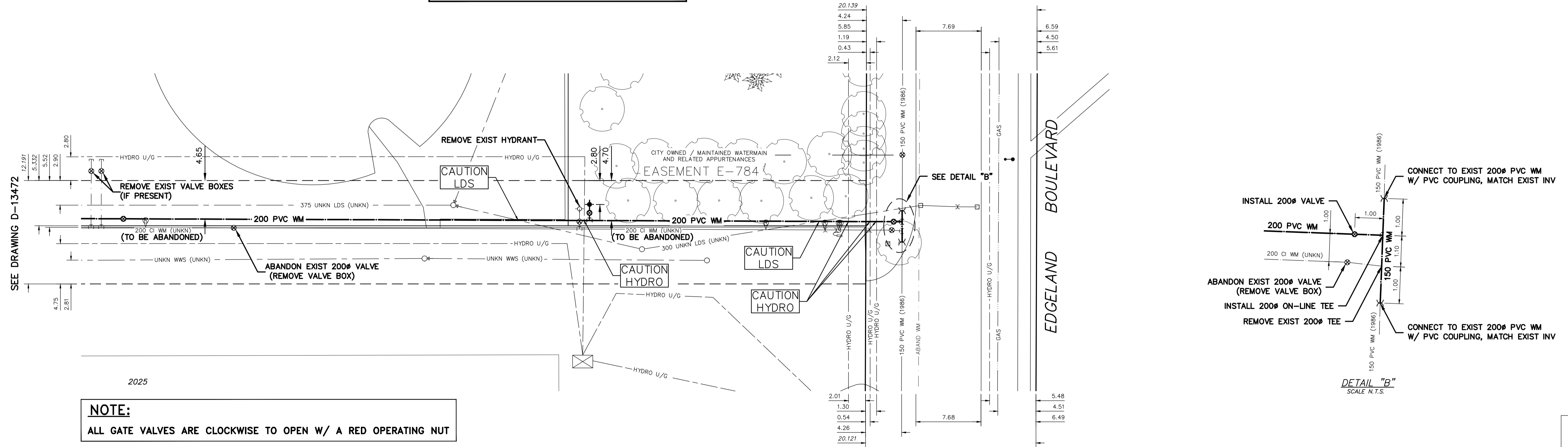

NOTE:
 ALL GATE VALVES ARE CLOCKWISE TO OPEN W/ A RED OPERATING NUT

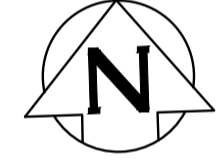
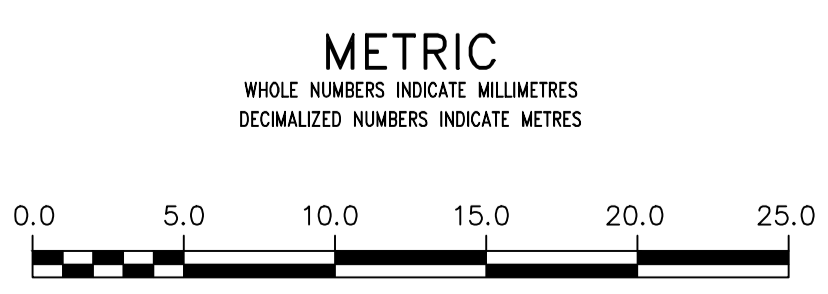

WARNING
 IF POWER EQUIPMENT OR EXPLOSIVES ARE TO BE USED FOR EXCAVATION ON THIS PROJECT THE CONTRACTOR MUST:
 1) NOTIFY THE GAS COMPANY OF THE PROPOSED LOCATION OF EXCAVATION.
 2) TAKE PRECAUTION TO AVOID DAMAGE TO GAS COMPANY INSTALLATIONS.
 SEE PROVINCIAL REGULATION 2107/2 FOR DETAILS

LOCATION APPROVED
 UNDERGROUND STRUCTURES
 SUPV. U/G STRUCTURES COMMITTEE DATE
 NOTE:
 LOCATION OF UNDERGROUND STRUCTURES AS SHOWN ARE BASED ON THE BEST INFORMATION AVAILABLE BUT NO GUARANTEE IS GIVEN THAT ALL EXISTING UTILITIES ARE SHOWN OR THAT THE GIVEN LOCATIONS ARE EXACT. CONFIRMATION OF EXISTENCE AND EXACT LOCATION OF ALL SERVICES MUST BE OBTAINED FROM THE INDIVIDUAL UTILITIES BEFORE PROCEEDING WITH CONSTRUCTION.

B.M. ELEV.	CONSTRUCTION COMPLETION DATE: YYYY MM DD		
2	BID OPPORTUNITY 293-2014	MARCH/14	P.R.
1	DESIGN REVIEW W & W	MARCH/14	P.R.
NO.	REVISIONS	DATE	BY

WSP
 1600 BUFFALO PLACE
 WINNIPEG, MB, R3T 6B8
 PHONE: 204-477-6650
 FAX: 204-474-2864
 WWW.WSPGROUP.COM

DESIGNED BY	M.B.S.	CHECKED BY	S.M.
DRAWN BY	M.B.S.	APPROVED BY	I.McK.
SCALE:	HORIZONTAL 1:250 VERTICAL 1:50		
DATE	2014 03 25	DATE	2014 03 21

ENGINEER'S SEAL
 PROVINCE OF MANITOBA
 REGISTERED PROFESSIONAL ENGINEER
 I. G. McKINNON

CONSULTANT DRAWING NUMBER
 141-13425-00-09

THE CITY OF WINNIPEG
 WATER AND WASTE DEPARTMENT
 ENGINEERING DIVISION

2014 WATERMAIN RENEWALS
 ROW BETWEEN TUXEDO AVENUE AND EDGELAND BOULEVARD
 100 M EEL OF TUXEDO AVENUE TO EDGELAND BOULEVARD

SHEET 2 OF 2
 CITY DRAWING NUMBER
 D-13473