

CONSTRUCTION NOTES:

1. ALL DIMENSIONS ARE TO BACK OF CURB.
2. ISOLATE MISCELLANEOUS ITEMS IN NEW CONCRETE WORKS AS PER SD-228C.
3. LEGAL PLAN AND UNDERGROUND INFORMATION FROM CITY OF WINNIPEG LBIS. CONTRACTOR TO VERIFY ALL UNDERGROUNDS IN THE FIELD.
4. CONTRACTOR TO TAKE PRECAUTIONARY STEPS TO AVOID DAMAGE FROM CONSTRUCTION ACTIVITIES TO TREES WITHIN THE LIMITS OF CONSTRUCTION.
5. LOCATION OF EXISTING SERVICES TO BE CONFIRMED IN THE FIELD BY THE CONTRACTOR.
6. CB LEADS TO BE INSTALLED AT MIN. 1.0% SLOPE OR AS DIRECTED BY CONTRACT ADMINISTRATOR.
7. LIMITS OF SIDEWALK RENEWAL TO BE FINALIZED IN THE FIELD BY THE CONTRACT ADMINISTRATOR.
8. LIMITS OF BOULEVARD GRADING TO BE FINALIZED IN THE FIELD BY THE CONTRACT ADMINISTRATOR.

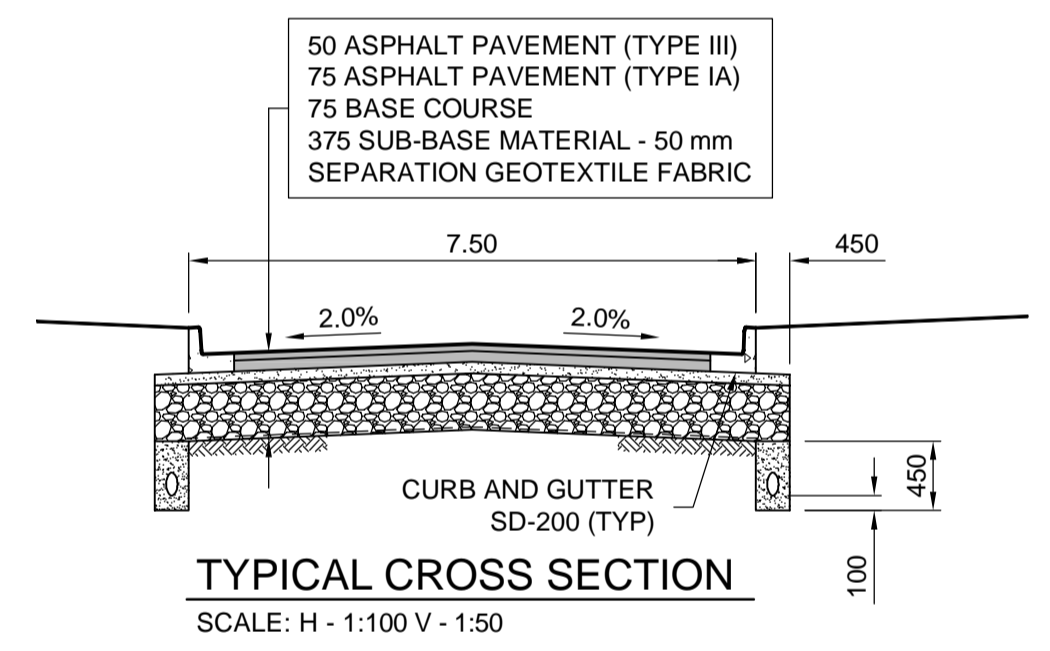
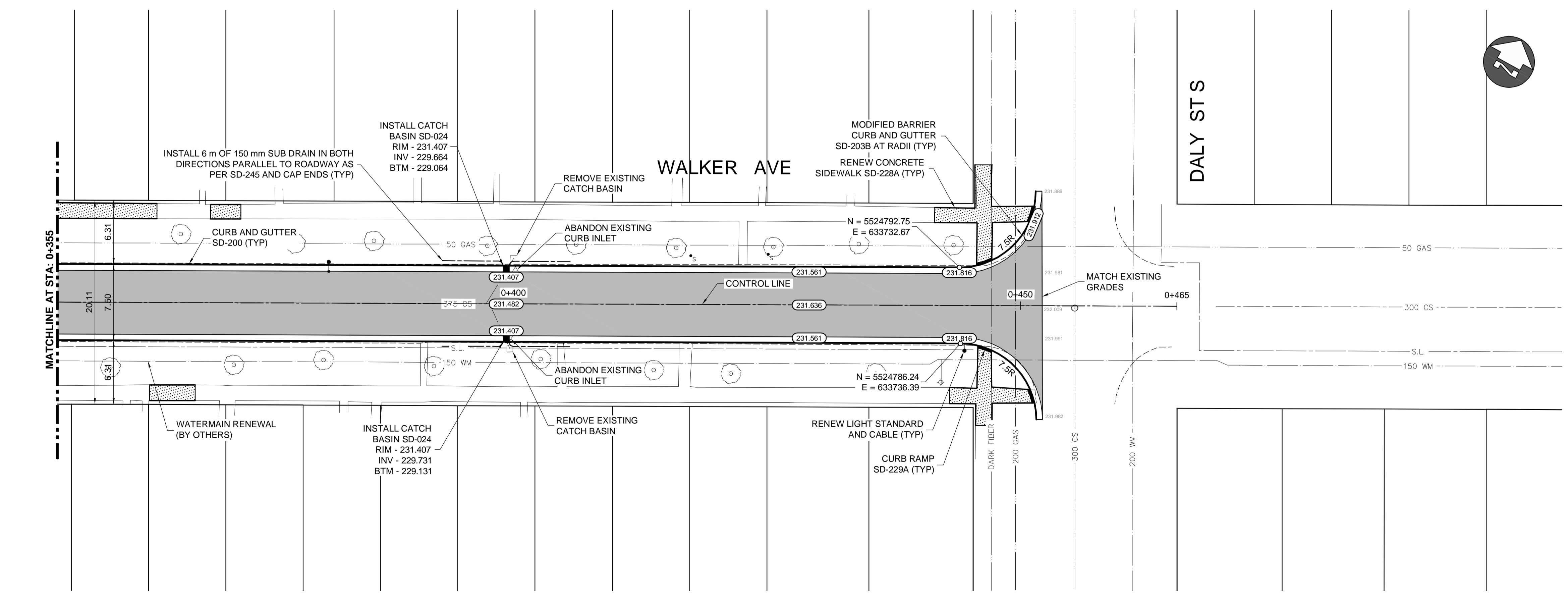

METRIC

WHOLE NUMBERS INDICATE MILLIMETRES
DECIMALIZED NUMBERS INDICATE METRES

WARNING

IF POWER EQUIPMENT OR EXPLOSIVES ARE TO BE USED FOR EXCAVATION ON THIS PROJECT THE CONTRACTOR MUST:

1. NOTIFY THE GAS COMPANY OF THE PROPOSED LOCATION OF EXCAVATION.
2. TAKE PRECAUTION TO AVOID DAMAGE TO GAS COMPANY INSTALLATIONS SEE PROVINCIAL REGULATION 210/72 FOR DETAILS.
3. OBTAIN EXCAVATION PERMITS PRIOR TO CONSTRUCTION.



Certificate of Authorization
Dillon Consulting Limited (MB)
No. 1789 Date: 04/22/2014

G:\CAD\138775\Contract\Plan-Profile-Walker.dwg

EXISTING	LEGEND-PLAN	PROPOSED	EXISTING	LEGEND-PLAN	PROPOSED	EXISTING	LEGEND-PROFILE	PROPOSED
150 WM	WATERMAIN	150 WM	HYDRO	HYDRO	HYDRO	150 WM	WATERMAIN	150 WM
300 LDS	HYDRANT VALVE	300 LDS	MTS	M.T.S.	MTS	300 LDS	HYDRANT VALVE	300 LDS
250 WWS	LAND DRAINAGE SEWER	250 WWS	CONCRETE	CONCRETE	CONCRETE	250 WWS	WASTE WATER SEWER	250 WWS
MANHOLE	WASTE WATER SEWER	MANHOLE	ASPHALT	ASPHALT	ASPHALT	MANHOLE	LAND DRAINAGE SEWER	MANHOLE
CATCH BASIN	MANHOLE	CATCH BASIN	PLANING	PLANING	PLANING	CATCH BASIN	WASTE WATER SEWER	CATCH BASIN
CURB INLET	CATCH BASIN	CURB INLET	SIDEWALK	SIDEWALK	SIDEWALK	CURB INLET	LAND DRAINAGE SEWER	CURB INLET
JUNCTIONS	CURB INLET	JUNCTIONS	PAVING STONES	PAVING STONES	PAVING STONES	JUNCTIONS	WASTE WATER SEWER	JUNCTIONS
CULVERT	JUNCTIONS	CULVERT	PARTIAL DEPTH REPAIR	PARTIAL DEPTH REPAIR	PARTIAL DEPTH REPAIR	CULVERT	LAND DRAINAGE SEWER	CULVERT
100 GAS	CULVERT	100 GAS	PROPERTY LINE	PROPERTY LINE	PROPERTY LINE	100 GAS	WASTE WATER SEWER	100 GAS
EXISTING	LEGEND-PLAN	PROPOSED	DRAINAGE ARROW	DRAINAGE ARROW	DRAINAGE ARROW	EXISTING	LAND DRAINAGE SEWER	EXISTING
			CURB RAMP	CURB RAMP	CURB RAMP		WASTE WATER SEWER	

UNDERGROUND STRUCTURES		B.M. ELEV.	DESIGNED BY
SUPV. U/G STRUCTURES	DATE		AMC
2	ISSUED FOR TENDER	04/22/14	TJH
1	ISSUED FOR REVIEW	04/04/14	TJH
NO.	REVISIONS	DATE	BY

CHECKED BY	ORIGINAL SIGNED BY	APPROVED BY	ORIGINAL SIGNED BY
TARAN J. PETERS	TARAN J. PETERS	DAVID B. WIEBE	DAVID B. WIEBE
HOR. SCALE	1:250	RELEASED FOR CONSTRUCTION	DATE
VERTICAL	1:10		
DATE	04/22/2014		

DILLON CONSULTING

ENGINEER'S SEAL
PROVINCE OF MANITOBA
REGISTERED PROFESSIONAL ENGINEER
T.J. PETERS
04/22/2014
Member 22309

THE CITY OF WINNIPEG
PUBLIC WORKS DEPARTMENT

2014 RESIDENTIAL STREET RENEWAL PROGRAM

PLAN-PROFILE - WALKER AVENUE - STA. 0+375 TO DALY STREET SOUTH

CITY DRAWING NUMBER
SHEET 11 OF 14
CONSULTANT DRAWING NUMBER

CONSULTANT PROJECT NUMBER
13-8775