

CONSTRUCTION NOTES:

- SEWER INSTALLATION BY TRENCHLESS METHODS.
- LEGAL PLAN AND UNDERGROUND INFORMATION FROM CITY OF WINNIPEG LBIS. CONTRACTOR TO VERIFY ALL UNDERGROUNDS IN THE FIELD.
- CONTRACTOR TO TAKE PRECAUTIONARY STEPS TO AVOID DAMAGE FROM CONSTRUCTION ACTIVITIES TO TREES WITHIN THE LIMITS OF CONSTRUCTION.
- LOCATION OF EXISTING SERVICES TO BE CONFIRMED IN THE FIELD BY THE CONTRACTOR.
- CB LEADS TO BE INSTALLED AT MIN. 1.0% SLOPE OR AS DIRECTED BY CONTRACT ADMINISTRATOR.
- MANITOBA HYDRO TO INSTALL TEMPORARY OVERHEAD STREET LIGHTING CABLE AND DE-ENERGIZE UNDERGROUND STREET LIGHTING CABLE. INSTALLATION OF LDS SHALL NOT COMMENCE UNTIL UNDERGROUND STREET LIGHTING HAS BEEN DE-ENERGIZED.

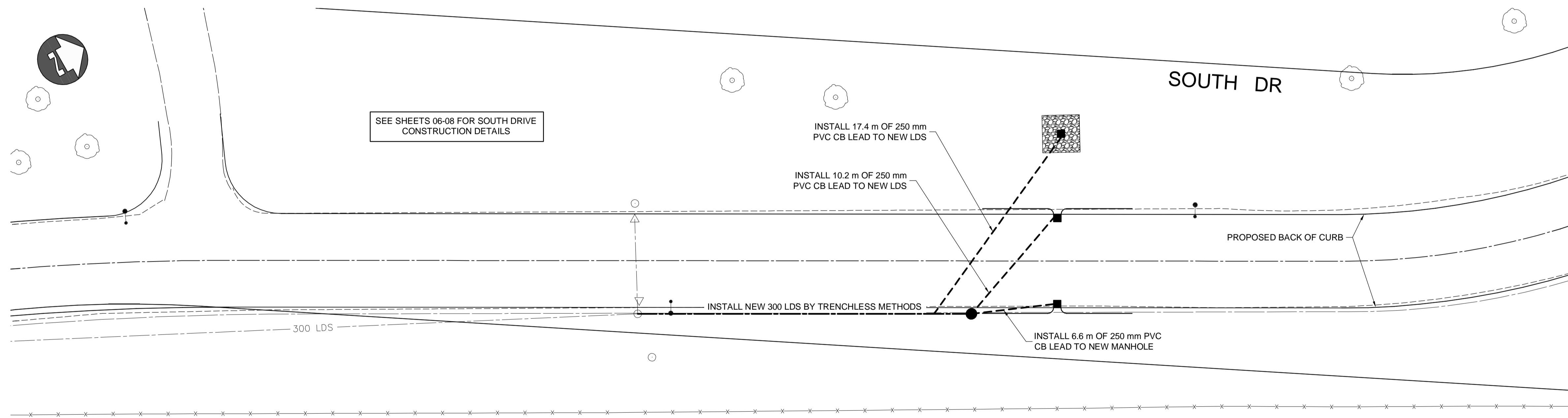

METRIC

WHOLE NUMBERS INDICATE MILLIMETRES
DECIMALIZED NUMBERS INDICATE METRES

WARNING

IF POWER EQUIPMENT OR EXPLOSIVES ARE TO BE USED FOR EXCAVATION ON THIS PROJECT THE CONTRACTOR MUST:

- NOTIFY THE GAS COMPANY OF THE PROPOSED LOCATION OF EXCAVATION.
- TAKE PRECAUTION TO AVOID DAMAGE TO GAS COMPANY INSTALLATIONS SEE PROVINCIAL REGULATION 210/72 FOR DETAILS.
- OBTAIN EXCAVATION PERMITS PRIOR TO CONSTRUCTION.



Certificate of Authorization
Dillon Consulting Limited (MB)
No. 1789 Date: 04/22/2014

150 WM	WATERMAIN	150 WM	HYDRO	HYDRO	HYDRO	150 WM	WATERMAIN	150 WM
+	HYDRANT	+	MTS	MTS	+	+	HYDRANT	+
+	VALVE	+	MTS	MTS	+	+	VALVE	+
300 LDS	LAND DRAINAGE SEWER	300 LDS		CONCRETE	300 LDS	300 LDS	LAND DRAINAGE SEWER	300 LDS
250 WWS	WASTE WATER SEWER	250 WWS		ASPHALT	250 WWS	250 WWS	WASTE WATER SEWER	250 WWS
○	MANHOLE	●		PLANING	○	○	PROFILE	○
□	CATCH BASIN	■		SIDEWALK	□	□	NORTH/WEST GUTTER	□
▽	CURB INLET	▽		PAVING STONES	▽	▽	SOUTH/EAST GUTTER	▽
+	JUNCTIONS	+		PARTIAL DEPTH REPAIR	+	+	NORTH/WEST DITCH	+
+	CULVERT	+		PROPERTY LINE	+	+	SOUTH/EAST DITCH	+
100 GAS	GAS	100 GAS		DRAINAGE ARROW	+	+		+
+		+		CURB RAMP	+	+		+
EXISTING	LEGEND-PLAN	PROPOSED	EXISTING	LEGEND-PLAN	PROPOSED	EXISTING	LEGEND-PROFILE	PROPOSED

UNDERGROUND STRUCTURES	B.M. ELEV.	DATE
SUPV. U/G STRUCTURES		
LOCATION OF UNDERGROUND STRUCTURES AS SHOWN ARE BASED ON THE BEST INFORMATION AVAILABLE, BUT NO GUARANTEE IS GIVEN THAT ALL EXISTING UTILITIES ARE SHOWN OR THAT THE GIVEN LOCATIONS ARE EXACT. CONFIRMATION OF EXISTENCE AND EXACT LOCATION OF ALL SERVICES MUST BE OBTAINED FROM THE INDIVIDUAL UTILITIES BEFORE PROCEEDING WITH CONSTRUCTION.		

NO.	REVISIONS	DATE	BY
2	ISSUED FOR TENDER	04/22/14	TJP
1	ISSUED FOR REVIEW	04/04/14	TJP

DESIGNED BY	AMC
DRAWN BY	TJH
CHECKED BY	ORIGINAL SIGNED BY TARAN J. PETERS
APPROVED BY	ORIGINAL SIGNED BY DAVID B. WIEBE
HOR. SCALE	1:500
VERTICAL	
DATE	04/22/2014

DILLON CONSULTING

RELEASED FOR CONSTRUCTION

DATE

ENGINEER'S SEAL

PROVINCE OF MANITOBA

REGISTERED PROFESSIONAL ENGINEER

T.J. PETERS
04/22/2014
Member
22309

CONSULTANT PROJECT NUMBER
13-8775

THE CITY OF WINNIPEG
PUBLIC WORKS DEPARTMENT

2014 RESIDENTIAL STREET RENEWAL PROGRAM

LAND DRAINAGE SEWER - SOUTH DRIVE

CITY DRAWING NUMBER

SHEET 14 OF 14

CONSULTANT DRAWING NUMBER

GA\CAD\138775\Contract\LDS-South-Dr.dwg