

**SITE DRAINAGE OUTLET PLAN**  
 SCALE: HOR=1:400

MANHOLE/CB LAYOUT CO-ORDINATES			
ITEM #	EASTING (X)	NORTHING (Y)	REMARKS
MH 1	636680.180	5517421.614	MANHOLE 1
CB 1	636654.024	5517408.920	CATCH BASIN 1
CB 2	636677.708	5517425.943	CATCH BASIN 2
MH 2	636707.026	5517379.230	MANHOLE 2
CB 3	636708.834	5517376.036	CATCH BASIN 3

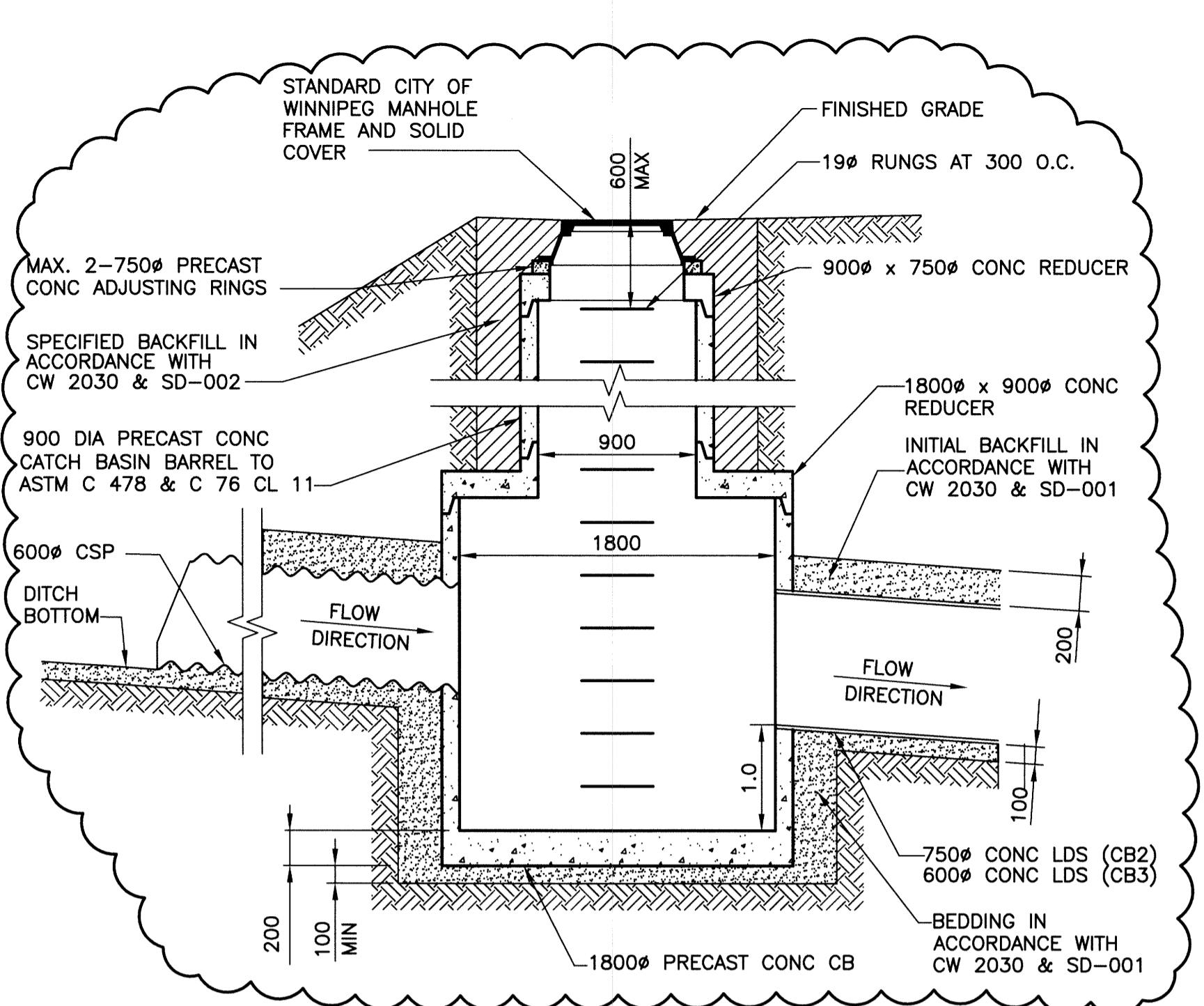

**CATCHBASIN DETAIL (TYP)**  
 SCALE NTS (CB2 AND CB3)

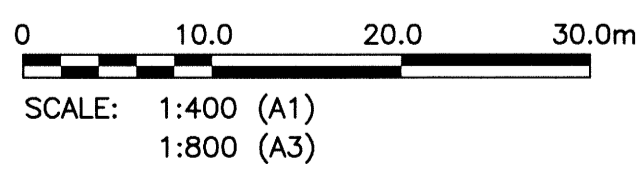
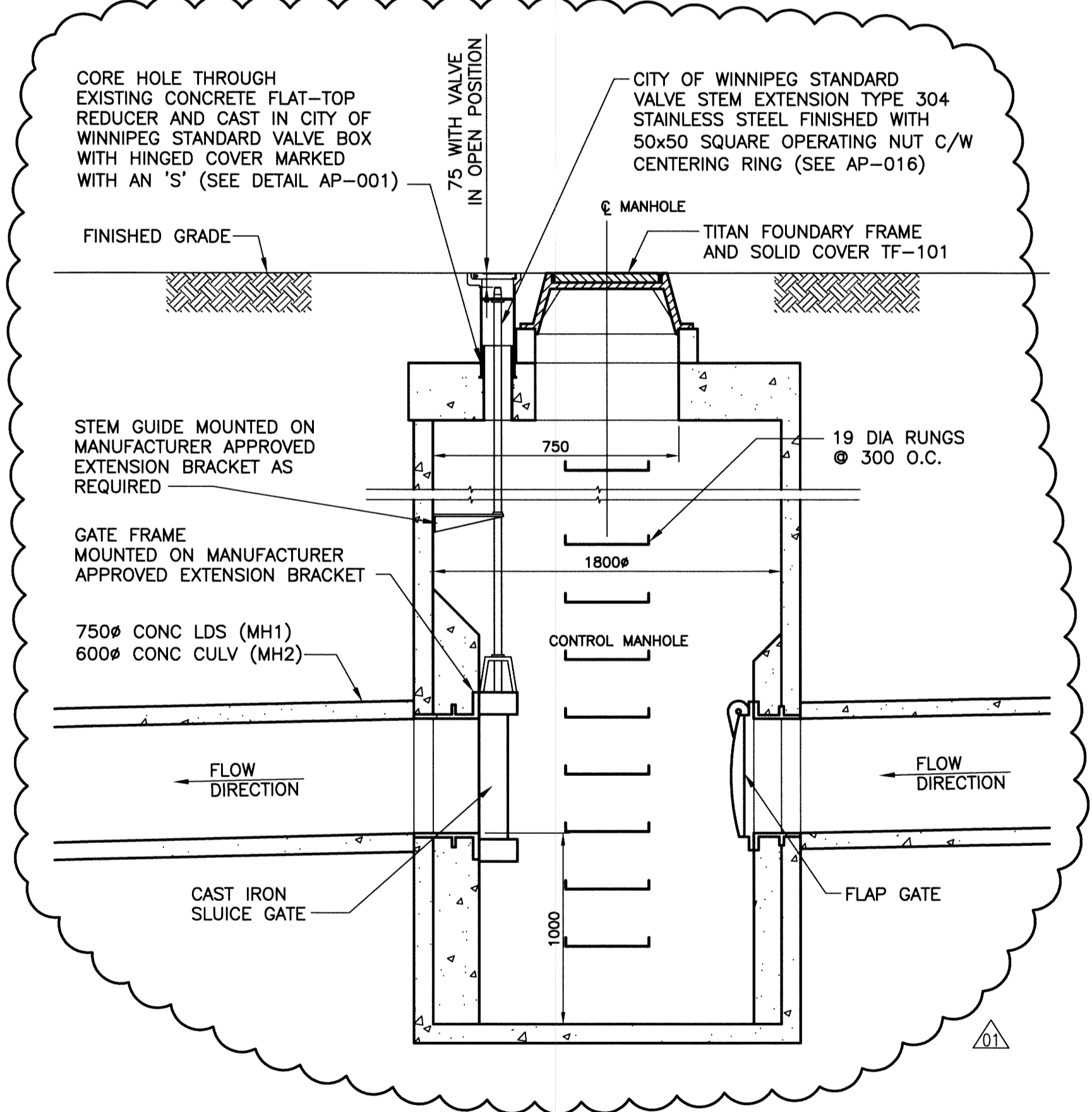

**MANHOLE DETAIL (TYP)**  
 SCALE NTS

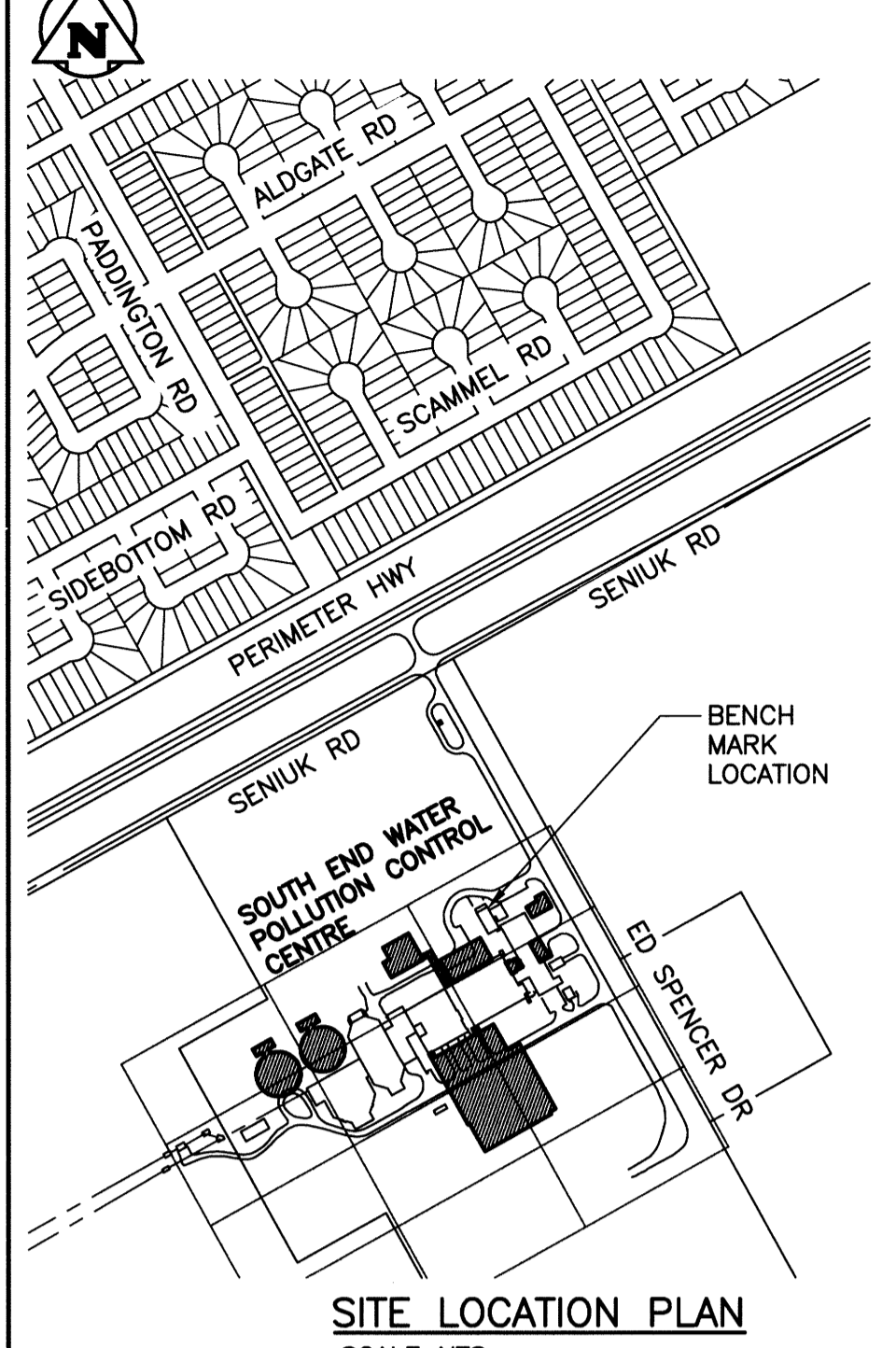

**SITE LOCATION PLAN**  
 SCALE NTS

LEGEND	EXISTING	NEW
SEWER	—	—
SEWER MH	○	●
SEWER PLUG	⊖	⊖
SEWER CB	□	□
SEWER STRUCT	□	□
WM	—	—
WM VALVE	⊗	⊗
WM HYDRANT	⊕	⊕
GAS	—	—
HYDRO	—	—
HYDRO POLE	●HP	●HP
HYDRO STR	□	□
HYDRO POLE	●H	●H
STREET LIGHT	⊙	⊙
HYDRO TRANSFORMER	⊗	⊗
BOLLARD	⊗	⊗
TREE	○	○
SHRUBS/BUSH	○	○
CULVERT	—	—
DITCH	—	—
ROAD	—	—
FENCE	—	—
LEASED LAND UNDER CULTIVATION	—	—
EXIST STRUCTURE TO BE MODIFIED	▨	▨
NEW STRUCTURE	▨	▨
REVISION CLOUD	☁	☁

**NOTE:**  
 1. ALL WORK SHALL BE PERFORMED IN ACCORDANCE WITH THE CITY OF WINNIPEG STANDARD CONSTRUCTION SPECIFICATIONS

B.M. ELEV. 234.059	BRASS PLATE LOCATED IN GRADE BEAM OF ADMINSTRATOR BUILDING	
01	ISSUED FOR ADDENDUM NO. 1	07/2014 EMS
00	ISSUED FOR TENDER	06/2014 EMS
NO.	REVISIONS	DATE DESIGN CHECK

**CH2MHILL**  
 SNC-LAVALLIN  
 DESIGNED BY: EMS  
 DRAWN BY: DMW  
 SCALE: AS NOTED  
 DATE: 2014/06/27  
 CONSULTANT NO.: 13-0338-002

ENGINEER'S SEAL  
**B.J. MIKOLAYENKO**  
 Member 24688  
 REGISTERED PROFESSIONAL ENGINEER  
 July 17, 2014

**THE CITY OF WINNIPEG**  
 WATER AND WASTE DEPARTMENT  
 SOUTH END WATER POLLUTION CONTROL CENTRE  
 SEMPPC UPGRADE/EXPANSION PROJECT  
 CIVIL  
 SITE DRAINAGE OUTLET PLAN AND DETAILS

CITY DRAWING NUMBER	SHEET	REV.	SIZE
1-0102-CDRN-Y001	001	01	A1