

PROFILE VIEW-B
SCALE: 1:250

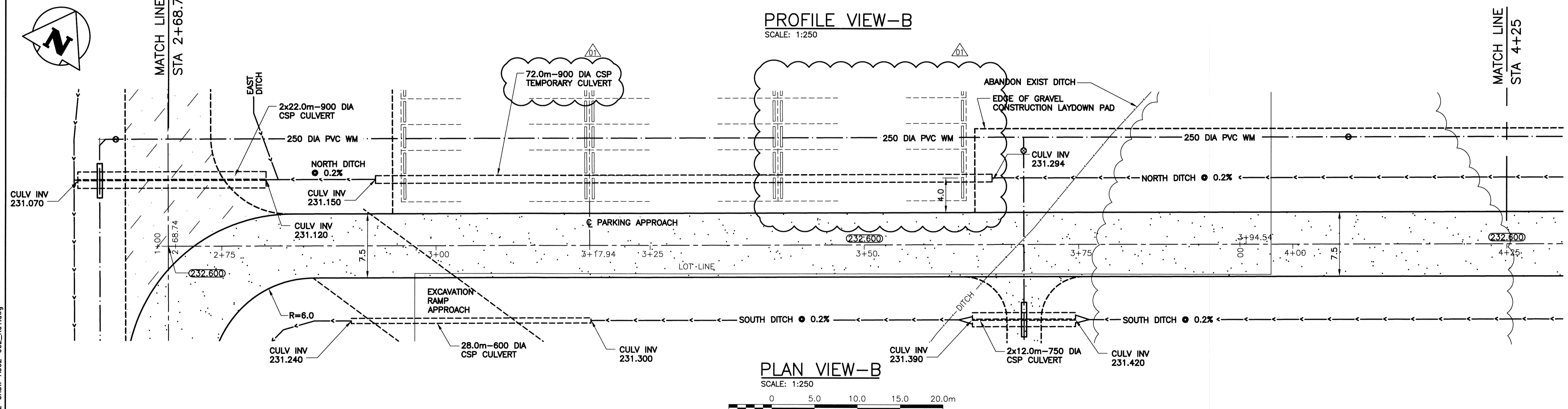

PLAN VIEW-B
SCALE: 1:250

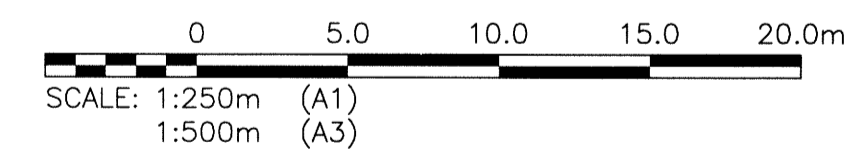

PERIMETER ROAD NORTH LAYOUT CO-ORDINATES			
STATION	EASTING (X)	NORTHING (Y)	REMARKS
2+68.74	636637.007	5517482.347	CL INTERSECTION
3+17.94	636679.939	5517506.384	CL PARKING APPROACH
4+25.0	636773.352	5517558.685	

ROADWAY DRAWING NOTES
NOTES:
1. ALL WORK SHALL BE PERFORMED IN ACCORDANCE WITH THE CITY OF WINNIPEG STANDARD CONSTRUCTION SPECIFICATIONS.
2. ALL PIECES OF EXISTING MUNICIPAL INFRASTRUCTURE TO BE REMOVED OR ABANDONED ARE IDENTIFIED IN GREATER DETAIL ON DRAWINGS 1-0102-CRAD-A006 SHEETS 001 THROUGH 012.

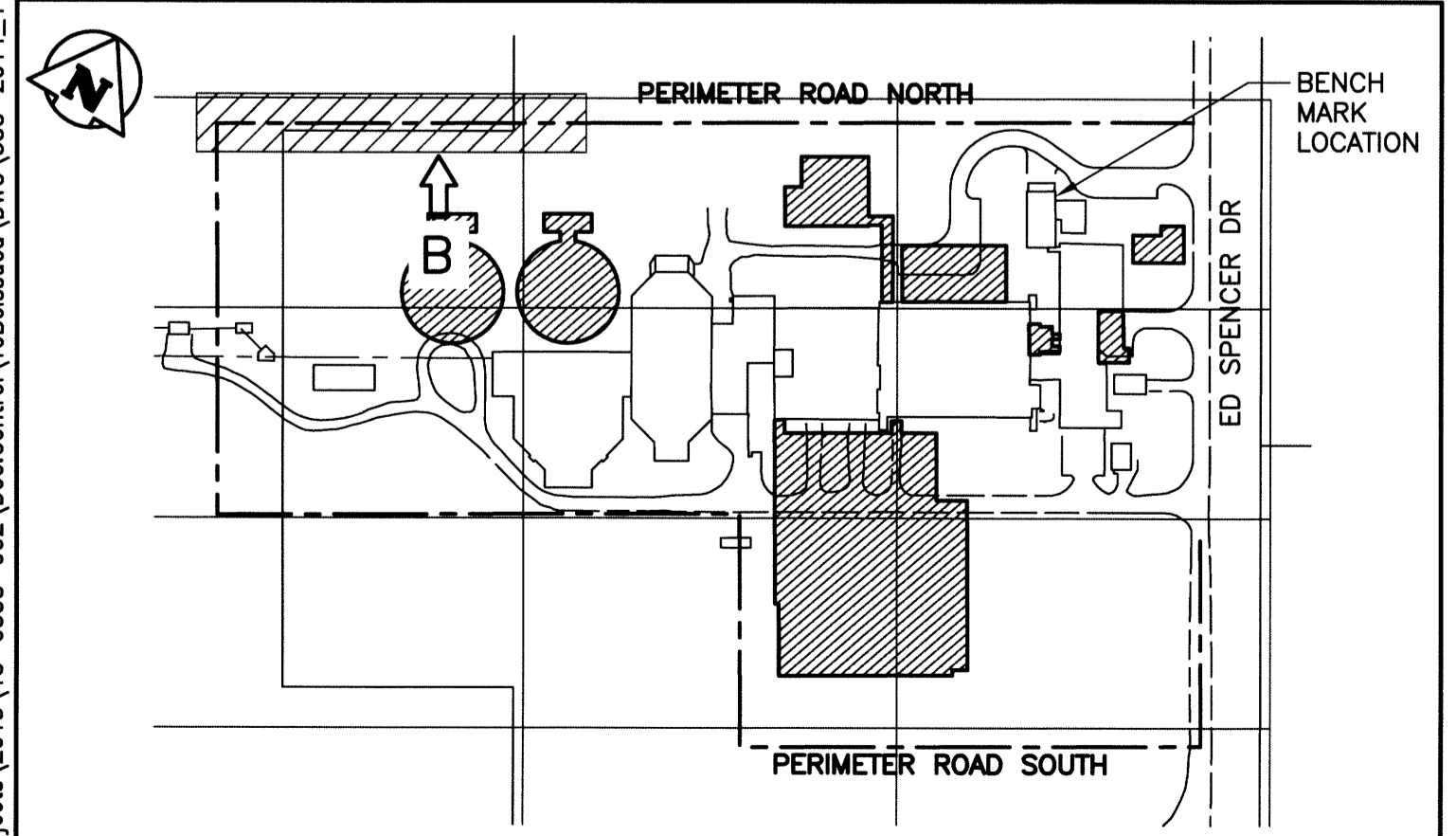

LOCATION PLAN

LEGEND			LEGEND		
ITEM	EXISTING	NEW	ITEM	EXISTING	NEW
WM	—	—	SIGN	—	—
WM VALVE	⊗	⊗	BOLLARD	⊙	⊙
WM HYDRANT	⊕	⊕	TREE	—	—
SEWER	—	—	BUSH	—	—
SEWER MH	○	●	ELEVATION	233.240	233.450
SEWER CB	□	■	CULVERT	=====	=====
MTS	—	—	ROAD	—	—
MTS MH	○	●	CONSTRUCTION ACCESS ROAD	—	—
HYDRO	—	—			
HYDRO LS	—	—			
HYDRO POLE	—HP	—			
GAS	—	—			
DITCH	—	—			
FENCE	—x	—x			

CH2MHILL
SNC-LAVALIN
DESIGNED BY: EMS
CHECKED BY: BJM
DRAWN BY: DMW
APPROVED BY: RJH
SCALE: AS NOTED
DATE: 2014/06/27
CONSULTANT NO.: 13-0338-002

KGS GROUP
B.J. MIKOLAYENKO
Member 24688
PROFESSIONAL ENGINEER

ENGINEER'S SEAL
July 17/2014

THE CITY OF WINNIPEG
WATER AND WASTE DEPARTMENT
SOUTH END WATER POLLUTION CONTROL CENTRE
SEWPPC UPGRADE/EXPANSION PROJECT
CIVIL
PERIMETER ROAD NORTH
STA 2+68.74 TO STA 4+25

CITY DRAWING NUMBER: 1-0102-CRSW-A002
SHEET: 002
REV: 01
SIZE: A1

