

PROFILE VIEW-B
SCALE: 1:250

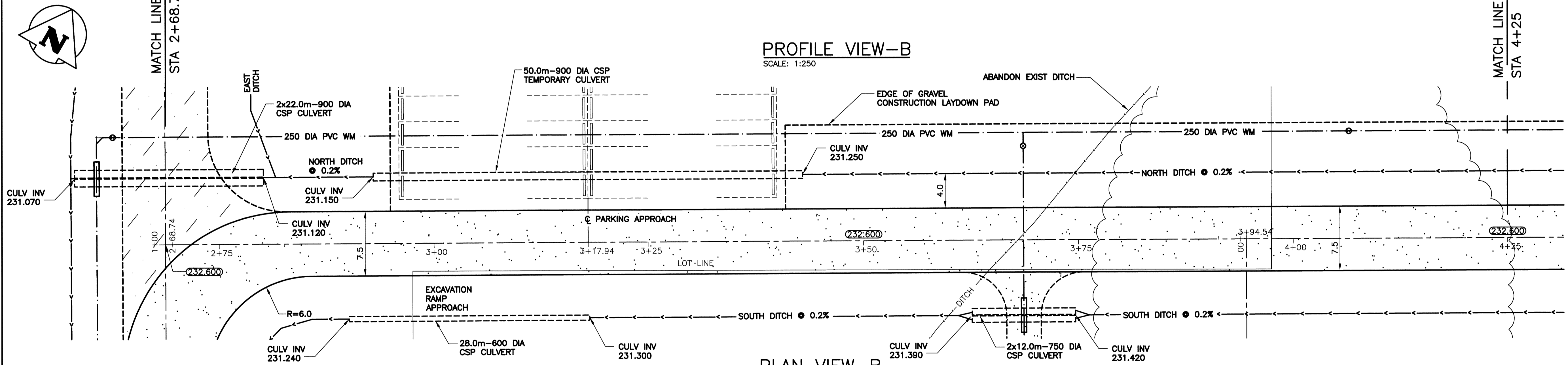

PLAN VIEW-B
SCALE: 1:250

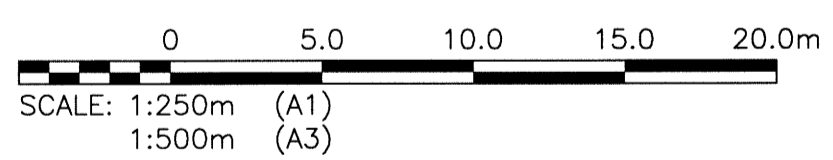

PERIMETER ROAD NORTH LAYOUT CO-ORDINATES			
STATION	EASTING (X)	NORTHING (Y)	REMARKS
2+68.74	636637.007	5517482.347	CL INTERSECTION
3+17.94	636679.939	5517506.384	CL PARKING APPROACH
4+25.0	636773.352	5517558.685	

ROADWAY DRAWING NOTES
 NOTES:
 1. ALL WORK SHALL BE PERFORMED IN ACCORDANCE WITH THE CITY OF WINNIPEG STANDARD CONSTRUCTION SPECIFICATIONS.
 2. ALL PIECES OF EXISTING MUNICIPAL INFRASTRUCTURE TO BE REMOVED OR ABANDONED ARE IDENTIFIED IN GREATER DETAIL ON DRAWINGS 1-0102-CGAD-A006 SHEETS 001 THROUGH 012.

LEGEND			
ITEM	EXISTING	NEW	ABANDONED
WM	⊕	⊕	⊕
WM VALVE	⊕	⊕	⊕
WM HYDRANT	⊕	⊕	⊕
SEWER MH	⊕	⊕	⊕
SEWER CB	⊕	⊕	⊕
MTS	⊕	⊕	⊕
MTS MH	⊕	⊕	⊕
HYDRO	⊕	⊕	⊕
HYDRO LS	⊕	⊕	⊕
HYDRO POLE	⊕	⊕	⊕
GAS	⊕	⊕	⊕
DITCH	---	---	---
FENCE	---	---	---
SIGN	⊕	⊕	⊕
BOLLARD	⊕	⊕	⊕
TREE	⊕	⊕	⊕
BUSH	⊕	⊕	⊕
ELEVATION	233.240	233.450	
CULVERT	====	====	---
ROAD	---	---	---
CONSTRUCTION ACCESS ROAD	---	---	---

B.M.	
NO.	ELEV.
00	234.059
BRASS PLATE LOCATED IN GRADE BEAM OF ADMINISTRATION BUILDING	

CH2MHILL
 SNC-LAVALIN
 DESIGNED BY: EMS
 CHECKED BY: BJM
 DRAWN BY: DMW
 APPROVED BY: RJH
 SCALE: AS NOTED
 RELEASED FOR CONSTRUCTION BY:
 DATE: 2014/06/27
 CONSULTANT NO.: 13-0338-002

ENGINEER'S SEAL

 B.J. MIKOLAYENKO
 Member 24888
 REGISTERED PROFESSIONAL ENGINEER

THE CITY OF WINNIPEG
 WATER AND WASTE DEPARTMENT
 SOUTH END WATER POLLUTION CONTROL CENTRE
 SEWPC UPGRADE/EXPANSION PROJECT
 CIVIL
 PERIMETER ROAD NORTH
 STA 2+68.74 TO STA 4+25
 CITY DRAWING NUMBER: 1-0102-CRSW-A002
 SHEET: 002
 REV: 00
 SIZE: A1

APEGM
 Certificate of Authorization
 KGS Group
 No. 245

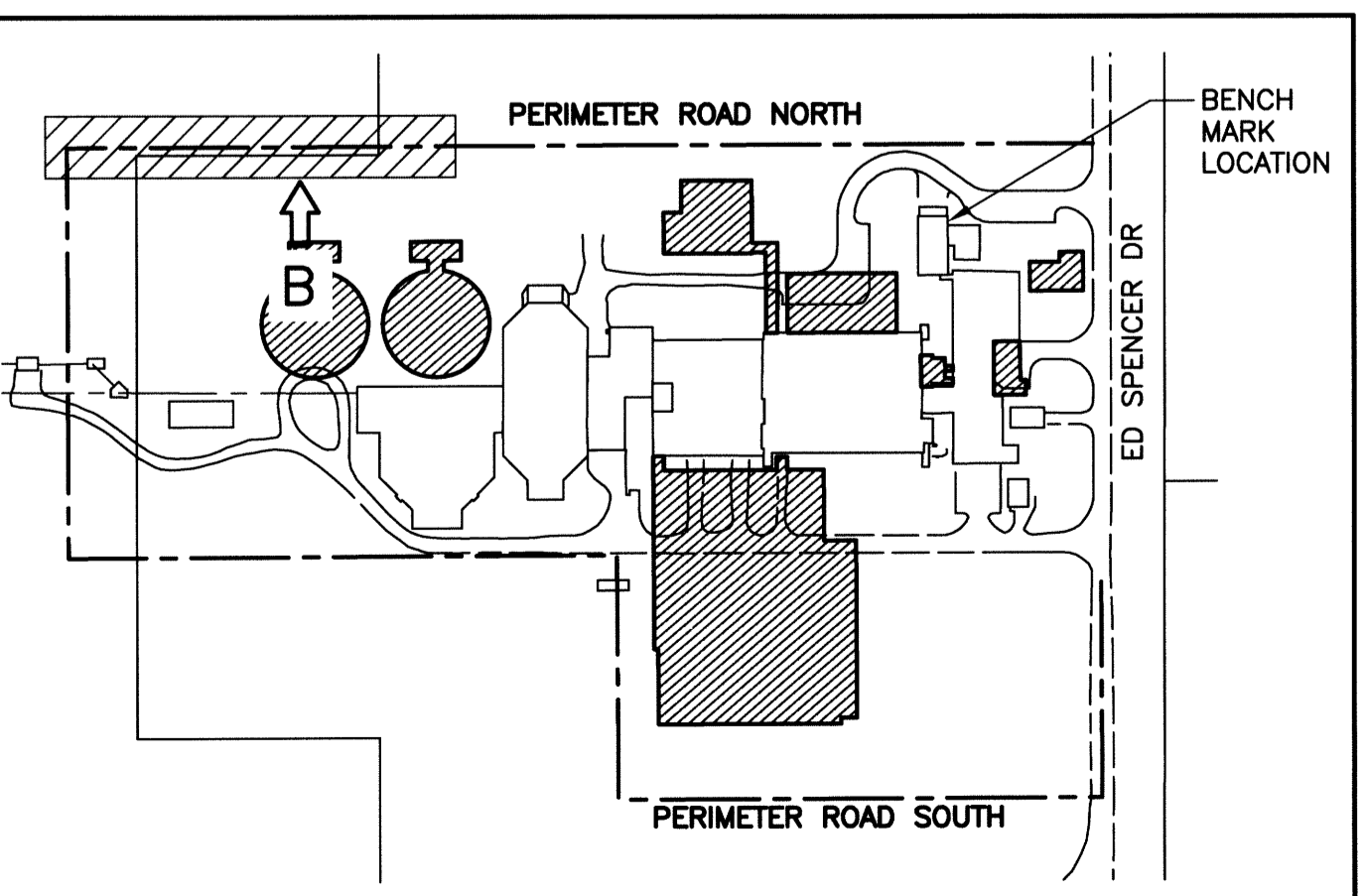

LOCATION PLAN