

PROFILE VIEW-A
SCALE: 1:250

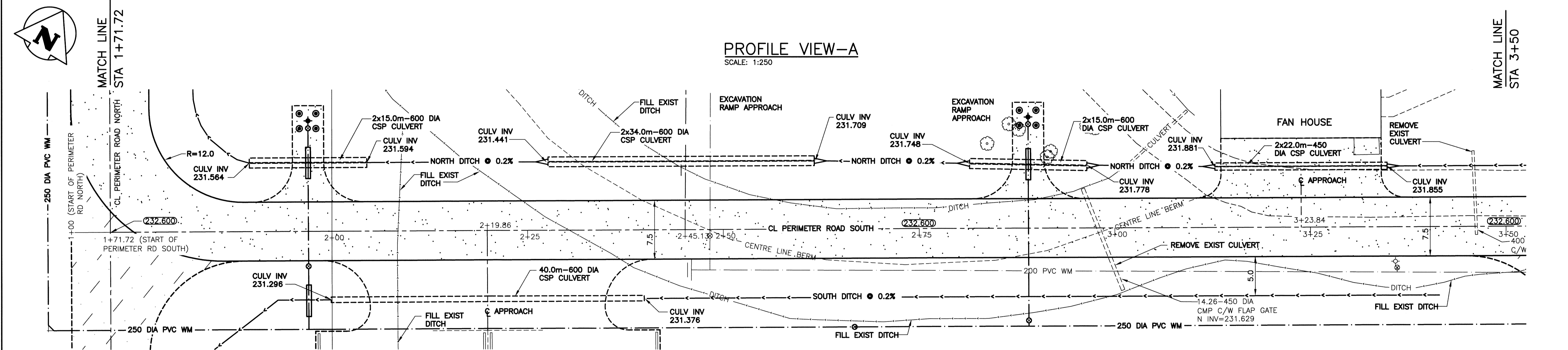

PLAN VIEW-A
SCALE: 1:250

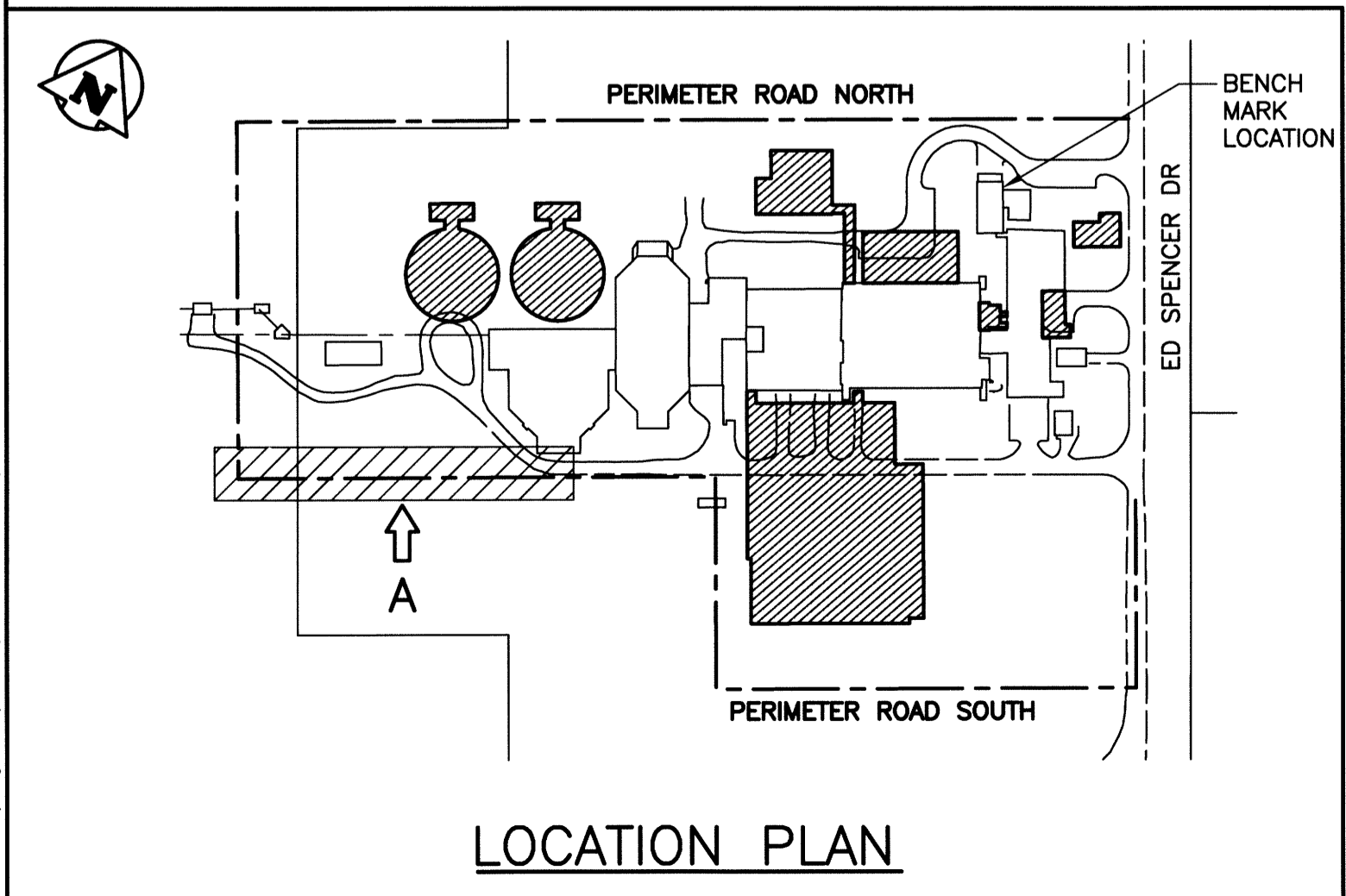

LOCATION PLAN

ROADWAY DRAWING NOTES
NOTES:
1. ALL WORK SHALL BE PERFORMED IN ACCORDANCE WITH THE CITY OF WINNIPEG STANDARD CONSTRUCTION SPECIFICATIONS.
2. ALL PIECES OF EXISTING MUNICIPAL INFRASTRUCTURE TO BE REMOVED OR ABANDONED ARE IDENTIFIED IN GREATER DETAIL ON DRAWINGS 1-0102-CRAD-A006 SHEETS 001 THROUGH 012.

LEGEND			
ITEM	EXISTING	NEW	ABANDONED
WM VALVE	⊕	⊕	⊕
WM HYDRANT	⊕	⊕	⊕
SEWER MH	○	●	○
SEWER CB	□	■	□
MTS	○	●	○
MTS MH	○	●	○
HYDRO	—	—	—
HYDRO LS	—	—	—
HYDRO POLE	—	—	—
GAS	—	—	—
DITCH	—	—	—
FENCE	—	—	—
SIGN BOLLARD	⊙	⊙	⊙
TREE	⊙	⊙	⊙
BUSH	⊙	⊙	⊙
ELEVATION	233.240	233.450	
CULVERT	====	====	
ROAD	---	---	
CONSTRUCTION ACCESS ROAD	---	---	

STATION	EASTING (X)	NORTHING (Y)	REMARKS
1+71.72	636719.445	5517335.109	CL ROAD INTERSECTION
2+19.86	636761.450	5517358.627	CL SOUTH APPROACH
3+23.84	636852.177	5517409.424	CL NORTH APPROACH

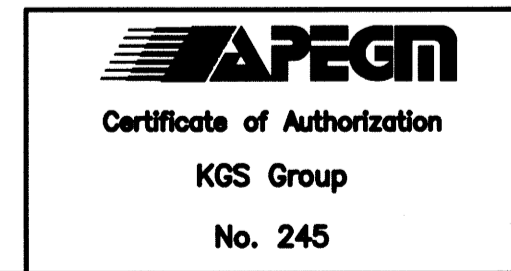
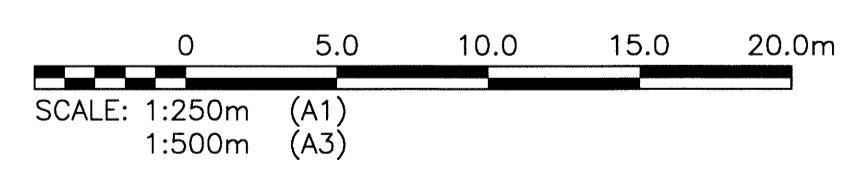

B.M. BRASS PLATE LOCATED IN GRADE BEAM OF ADMINISTRATION BUILDING	ELEV. 234.059
00	ISSUED FOR TENDER
NO.	REVISIONS

CH2MHILL
SNC-LAVALIN
DESIGNED BY: EMS
DRAWN BY: DMW
SCALE: AS NOTED
DATE: 2014/06/27

KGS GROUP
CHECKED BY: BJM
APPROVED BY: RJH
RELEASED FOR CONSTRUCTION BY:
DATE: JUNE 25/2014

ENGINEER'S SEAL
B.J. MIKOLAYENKO
Member 24888
REGISTERED PROFESSIONAL ENGINEER

THE CITY OF WINNIPEG
WATER AND WASTE DEPARTMENT

SOUTH END WATER POLLUTION CONTROL CENTRE
SEWPC UPGRADE/EXPANSION PROJECT
CML

PERIMETER ROAD SOUTH
STA 1+71.72 TO STA 3+50

CITY DRAWING NUMBER	1-0102-CRSW-A003	SHEET	001	REV.	00	SIZE	A1
---------------------	------------------	-------	-----	------	----	------	----