

CONSTRUCTION ROAD SOUTH - PROFILE VIEW A
 SCALE: 1:250

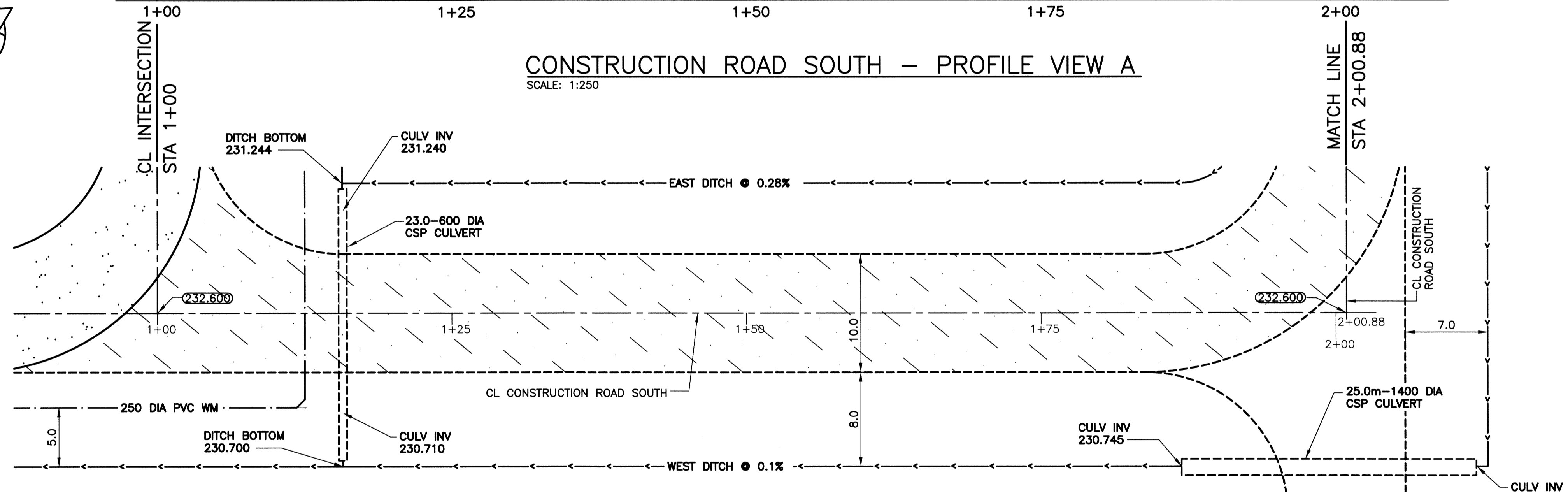

CONSTRUCTION ROAD SOUTH - PLAN VIEW A
 SCALE: 1:250

ACCESS ROAD SOUTH LAYOUT CO-ORDINATES			
STATION	EASTING (X)	NORTHING (Y)	REMARKS
1+00	636719.445	5517335.109	CL INTERSECTION
2+00.88	636768.728	5517247.086	CL INTERSECTION
.	.	.	.
.	.	.	.
.	.	.	.
.	.	.	.
.	.	.	.
.	.	.	.
.	.	.	.
.	.	.	.
.	.	.	.

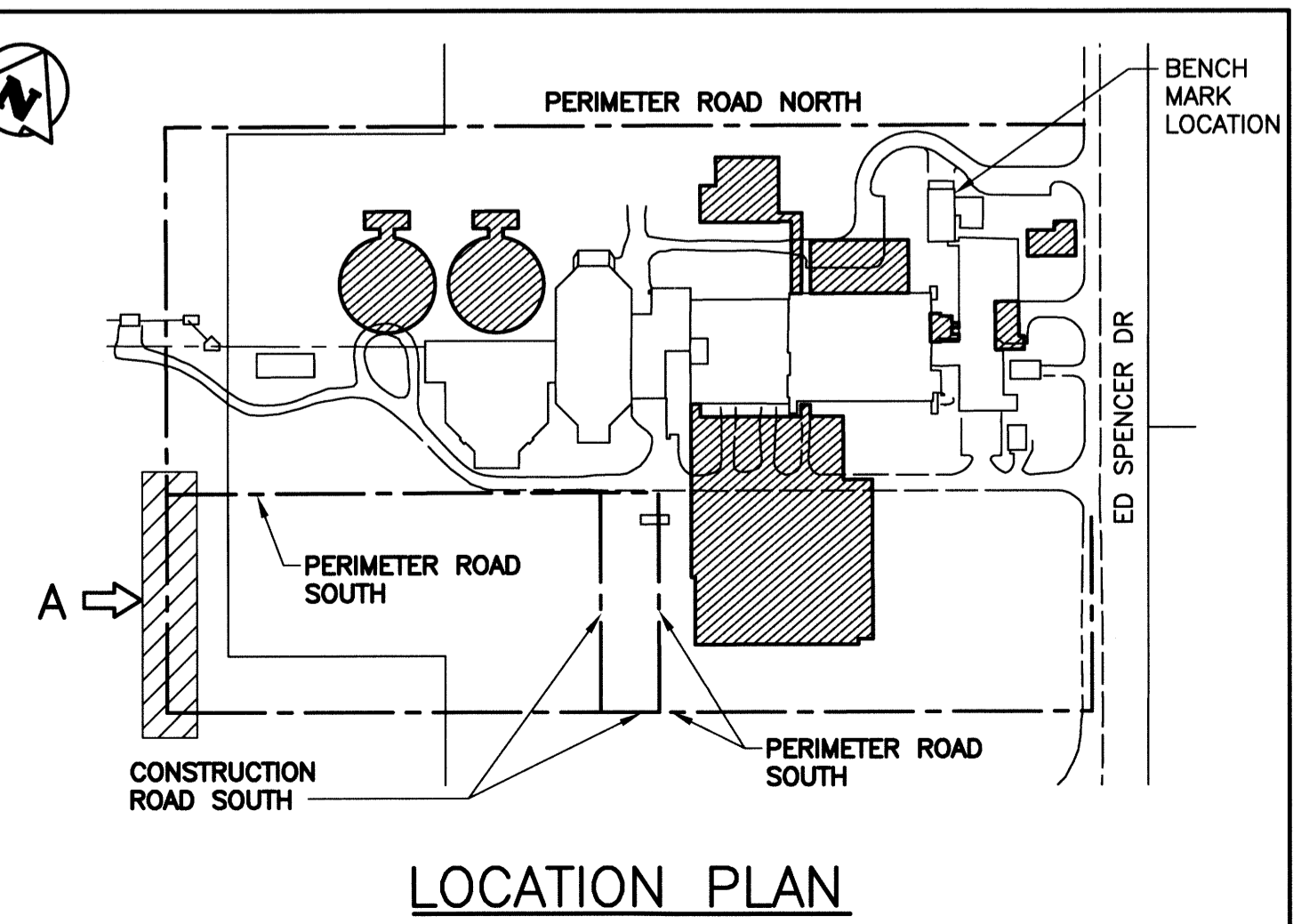

LOCATION PLAN

ROADWAY DRAWING NOTES
 NOTES:
 1. ALL WORK SHALL BE PERFORMED IN ACCORDANCE WITH THE CITY OF WINNIPEG STANDARD CONSTRUCTION SPECIFICATIONS.
 2. ALL PIECES OF EXISTING MUNICIPAL INFRASTRUCTURE TO BE REMOVED OR ABANDONED ARE IDENTIFIED IN GREATER DETAIL ON DRAWINGS 1-0102-CRAD-A006 SHEETS 001 THROUGH 012.

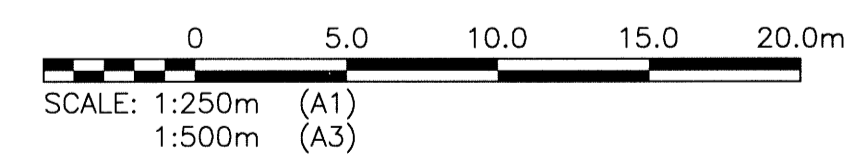

LEGEND			
ITEM	EXISTING	NEW	ABANDONED
WM VALVE	⊗	⊕	
WM HYDRANT	⊙	⊕	
SEWER	—○—	—●—	—○—
SEWER MH	⊙	●	○
SEWER CB	□	■	□
MTS	—	—	—
MTS MH	○	●	
HYDRO	—	—	—
HYDRO LS	—	—	—
HYDRO POLE	—HP—	—	—
GAS	—	—	—
DITCH	—	—	—
FENCE	—x—	—x—	—x—
SIGN	⊙	⊕	
BOLLARD	⊙	⊕	
TREE	⊙	⊕	
BUSH	⊙	⊕	
ELEVATION	233.240	233.450	
CULVERT	====	====	
ROAD	----	----	
CONSTRUCTION ACCESS ROAD	----	----	

B.M. ELEV. 234.059	BRASS PLATE LOCATED IN GRADE BEAM OF ADMINSTRATON BUILDING
00	ISSUED FOR TENDER
NO.	REVISIONS

CH2MHILL
 SNC-LAVALIN
 DESIGNED BY: EMS
 CHECKED BY: BJM
 DRAWN BY: DMW
 APPROVED BY: RJH
 SCALE: AS NOTED
 DATE: 2014/06/27
 CONSULTANT NO.: 13-0338-002

ENGINEER'S SEAL

THE CITY OF WINNIPEG
 WATER AND WASTE DEPARTMENT
 SOUTH END WATER POLLUTION CONTROL CENTRE
 SEWPCC UPGRADE/EXPANSION PROJECT
 CML
 CONSTRUCTION ACCESS ROAD SOUTH
 STA 1+00 TO STA 2+00.88
 CITY DRAWING NUMBER: 1-0102-CRSW-A004
 SHEET: 001
 REV: 00
 SIZE: A1

APEGM
 Certificate of Authorization
 KGS Group
 No. 245