

PROFILE VIEW-A  
SCALE: 1:250

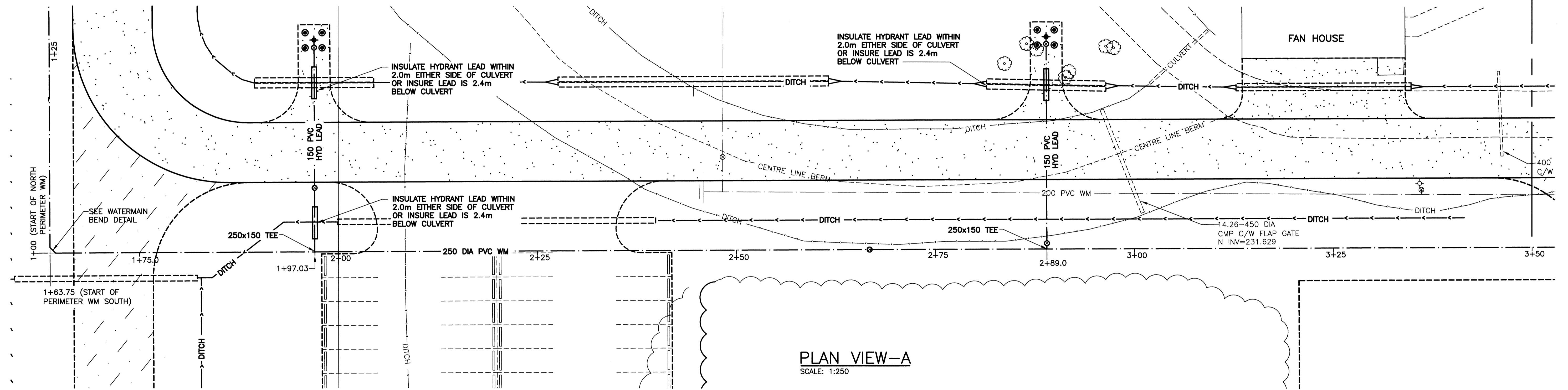

PLAN VIEW-A  
SCALE: 1:250

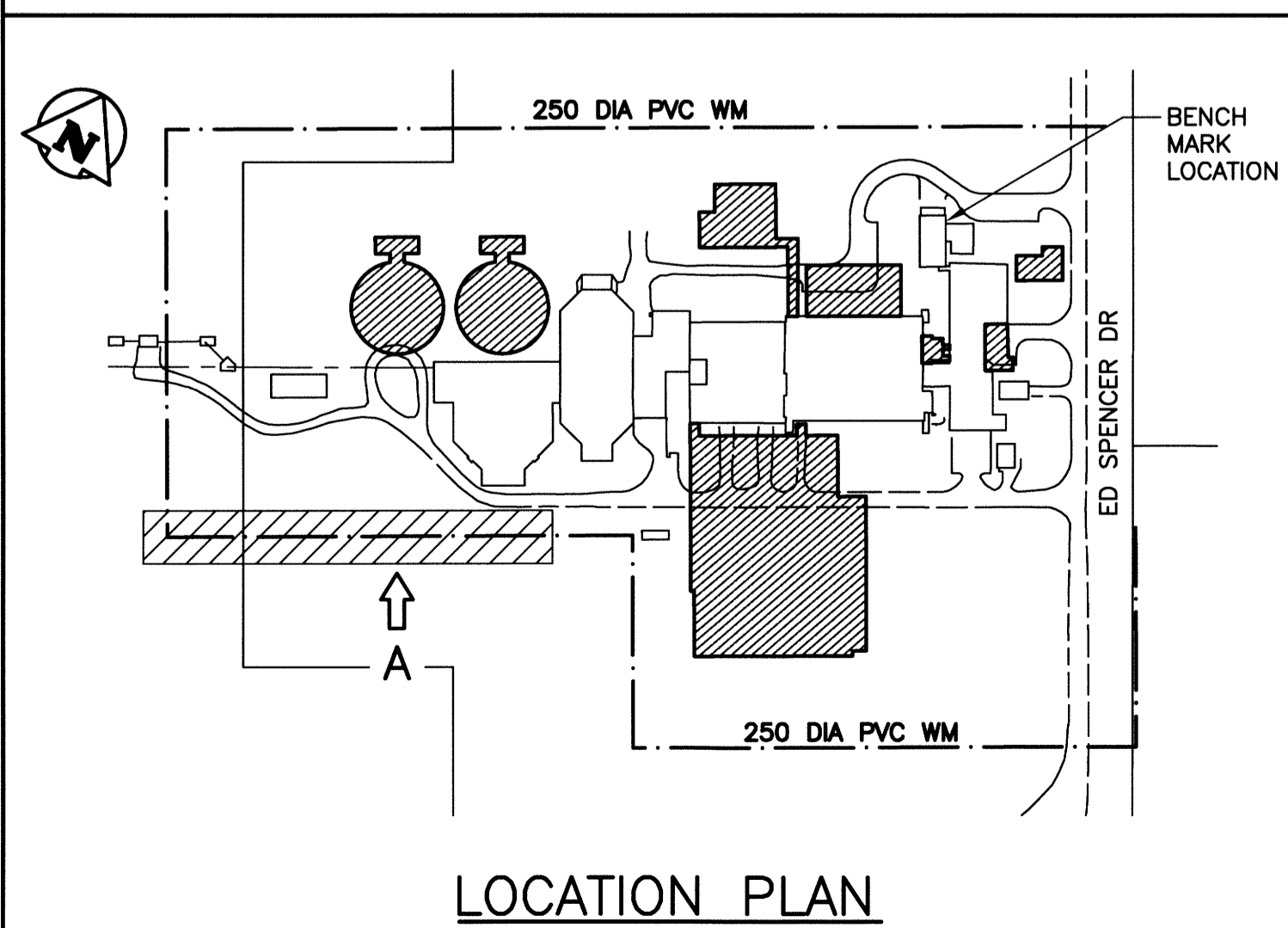

LOCATION PLAN

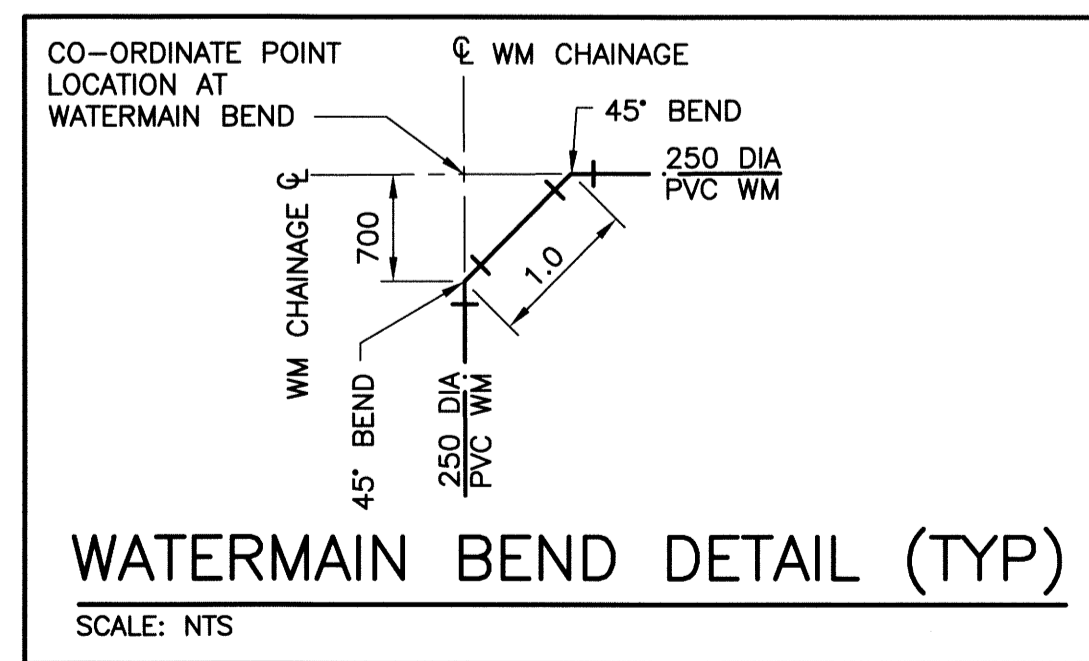

WATERMAIN BEND DETAIL (TYP)  
SCALE: NTS

		LEGEND					
ITEM	EXISTING	NEW	ABANDONED	ITEM	EXISTING	NEW	ABANDONED
WM	—	—	—	GAS	—	—	—
WM VALVE	⊙	⊙	—	DITCH	—	—	—
WM HYDRANT	⊙	⊙	—	FENCE	—	—	—
SEWER	—	—	—	SIGN	—	—	—
SEWER MH	⊙	⊙	—	BOLLARD	—	—	—
SEWER CB	⊙	⊙	—	TREE	—	—	—
MTS	—	—	—	BUSH	—	—	—
MTS MH	⊙	⊙	—	ELEVATION	233.240	233.450	—
HYDRO	—	—	—	CULVERT	—	—	—
HYDRO LS	—	—	—				
HYDRO POLE	—	—	—				

**WATERMAIN DRAWING NOTES**

NOTES:

- ALL WORK SHALL BE PERFORMED IN ACCORDANCE WITH THE CITY OF WINNIPEG STANDARD CONSTRUCTION SPECIFICATIONS.
- ALL NEW WATERMAIN AND SERVICE CONNECTIONS SHALL HAVE MINIMUM 2.4 METRES OF COVER.
- ALL PIECES OF EXISTING MUNICIPAL INFRASTRUCTURE TO BE REMOVED OR ABANDONED ARE IDENTIFIED IN GREATER DETAIL ON DRAWINGS 1-0102-CGAD-A006 SHEETS 001 THROUGH 012.

STATION	EASTING (X)	NORTHING (Y)	REMARKS
1+63.75	636718.571	5517320.294	90° BEND
1+97.03	636747.611	5517336.553	FIRE HYDRANT TEE
1+97.03	636734.606	5517359.781	FIRE HYDRANT
2+66.76	636808.443	5517370.614	WM VALVE
2+89.00	636827.856	5517381.482	FIRE HYDRANT TEE
2+89.00	636814.816	5517404.772	FIRE HYDRANT

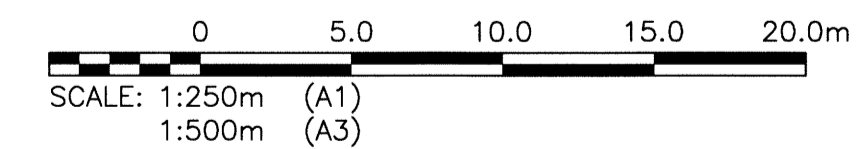

B.M. BRASS PLATE LOCATED IN GRADE BEAM OF ADMINSTRATON BUILDING ELEV. 234.059			
00	ISSUED FOR TENDER	06/2014	EMS
NO.	REVISIONS	DATE	DESIGN CHECK

**CH2MHILL**

SNC-LAVALIN

DESIGNED BY: EMS  
DRAWN BY: DMW  
SCALE: AS NOTED  
DATE: 2014/06/27

CHECKED BY: BJM  
APPROVED BY: RJH  
RELEASED FOR CONSTRUCTION BY:  
DATE:

CONSULTANT NO.: 13-0338-002

ENGINEER'S SEAL

B.J. MIKOLAYENKO  
Member 24688  
Professional Engineer  
June 27/2014

**THE CITY OF WINNIPEG**  
WATER AND WASTE DEPARTMENT

SOUTH END WATER POLLUTION CONTROL CENTRE  
SEWPC UPGRADE/EXPANSION PROJECT  
CML

WATERMAIN SOUTH  
STA 1+63.75 TO STA 3+50

CITY DRAWING NUMBER	SHEET	REV.	SIZE
1-0102-CUTY-Y007	001	00	A1