

LEGEND	EXISTING	NEW
SEWER		
SEWER MH	○	●
SEWER PLUG	⊞	
SEWER CB	□	
SEWER STRUCT	□	
WM		
WM VALVE	⊗	⊙
WM HYDRANT	⊕	
GAS		
HYDRO		
HYDRO POLE	●HP	
HYDRO STR	□	
HYDRO POLE	●H	
STREET LIGHT	⊙	
HYDRO TRANSFORMER	⊞	⊞
BOLLARD	⊙	
TREE	⊙	
SHRUBS/BUSH	⊙	
CULVERT	⊞	⊞
DITCH	⊞	⊞
ROAD	⊞	⊞
FENCE	⊞	⊞
LEASED LAND UNDER CULTIVATION	⊞	⊞
EXIST STRUCTURE TO BE MODIFIED		⊞
NEW STRUCTURE		⊞
NEW ROAD		⊞
CONSTRUCTION ACCESS RAMP		⊞
HYDRO DUCT		⊞
SHORING AND LAGGING		⊞

PLAN - SITE LOCATION 3
SCALE: 1:250

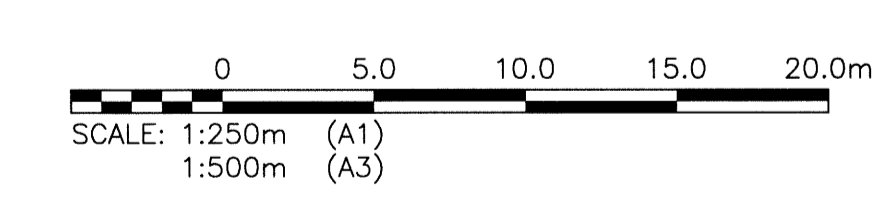

NOTE:
1. ALL WORK SHALL BE PERFORMED IN ACCORDANCE WITH THE CITY OF WINNIPEG STANDARD CONSTRUCTION SPECIFICATIONS

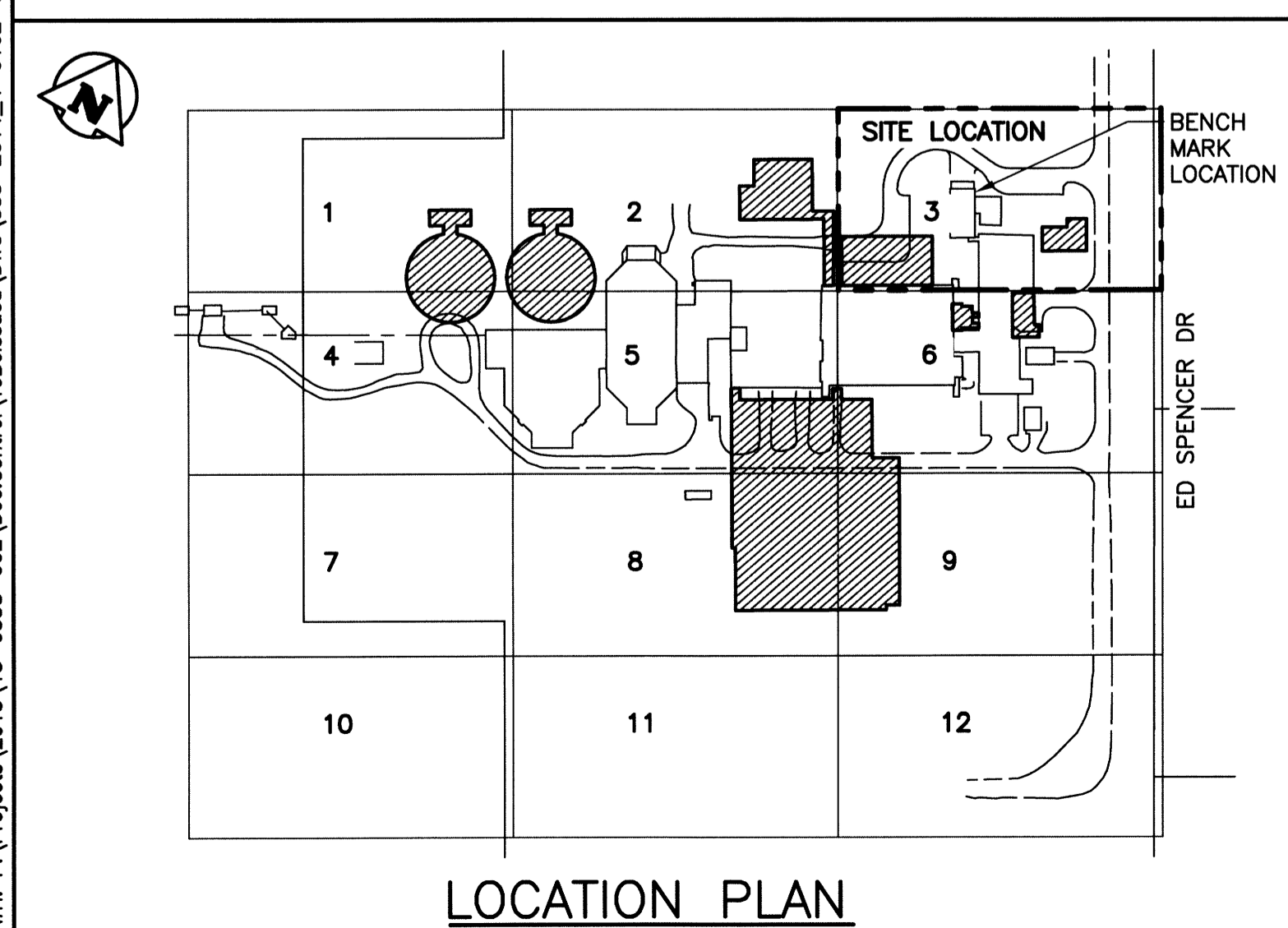

APEGN
Certificate of Authorization
KGS Group
No. 245

B.M.	BRASS PLATE LOCATED IN GRADE BEAM OF ADMINSTRATON BUILDING		
ELEV.	234.059		
NO.	REVISIONS	DATE	DESIGN/CHECK
00	ISSUED FOR TENDER	06/2014	EMS

CH2MHILL
SNC-LAVALIN
DESIGNED BY: EMS
DRAWN BY: DMW
SCALE: AS NOTED
DATE: 2014/06/27
CONSULTANT NO.: 13-0338-002

CHECKED BY: BJM
APPROVED BY: RJH
RELEASED FOR CONSTRUCTION BY:
DATE:

ENGINEER'S SEAL
PROVINCE OF MANITOBA
B.J. MIKOLAYENKO
Member 24688
JUNE 25/2014

THE CITY OF WINNIPEG
WATER AND WASTE DEPARTMENT
SOUTH END WATER POLLUTION CONTROL CENTRE
SEWPC UPGRADE/EXPANSION PROJECT
CIVIL
SITE REMOVALS - LOCATION 3

CITY DRAWING NUMBER: 4-0102-CGAD-A001
SHEET: 003
REV: 00
SIZE: A1