

BIOREACTOR BUILDING

BOTTOM OF EXCAVATION

TOP OF EXCAVATION

CONTRACTOR LAYDOWN AREA

ED SPENCER DR

LOT LINE
250 DIA PVC WM

PLAN - SITE LOCATION 9

SCALE: 1:250

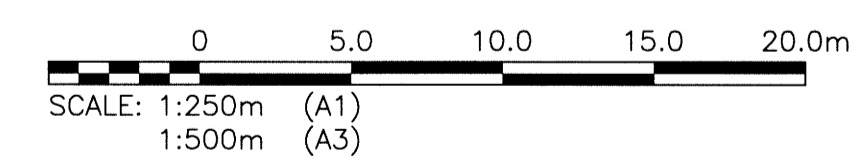

LEGEND	EXISTING	NEW
SEWER		
SEWER MH	○	●
SEWER PLUG	⊥	
SEWER CB	□	
SEWER STRUCT	▭	
WM		
WM VALVE	⊗	⊙
WM HYDRANT	⊕	
GAS		
HYDRO		
HYDRO POLE	●HP	
HYDRO STR	□	
HYDRO POLE	●H	
STREET LIGHT	⊙	
HYDRO TRANSFORMER	⊗	⊙
BOLLARD	⊙	
TREE	⊙	
SHRUBS/BUSH	⊙	
CULVERT	⊔	→
DITCH	→	→
ROAD	---	---
FENCE	x	x
LEASED LAND UNDER CULTIVATION	---	---
EXIST STRUCTURE TO BE MODIFIED		▨
NEW STRUCTURE		▨
NEW ROAD		▨
CONSTRUCTION ACCESS RAMP		---
HYDRO DUCT		---
SHORING AND LAGGING		---

NOTE:
1. ALL WORK SHALL BE PERFORMED IN ACCORDANCE WITH THE CITY OF WINNIPEG STANDARD CONSTRUCTION SPECIFICATIONS

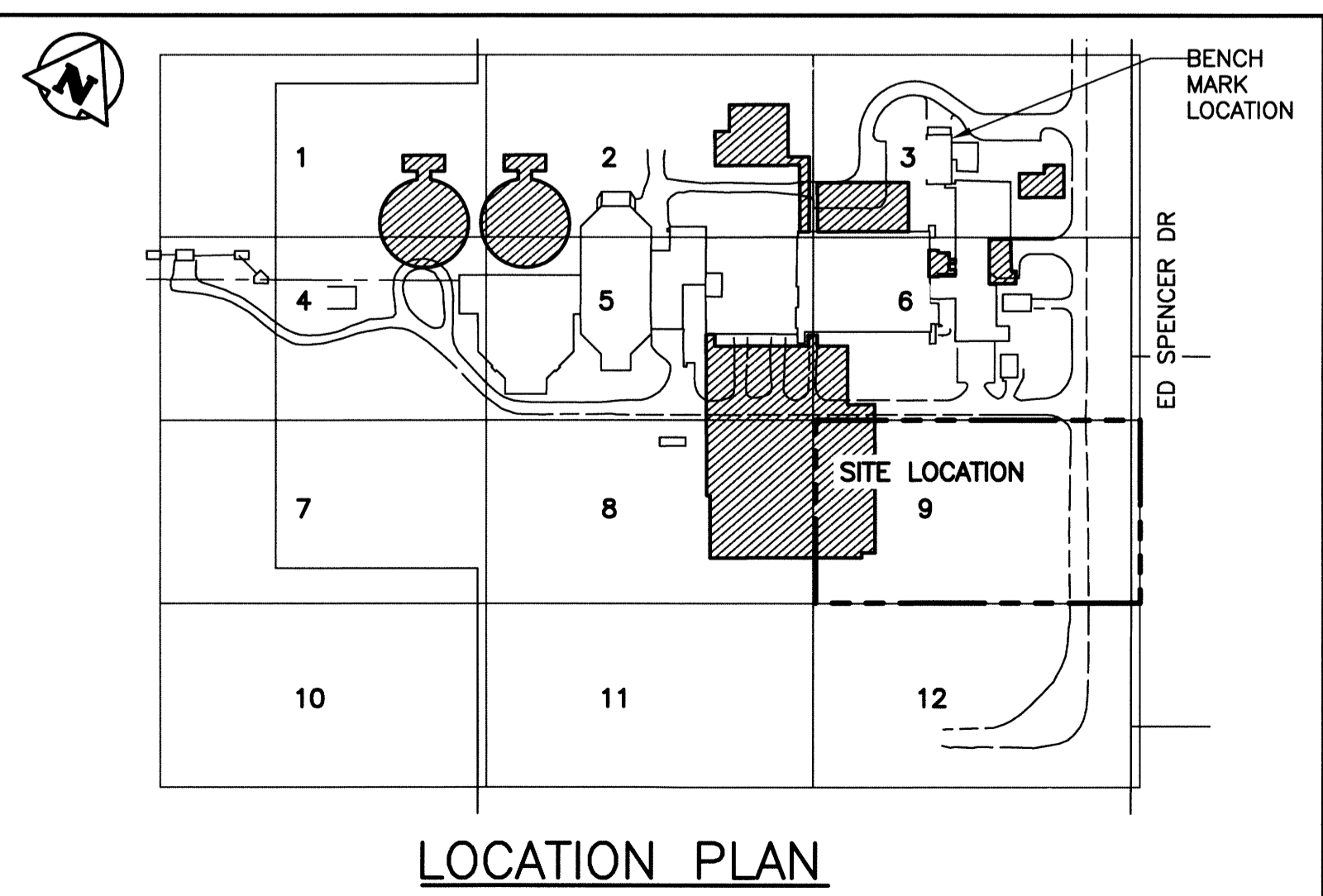

LOCATION PLAN

APEGN
Certificate of Authorization
KGS Group
No. 245

B.M. BRASS PLATE LOCATED IN GRADE BEAM OF ADMINSTRATON BUILDING ELEV. 234.059	
DESIGNED BY: EMS	CHECKED BY: BJM
DRAWN BY: DMW	APPROVED BY: RJH
SCALE: AS NOTED	RELEASED FOR CONSTRUCTION BY:
DATE: 2014/06/27	DATE:
ISSUED FOR TENDER	06/2014
NO. REVISIONS	DATE
	DESIGN CHECK

CH2MHILL
SNC-LAVALIN
KGS GROUP
DESIGNED BY: EMS
CHECKED BY: BJM
DRAWN BY: DMW
APPROVED BY: RJH
SCALE: AS NOTED
RELEASED FOR CONSTRUCTION BY:
DATE: 2014/06/27
DATE:
CONSULTANT NO.: 13-0338-002

ENGINEER'S SEAL
PROVINCE OF MANITOBA
B.J. MIKOLAYENKO
Member
24688
JUNE 25/2014

THE CITY OF WINNIPEG
WATER AND WASTE DEPARTMENT
SOUTH END WATER POLLUTION CONTROL CENTRE
SEMPCC UPGRADE/EXPANSION PROJECT
CIVIL
SITE REMOVALS - LOCATION 9
CITY DRAWING NUMBER: 4-0102-CGAD-A001
SHEET: 009
REV: 00
SIZE: A1