

NOTE: CHAINAGES SHOWN ARE ALONG E. P. OF VALOUR RD

VALOUR ROAD

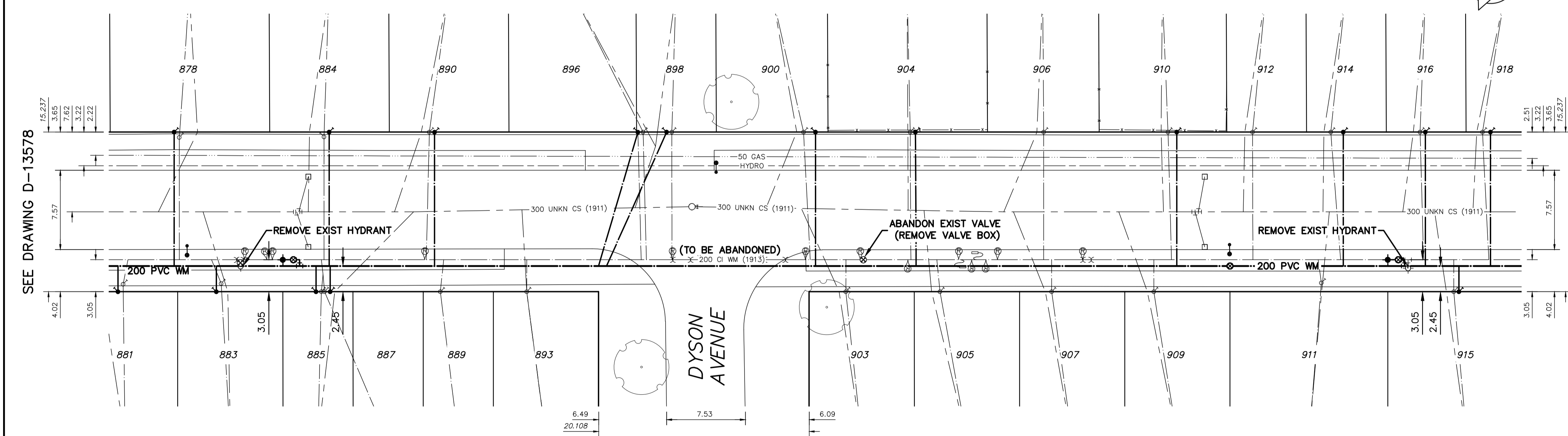

ADDRESS	SIZE (mm) MATERIAL (STREET)	SIZE (mm) MATERIAL (PROP.)	SHORT & LONG MEASUREMENT	CORP. LOCATION	REMARKS
881 VALOUR RD	12	12	5.2m S/NLL	1.5' N SC	-
RESIDENTIAL LEAD	20	20	45.47m S/SL DYSON AVE	OPP SC	-
878 VALOUR RD	20	20	6.59m N/SL	OPP SC	-
RESIDENTIAL LEAD	20	20	39.63m S/SL DYSON AVE	OPP SC	-
885 VALOUR RD	12	12	5.9m S/NLL	3.0' S SC	-
RESIDENTIAL LEAD	20	20	36.11m S/SL DYSON AVE	OPP SC	-
885 VALOUR RD	16	12	6' SSHL	OPP SC	OPP SC
RESIDENTIAL LEAD	16	12	9' SSHL	OPP SC	OPP SC
887 VALOUR RD	16	12	9' SSHL	OPP SC	OPP SC
RESIDENTIAL LEAD	20	20	5.13m N/SL	OPP SC	TAPPED OPP
884 VALOUR RD	20	20	26.50m S/SL DYSON AVE	OPP SC	-
RESIDENTIAL LEAD	20	20	6.5' NSHL	1' S SC	-
890 VALOUR RD	20	20	4.32' NLL ST MATTHEWS AVE	1' N SC	-
RESIDENTIAL LEAD	20	20	3.3' SSL DYSON AVE	OPP SC	-
889 VALOUR RD	20	12	3' NSHL	OPP SC	-
RESIDENTIAL LEAD	20	20	8' NSHL	1' N SC	-
893 VALOUR RD	20	20	33' SSL DYSON AVE	OPP SC	-
RESIDENTIAL LEAD	12	12	9' NNHL	1' N SC	-
896 VALOUR RD	12	12	14' NLL DYSON AVE	OPP SC	-
RESIDENTIAL LEAD	20	20	6.5' NSHL	OPP SC	-
898 VALOUR RD	20	20	23' NLL DYSON AVE	OPP SC	-
RESIDENTIAL LEAD	12	12	1' SSL DOOR	x.x X OF S/C	-
900 VALOUR RD	12	12	546' NLL ST MATTHEWS AVE	OPP SC	MAY/05-RENEWED SERVICE BOX
RESIDENTIAL LEAD	20	12	3' NSHL	OPP SC	-
903 VALOUR RD	20	12	11.5' NLL DYSON AVE	OPP SC	-
RESIDENTIAL LEAD	12	20	1' S/SBL	OPP SC	-
904 VALOUR RD	12	20	29'9" N/SPL	OPP SC	-
RESIDENTIAL LEAD	20	20	4' NSHL	1' S SC	-
905 VALOUR RD	20	20	41' NLL DYSON AVE	OPP SC	-
RESIDENTIAL LEAD	20	20	7.5' NSHL	OPP SC	-
906 VALOUR RD	20	20	73.5' NLL DYSON AVE	OPP SC	-
RESIDENTIAL LEAD	20	20	2.5' NSHL	OPP SC	-
907 VALOUR RD	20	20	76' NLL DYSON AVE	OPP SC	-
RESIDENTIAL LEAD	20	20	108' NLL DYSON AVE	OPP SC	-
908 VALOUR RD	20	20	6' NSHL	1' N SC	-
RESIDENTIAL LEAD	20	20	44.3' SSL ELLICE AVE	OPP SC	-
910 VALOUR RD	12	12	416.5' SSL ELLICE AVE	OPP SC	-
RESIDENTIAL LEAD	20	20	6.35m S/NLL	0.3m S OF CS	-
911 VALOUR RD	20	20	48.77m N/NL DYSON AVE	OPP SC	-
RESIDENTIAL LEAD	12	12	6' NSHL	3' N SC	-
914 VALOUR RD	12	12	392' SSL ELLICE AVE	OPP SC	-
RESIDENTIAL LEAD	12	12	6.5' NSHL	1' N SC	-
916 VALOUR RD	12	12	394' SSL ELLICE AVE	OPP SC	-
RESIDENTIAL LEAD	20	20	5' NSHL	OPP SC	-
915 VALOUR RD	20	20	202' NLL DYSON AVE	OPP SC	-
RESIDENTIAL LEAD	12	12	3.5' NSHL	2' N SC	-
918 VALOUR RD	12	12	211' NLL DYSON AVE	OPP SC	-
RESIDENTIAL LEAD					

LEAD SERVICES TO BE RENEWED TO P. ALL OTHERS TO BE RECONNECTED

NOTE:  
ALL GATE VALVES ARE CLOCKWISE TO OPEN W/ A RED OPERATING NUT

**WARNING**  
IF POWER EQUIPMENT OR EXPLOSIVES ARE TO BE USED FOR EXCAVATION ON THIS PROJECT THE CONTRACTOR MUST:  
1) NOTIFY THE GAS COMPANY OF THE PROPOSED LOCATION OF EXCAVATION.  
2) TAKE PRECAUTION TO AVOID DAMAGE TO GAS COMPANY INSTALLATIONS.  
SEE PROVINCIAL REGULATION 21072 FOR DETAILS

**LOCATION APPROVED UNDERGROUND STRUCTURES**  
SUPV. U/G STRUCTURES COMMITTEE DATE  
NOTE:  
LOCATION OF UNDERGROUND STRUCTURES AS SHOWN ARE BASED ON THE BEST INFORMATION AVAILABLE BUT NO GUARANTEE IS GIVEN THAT ALL EXISTING UTILITIES ARE SHOWN OR THAT THE GIVEN LOCATIONS ARE EXACT. CONFIRMATION OF EXISTENCE AND EXACT LOCATION OF ALL SERVICES MUST BE OBTAINED FROM THE INDIVIDUAL UTILITIES BEFORE PROCEEDING WITH CONSTRUCTION.

B.M. ELEV.	CONSTRUCTION COMPLETION DATE: YYYY MM DD		
2	BID OPPORTUNITY 382-2014	APRIL/14	P.R.
1	DESIGN REVIEW W & W	APRIL/14	P.R.
NO.	REVISIONS	DATE	BY

**WSP** 1600 BUFFALO PLACE  
WINNIPEG, MB, R3T 6B8  
PHONE: 204-477-6650  
FAX: 204-474-2864  
WWW.WSPGROUP.COM

DESIGNED BY	P.R.	CHECKED BY	S.M.
DRAWN BY	R.H.	APPROVED BY	I.McK.
SCALE:	RELEASED FOR CONSTRUCTION		
HORIZONTAL 1:250	S. COURNOYER, P. ENG		
VERTICAL 1:50	DATE 2014 04 16		
DATE 2014 04 16	DATE 2014 04 15		

ENGINEER'S SEAL  
PROVINCE OF MANITOBA  
REGISTERED PROFESSIONAL ENGINEER  
I. G. MCKINNON

CONSULTANT DRAWING NUMBER  
141-13765-10

**THE CITY OF WINNIPEG**  
WATER AND WASTE DEPARTMENT  
ENGINEERING DIVISION

2014 WATERMAIN RENEWALS

VALOUR ROAD  
100M NNL OF ST. MATTHEWS AVENUE TO  
65M NNL OF DYSON AVENUE

SHEET 2 OF 3  
CITY DRAWING NUMBER  
D-13579

