

- REFERENCE NOTES**
- A. PAVEMENT DIMENSIONS ARE TO BACK OF CURB
 - B. BASELINE IS 12.0M NORTH OF SOUTH PROPERTY LINE
 - C. PROPERTY LINES OBTAINED FROM THE CITY OF WINNIPEG L.B.I.S., AND NO SCALE FACTOR WAS APPLIED
 - D. REFER TO AECOM FIELD BOOK NO. 4821, 4822 & 4823

- CONSTRUCTION NOTES:**
1. PLANE EXISTING ASPHALT AND CONSTRUCT NEW ASPHALTIC PAVEMENT OVERLAY TYPE 1A (AVERAGE THICKNESS 85mm)
 2. REMOVE EXISTING PAVEMENT AND CONSTRUCT NEW 200mm REINFORCED CONCRETE PAVEMENT c/w 85mm TYPE 1A ASPHALT OVERLAY
 3. REMOVE EXISTING CONCRETE SIDEWALK AND CONSTRUCT NEW 100mm SIDEWALK c/w PAVING STONE BAND (SEE DETAIL 1)
 4. RENEW EXISTING MONOLITHIC CURB RAMP (10mm HT. INTEGRAL)
 5. CONSTRUCT NEW MODIFIED BARRIER CURB (150mm AVG. HT. REVEAL SEPARATE)
 6. REMOVE EXISTING BARRIER CURB
 7. RENEW EXISTING BARRIER CURB (100mm AVG. HT. REVEAL)
 8. ADJUST EXISTING CATCH BASIN/MANHOLE TO GRADE
 9. REMOVE EXISTING FRAME AND COVER AND PLACE NEW FRAME AND COVER (AP-004 AND AP-005)
 10. INSTALL NEW CAST IRON RISER RING
 11. INSTALL NEW DETECTABLE SURFACE WARNING TILES
 12. REMOVE AND INSTALL NEW MTS MANHOLE FRAME AND COVER c/w 50mm CAST IRON RISER RING
 13. REMOVE TREE STUMP (BY OTHERS)
 14. INSTALL VALVE BOX EXTENSION
 15. REMOVE EXISTING CATCHBASIN AND CURB INLET
 16. INSTALL NEW CURB AND GUTTER INLET c/w CATCHBASIN (SD-024) AND CONNECT TO EXISTING LEAD
 17. REMOVE EXISTING CATCHPIT AND INSTALL NEW CURB AND GUTTER INLET c/w CATCHPIT (SD-023) AND CONNECT TO EXISTING CATCHBASIN
 18. REGRADE EXISTING PAVING STONES
 19. REMOVE EXISTING TREE WELL
 20. REMOVE AND INSTALL EXISTING BENCH (BY OTHERS)
 21. REMOVE AND INSTALL EXISTING GARBAGE BIN (BY OTHERS)
 22. REMOVE AND INSTALL EXISTING BUS SHELTER (BY OTHERS)
 23. INSTALL PAVING STONE (SEE DETAIL 2)
 24. REMOVE AND REINSTALL CONC. PLANTERS (BY OTHERS)
 25. RELOCATE STREET LIGHT (BY OTHERS)

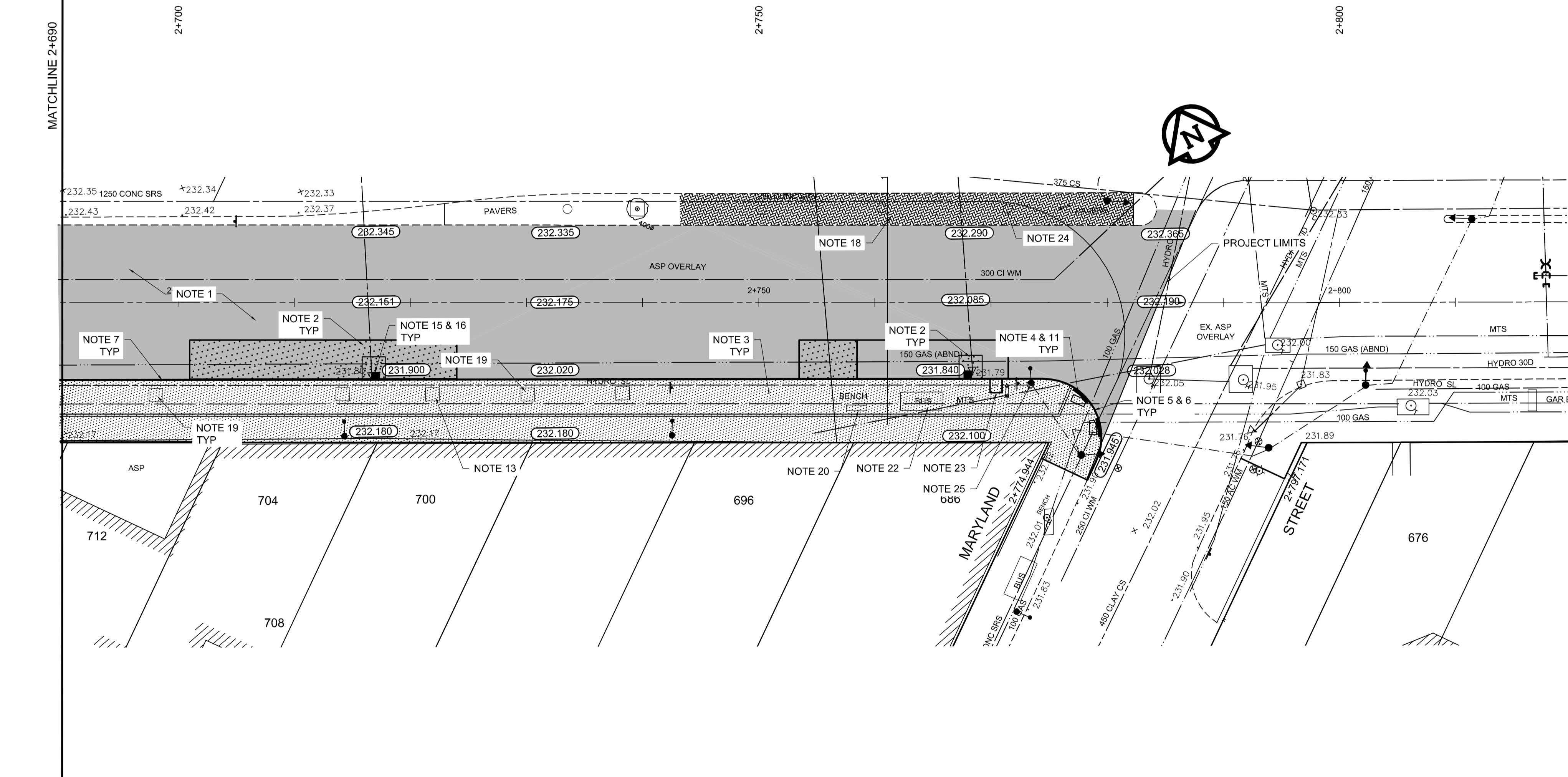

EXISTING	LEGEND - PLAN	PROPOSED	EXISTING	LEGEND - PLAN	PROPOSED	EXISTING	LEGEND - PROFILE	PROPOSED
150 mm W.W.M.	WATERMAIN	150 mm W.W.M.	---	HYDRO	---	x	C PROFILE	---
Hydrant	HYDRANT	Hydrant	---	M.T.S.	---	o	SOUTH/EAST GUTTER	---
Valve	VALVE	Valve	---	CONCRETE	---	o	MEDIAN GUTTER	---
300mm L.D.S.	LAND DRAINAGE SEWER	300mm L.D.S.	---	ASPHALT	---	o	N/W PROPERTY LINE	---
250mm W.W.S.	WASTEWATER SEWER	250mm W.W.S.	---	PROPERTY LINE	---	o	S/E PROPERTY LINE	---
Manhole	MANHOLE	Manhole	---	SURVEY BAR	---	o		---
Catch Basin	CATCH BASIN	Catch Basin	---	ELEVATION	(35.750)	o		---
Curb Inlet	CURB INLET	Curb Inlet	---	TREE	---	o		---
Building Outline	BUILDING OUTLINE	Building Outline	---	SIDEWALK RAMP	---	o		---
Culvert	CULVERT	Culvert	---	CONCRETE SIDEWALK	---	o		---
Gas	GAS	Gas	---	FENCE	---	o		---

LOCATION APPROVED UNDERGROUND STRUCTURES

SUPV. U/G STRUCTURES COMMITTEE DATE

NOTE:
LOCATION OF UNDERGROUND STRUCTURES AS SHOWN ARE BASED ON THE BEST INFORMATION AVAILABLE, BUT NO GUARANTEE IS GIVEN THAT ALL EXISTING UTILITIES ARE SHOWN OR THAT THE GIVEN LOCATIONS ARE EXACT. CONFIRMATION OF EXISTENCE AND EXACT LOCATION OF ALL SERVICES MUST BE OBTAINED FROM THE INDIVIDUAL UTILITIES BEFORE PROCEEDING WITH CONSTRUCTION.

B.M. 89R581
ELEV. 232.540

S.W. corner Portage Ave. & Sprague St., Tilt. on pipe, 4.8m E. of W.L. Sprague St. produced from the W. along the S.L. of Portage Ave.

ISSUED FOR TENDER 2014/06/26 KWR

AECOM

DESIGNED BY BC CHECKED BY KWR

DRAWN BY RT, PB APPROVED BY

HOR. SCALE: 1:250
VERTICAL: 1:10

RELEASED FOR CONSTRUCTION BY:

DATE 2014/06/26 DATE

ENGINEER'S SEAL

PROVINCE OF MANITOBA
ORIGINAL SIGNED BY
K.W. RAE
06/26/2014
REGISTERED PROFESSIONAL ENGINEER

CONSULTANT DRAWING NO. CT-11

METRIC
WHOLE NUMBERS INDICATE MILLIMETRES
DECIMALIZED NUMBERS INDICATE METRES

THE CITY OF WINNIPEG
PUBLIC WORKS DEPARTMENT
ENGINEERING DIVISION

PORTAGE AVENUE REHABILITATION:
PART A- EASTBOUND FROM SHERBURN ST. TO MARYLAND ST.
PART B- WESTBOUND FROM EMPRESS ST. TO MINTO ST.

PLAN / PROFILE PART A
STATION 2+690 TO 2+784

CITY DRAWING NUMBER P-3359-11
SHEET 11 OF 21