

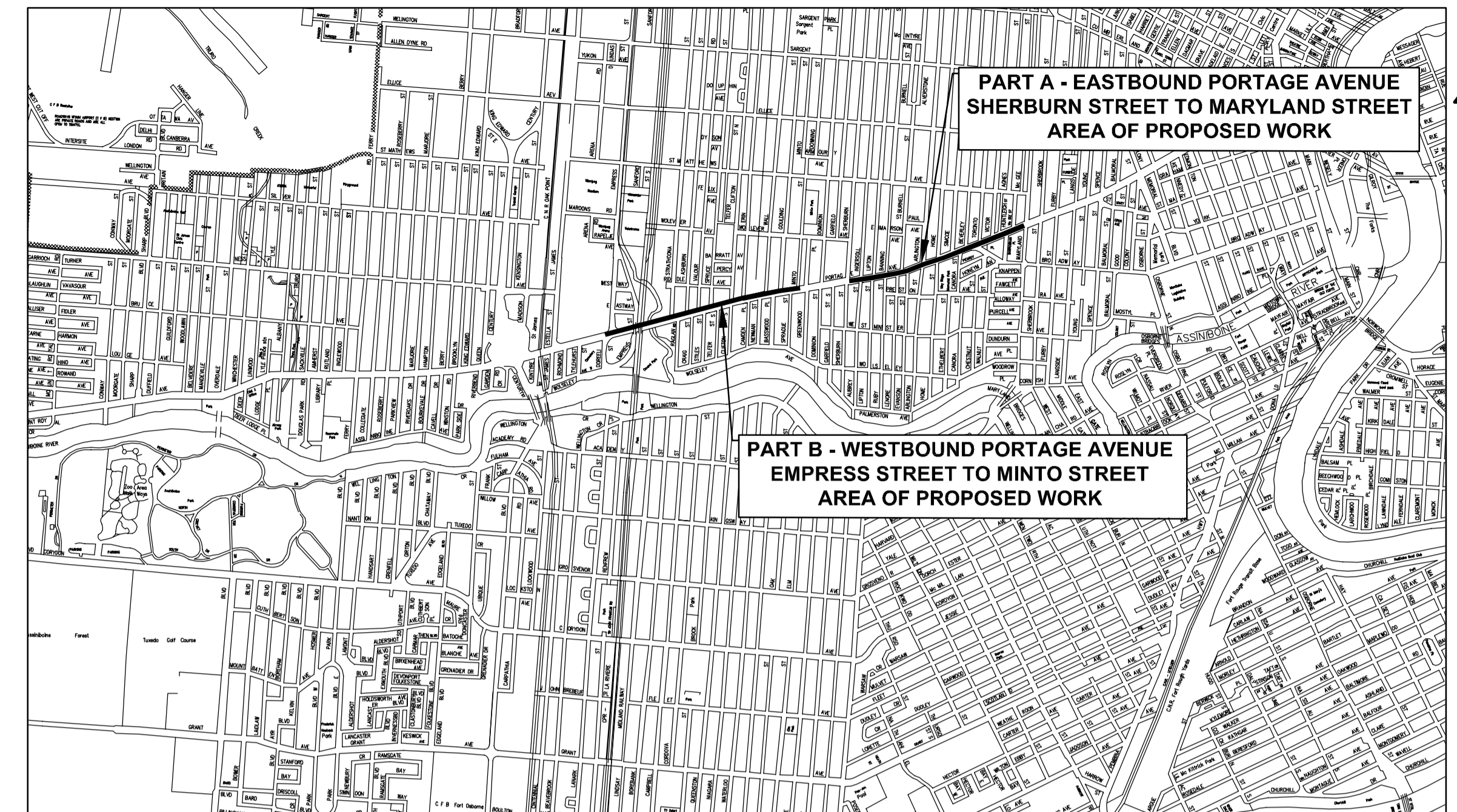

THE CITY OF WINNIPEG
PUBLIC WORKS DEPARTMENT
ENGINEERING DIVISION

PORTAGE AVENUE REHABILITATION
PART A- EASTBOUND FROM SHERBURN STREET TO MARYLAND STREET.
PART B- WESTBOUND FROM EMPRESS STREET TO MINTO STREET
BID OPPORTUNITY NO. 404-2014



LOCATION PLAN

DRAWING INDEX

TITLE

<u>PART A-EASTBOUND PORTAGE AVENUE SHERBURN STREET TO MARYLAND STREET</u>	<u>CITY OF WINNIPEG DRAWING No.</u>	<u>AECOM DRAWING No.</u>
COVER SHEET	P-3359-01	CT01
CONSTRUCTION STAGING PLAN (PART A)	P-3359-02	CT02
PLAN/PROFILE PART A STATION 1+639 TO STATION 1+730	P-3359-03	CT03
PLAN/PROFILE PART A STATION 1+730 TO STATION 1+870	P-3359-04	CT04
PLAN/PROFILE PART A STATION 1+870 TO STATION 1+990	P-3359-05	CT05
PLAN/PROFILE PART A STATION 1+990 TO STATION 2+130	P-3359-06	CT06
PLAN/PROFILE PART A STATION 2+130 TO STATION 2+270	P-3359-07	CT07
PLAN/PROFILE PART A STATION 2+270 TO STATION 2+410	P-3359-08	CT08
PLAN/PROFILE PART A STATION 2+410 TO STATION 2+550	P-3359-09	CT09
PLAN/PROFILE PART A STATION 2+550 TO STATION 2+690	P-3359-10	CT10
PLAN/PROFILE PART A STATION 2+690 TO STATION 2+784	P-3359-11	CT11

DRAWING INDEX

TITLE

<u>PART B-WESTBOUND PORTAGE AVENUE EMPRESS STREET TO MINTO STREET</u>	<u>CITY OF WINNIPEG DRAWING No.</u>	<u>AECOM DRAWING No.</u>
CONSTRUCTION STAGING PLAN (PART B)	P-3356-01	CT12
PLAN/PROFILE PART B STATION 0+110 TO STATION 0+220	P-3356-02	CT13
PLAN/PROFILE PART B STATION 0+220 TO STATION 0+360	P-3356-03	CT14
PLAN/PROFILE PART B STATION 0+360 TO STATION 0+500	P-3356-04	CT15
PLAN/PROFILE PART B STATION 0+500 TO STATION 0+630	P-3356-05	CT16
PLAN/PROFILE PART B STATION 0+630 TO STATION 0+770	P-3356-06	CT17
PLAN/PROFILE PART B STATION 0+770 TO STATION 0+910	P-3356-07	CT18
PLAN/PROFILE PART B STATION 0+910 TO STATION 1+050	P-3356-08	CT19
PLAN/PROFILE PART B STATION 1+050 TO STATION 1+170	P-3356-09	CT20
PLAN/PROFILE PART B STATION 1+170 TO STATION 1+304	P-3356-10	CT21



RELEASED FOR CONSTRUCTION BY :

B.KELLET
 STREETS PROJECT COORDINATOR
 DATE

ISSUED FOR TENDER

SET NO. _____
 AECOM PROJECT No. 60318473