

ALLEY PAVEMENT PROFILE

SCALE: 1:250 HOR
1:10 VER

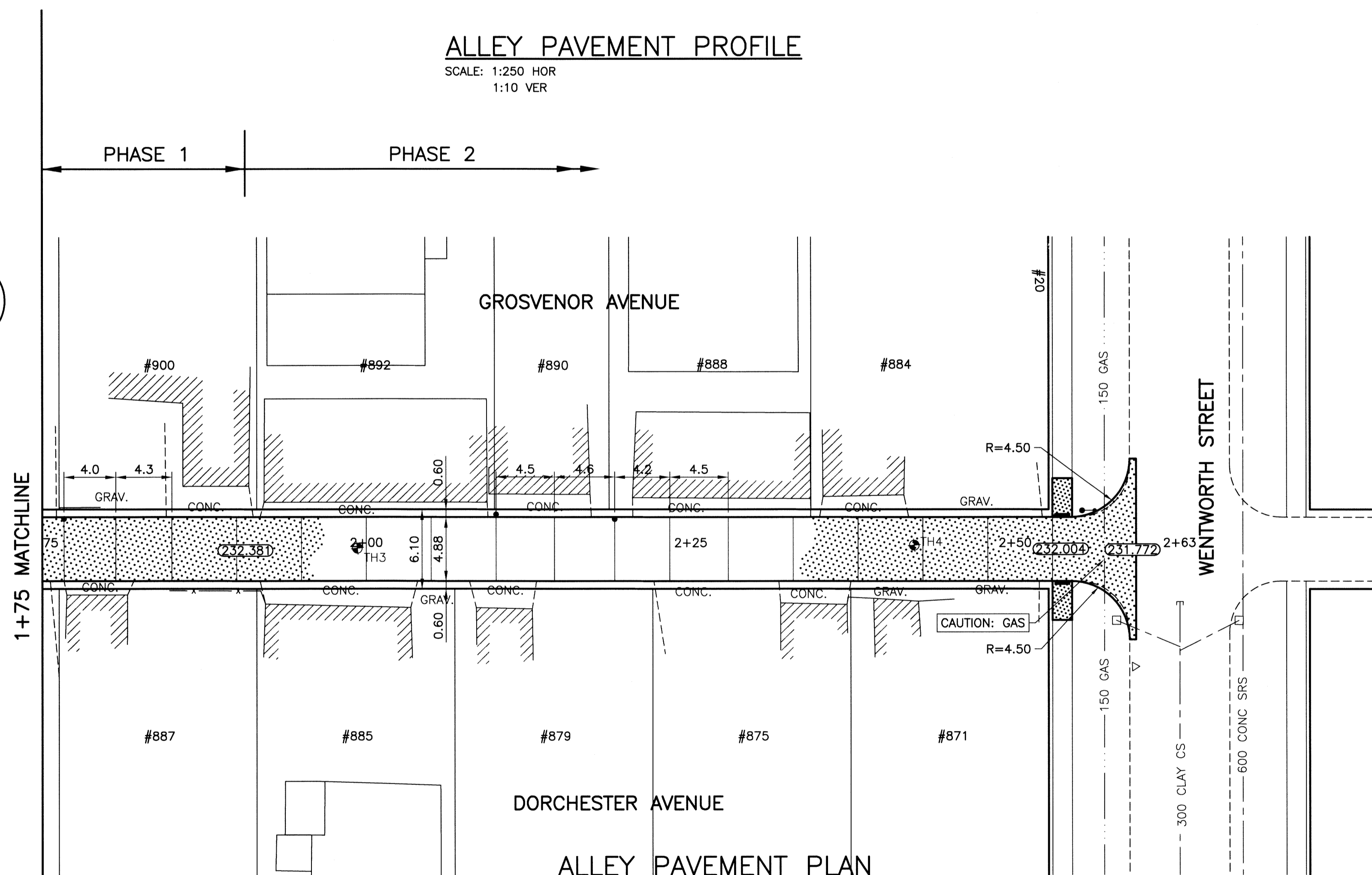

ALLEY PAVEMENT PLAN

SCALE: 1:250 HOR

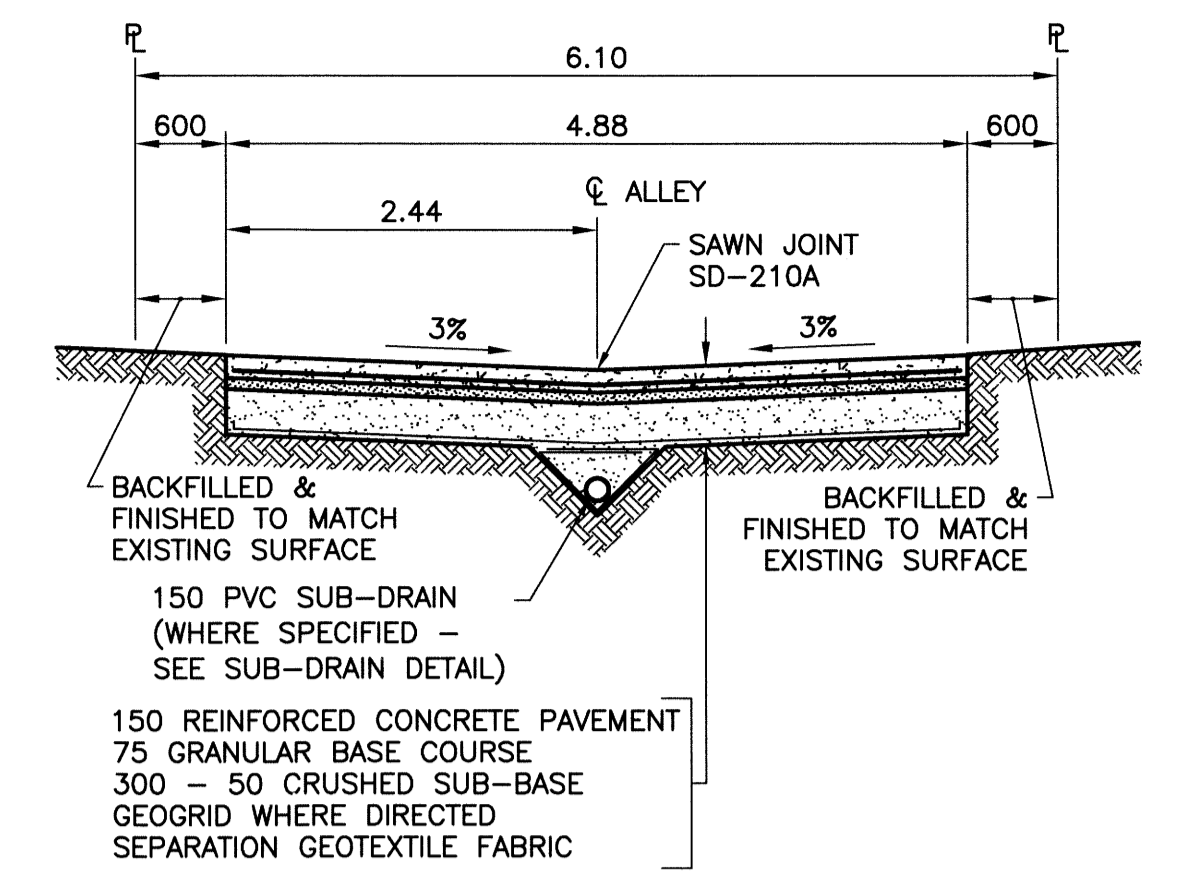

TYPICAL CROSS SECTION

SCALE: 1:50

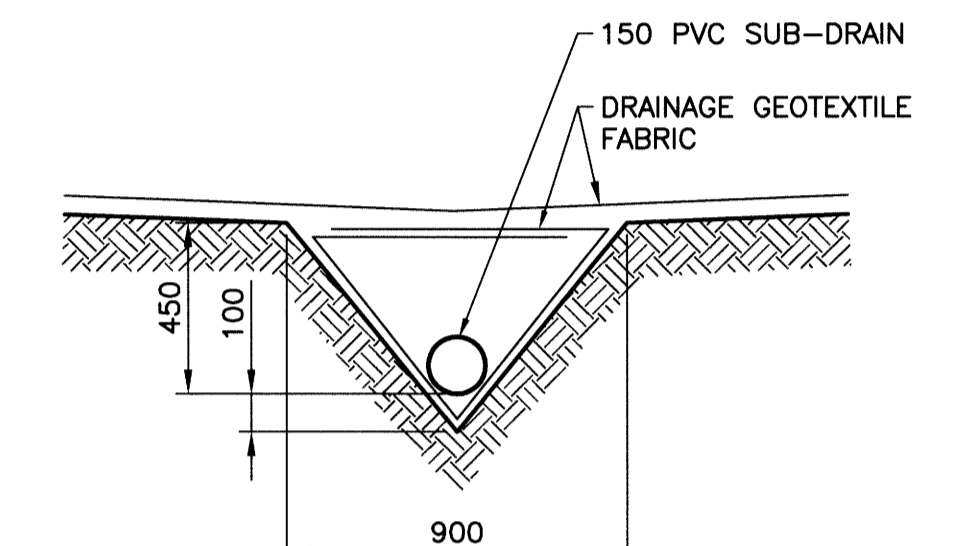

SUB-DRAIN DETAIL

SCALE: 1:20

NOTES:

1. STATION CHAINAGE IS BASED ON CENTERLINE OF ALLEY RIGHT OF WAY.
2. ADJUST MH AND CB RIMS TO NEW GRADES.
3. PLUG SUB-DRAINS AT TERMINAL ENDS.
4. REGRADE EXISTING PRIVATE SIDEWALKS AS REQUIRED.
5. INSTALLATION OF LIP CURBS AND THEIR EXTENTS TO BE DETERMINED BY THE CONTRACT ADMINISTRATOR.
6. LIGHT STANDARDS, HYDRO POLES AND ANCHORS MAY REQUIRE TEMPORARY SUPPORT/REMOVAL OR REPLACEMENT AT THE CONTRACTOR'S EXPENSE.
7. ISOLATE ALL POLES, BASES AND PILES WITHIN ALLEY RIGHT OF WAY (SD-228C)
8. AVOID DAMAGE TO EXISTING TREES WITHIN THE LIMITS OF CONSTRUCTION.

WARNING

NOTIFY THE GAS COMPANY OF THE PROPOSED LOCATION OF EXCAVATION. TAKE PRECAUTION TO AVOID DAMAGE TO GAS COMPANY INSTALLATIONS. SEE PROVINCIAL REGULATION 210/72 FOR DETAILS.

METRIC

WHOLE NUMBERS INDICATE MILLIMETRES
DECIMALIZED NUMBERS INDICATE METRES

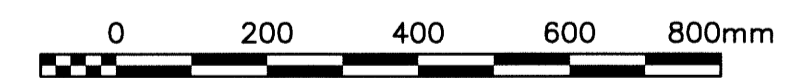

PROPERTY LIMITS DELINEATION

DELINEATION OF PROPERTY LIMITS AS SHOWN ON THIS DWG DOES NOT REPRESENT A "LEGAL SURVEY". KGS GROUP MAKES NO REPRESENTATION OR WARRANTY AS TO THE ACCURACY OF PROPERTY LIMITS DELINEATED ON THIS DWG, NOR ON THE DIMENSIONAL ACCURACY OF DWG FEATURES RELATIVE TO THOSE PROPERTY LIMITS.

P:\Projects\2013\13-0107-031\Doc\Control\Tobias\DWG\13-0107-031_C12-Rev 0.dwg - Tab: C12 Plotted By: GLoewen 05/22/2014 [Thu 10:08am] PLOT 1:1 A-1

300 LPS	LAND DRAINAGE SEWER	300 LPS	TEST HOLE			
250 WWS	WASTE WATER SEWER	250 WWS	GUY WIRE			
	GAS		LIGHT STANDARD			
	HYDRO		BACK OF CURB			
	M.T.S.		CONCRETE			
150 WM	WATERMAIN	150 WM	ASPHALT			
	HYDRANT		SIDEWALK			
	VALVE		PROPERTY LINE			
	MANHOLE		SURVEY BAR			
	CATCH BASIN		GEODETIC BENCHMARK			
	CURB INLET		ELEVATION	231.334		
	POLES					
EXISTING	LEGEND-PLAN	PROPOSED	EXISTING	LEGEND-PLAN	PROPOSED	EXISTING
				LEGEND-PROFILE	PROPOSED	

LOCATION APPROVED UNDERGROUND STRUCTURES

SUPV. U/G STRUCTURES COMMITTEE DATE

NOTE:
LOCATION OF UNDERGROUND STRUCTURES AS SHOWN ARE BASED ON THE BEST INFORMATION AVAILABLE BUT NO GUARANTEE IS GIVEN THAT ALL EXISTING UTILITIES ARE SHOWN OR THAT THE GIVEN LOCATIONS ARE EXACT. CONFIRMATION OF EXISTENCE AND EXACT LOCATION OF ALL SERVICES MUST BE OBTAINED FROM THE INDIVIDUAL UTILITIES BEFORE PROCEEDING WITH CONSTRUCTION.

B.M. 52-038
ELEV. 232.593
N.W. Cor. Grosvenor Ave. & Stafford St., Brass plug in 8.2m Conc. pile, 0.5m W. of W.L. Stafford St. & 2.1m s. of N.L. Grosvenor Ave.

0	ISSUED FOR TENDER	14/05/23	CR
NO.	REVISIONS	DATE	BY

KGS GROUP CONSULTING ENGINEERS

Certificate of Authorization
KGS Group
No. 245

DESIGNED BY: GES
CHECKED BY: CR
DRAWN BY: GEL
APPROVED BY: [Signature]

HOR. SCALE: 1:250
VERTICAL: 1:50

RELEASED FOR CONSTRUCTION: [Signature]

DATE: 14/03/14

ENGINEER'S SEAL

M.C. ROWBOTHAM
REGISTERED PROFESSIONAL ENGINEER
MAY 15, 2014

CONSULTANT DRAWING NO.
13-0107-007_C12

THE CITY OF WINNIPEG
PUBLIC WORKS DEPARTMENT
TRANSPORTATION ENGINEERING DIVISION

PROJECT TITLE
2013 ALLEY RENEWAL PROGRAM
CONTRACT 1
GROSVENOR AVE/DORCHESTER AVE
STAFFORD ST TO WENTWORTH ST
STA 1+75 TO WENTWORTH ST

SHEET OF
12 OF **14**

COMPUTER FILE NAME
13-0107-031_CALL

CITY DRAWING NUMBER
0012