

**ALLEY PAVEMENT PROFILE**  
SCALE: 1:250 HOR  
1:10 VER

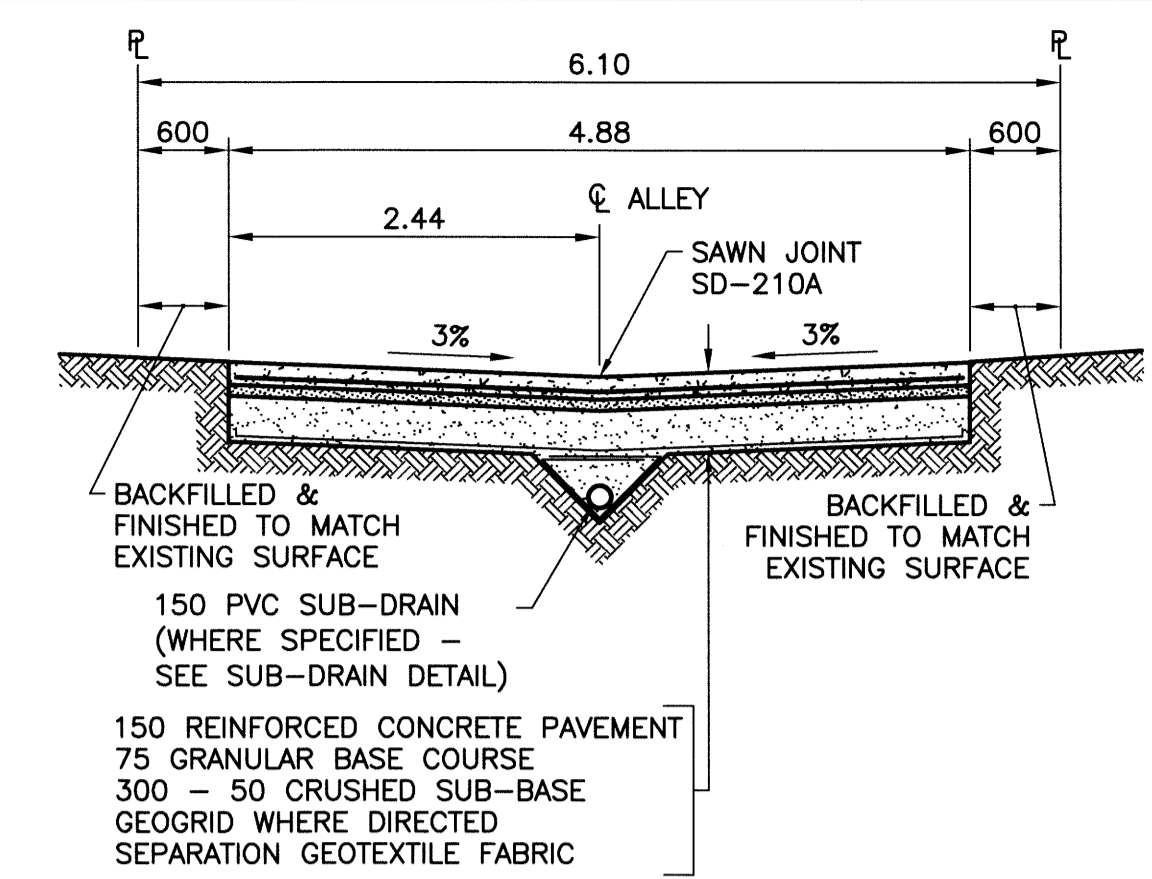

**TYPICAL CROSS SECTION**  
SCALE: 1:50

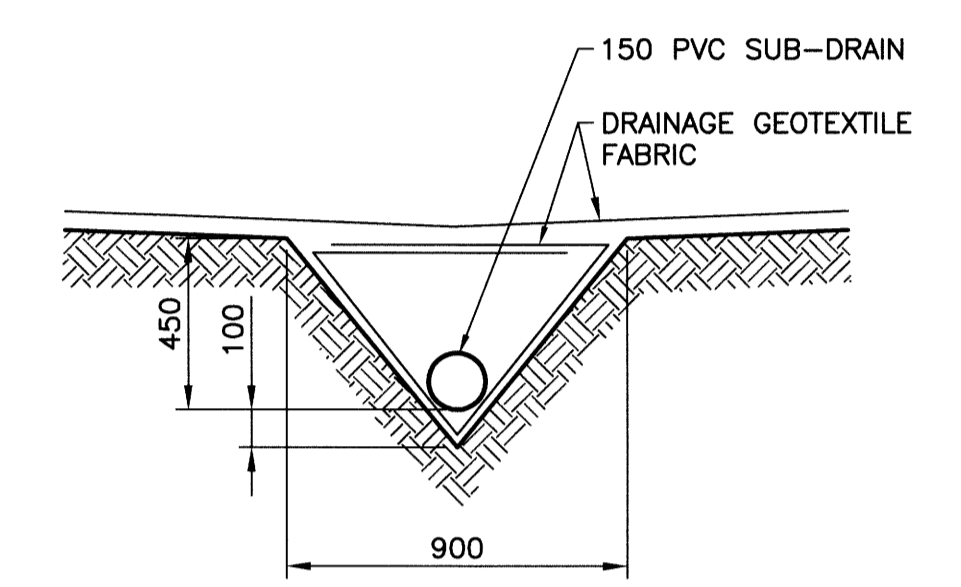

**SUB-DRAIN DETAIL**  
SCALE: 1:20

- NOTES:**
1. STATION CHAINAGE IS BASED ON CENTERLINE OF ALLEY RIGHT OF WAY.
  2. ADJUST MH AND CB RIMS TO NEW GRADES.
  3. PLUG SUB-DRAINS AT TERMINAL ENDS.
  4. REGRADE EXISTING PRIVATE SIDEWALKS AS REQUIRED.
  5. INSTALLATION OF LIP CURBS AND THEIR EXTENTS TO BE DETERMINED BY THE CONTRACT ADMINISTRATOR.
  6. LIGHT STANDARDS, HYDRO POLES AND ANCHORS MAY REQUIRE TEMPORARY SUPPORT/REMOVAL OR REPLACEMENT AT THE CONTRACTOR'S EXPENSE.
  7. ISOLATE ALL POLES, BASES AND PILES WITHIN ALLEY RIGHT OF WAY (SD-228C)
  8. AVOID DAMAGE TO EXISTING TREES WITHIN THE LIMITS OF CONSTRUCTION.

**WARNING**  
NOTIFY THE GAS COMPANY OF THE PROPOSED LOCATION OF EXCAVATION. TAKE PRECAUTION TO AVOID DAMAGE TO GAS COMPANY INSTALLATIONS. SEE PROVINCIAL REGULATION 210/72 FOR DETAILS.

**METRIC**  
WHOLE NUMBERS INDICATE MILLIMETRES  
DECIMALIZED NUMBERS INDICATE METRES

**PROPERTY LIMITS DELINEATION**  
DELINEATION OF PROPERTY LIMITS AS SHOWN ON THIS DWG DOES NOT REPRESENT A "LEGAL SURVEY". KGS GROUP MAKES NO REPRESENTATION OR WARRANTY AS TO THE ACCURACY OF PROPERTY LIMITS DELINEATED ON THIS DWG, NOR ON THE DIMENSIONAL ACCURACY OF DWG FEATURES RELATIVE TO THOSE PROPERTY LIMITS.

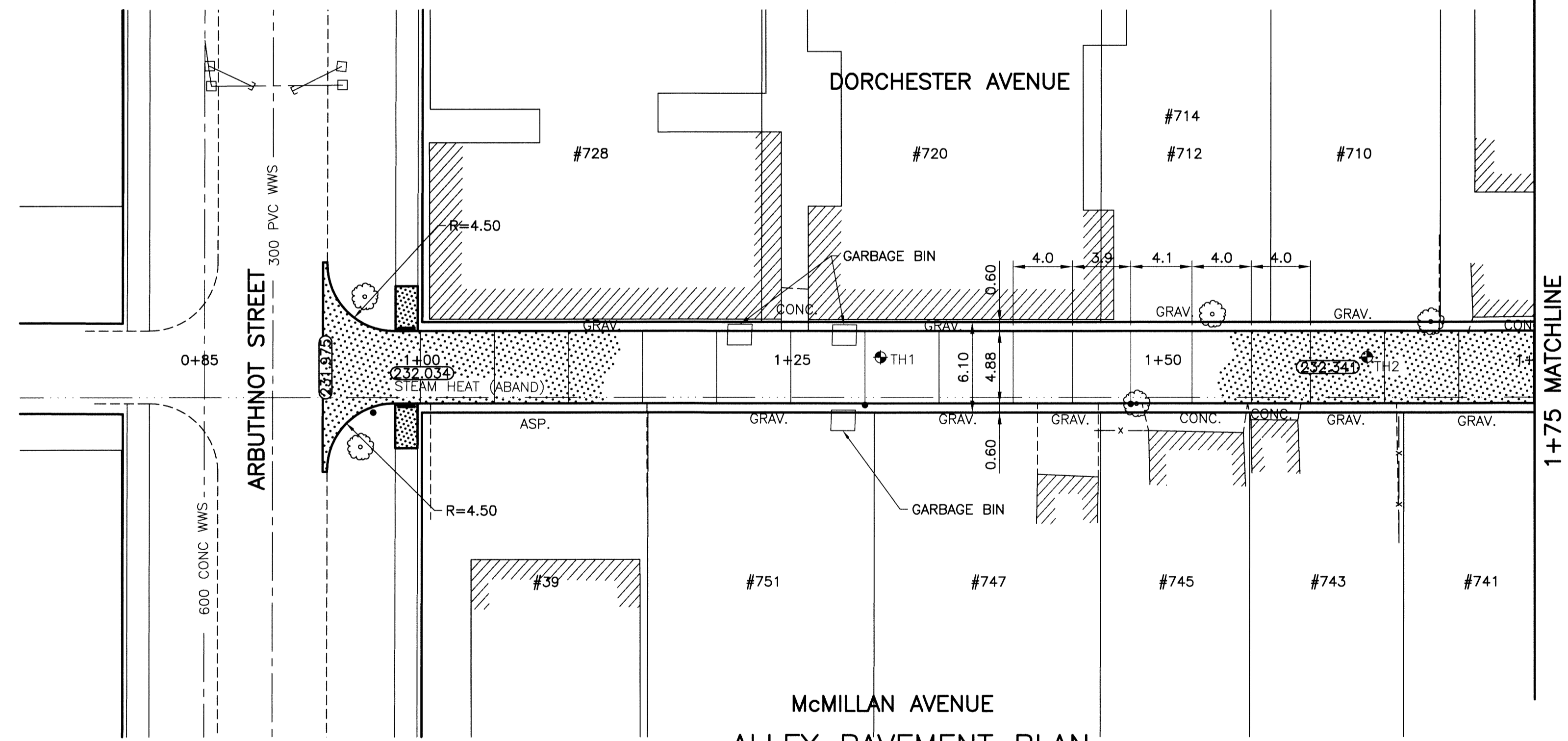

**ALLEY PAVEMENT PLAN**  
SCALE: 1:250 HOR

**APEGN**  
Certificate of Authorization  
KGS Group  
No. 245

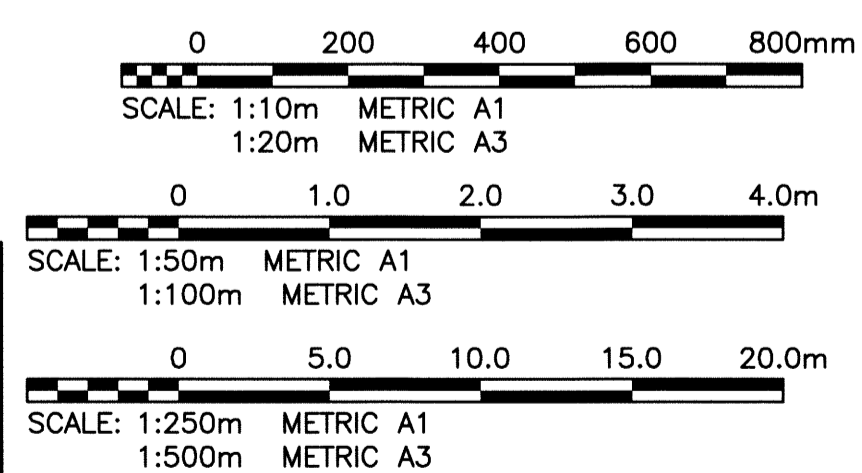

300 LBS	LAND DRAINAGE SEWER	300 LBS					
250 WWS	WASTE WATER SEWER	250 WWS	TEST HOLE				
	GAS		GUY WIRE				
	HYDRO		LIGHT STANDARD				
	M.T.S.		BACK OF CURB				
150 WM	WATERMAIN	150 WM	CONCRETE				
	HYDRANT		ASPHALT				
	VALVE		SIDEWALK				
	MANHOLE		PROPERTY LINE				
	CATCH BASIN		SURVEY BAR				
	CURB INLET		GEODETIC BENCHMARK				
	POLES		ELEVATION				
EXISTING	LEGEND-PLAN	PROPOSED	EXISTING	LEGEND-PLAN	PROPOSED	EXISTING	LEGEND-PROFILE

**LOCATION APPROVED UNDERGROUND STRUCTURES**

SUPV. U/G STRUCTURES COMMITTEE DATE

**NOTE:**  
LOCATION OF UNDERGROUND STRUCTURES AS SHOWN ARE BASED ON THE BEST INFORMATION AVAILABLE BUT NO GUARANTEE IS GIVEN THAT ALL EXISTING UTILITIES ARE SHOWN OR THAT THE GIVEN LOCATIONS ARE EXACT. CONFIRMATION OF EXISTENCE AND EXACT LOCATION OF ALL SERVICES MUST BE OBTAINED FROM THE INDIVIDUAL UTILITIES BEFORE PROCEEDING WITH CONSTRUCTION.

B.M. 52-035	S. side Condon Ave. E/W'n. Daly St. N. & Nassau St.
ELEV. 232.387	N. 10ft. In Conc. Foundation of 565 Condon Ave., 15.2m W. & 0.2m below track from S.E. Cor. of 34kg.

**KGS GROUP CONSULTING ENGINEERS**

DESIGNED BY: GES  
DRAWN BY: GEL  
CHECKED BY: CR  
APPROVED BY: [Signature]

HOR. SCALE: 1:250  
VERTICAL: 1:50

ISSUED FOR TENDER: 14/05/23  
NO. REVISIONS: [Blank]

**THE CITY OF WINNIPEG PUBLIC WORKS DEPARTMENT TRANSPORTATION ENGINEERING DIVISION**

PROJECT TITLE: 2013 ALLEY RENEWAL PROGRAM CONTRACT 1  
DORCHESTER AVE/McMILLAN AVE ARBUTHNOT ST TO COCKBURN ST  
ARBUTHNOT ST TO STA 1+75

ENGINEER'S SEAL: M.C. ROWBOTHAM, Registered Professional Engineer, No. 22679, May 25, 2014

SHEET OF: 13 OF 14  
COMPUTER FILE NAME: 13-0107-031\_CALL  
CITY DRAWING NUMBER: 0013

P:\Projects\2013\13-0107-031\Doc\Control\Tobelausad\DWG\13-0107-031\_C13-Rev 0.dwg - Tab: C13 Plotted By: Gloewen 05/22/2014 [Thu 10:09am]  
 PLOT 1:1 A-1