

MAYFAIR PLACE

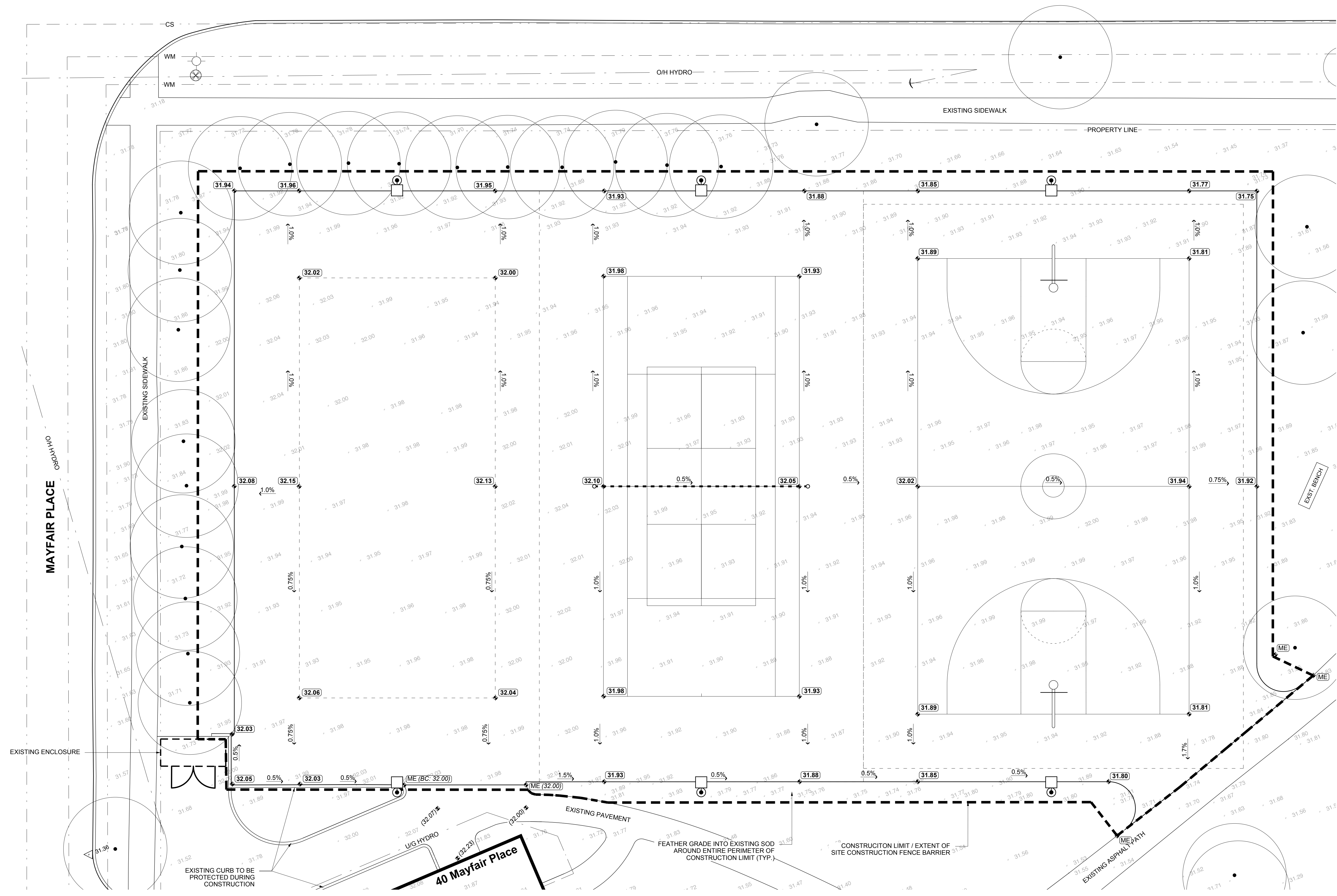

- GENERAL NOTES:**
1. ALL DIMENSIONS ARE IN METERS UNLESS OTHERWISE SPECIFIED.
 2. ENSURE THE LOCATION OF ALL EXISTING SERVICES BOTH OLD AND RECENTLY INSTALLED ARE CLEARLY LOCATED ON SITE PRIOR TO CONSTRUCTION. THE CONTRACTOR WILL BE RESPONSIBLE FOR REPAIRING ALL DAMAGE CAUSED TO SERVICES DURING CONSTRUCTION.
- UG SERVICE NOTES:**
1. LOCATIONS OF UNDERGROUND STRUCTURES AS SHOWN ARE BASED ON THE BEST INFORMATION AVAILABLE. BUT NO GUARANTEE IS GIVEN THAT ALL EXISTING ARE SHOWN OR THAT THE GIVEN LOCATIONS ARE EXACT. CONFIRMATION OF EXISTENCE AND EXACT LOCATION OF ALL SERVICES MUST BE OBTAINED FROM THE INDIVIDUAL UTILITIES BEFORE PROCEEDING WITH CONSTRUCTION. ANY ENCUMBRANCES SHALL BE REPORTED TO THE CONTRACT ADMINISTRATOR IMMEDIATELY.
 2. DUCTS CONTAIN FIBRE OPTIC CABLES MUST BE EXCAVATED IN ACCORDANCE WITH UTILITIES EXPRESS REQUIREMENTS. THE CONTRACTOR SHALL CONTACT THE UTILITY AT LEAST SEVEN (7) DAYS PRIOR TO EXCAVATION.
 3. A MINIMUM CLEARANCE OF 1.0 METER MUST BE PROVIDED BETWEEN THE UNDERSIDE OF ANY EXISTING WATERMAIN OR SEWERMAIN AND THE TOP OF PROPOSED WORKS.
 4. A MINIMUM CLEARANCE OF 0.5 METER MUST BE PROVIDED BETWEEN THE UNDERSIDE OF THE PROPOSED WORKS AND THE TOP OF ANY EXISTING WATERMAIN OR SEWERMAIN.
 5. A MINIMUM CLEARANCE OF 2.0 METERS MUST BE PROVIDED BETWEEN ANY EXISTING WATERMAIN OR SEWERMAIN PIPE AND THE PROPOSED WORKS.
 6. CONTACT THE CUSTOMER TECHNICAL SERVICES BRANCH AT 986-3322, 48 HOURS PRIOR TO CONSTRUCTION FOR CLEARANCE OF EXISTING WATER AND WASTEWATER UTILITIES.

- GENERAL LEGEND**
- PROPERTY LINE — PROPERTY LINE
 - WM — WATERMAIN
 - CS — SEWER LINE
 - O/H HYDRO — OVERHEAD HYDRO LINE
 - UG HYDRO — UNDERGROUND HYDRO
 - H — HYDRO POLE
 - △ — CATCH BASIN
 - ⊗ — WATER VALVE
 - ⊙ — HYDRANT
 - LIMIT OF WORK
 - — EXISTING TREES TO BE PROTECTED DURING CONSTRUCTION

- GRADING LEGEND**
- EXISTING GRADE
 - 31.94 PROPOSED GRADE
 - ME MATCH EXISTING
 - 0.5% DIRECTION OF SLOPE

1 GRADING PLAN
L3.0 SCALE: 1:100

No.	Date	Issue/Revision	By
3	14/05/26	ISSUED FOR TENDER	JH
2	14/05/02	ISSUED FOR 100% REVIEW	JH
1	11/02/14	ISSUED FOR 30% REVIEW	JH

Winnipeg
PLANNING PROPERTY AND DEVELOPMENT DEPARTMENT
3rd Floor - 65 Garry Street
Winnipeg, MB R2C 4K4

Contract Administrator
James Hudson

Electrical Engineer
TOWER ENGINEERING GROUP
UNIT 1 - 1140 WINDREY ST. WINNIPEG, MB R3T 0P4
TEL: (204) 925-1150 FAX: (204) 925-1155
EMAIL: towereng@towereng.ca WEB: www.towereng.ca

HTFC
PLANNING & DESIGN
500-115 Bannatyne Avenue East Winnipeg, MB R3B 0R3
PHONE 204 944 9907 WEB htfc.mb.ca

Project
MAYFAIR PARK ASPHALT AND LIGHTING IMPROVEMENTS
BCI II FORT ROUGE EAST FORT GARRY WARD
WINNIPEG, MANITOBA

Sheet Title
GRADING PLAN

Design	Drawn	Checked	Scale	Date	File	Sheet No.	Rev.
JH	JH	MG	1:100	11/02/14	14-008	L3.0	3

Tuesday, May 27, 2014

The general contractor shall check & verify all dimensions and report any errors or omissions to the Contract Administrator.