

HENDERSON HWY NB

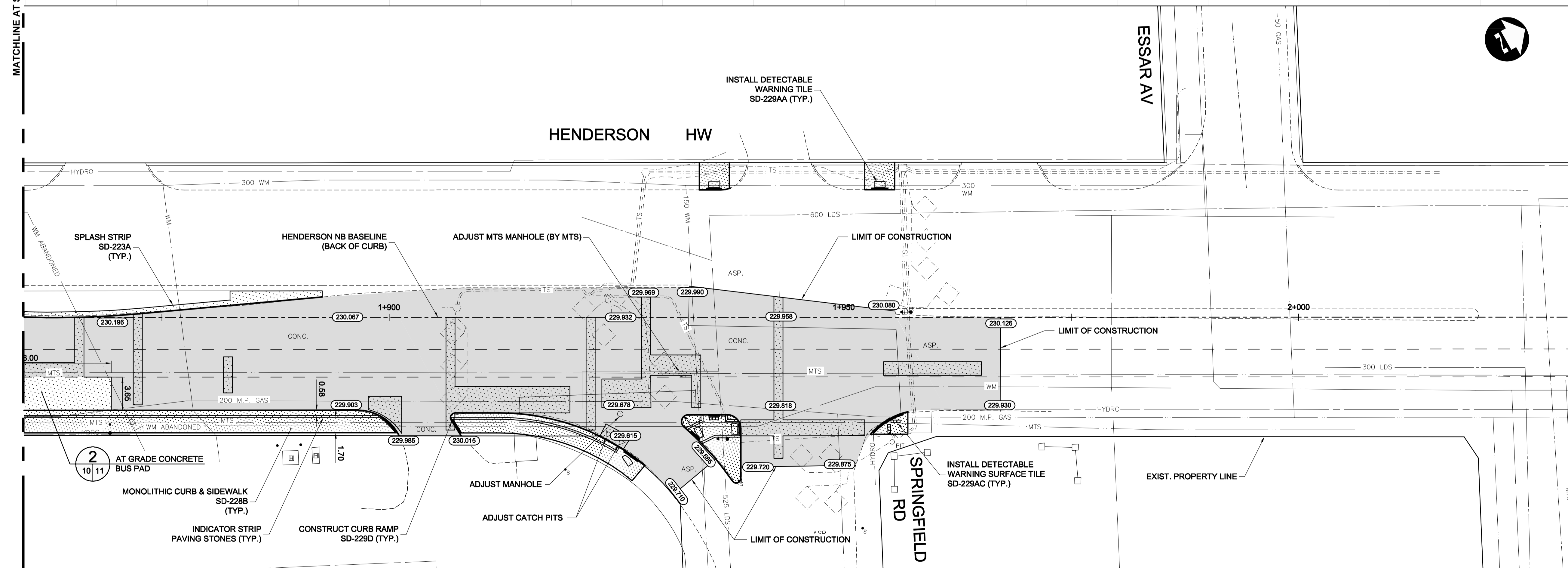

CONSTRUCTION NOTES:

1. MONOLITHIC CURB AND SIDEWALK SD-228B AND SPLASH STRIP SD-223A HEIGHT IS 150 mm UNLESS DIRECTED BY CONTRACT ADMINISTRATOR.
2. SEE SHEET 11 FOR TYPICAL CROSS SECTIONS AND DETAILS.
3. ALL DIMENSIONS ARE TO BACK OF CURB.
4. ISOLATE MISCELLANEOUS ITEMS IN NEW CONCRETE WORKS AS PER SD-220B AND SD-228C
5. PLANE EXISTING ASPHALT OVERLAY WITHIN LIMITS OF CONSTRUCTION TO DEPTH INDICATED BY CONTRACT ADMINISTRATOR.
6. LEGAL PLAN AND UNDERGROUND INFORMATION FROM THE CITY OF WINNIPEG LBIS.
7. LIMITS OF CURB, SIDEWALK, JOINT AND SLAB REPAIR, AND TIE-INS TO BE FINALIZED IN THE FIELD BY THE CONTRACT ADMINISTRATOR.
8. ADJUST ALL WATER VALVES, MANHOLES, AND DRAINAGE INLETS WITHIN LIMITS OF CONSTRUCTION.
9. PLACE CRUSHED RED SHALE MIX IN MEDIAN TO MATCH NEW TOP OF CURB GRADE AS NECESSARY.

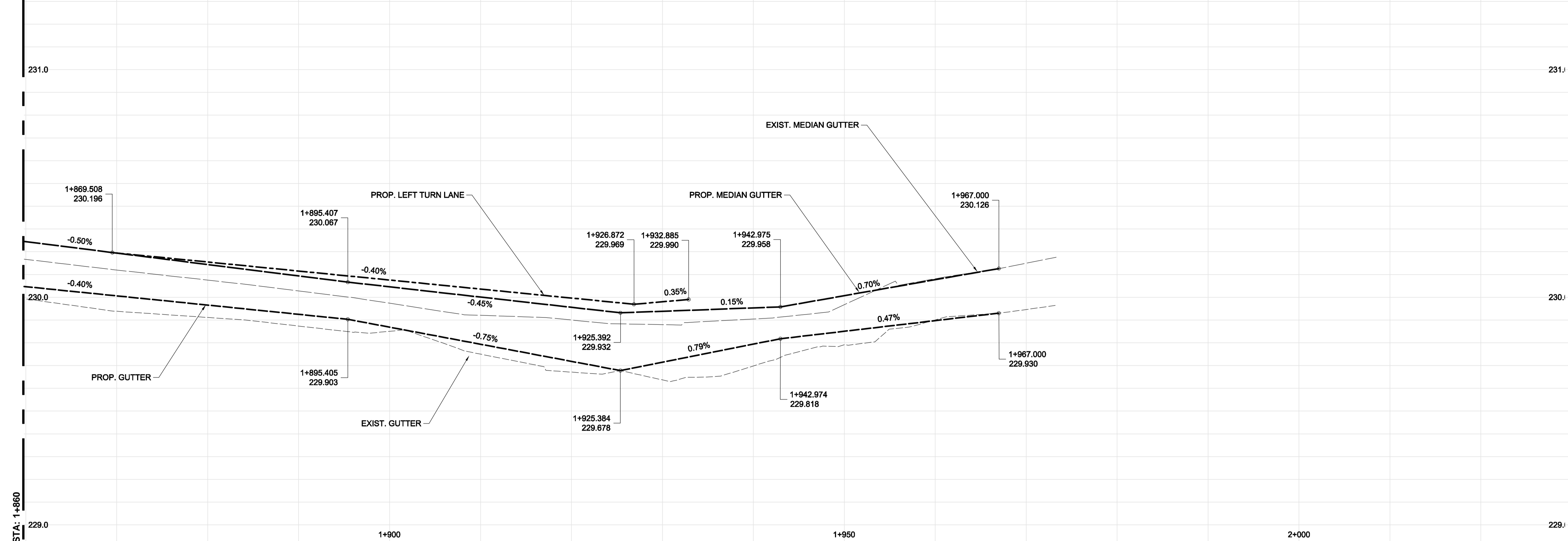

METRIC

WHOLE NUMBERS INDICATE MILLIMETRES
DECIMALIZED NUMBERS INDICATE METRES

WARNING

IF POWER EQUIPMENT OR EXPLOSIVES ARE TO BE USED FOR EXCAVATION ON THIS PROJECT THE CONTRACTOR MUST:

1. NOTIFY THE GAS COMPANY OF THE PROPOSED LOCATION OF EXCAVATION.
2. TAKE PRECAUTION TO AVOID DAMAGE TO GAS COMPANY INSTALLATIONS SEE PROVINCIAL REGULATION 210/72 FOR DETAILS.
3. OBTAIN EXCAVATION PERMITS PRIOR TO CONSTRUCTION.
4. A MINIMUM VERTICAL SEPARATION OF 300 mm FROM GAS MAINS AND 100 mm FROM GAS SERVICE MUST BE MAINTAINED BETWEEN ANY MANITOBA HYDRO FACILITY AND ANY NEW INSTALLATIONS.
5. A MINIMUM 900 mm OF COVER SHALL BE MAINTAINED IN ALL AREAS WHERE EQUIPMENT WILL BE CROSSING, TRAVELING OR COMPACTING OVER THE HIGH PRESSURE GAS MAINS.
6. IF EQUIPMENT MUST CROSS, TRAVEL, OR COMPACT OVER THE GAS MAIN WITH LESS THAN THE MINIMUM DEPTH COVER, EARTH BRIDGING OR STEEL PLATES SHALL BE PLACED OVER THE MAIN AND EXTEND A MINIMUM OF 1.0 METRE ON EITHER SIDE AT EACH CROSSING LOCATION.

G:\CAD\149129_1\Contract\Plan_Profile.dwg

150 WM	150 WM	MTS	M.T.S.	MTS	150 mm W.M.	150 mm W.M.
WATERMAIN	HYDRANT VALVE	LAND DRAINAGE SEWER	WASTE WATER SEWER	MANHOLE	CATCH BASIN	TEST HOLES
JUNCTIONS	CULVERT	100 GAS	EXISTING	LEGEND-PLAN	PROPOSED	EXISTING
CONCRETE	ASPHALT	PLANNING	SIDEWALK	PAVING STONES	PROPERTY LINE	SURVEY BAR
CURB RAMP	DITCH	SWALE	LEGEND-PLAN	PROPOSED	EXISTING	LEGEND-PROFILE
PROPOSED	PROPOSED	EXISTING	LEGEND-PROFILE	PROPOSED	EXISTING	PROPOSED

UNDERGROUND STRUCTURES

DESIGNED BY: GP
DRAWN BY: PMW
CHECKED BY: PMW
APPROVED BY: DBW

DATE: 2014/06/12

B.M. 654540 N: 55.9133.240 E: 634706.783
ELEV. 230.732 m

DESIGNED BY: GP
DRAWN BY: PMW
CHECKED BY: PMW
APPROVED BY: DBW

DATE: 2014/06/12

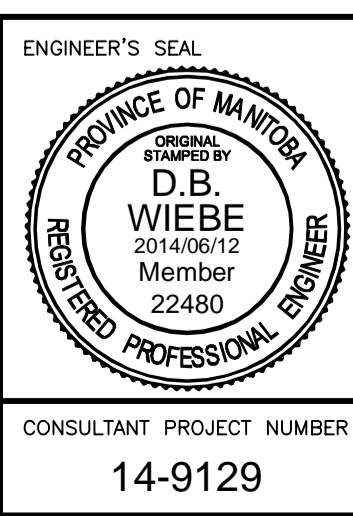

THE CITY OF WINNIPEG
PUBLIC WORKS DEPARTMENT

2014 REGIONAL STREETS PROGRAM:
HENDERSON HWY NORTHBOUND
McLEOD AVE TO SPRINGFIELD RD
MAJOR REHABILITATION

CITY DRAWING NUMBER: P-3357-10
SHEET 10 OF 11
CONSULTANT DRAWING NUMBER

PLAN AND PROFILE
STA: 1+860 TO 2+030

CONSULTANT PROJECT NUMBER: 14-9129