

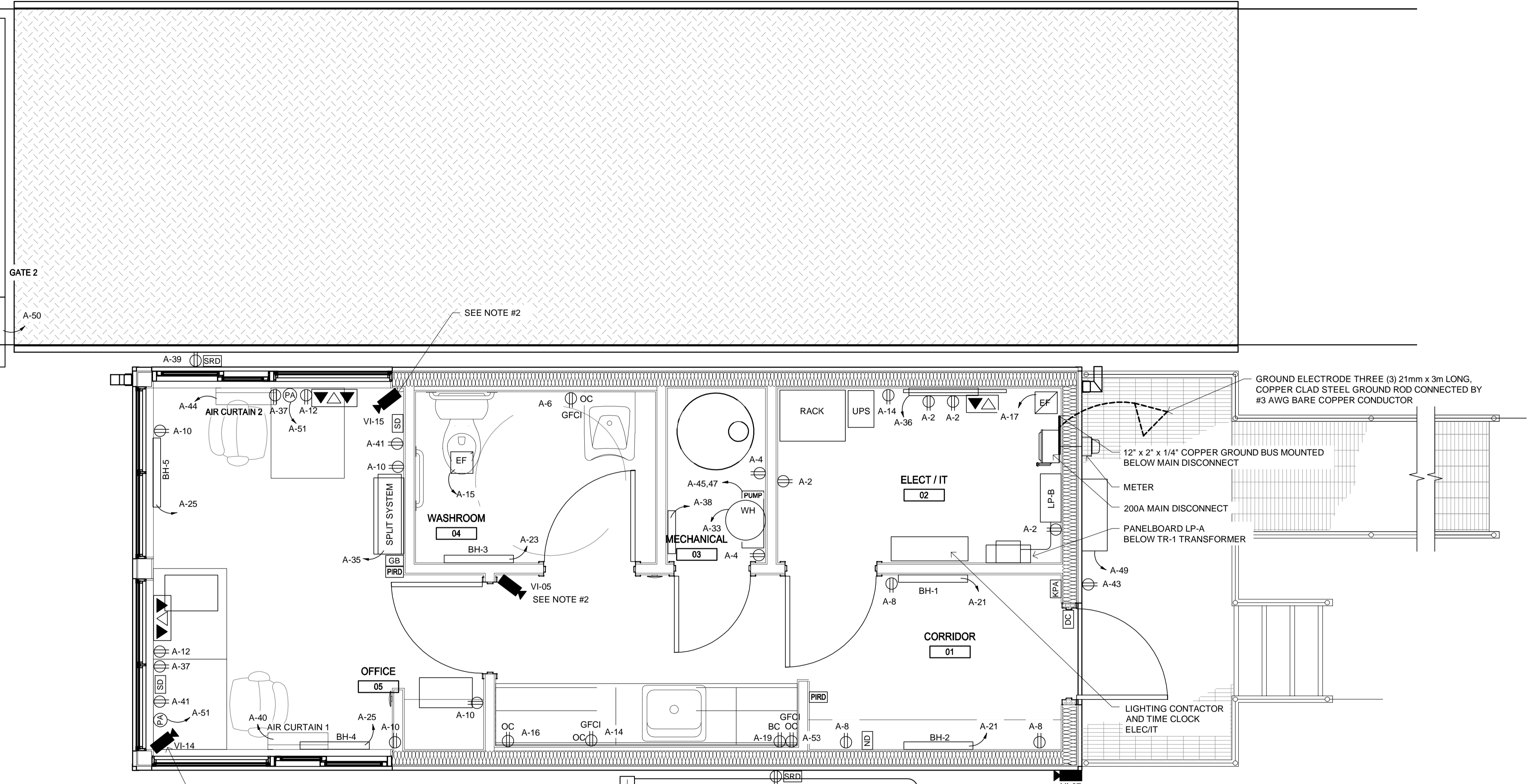

GALVANIZED TAPERED STEEL POST (SEE E8 FOR DETAIL)

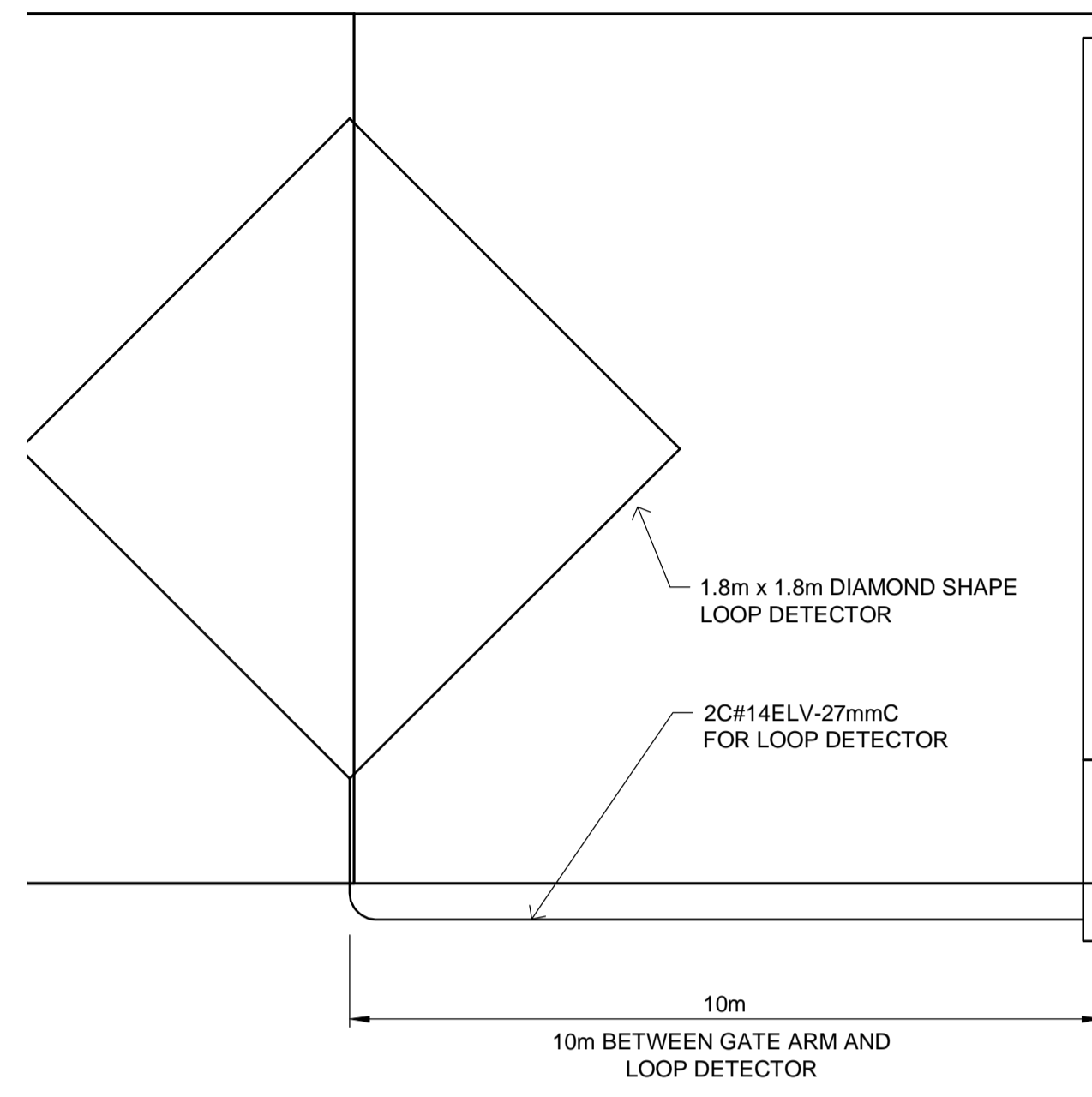

LEGEND	
SYMBOL	DESCRIPTION
[Symbol]	FLUORESCENT LIGHTING FIXTURE
[Symbol]	EMERGENCY / EXIT LIGHT
[Symbol]	REMOTE EMERGENCY LIGHTING DOUBLE HEAD
[Symbol]	SINGLE POLE 15A SWITCH
[Symbol]	TIMER SWITCH
[Symbol]	RECEPTACLE
[Symbol]	OVER THE COUNTER
[Symbol]	BELOW COUNTER
[Symbol]	COMBINATION DATA PORT
[Symbol]	SCALE REMOTE DISPLAY
[Symbol]	SCALE DIGITIZER
[Symbol]	PASSIVE IR DETECTOR
[Symbol]	NOTIFICATION DEVICE
[Symbol]	KEY PAD ALARM
[Symbol]	GLASS BREAKAGE
[Symbol]	DOOR CONTACTS
[Symbol]	CLERK PANIC ALARM BUTTON
[Symbol]	OUTDOOR LIGHT
[Symbol]	SECURITY CAMERA

- NOTES:
- EACH WORK STATION WILL REQUIRE AT LEAST THREE (3) NETWORK DROPS:
 - 1 PAYMENT STATION
 - 1 MERCHANT TERMINAL
 - 1 SECURITY MONITOR STATION
 - SECURITY CAMERAS:
 - ACTUAL FIELD OF VIEW TO BE DETERMINED ONSITE BY THE CONTRACT ADMINISTRATOR.
 - ALL CAMERAS PLACEMENTS AND TYPES MUST BE CONFIRMED BY THE CONTRACTOR. ALL SITE CONDITIONS
 - CONTRACTOR SHALL FOLLOW ALL MANUFACTURERS GUIDELINES FOR INSTALLATION OF CAMERAS.

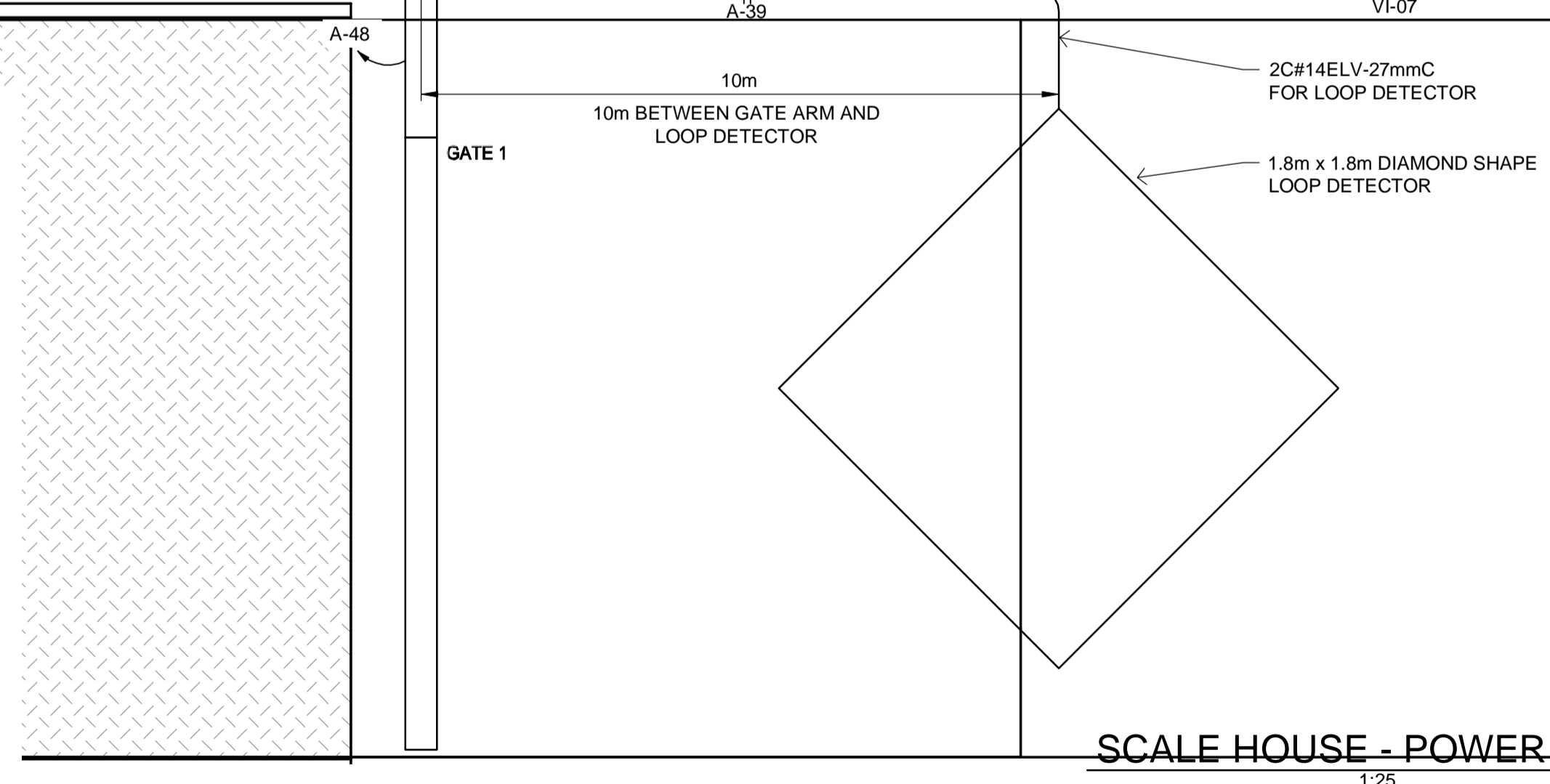

METRIC

WHOLE NUMBERS INDICATE MILLIMETRES
DECIMALIZED NUMBERS INDICATE METRES

SCALE HOUSE - POWER PLAN
1:25

B.M. ELEV. 1 ISSUED FOR TENDER 14/06/19 ARR NO. REVISIONS DATE BY DATE MARCH 2014	DESIGNED BY JAD DRAWN BY MS CHECKED BY BM APPROVED BY ARR	RELEASED FOR CONSTRUCTION DATE	ENGINEER'S SEAL PROVINCE OF MANITOBA ORIGINAL STAMPED BY B.L. MOORE 2014/06/19 REGISTERED PROFESSIONAL ENGINEER	4R WINNIPEG DEPOT BRADY ROAD RESOURCE MANAGEMENT FACILITY	CITY DRAWING NUMBER 1-0400A-E0002-001
	HOR. SCALE 1:25 VERTICAL				CONSULTANT PROJECT NUMBER 13-8224