

- GENERAL NOTES**
- CONTRACTOR TO CONFIRM ALL DIMENSIONS AND REPORT ANY DISCREPANCIES TO CONTRACT ADMINISTRATOR PRIOR TO CONSTRUCTION.
  - LAYOUT TO BE APPROVED BY CONTRACT ADMINISTRATOR PRIOR TO ANY CONSTRUCTION OR REMOVALS.
  - ALL DIMENSIONS ARE IN METRIC UNLESS OTHERWISE NOTED.
  - REFER ALSO TO WRITTEN SPECIFICATIONS.
  - CONTRACTOR IS RESPONSIBLE FOR ALL EXCAVATIONS, REMOVALS, DISPOSALS, AND ROUGH GRADING AS REQUIRED TO CONSTRUCT ALL WORKS AS SHOWN ON ALL PLANS, DETAILS AND SPECIFICATIONS. SAWCUT EXISTING PAVEMENT TO ENSURE CLEAN EDGE ON PAVEMENT TO REMAIN (NO BROKEN EDGES).
  - CONSTRUCTION ACCESS TO BE LIMITED TO THE AREAS SPECIFIED ON SITE BY CONTRACT ADMINISTRATOR
  - ALL PAINTED PAVEMENT MARKINGS SHOWN WITHIN LIMIT OF WORK & AS NOTED ON PLANS, TO BE INCLUDED IN WORK UNDER THIS CONTRACT.
  - LOCATION OF ALL UTILITIES SHOWN FOR ILLUSTRATION ONLY. CONTRACTOR MUST CONTACT ALL UTILITIES REGARDING RULES FOR WORKING IN THE AREA OF THE UTILITIES PRIOR TO COMMENCEMENT OF ANY WORK. CONTRACTOR MUST CONFIRM LOCATION OF ALL UTILITIES PRIOR TO CONSTRUCTION.
  - THE CONTRACTOR SHALL PROVIDE A QUALIFIED CREW TO LAYOUT STREETSCLAPING ELEMENTS. THE CREW SHALL BE EQUIPPED WITH ALL THE NECESSARY EQUIPMENT TO PROVIDE HORIZONTAL AND VERTICAL LAYOUT IN ACCORDANCE WITH THE PLANS AND SPECIFICATIONS.
  - LAYOUT ALL CONCRETE SAWCUTS FOR REVIEW AND APPROVAL BY CONTRACT ADMINISTRATOR PRIOR TO CONSTRUCTION.
  - ALL EXISTING TREES, SIDEWALKS, CURBS, FENCING, SOD, PAVING AND APPROACHES TO REMAIN TO BE PROTECTED DURING CONSTRUCTION TO CITY OF WINNIPEG STANDARDS. AREAS DAMAGED DURING CONSTRUCTION TO BE REPAIRED TO CITY OF WINNIPEG STANDARDS AT THE CONTRACTORS OWN COST.

- FILL ALL HOLES AND LOW AREAS TO DESIGN SUBGRADE WITH COMPACTED FILL (SUITABLE TO SURFACE FINISH). FOR SODDED/PLANTED AREAS USE COMPACTED CLEAN EARTH FILL SUITABLE FOR PLANT GROWTH. FOR PAVED AREAS USE COMPACTED GRANULAR BASE. REFER TO SPECIFICATIONS.
- USE SPECIFIED BACKFILL IN ALL TRENCHES RUNNING BELOW ALL STRUCTURES, PAVING, SWALES, ETC.
- CONTRACTOR TO ADJUST GRADES OF ALL SERVICES IN SIDEWALK AS REQUIRED. REFER TO ENGINEER'S DRAWINGS AND SPECIFICATIONS FOR ALL MANHOLE CATCH BASINS, FIRE HYDRANT, CURB STOPS, ETC. REMOVALS, RELOCATIONS AND ADJUSTMENTS.
- THERE ARE A SIGNIFICANT NUMBER OF AREAWAYS WITHIN THE AREA OF PROPOSED WORKS. CONTRACTOR TO VERIFY LOCATION OF ALL AREAWAYS. REFER TO STANTEC'S DRAWINGS AND SPECIFICATIONS FOR LOCATIONS. DEPTH OF BURIAL IS NOT KNOWN. CONTRACTOR SHOULD EXERCISE EXTREME CAUTION IN AREA OF ALL AREAWAYS. REFER TO STANTEC'S DRAWINGS AND SPECIFICATIONS FOR INFORMATION REGARDING AREAWAYS TO BE RECONSTRUCTED OR ABANDONED.
- LAYOUT OF ALL LIGHT STANDARDS TO BE REVIEWED AND APPROVED BY CONTRACT ADMINISTRATOR PRIOR TO INSTALLATION OF CONCRETE BASES, TREE WELLS AND DECORATIVE PAVING BY CONTRACTOR. CONTRACTOR TO ADJUST LOCATIONS AND PAVING PATTERNS ON SITE AS REQUIRED IN CONJUNCTION WITH THE CONTRACT ADMINISTRATOR.
- LOCATION OF TRAFFIC SIGNALS AND BASES (WORK BY SIGNALS) AS SHOWN ON THESE PLANS ARE APPROXIMATE ONLY. REFER TO DRAWINGS BY TRAFFIC SIGNALS SECTION OF THE STREETS AND TRANSPORTATION DEPT. FOR EXACT LOCATIONS. CONTRACTOR TO REPORT ANY MAJOR DISCREPANCIES TO CONTRACT ADMINISTRATOR TO ALLOW ADJUSTMENT OF AFFECTED ELEMENTS ON SITE.
- LOCATION OF ALL RAMP CURBS AND SIDEWALK RAMP TO BE CONFIRMED ON SITE RELATIVE TO SIGNAL POLE AND CROSSWALK LOCATIONS. ADJUST PAVING PATTERN AS REQUIRED. LOCATIONS TO BE APPROVED BY CONTRACT ADMINISTRATOR/ACCESSIBILITY CONSULTANT PRIOR TO CONSTRUCTION. ALL RAMP CURBS MUST BE

- SMOOTH WITH NO DIPS OR STEPS IN PAVING. ALL SIDEWALK RAMP TO HAVE A MAXIMUM 6% SLOPE UNLESS OTHERWISE NOTED.
- EXISTING BENCHES, GARBAGE RECEPTACLES, NEWSPAPER BOXES, AND MAIL BOXES TO BE TEMPORARILY RELOCATED BY CONTRACTOR. CONTRACTOR TO COORDINATE WITH RESPECTIVE PARTIES AS REQUIRED. EXISTING PARKING METERS TO BE REMOVED BY CITY OF WINNIPEG PUBLIC WORKS DEPARTMENT. CONTRACTOR TO INSTALL POST IN LOCATIONS INDICATED BY TRAFFIC SERVICES. POST TO BE SUPPLIED BY TRAFFIC SERVICES. REFER TO SITE SERVICES DRAWINGS FOR LOCATION OF ALL CURB CUTS, CATCH BASINS, SWALES, ETC.
  - CONTRACTOR TO SUPPLY AND INSTALL SQUARE CONCRETE COLLARS FOR ALL SURFACE UTILITIES IN SIDEWALK. WHERE COLLAR EXTENDS INTO PAVING BANDS CONTRACTOR TO ENSURE CONCRETE EXTENDS TO NEAREST LINE OF PAVER OR BRICK.
  - REFER TO SITE SERVICES DRAWINGS FOR LOCATION OF ALL CATCH BASINS, MANHOLES, FIRE HYDRANTS, ETC.
  - REMOVAL OF TRANSIT PRIORITY LANE SIGNAGE AND STREET SIGNAGE BY TRAFFIC SERVICES AS REQUIRED. CONTRACTOR TO INSTALL SIGN POST CLAMPS SUPPLIED BY TRAFFIC SERVICES IN LOCATIONS INDICATED BY TRAFFIC SERVICES
  - ALL BRICK AND UNIT PAVING EXTENDS BENEATH ALL STREET FURNITURE (PLANTERS, NEWSPAPER BOXES, GARBAGE RECEPTACLES AND BENCHES)
  - LOCATION OF ALL PLANT MATERIAL TO BE MARKED OUT ON SITE AND APPROVED BY CONTRACT ADMINISTRATOR PRIOR TO PLANTING.
  - ALL PLANT MATERIAL TO BE BEST QUALITY. PLANT MATERIAL TO BE REVIEWED ON SITE BY CONTRACT ADMINISTRATOR ON SITE PRIOR TO PLANTING. PLANTS NOT ACCEPTABLE ARE TO BE REPLACED AND NEW PLANTS APPROVED PRIOR TO PLANTING. REPLACEMENTS ARE AT THE CONTRACTOR'S OWN COST.
  - ALL PLANTING EXCAVATIONS ARE TO BE REVIEWED AND APPROVED BY CONTRACT ADMINISTRATOR PRIOR TO PLACEMENT OF DRAINAGE COURSE, FILTER FABRIC AND/OR SOIL.

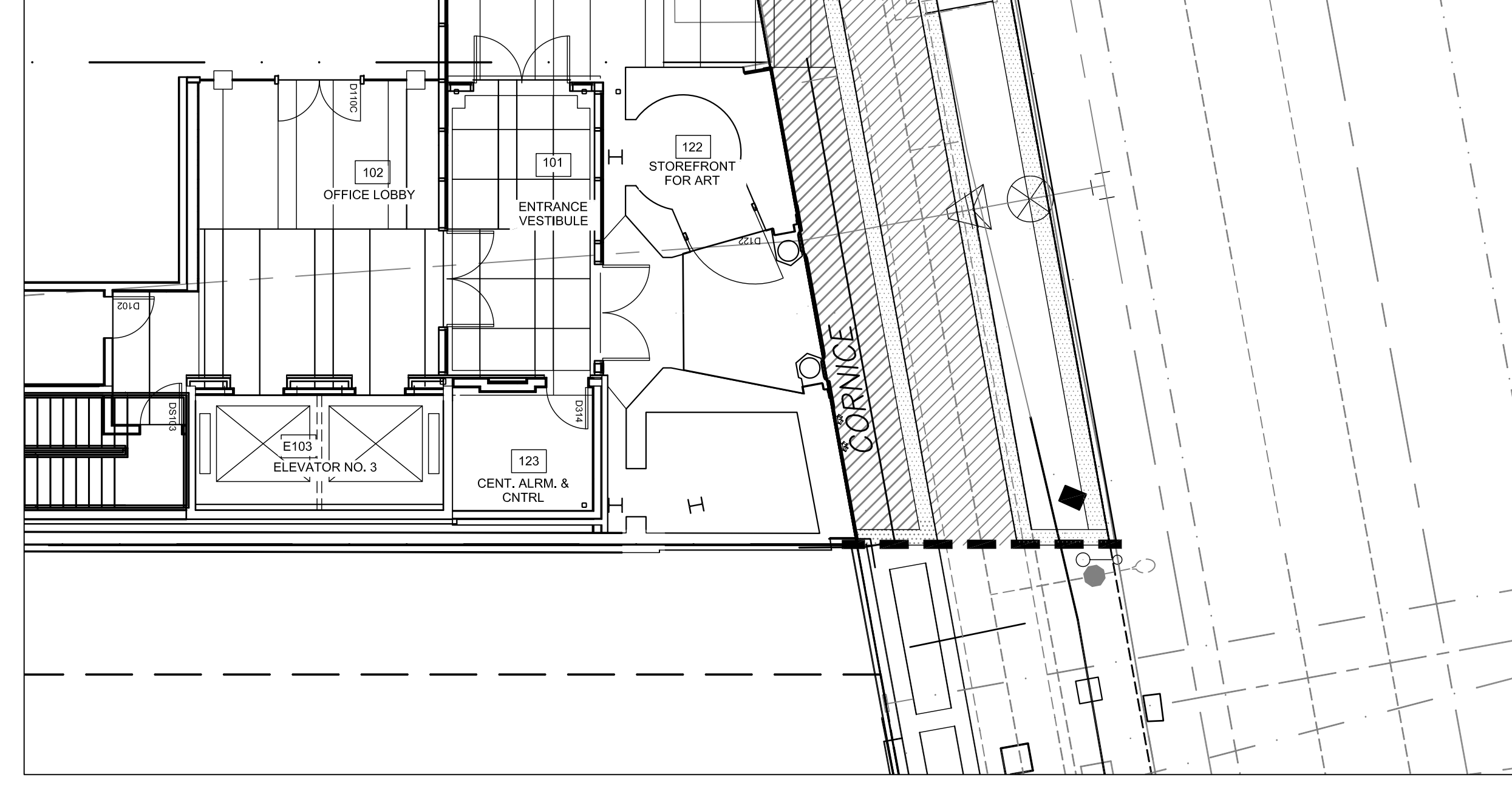

No.	Revisions	Date	By
10-07-14	1=100		
Designed By	Drawn By	Checked By	
JW	AR	JW	

**McGOWAN RUSSELL**  
Client  
**CENTRE VENTURE**

Project Title  
**CENTRE POINT SITE WORKS**

Sheet Title  
**LAYOUT PLAN**  
1 of 4

Project No. 12-017 Drawing No. L2.1