

KILDARE AVENUE WEST

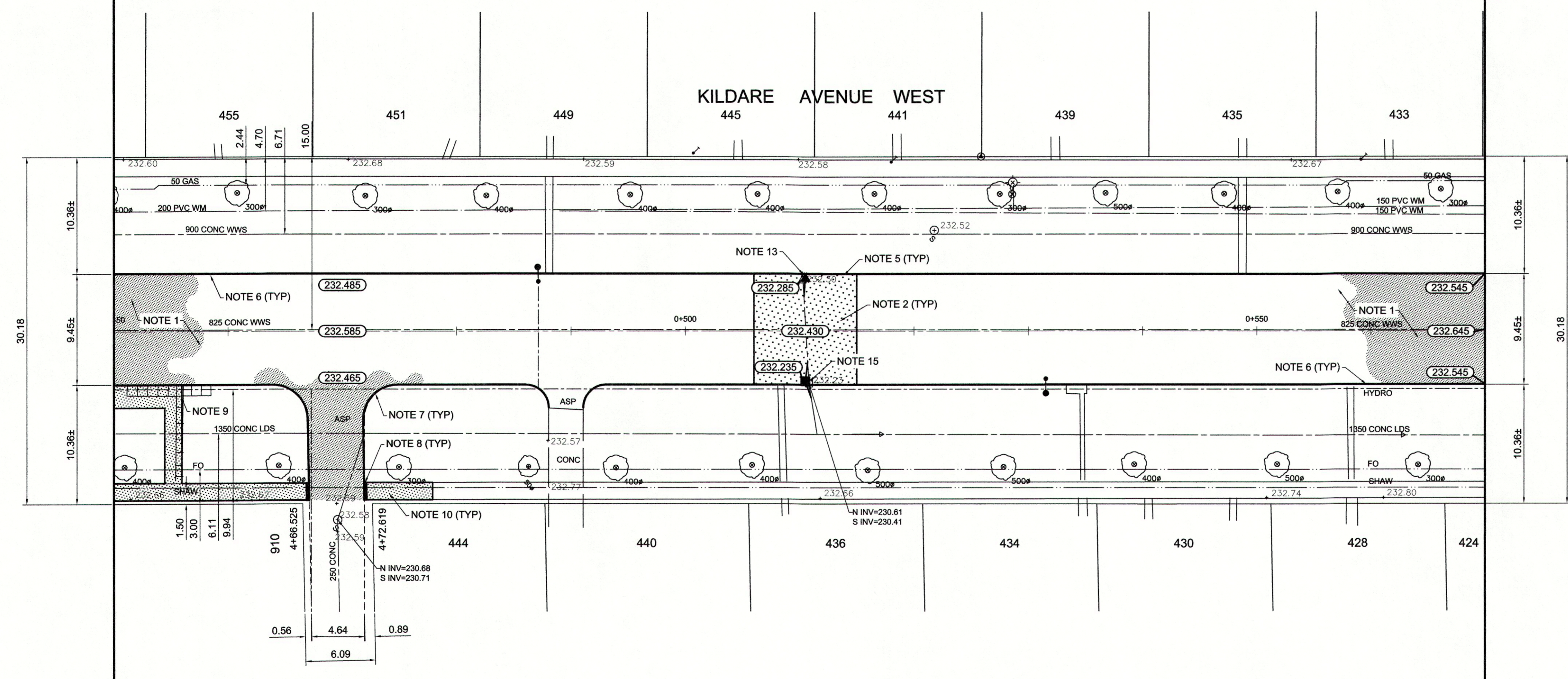

- REFERENCE NOTES**
- PAVEMENT DIMENSIONS ARE TO BACK OF CURB
  - BASELINE IS CENTRE LINE RIGHT-OF-WAY
  - PROPERTY LINES OBTAINED FROM CITY OF WINNIPEG L.B.I.S., AND NO SCALE FACTOR WAS APPLIED
  - REFER TO AECOM FIELD BOOK NO. 4807

- CONSTRUCTION NOTES**
- REMOVE EXISTING ASPHALTIC PAVEMENT AND PLACE NEW ASPHALTIC PAVEMENT TYPE 1A (AVG THICKNESS 85mm)
  - REMOVE EXISTING CONCRETE PAVEMENT AND CONSTRUCT NEW 200mm REINFORCED CONCRETE PAVEMENT c/w 85mm ASPHALT OVERLAY
  - REMOVE EXISTING FRAME AND COVER AND INSTALL NEW FRAME AND COVER (AP-005 AND AP-004)
  - ADJUST EXISTING MANHOLE/CATCH BASIN TO GRADE
  - CONSTRUCT NEW BARRIER CURB (100mm REVEAL HT. SEPARATE)
  - RENEW EXISTING BARRIER CURB (150mm REVEAL HT. DOWELLED)
  - REMOVE EXISTING CURB AND CONSTRUCT NEW MODIFIED BARRIER CURB (100mm REVEAL HT. DOWELLED)
  - CONSTRUCT NEW CURB RAMP (10mm HT. MONOLITHIC)
  - REMOVE EXISTING PATIO BLOCK BUS PAD AND CONSTRUCT NEW 100mm CONCRETE SIDEWALK
  - RENEW EXISTING 100mm CONCRETE SIDEWALK
  - ADJUST EXISTING WATER VALVE TO GRADE
  - ADJUST EXISTING CURB STOP
  - REMOVE EXISTING INLET AND INSTALL NEW CURB AND GUTTER INLET c/w CATCHPIT (SD-023) AND CONNECT TO EXISTING LEAD
  - REMOVE EXISTING INLET AND INSTALL NEW CURB AND GUTTER INLET c/w CATCHPIT (SD-023) AND CONNECT TO EXISTING CATCHBASIN
  - REMOVE EXISTING CATCHBASIN AND INSTALL NEW CURB AND GUTTER INLET c/w CATCHBASIN (SD-024) AND CONNECT TO EXISTING LEADS



**METRIC**  
WHOLE NUMBERS INDICATE MILLIMETRES  
DECIMALIZED NUMBERS INDICATE METRES

150 mm W.M.	150 mm W.M.	150 mm W.M.	HYDRO	EXISTING	PROPOSED	EXISTING	PROPOSED	EXISTING	PROPOSED				
WATERMAIN	HYDRANT	VALVE	M.T.S.	CONCRETE	ASPHALT	PROPERTY LINE	SURVEY BAR	ELEVATION	(35.750)	TREE	SIDEWALK RAMP	CONCRETE SIDEWALK	FENCE
300mm L.D.S.	LAND DRAINAGE SEWER	WASTEWATER SEWER	MANHOLE	CATCH BASIN	CATCH PIT	JUNCTIONS	CULVERT	GAS	EXISTING	LEGEND - PLAN	PROPOSED	EXISTING	LEGEND - PLAN
250mm W.W.S.	MANHOLE	CATCH BASIN	CATCH PIT	JUNCTIONS	CULVERT	GAS	EXISTING	LEGEND - PLAN	PROPOSED	EXISTING	LEGEND - PROFILE	PROPOSED	EXISTING

**LOCATION APPROVED UNDERGROUND STRUCTURES**

SUPV. U/G STRUCTURES COMMITTEE DATE

**NOTE:**  
LOCATION OF UNDERGROUND STRUCTURES AS SHOWN ARE BASED ON THE BEST INFORMATION AVAILABLE, BUT NO GUARANTEE IS GIVEN THAT ALL EXISTING UTILITIES ARE SHOWN OR THAT THE GIVEN LOCATIONS ARE EXACT. CONFIRMATION OF EXISTENCE AND EXACT LOCATION OF ALL SERVICES MUST BE OBTAINED FROM THE INDIVIDUAL UTILITIES BEFORE PROCEEDING WITH CONSTRUCTION.

B.M. 1236-C	Tbit in E conc foundation of bungalow with attached garage, #23 Burnaby Bay, 3.2m N of SE corner of building
ELEV. 233.016	
DESIGNED BY	BC/SS
CHECKED BY	KWR
DRAWN BY	PB/RT
APPROVED BY	
ISSUED FOR TENDER	03/04/14 BC
ISSUED FOR REVIEW	02/07/14 BC
NO. REVISIONS	DATE BY

**AECOM**

DESIGNED BY: BC/SS  
CHECKED BY: KWR  
DRAWN BY: PB/RT  
APPROVED BY: [Signature]  
HOR. SCALE: 1:250  
VERTICAL: 1:10  
RELEASED FOR CONSTRUCTION BY: [Signature]  
DATE: Mar 4/14

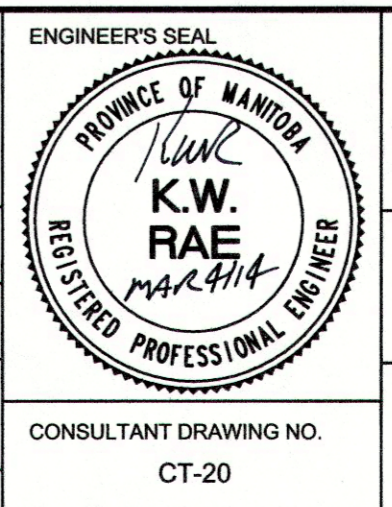

**THE CITY OF WINNIPEG**  
PUBLIC WORKS DEPARTMENT  
ENGINEERING DIVISION

2014 LOCAL STREET RENEWAL PROGRAM

KILDARE AVENUE WEST - BREWSTER STREET - DAY STREET  
REHABILITATION  
STATION 4+50 TO STATION 5+70

CITY DRAWING NUMBER: SHEET 20 OF 27

CONSULTANT DRAWING NO. CT-20