

MATCHLINE STATION 8+10

MATCHLINE STATION 9+40



REFERENCE NOTES

- A. PAVEMENT DIMENSIONS ARE TO BACK OF CURB
- B. BASELINE IS CENTRE LINE RIGHT-OF-WAY
- C. PROPERTY LINES OBTAINED FROM CITY OF WINNIPEG L.B.I.S., AND NO SCALE FACTOR WAS APPLIED
- D. REFER TO AECOM FIELD BOOK NO. 4807

KILDARE AVENUE WEST

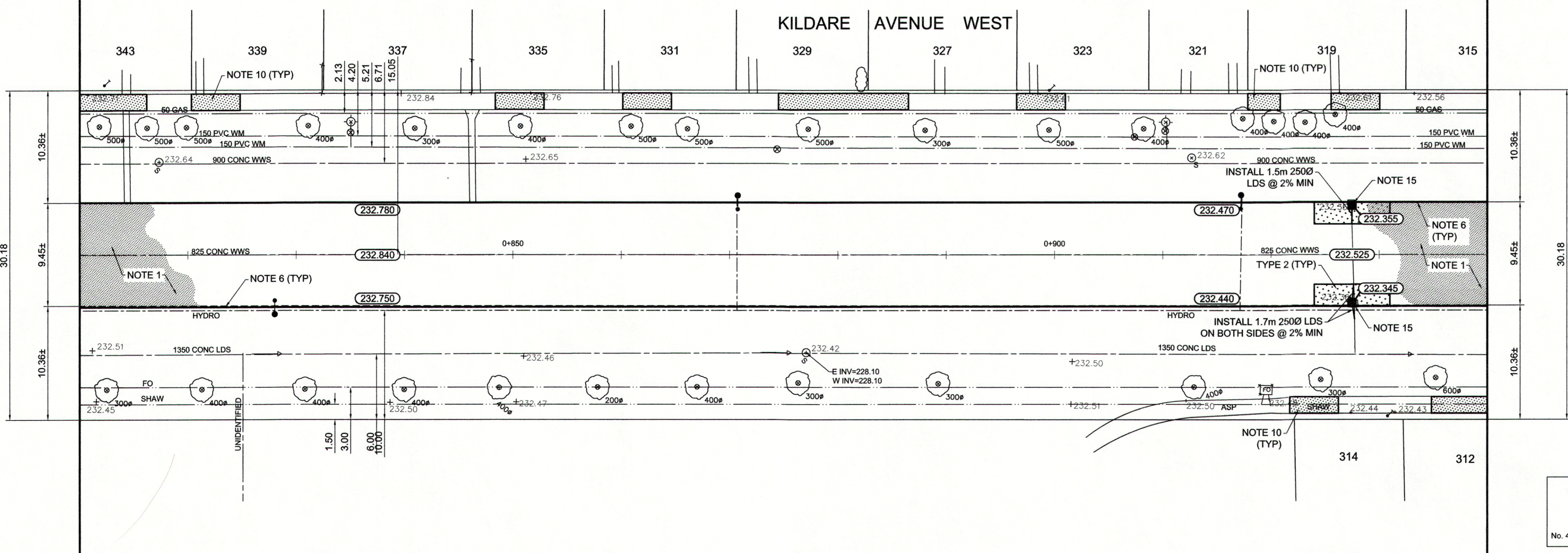

CONSTRUCTION NOTES

1. REMOVE EXISTING ASPHALTIC PAVEMENT AND PLACE NEW ASPHALTIC PAVEMENT TYPE 1A (AVG THICKNESS 85mm)
2. REMOVE EXISTING CONCRETE PAVEMENT AND CONSTRUCT NEW 200mm REINFORCED CONCRETE PAVEMENT c/w 85mm ASPHALT OVERLAY
3. REMOVE EXISTING FRAME AND COVER AND INSTALL NEW FRAME AND COVER (AP-005 AND AP-004)
4. ADJUST EXISTING MANHOLE/CATCH BASIN TO GRADE
5. INSTALL NEW CAST IRON RISER RING
6. RENEW EXISTING BARRIER CURB (100mm REVEAL HT. DOWELLED)
7. REMOVE EXISTING CURB AND CONSTRUCT NEW MODIFIED BARRIER CURB (100mm REVEAL HT. DOWELLED)
8. CONSTRUCT NEW CURB RAMP (10mm HT. MONOLITHIC)
9. REMOVE EXISTING PATIO BLOCK BUS PAD AND CONSTRUCT NEW 100mm CONCRETE SIDEWALK
10. RENEW EXISTING 100mm CONCRETE SIDEWALK
11. ADJUST EXISTING WATER VALVE TO GRADE
12. ADJUST EXISTING CURB STOP
13. REMOVE EXISTING INLET AND INSTALL NEW CURB AND GUTTER INLET c/w CATCHPIT (SD-023) AND CONNECT TO EXISTING LEAD
14. REMOVE EXISTING INLET AND INSTALL NEW CURB AND GUTTER INLET c/w CATCHPIT (SD-023) AND CONNECT TO EXISTING CATCHBASIN
15. REMOVE EXISTING CATCHBASIN AND INSTALL NEW CURB AND GUTTER INLET c/w CATCHBASIN (SD-024) AND CONNECT TO EXISTING LEADS



METRIC
WHOLE NUMBERS INDICATE MILLIMETRES
DECIMALIZED NUMBERS INDICATE METRES

EXISTING	LEGEND - PLAN	PROPOSED	EXISTING	LEGEND - PLAN	PROPOSED	EXISTING	LEGEND - PROFILE	PROPOSED
150 mm W.M.	WATERMAIN	150 mm W.M.	HYDRO	HYDRO	HYDRO	---	C PROFILE	---
300mm L.D.S.	LAND DRAINAGE SEWER	300mm L.D.S.	CONCRETE	CONCRETE	CONCRETE	---	NORTH/WEST GUTTER	---
250mm W.W.S.	WASTEWATER SEWER	250mm W.W.S.	ASPHALT	ASPHALT	ASPHALT	---	SOUTH/EAST GUTTER	---
○	MANHOLE	○	PROPERTY LINE	PROPERTY LINE	PROPERTY LINE	---	N/W PROPERTY LINE	---
□	CATCH BASIN	□	SURVEY BAR	SURVEY BAR	SURVEY BAR	---	S/E PROPERTY LINE	---
▽	CATCH PIT	▽	ELEVATION	ELEVATION	ELEVATION	---		
+	JUNCTIONS	+	TREE	TREE	TREE	---		
—	CULVERT	—	SIDEWALK RAMP	SIDEWALK RAMP	SIDEWALK RAMP	---		
—	GAS	—	CONCRETE SIDEWALK	CONCRETE SIDEWALK	CONCRETE SIDEWALK	---		
---	LEGEND - PLAN	---	FENCE	FENCE	FENCE	---		

LOCATION APPROVED UNDERGROUND STRUCTURES

SUPV. U/G STRUCTURES COMMITTEE DATE

NOTE:
LOCATION OF UNDERGROUND STRUCTURES AS SHOWN ARE BASED ON THE BEST INFORMATION AVAILABLE, BUT NO GUARANTEE IS GIVEN THAT ALL EXISTING UTILITIES ARE SHOWN OR THAT THE GIVEN LOCATIONS ARE EXACT. CONFIRMATION OF EXISTENCE AND EXACT LOCATION OF ALL SERVICES MUST BE OBTAINED FROM THE INDIVIDUAL UTILITIES BEFORE PROCEEDING WITH CONSTRUCTION.

B.M. ELEV.	1236-C	Tilt in E conc foundation of bungalow with attached garage, #23 Burnaby Bay, 3.2m N of SE corner of building
	233.016	
NO.	REVISIONS	DATE BY
0	ISSUED FOR TENDER	03/04/14 BC
A	ISSUED FOR REVIEW	02/07/14 BC

DESIGNED BY	BC/SS	CHECKED BY	KWR
DRAWN BY	PB/RT	APPROVED BY	
HOR. SCALE:	1:250	RELEASED FOR CONSTRUCTION BY	
VERTICAL:	1:10	DATE	Mar 4/14
NO.	REVISIONS	DATE BY	

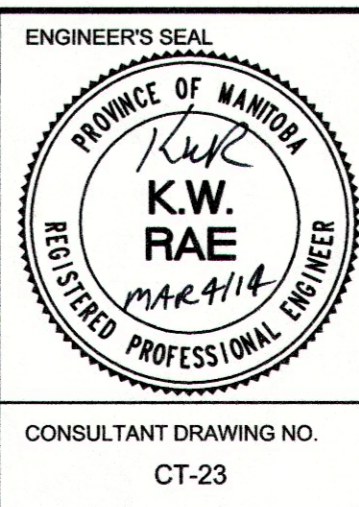

THE CITY OF WINNIPEG
PUBLIC WORKS DEPARTMENT
ENGINEERING DIVISION

2014 LOCAL STREET RENEWAL PROGRAM

KILDARE AVENUE WEST - BREWSTER STREET - DAY STREET
REHABILITATION
STATION 8+10 TO STATION 9+40

CITY DRAWING NUMBER
SHEET 23 OF 27

CONSULTANT DRAWING NO. CT-23