

CONSTRUCTION SCOPE OF WORK

- CONCRETE PAVEMENT RENEWALS (SLAB, JOINT, ISOLATIONS)
- INSTALL BARRIER CURB
- PLACEMENT OF ASPHALT OVERLAY
- SIDEWALK RENEWAL

REFERENCE NOTES:

- A. ALL PAVEMENT DIMENSIONS ARE TO BACK OF CURB.
- B. LEGAL PLAN AND UNDERGROUND INFORMATION FROM CITY OF WINNIPEG LBIS. CONTRACTOR TO VERIFY ALL UNDERGROUNDS IN THE FIELD.
- C. CONTROL LINE IS CENTRELINE OF RIGHT-OF-WAY.
- D. ALL SIDEWALK, CURB, AND CONCRETE REPAIRS TO BE MARKED OUT IN FIELD BY CONTRACT ADMINISTRATOR.
- E. ALL ADJUSTMENTS FOR CATCH BASINS, MANHOLES, VALVES & INLETS TO BE MARKED IN FIELD BY CONTRACT ADMINISTRATOR.
- F. PAVEMENT REPAIRS SHOWN ARE ONLY A REPRESENTATIVE APPROXIMATION OF THE TENDERED QUANTITIES.
- G. CONTRACTOR TO COMPLETE RECONSTRUCTION OF STREET LIGHTING (BASES, WIRING & LAMP STANDARDS).
- H. CONTRACTOR TO TAKE PRECAUTIONARY STEPS TO PROTECT EXISTING TREES FROM CONSTRUCTION ACTIVITIES.

CONSTRUCTION NOTES:

1. PLACE NEW ASPHALTIC PAVEMENT OVERLAY (TYPE 1A, 80mm AVERAGE THICKNESS).
2. REMOVE EXISTING CONCRETE PAVEMENT AND CONSTRUCT NEW REINFORCED CONCRETE PAVEMENT (150mm) C/W ASPHALTIC PAVEMENT OVERLAY (80mm AVERAGE THICKNESS).
3. REMOVE EXISTING FRAME AND COVER AND INSTALL NEW.
4. ADJUST EXISTING MANHOLE/CATCHBASIN.
5. CONSTRUCT NEW BARRIER CURB AND GUTTER (SD-200).
6. PLANE EXISTING LIP CURB AND REPLACE WITH NEW LIP CURB (75mm REVEAL, DOWELED, SD-202C).
7. CONSTRUCT NEW MODIFIED BARRIER CURB (180mm, SEPARATE).
8. CONSTRUCT NEW CURB RAMP (SD-229A).
9. RENEW EXISTING CONCRETE SIDEWALK (SD-228A).
10. ADJUST WATER VALVE.
11. REMOVE EXISTING INLET.
12. INSTALL NEW CURB & GUTTER INLET C/W CATCH PIT (SD-023) AND CONNECT TO EXISTING LEAD.
13. INSTALL NEW CURB & GUTTER INLET C/W 1200 CATCH BASIN (SD-024) AND CONNECT TO EXISTING MANHOLE.

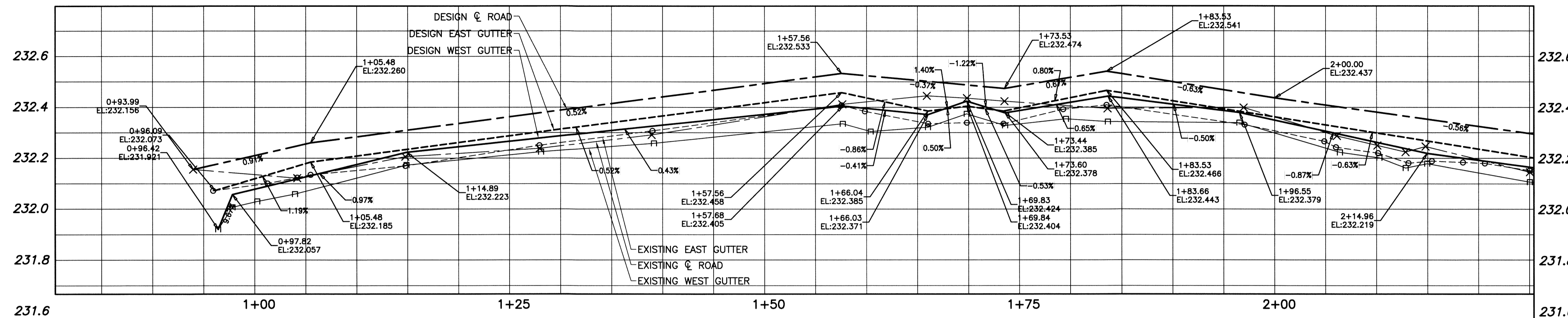

PROFILE
SCALE H=1:250
V=1:10

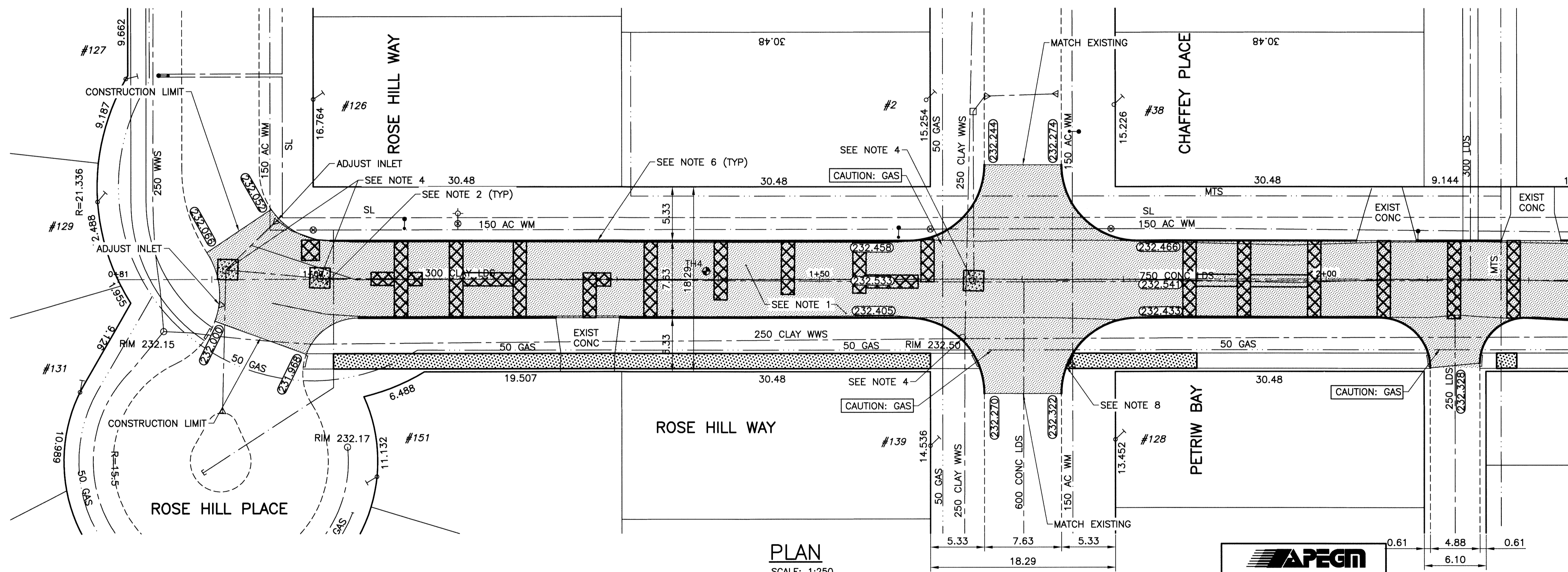
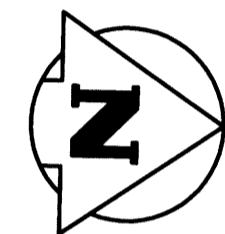

PLAN
SCALE: 1:250

CONTROL LINE COORDINATES		
POINT/STATION	NORTHING	EASTING
POT 0+80.71	5534233.573	629266.007
POC 2+12.83	5534365.661	629262.996
POC 2+55.31	5534408.131	629263.546
POT 2+97.79	5534450.600	629264.096
POC 3+42.48	5534495.282	629263.075
POT 3+79.36	5534531.197	629270.102
POT 4+08.98	5534558.365	629281.891
POT 4+39.50	5534586.368	629294.030
POC 4+54.93	5534600.522	629300.174
POT 5+30.48	5534674.093	629314.579
POT 6+56.90	5534800.477	629311.699

WARNING
NOTIFY THE GAS COMPANY OF THE PROPOSED LOCATION OF EXCAVATION. TAKE PRECAUTION TO AVOID DAMAGE TO GAS COMPANY INSTALLATIONS. SEE PROVINCIAL REGULATION 210/72 FOR DETAILS.

METRIC
WHOLE NUMBERS INDICATE MILLIMETRES
DECIMALIZED NUMBERS INDICATE METRES

PROPERTY LIMITS DELINEATION
DELINEATION OF PROPERTY LIMITS AS SHOWN ON THIS DWG DOES NOT REPRESENT A "LEGAL SURVEY". KGS GROUP MAKES NO REPRESENTATION OR WARRANTY AS TO THE ACCURACY OF PROPERTY LIMITS DELINEATED ON THIS DWG, NOR ON THE DIMENSIONAL ACCURACY OF DWG FEATURES RELATIVE TO THOSE PROPERTY LIMITS.

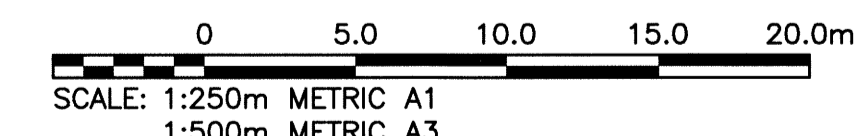

P:\Projects\2013\13-0107-030\DWG\Mun\13-0107-030_CALL.dwg - Tab: C06 Plotted By: sderoché 08/06/2014 [Wed 8:57am] PLOT 1:1 A-1

300_LDS	LAND DRAINAGE SEWER	300_LDS	—	GUY WIRE	—	CONCRETE	—
250_WWS	WASTE WATER SEWER	250_WWS	—	LIGHT STANDARD	—	ASPHALT	—
—	GAS	—	—	POLES	—	GRAVEL	—
—	HYDRO	—	—	PROPERTY LINE	—	SIDEWALK	—
—	M.T.S.	—	—	BACK OF CURB	—	PLANING - REMOVAL	—
150_WM	WATERMAIN	150_WM	—	RAMP CURB	—	PARTIAL DEPTH PATCH	—
+	HYDRANT	+	231.334	ELEVATION	(32.231)		
⊗	VALVE	⊗	+	SURVEY BAR	+		
○	MANHOLE	○	+	GEODETIC BENCHMARK	+		
□	CATCH BASIN	□	x	FENCE	x		
▽	CURB INLET	▽	+	TEST HOLE	+		
			+	TREE	+		
EXISTING	LEGEND-PLAN	PROPOSED	EXISTING	LEGEND-PLAN	PROPOSED	EXISTING	LEGEND-PLAN

LOCATION APPROVED UNDERGROUND STRUCTURES
SUPV. U/G STRUCTURES COMMITTEE DATE
NOTE: LOCATION OF UNDERGROUND STRUCTURES AS SHOWN ARE BASED ON THE BEST INFORMATION AVAILABLE BUT NO GUARANTEE IS GIVEN THAT ALL EXISTING UTILITIES ARE SHOWN OR THAT THE GIVEN LOCATIONS ARE EXACT. CONFIRMATION OF EXISTENCE AND EXACT LOCATION OF ALL SERVICES MUST BE OBTAINED FROM THE INDIVIDUAL UTILITIES BEFORE PROCEEDING WITH CONSTRUCTION.

B.M. 15-034	SW Cor Inletter Garden Dr & Rose Hill Way, 10ft on top on 0.05m ² x 2.4m iron pipe, 2.3m N of SL of Inletter Garden Dr & 3.2m E of ML of Rose Hill Way	ELEV. 232.048
0	ISSUED FOR TENDER	14/08/06
NO.	REVISIONS	DATE

DESIGNED BY	JB	CHECKED BY	CR
DRAWN BY	GEL	APPROVED BY	Rg 12
HOR. SCALE:	1:250	RELEASED FOR CONSTRUCTION:	
VERTICAL:	—	DATE	14/07/20

ENGINEER'S SEAL
M.C. ROWBOTHAM
22679
August 6, 2014

THE CITY OF WINNIPEG
PUBLIC WORKS DEPARTMENT
TRANSPORTATION ENGINEERING DIVISION

PROJECT TITLE: 2014 LOCAL STREET RENEWAL PROGRAM
SHEET OF: 06 19
ROSE HILL PL TO WILDES LN
ROSE HILL PL TO STA 2+25
COMPUTER FILE NAME: 13-0107-030_CALL
DRAWING NUMBER: C06