

**1 MARKET & BERTHA PLANTING & FURNITURE PLAN**  
SCALE 1:200

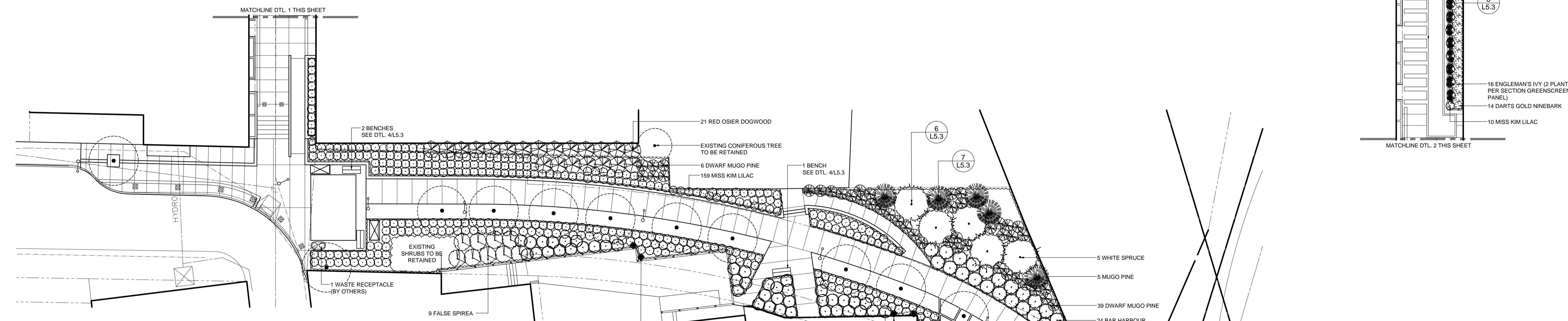

**2 BERTHA & JOHN HIRSCH PLANTING & FURNITURE PLAN**  
SCALE 1:200

QTY	BOTANICAL / COMMON NAME	SIZE / REMARKS
<b>Deciduous &amp; Coniferous Trees</b>		
7	<i>Acer ginnata</i> / Amur Maple	3.5m ht. single-stem 65mm cal. 12 major branches in well formed head 1.8m above grade, B & B, wire basket. Double stake.
5	<i>Picea glauca</i> / White Spruce	2.4m ht. Evenly branched, full bushy trees, no broken leaders, well branched o grade, B & B or tree mover, wire basket. Guy wire.
<b>Deciduous &amp; Coniferous Shrubs</b>		
390	<i>Syringa patula</i> / Miss Kim Lilac	400-500mm dia. well formed shrub with even growth. Container stock (2 gal pot min.)
9	<i>Sorbaria sorbifolia</i> / False Spirea	400-500mm dia. well formed shrub with even growth. Container stock (2 gal pot min.)
48	<i>Viburnum dentatum</i> 'Christom' / Blue Muffin Viburnum	400-500mm dia. well formed shrub with even growth. Container stock (2 gal pot min.)
21	<i>Cornus sericea</i> / stolonifera / Red Osier Dogwood	400-500mm dia. well formed shrub with even growth. Container stock (2 gal pot min.)
19	<i>Ribes alpinum</i> / Alpine Currant	400-500mm dia. well formed shrub with even growth. Container stock (2 gal pot min.)
32	<i>Physocarpus opulifolius</i> 'Dart's Gold' / Darts Gold Ninebark	400-500mm dia. well formed shrub with even growth. Container stock (2 gal pot min.)
5	<i>Pinus mugo mughus</i> / Mugo Pine	400-500mm dia. well formed shrub with even growth. Container stock (2 gal pot min.)
45	<i>Pinus mugo</i> var. 'pumilio' / Dwarf Mugo Pine	400-500mm dia. well formed shrub with even growth. Container stock (2 gal pot min.)
24	<i>Juniperus horizontalis</i> 'Bar Harbour' / Bar Harbour Juniper	500mm dia. well formed shrub with even growth. Container stock (2 gal pot min.)
<b>Vines</b>		
20	<i>Parthenocissus quinquefolia</i> var. 'englemanni' / Englemann's Ivy	2 yr. plants from division. No. 1 grade, well branched, with not less than 3 runner, 18" and up and vigorous, well developed root system. Stake, (6" dia. pot min.)

<b>LOCATIONS APPROVED UNDERGROUND STRUCTURES</b>		G.B.M. ELEV.		
SIGNED BY:	DATE:		DESIGNED BY: JH	CHECKED BY: GM
SUPV. U/G STRUCTURES:	DATE:		DRAWN BY: JH	APPROVED BY: GM
LOCATION OF UNDERGROUND STRUCTURES AS SHOWN ARE BASED ON THE BEST INFORMATION AVAILABLE BUT NO GUARANTEE IS GIVEN THAT ALL EXISTING UTILITIES ARE SHOWN OR THAT THE GIVEN LOCATIONS ARE EXACT CONFIRMATION OF EXISTANCE AND EXACT LOCATION OF ALL SERVICES MUST BE OBTAINED FROM THE INDIVIDUAL UTILITIES BEFORE PROCEEDINGS			HOR. SCALE: AS NOTED	RELEASED FOR CONSTRUCTION
F			VERTICAL: AS NOTED	
E				
D				
C				
B	ISSUED FOR TENDER	7/8/14	JH	
A	ISSUED FOR 66% REVIEW	27/6/14	JH	
NO.	REVISIONS	DATE	BY	DATE
				AUG 7, 2014

ENGINEER'S SEAL

CONSULTANT ACAD DWG. NO. L2.1

THE CITY OF WINNIPEG  
PUBLIC WORKS DEPARTMENT  
ENGINEERING SERVICES DIVISION

CITY OF WINNIPEG

MARKET, BERTHA & JOHN HIRSCH  
PLANTING & FURNITURE PLAN

CITY DRAWING NUMBER  
SHEET 3 OF 11

BID NO. 742-2014

Aug 05, 2014 - 9:55am  
 \\Data\West\Volumes\HTFC\_FILES\_SERVER\2014\1-049\_Enst\_Exchange\_Implementation\ACAD\14-049\_LAYOUT\1.dwg - tab:L2.1