

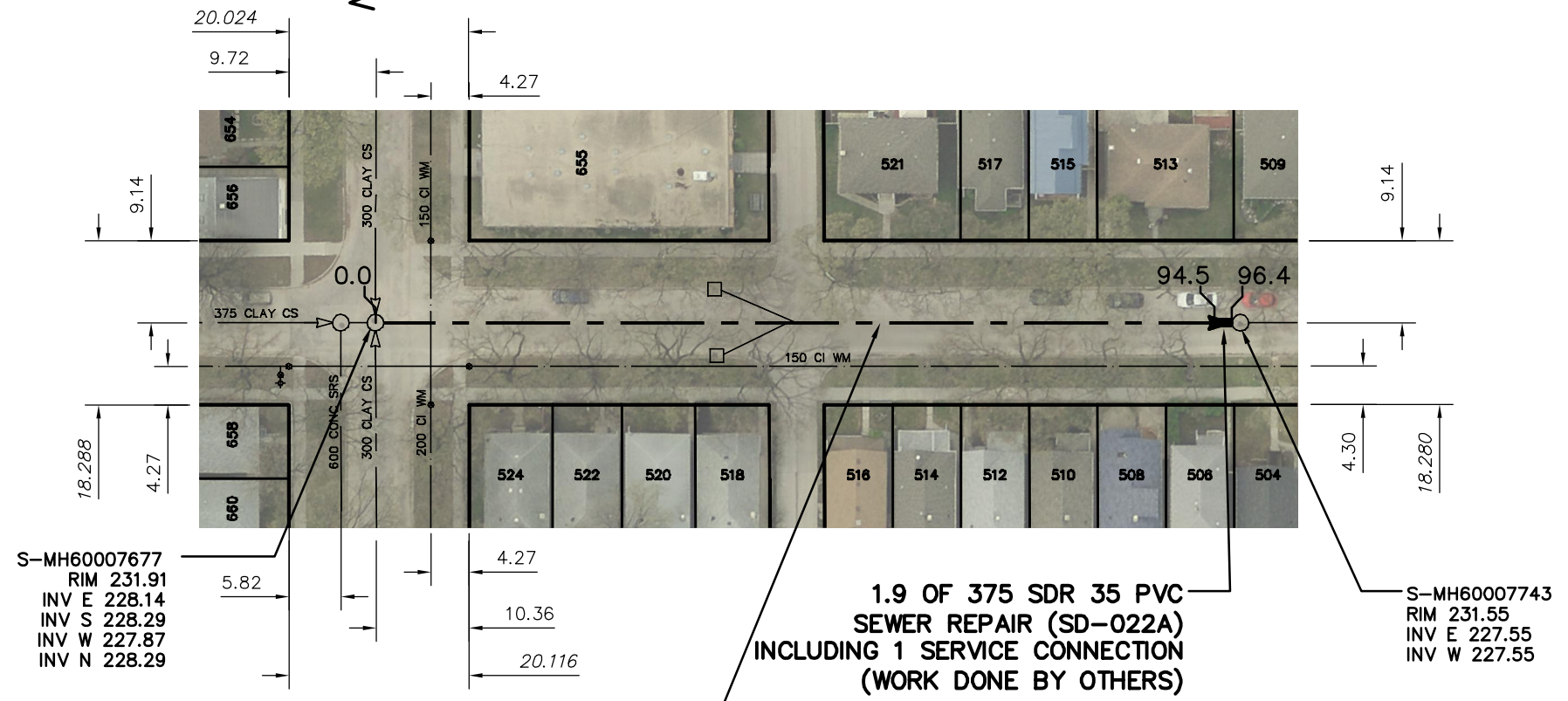

NASSAU ST

CARLAW AVENUE



SEWER JUNCTION INFORMATION FROM SEWER VIDEO INSPECTION		
SEWER ID S-MA60009281		
DISTANCE FROM MH ID S-MH60007677		
DISTANCE	DIAMETER	CLOCK
18.7	150	2
30.5	150	10
43.0	150	2
45.4	150	10
45.9	150	10
47.4	150	10
57.4	150	1
63.7	150	10
71.3	150	11
71.9	150	2
77.6	150	10
86.9	150	2
94.3	150	10
95.1	150	2

S-MH60007677
RIM 231.91
INV E 228.14
INV S 228.29
INV W 227.87
INV N 228.29

S-MH60007743
RIM 231.55
INV E 227.55
INV W 227.55

1.9 OF 375 SDR 35 PVC SEWER REPAIR (SD-022A) INCLUDING 1 SERVICE CONNECTION (WORK DONE BY OTHERS)

96.40 OF 375 CLAY CS TO BE LINED S-MA60009281 (FULLY DETERIORATED)

WARNING
IF POWER EQUIPMENT OR EXPLOSIVES ARE TO BE USED FOR EXCAVATION ON THIS PROJECT THE CONTRACTOR MUST:
1) NOTIFY THE GAS COMPANY OF THE PROPOSED LOCATION OF EXCAVATION.
2) TAKE PRECAUTION TO AVOID DAMAGE TO GAS COMPANY INSTALLATIONS.
SEE PROVINCIAL REGULATION 210/72 FOR DETAILS

METRIC
WHOLE NUMBERS INDICATE MILLIMETRES
DECIMALIZED NUMBERS INDICATE METRES



<p>LOCATION APPROVED UNDERGROUND STRUCTURES</p> <p>SUPV. U/G STRUCTURES COMMITTEE _____ DATE _____</p> <p>NOTE: LOCATION OF UNDERGROUND STRUCTURES AS SHOWN ARE BASED ON THE BEST INFORMATION AVAILABLE BUT NO GUARANTEE IS GIVEN THAT ALL EXISTING UTILITIES ARE SHOWN OR THAT THE GIVEN LOCATIONS ARE EXACT. CONFIRMATION OF EXISTENCE AND EXACT LOCATION OF ALL SERVICES MUST BE OBTAINED FROM THE INDIVIDUAL UTILITIES BEFORE PROCEEDING WITH CONSTRUCTION.</p>	<p>B.M. ELEV.</p> <p>CONSTRUCTION COMPLETION DATE: YYYY MM DD</p> <table border="1" style="width:100%; height: 40px;"> <tr><td> </td><td> </td><td> </td><td> </td></tr> </table>					<p>DESIGNED BY SC</p> <p>CHECKED BY SC</p> <p>DRAWN BY MA</p> <p>APPROVED BY KZ</p> <p>SCALE: HORIZONTAL 1:750</p> <p>VERTICAL</p> <p>RELEASED FOR CONSTRUCTION</p> <p>DATE 2014 10 08</p> <p>PLOT DATE: 2014 10 08</p>	<p>ENGINEER'S SEAL</p> <p>ORIGINAL SIGNED BY S.R.J. COURNOYER 14-10-07</p> <p>CONSULTANT DRAWING NUMBER -</p>	<p>THE CITY OF WINNIPEG WATER AND WASTE DEPARTMENT ENGINEERING DIVISION</p> <p>2014 SEWER RENEWALS BY CIPP LINING - CONTRACT 12 CARLAW AVENUE 1ST MH E OF NASSAU STREET S TO MH AT NASSAU STREET S (CL)</p>	<p>SHEET 10 OF 66</p> <p>CITY DRAWING NUMBER</p> <p style="font-size: 24pt; text-align: center;">10821</p>