

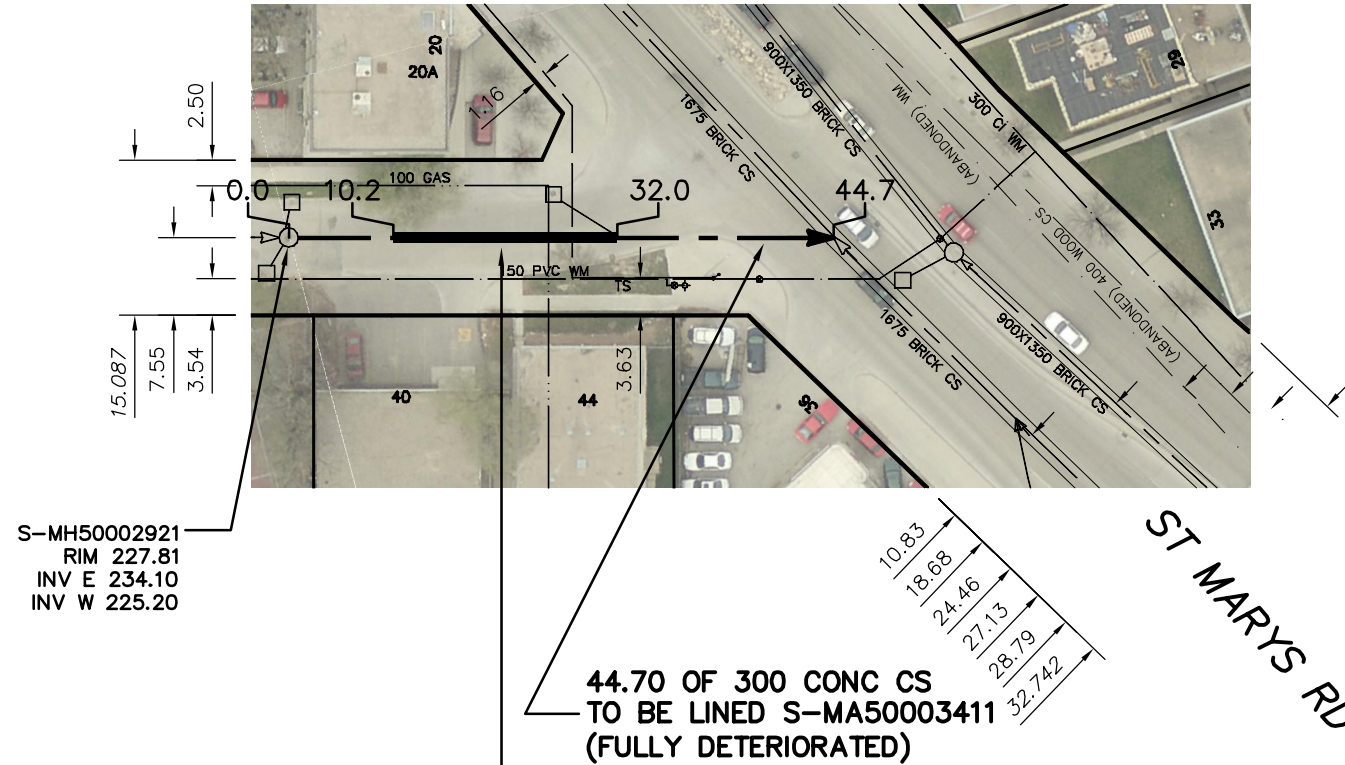

# CROMWELL STREET



SEWER JUNCTION INFORMATION FROM SEWER VIDEO INSPECTION		
SEWER ID S-MA50003411		
DISTANCE FROM MH ID S-MH50002921		
DISTANCE	DIAMETER	CLOCK
3.8	150	10
12.1	150	2
27.6	150	2
32.9	150	2
36.3	150	2
42.0	150	2
46.6	150	10

S-MH50002921  
RIM 227.81  
INV E 234.10  
INV W 225.20

21.8 OF 300 SDR 35 PVC  
SEWER REPAIR (SD-022B)  
INCLUDING 2 SERVICE CONNECTIONS  
(WORK DONE BY OTHERS)

44.70 OF 300 CONC CS  
TO BE LINED S-MA50003411  
(FULLY DETERIORATED)

ST MARYS RD

## WARNING

IF POWER EQUIPMENT OR EXPLOSIVES ARE TO BE USED FOR EXCAVATION ON THIS PROJECT THE CONTRACTOR MUST:

- 1) NOTIFY THE GAS COMPANY OF THE PROPOSED LOCATION OF EXCAVATION.
- 2) TAKE PRECAUTION TO AVOID DAMAGE TO GAS COMPANY INSTALLATIONS.

SEE PROVINCIAL REGULATION 210/72 FOR DETAILS

## METRIC

WHOLE NUMBERS INDICATE MILLIMETRES  
DECIMALIZED NUMBERS INDICATE METRES

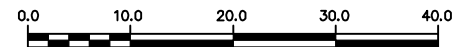

LOCATION APPROVED  
UNDERGROUND STRUCTURES

SUPV. U/G STRUCTURES COMMITTEE DATE

NOTE:

LOCATION OF UNDERGROUND STRUCTURES AS SHOWN ARE BASED ON THE BEST INFORMATION AVAILABLE BUT NO GUARANTEE IS GIVEN THAT ALL EXISTING UTILITIES ARE SHOWN OR THAT THE GIVEN LOCATIONS ARE EXACT. CONFIRMATION OF EXISTENCE AND EXACT LOCATION OF ALL SERVICES MUST BE OBTAINED FROM THE INDIVIDUAL UTILITIES BEFORE PROCEEDING WITH CONSTRUCTION.

B.M. ELEV.			
CONSTRUCTION COMPLETION DATE: YYYY MM DD			
NO.	REVISIONS	DATE	BY

DESIGNED BY	SC	CHECKED BY	SC
DRAWN BY	MA	APPROVED BY	KZ
SCALE:	1:750	RELEASED FOR CONSTRUCTION	
HORIZONTAL			
VERTICAL			
DATE	2014 10 08	DATE	
PLOT DATE:	2014 10 08		

ENGINEER'S SEAL

ORIGINAL  
SIGNED BY  
S.R.J.  
COURNOYER  
14-10-07

CONSULTANT DRAWING NUMBER



**THE CITY OF WINNIPEG**  
WATER AND WASTE DEPARTMENT  
ENGINEERING DIVISION

2014 SEWER RENEWALS  
BY CIPP LINING - CONTRACT 12  
**CROMWELL STREET**  
1ST MH W OF ST MARYS ROAD TO  
NODE AT ST MARYS ROAD (CL)

SHEET 17 OF 66

CITY DRAWING NUMBER

10828