

4+10 MATCHLINE

5+70 MATCHLINE

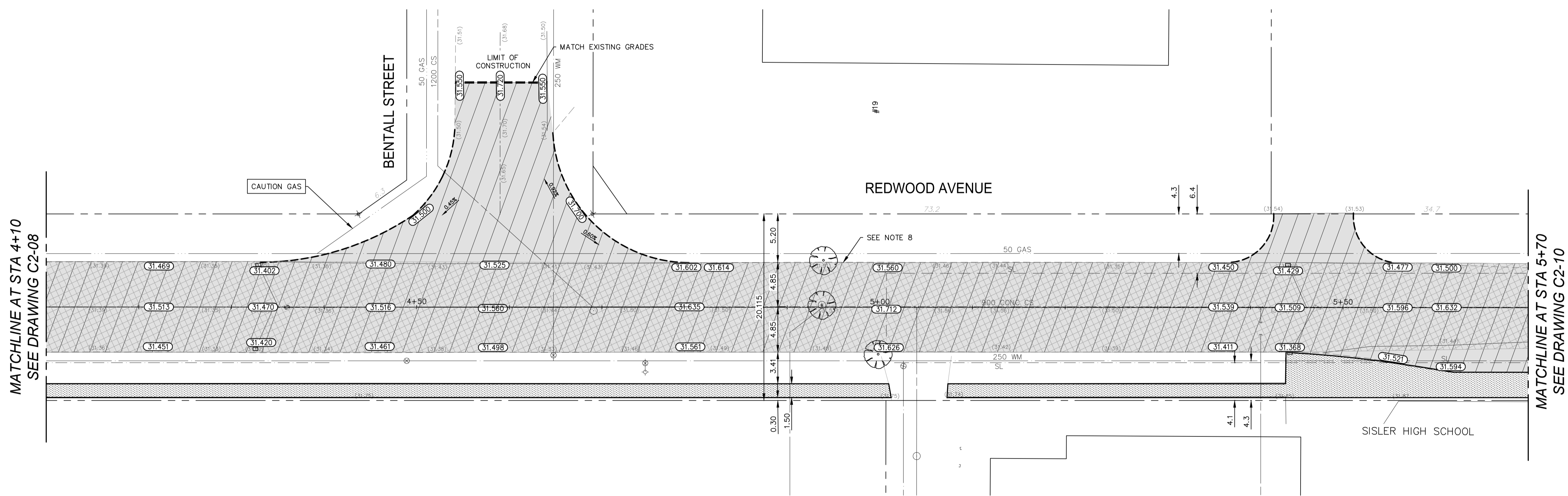

MATCHLINE AT STA 4+10
SEE DRAWING C2-08

MATCHLINE AT STA 5+70
SEE DRAWING C2-10

- GENERAL NOTES:**
- ADJUST MH, CB RIMS, AND VALVES TO NEW GRADES.
 - CONTRACTORS TO TAKE PRECAUTIONARY STEPS TO PROTECT EXISTING TREES WITHIN THE LIMITS OF CONSTRUCTION FROM DAMAGE FROM CONSTRUCTION ACTIVITIES AS OUTLINED IN THE SPECIFICATIONS.
 - MODIFIED BARRIER CURB TO BE USED AT ALL INTERSECTION RADI, BACK LANE RADI, AND BULL NOSES.
 - CONTRACTOR TO CONFIRM THE LOCATION OF ALL UTILITIES/SERVICES IN THE FIELD PRIOR TO CONSTRUCTION.
 - ADD 200.00M TO ABBREVIATED ELEVATIONS TO OBTAIN GEODETIC ELEVATIONS.
 - CB OFFSETS ARE DIMENSIONED TO BOC.
 - PAVEMENT REPAIRS SHOWN ARE ONLY A REPRESENTATIVE APPROXIMATION OF THE TENDERED QUANTITIES. SIDEWALKS TO BE RENEWED WITH CONCRETE AS NOTED BY CONTRACT ADMINISTRATOR.
 - LAMP STANDARDS, HYDRO POLES, AND ANCHORS THAT REQUIRE TEMPORARY SUPPORT, REMOVAL OR REPLACEMENT, TO BE DONE SO AT THE EXPENSIVE OF THE CONTRACTOR AS NECESSARY.

- CONSTRUCTION NOTES:**
- PLACE NEW ASPHALTIC PAVEMENT OVERLAY (TYPE 1A, 80mm AVERAGE THICKNESS, TWO LIFTS)
 - REMOVE EXISTING CONCRETE PAVEMENT AND CONSTRUCT NEW REINFORCED CONCRETE PAVEMENT (150mm) C/W ASPHALTIC PAVEMENT OVERLAY (80mm AVERAGE THICKNESS)
 - REMOVE EXISTING FRAME AND COVER AND INSTALL NEW, AS REQUIRED.
 - CONSTRUCT NEW MODIFIED BARRIER CURB (180mm, SEPARATE), AS REQUIRED
 - CONSTRUCT NEW CURB RAMP (SD-229A), AS REQUIRED.
 - REMOVE EXISTING INLET
 - INSTALL CATCH PIT C/W NEW CURB & GUTTER INLET (SD-023) AND CONNECT TO EXISTING LEAD
 - RENEW CURB AS IDENTIFIED BY CONTRACT ADMINISTRATOR.

EXISTING	LEGEND-PLAN	PROPOSED	EXISTING	LEGEND-PLAN	PROPOSED	EXISTING	LEGEND-PLAN	PROPOSED
○	MANHOLE	●	—	WATER MAIN	—	—	EDGE OF CONCRETE	—
□	CATCH BASIN	■	—	LAND DRAINAGE SEWER	—	—	PROPERTY LINE	—
△	CURB INLET	▽	—	WASTE WATER SEWER	—	—	GUTTER	—
⊥	UTILITIES ADJUSTED	△ □ ⊥	—	HYDRO	—	—	MODIFIED BARRIER CURB	—
J	PLUG	J	—	M.T.S.	—	—	BARRIER CURB	—
◇	HYDRANT	◆	—	GAS	—	—	CURB & GUTTER	—
⊗	VALVE	⊗	—	SIGNALS	—	—	GLASS GRID	—
⊕	IRON BAR	⊕	—	LIGHT STANDARD	—	—	CONCRETE	—
230.99	GROUND GRADE	—	—	DETECTABLE WARNING TILE	—	—	ASPHALT	—
(230.99)	PAVEMENT GRADE	(31.00)	—	CURB RAMP	—	—	ASPHALT OVERLAY	—
	LOT GRADE	(31.00)	—	EDGE OF SIDEWALK	—	—	ASPHALT JOINT REPAIR	—

LOCATIONS APPROVED UNDERGROUND STRUCTURES

SIGNED BY: _____ DATE: _____

SUPV U/G STRUCTURES

LOCATION OF UNDERGROUND STRUCTURES AS SHOWN ARE BASED ON THE BEST INFORMATION AVAILABLE BUT NO GUARANTEE IS GIVEN THAT ALL EXISTING UTILITIES ARE SHOWN OR THAT THE GIVEN LOCATIONS ARE EXACT CONFIRMATION OF EXISTANCE AND EXACT LOCATION OF ALL SERVICES MUST BE OBTAINED FROM THE INDIVIDUAL UTILITIES BEFORE PROCEEDINGS

NO.	REVISIONS	DATE	BY
2	ISSUED FOR TENDER	04.03.15	VMM
1	ISSUED TO U/G STRUCTURES FOR REVIEW	03.02.15	BQD

MMM GROUP

DESIGNED BY: MS
DRAWN BY: KB

CHECKED BY: BQD
APPROVED BY: VMM

WMM Group Limited,
Suite 111 - 93 Lombard Ave.
Winnipeg, MB R3B 3B1
t. 204.943.3178
f. 204.943.4948
www.mmm.ca

DATE: 05-Mar-15

ENGINEER'S SEAL

ORIGINAL SEALED BY
V.M. MAROTI
P. ENG.
03/02/15

CONSULTANT ACAD DWG. NO.
5514132-C2-09

THE CITY OF WINNIPEG
PUBLIC WORKS DEPARTMENT
ENGINEERING DIVISION

2015 LOCAL STREETS RENEWAL PRG
REHABILITATION
REDWOOD AVENUE - SHEPPARD ST TO SHAUGHNESSY ST
STA 4+10 TO STA 5+70

Winnipeg

CHIT DRAWING NUMBER
SHEET 9 OF 14
BID NO. 152-2015

PRELIMINARY

METRIC
WHOLE NUMBERS INDICATE MILLIMETRES
DECIMALIZED NUMBERS INDICATE METRES

APEGM
Certificate of Authorization
MMM Group Limited
No. 4531

Rev. 05 - 0915 - 4-17-15
P:\5514132-09-15-15\Drawings\2015 Local Streets and Alley Renewal 15-R-06\WMM Drawings\Redwood Avenue - Rehabilitation\5514132-Redwood-Renewal.dwg - tab: STA 4+10 - STA 5+70