

**ALLEY PAVEMENT PROFILE**  
SCALE: 1:250 HOR  
1:10 VER

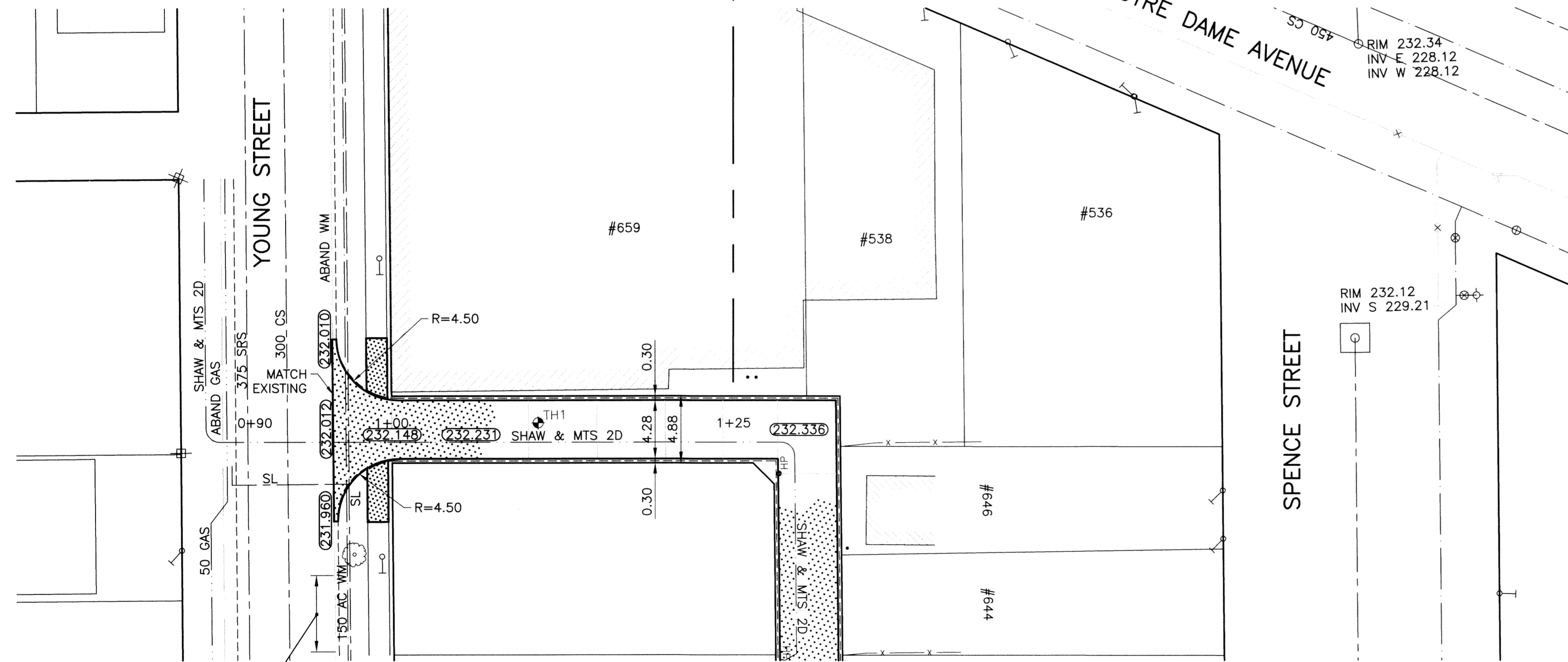

**ALLEY PAVEMENT PLAN**  
SCALE: 1:250 HOR

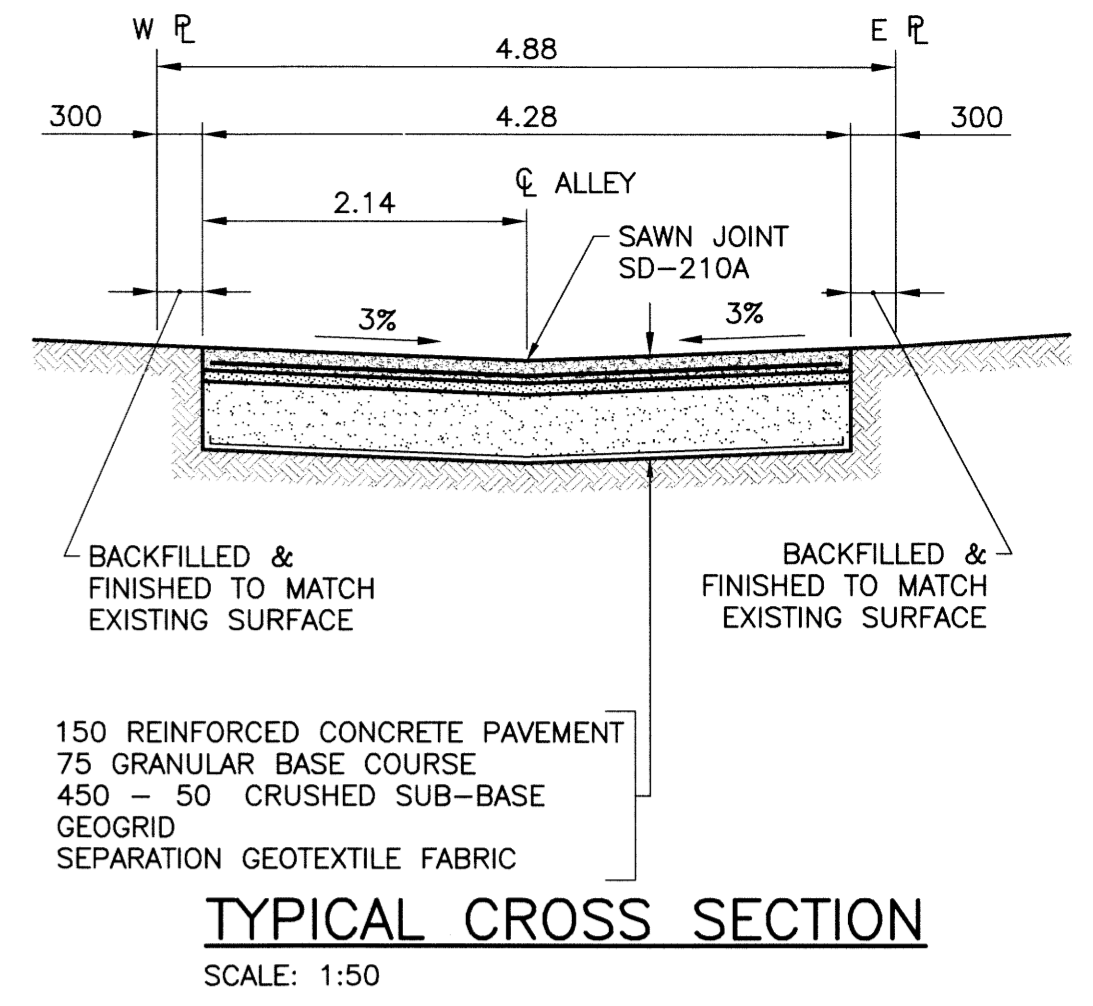

**TYPICAL CROSS SECTION**  
SCALE: 1:50

- NOTES**
1. STATION CHAINAGE IS BASED ON CENTERLINE OF ALLEY RIGHT OF WAY.
  2. ADJUST MH AND CB RIMS TO NEW GRADES.
  3. PLUG SUB-DRAINS AT TERMINAL ENDS.
  4. REGRADE EXISTING PRIVATE SIDEWALKS AS REQUIRED.
  5. INSTALLATION OF LIP CURBS AND THEIR EXTENTS TO BE DETERMINED BY THE CONTRACT ADMINISTRATOR.
  6. LIGHT STANDARDS, HYDRO POLES AND ANCHORS MAY REQUIRE TEMPORARY SUPPORT/REMOVAL OR REPLACEMENT AT THE CONTRACTOR'S EXPENSE.
  7. ISOLATE ALL POLES, BASES AND PILES WITHIN ALLEY RIGHT OF WAY (SD-228C).
  8. AVOID DAMAGE TO EXISTING TREES WITHIN THE LIMITS OF CONSTRUCTION.
  9. CITY OF WINNIPEG SURVEY MONUMENTS EXIST ON THIS SITE. CONTRACTOR TO CONTACT THE CITY OF WINNIPEG GEOMATICS BRANCH 5 WORKING DAYS IN ADVANCE OF CONSTRUCTION TO COORDINATE MONUMENT PROTECTION SERVICES (204-918-1360).
  10. ALLEY TO BE CONSTRUCTED IN PHASES AS SHOWN.
  11. ALL EXCAVATIONS WITHIN 1.0m OF ANY NATURAL GAS MAIN MUST BE COMPLETED BY HAND OR HYDRO EXCAVATION.
  12. CONTRACTOR TO REMOVE FENCE AND PROVIDE TEMPORARY ASPHALT ACCESS DURING CONSTRUCTION. CONTRACTOR TO REPLACE FENCE FOLLOWING CONSTRUCTION.

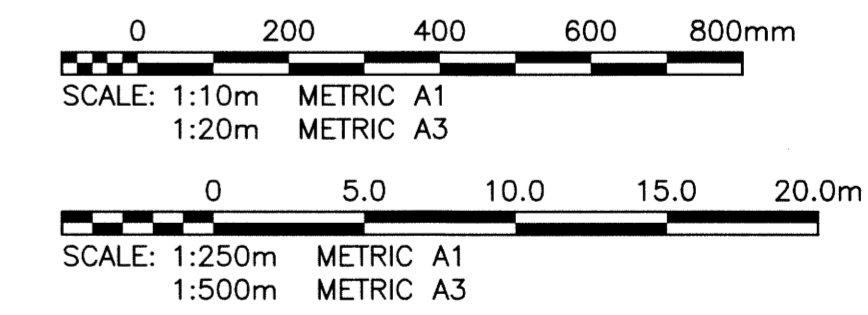

**METRIC**  
WHOLE NUMBERS INDICATE MILLIMETRES  
DECIMALIZED NUMBERS INDICATE METRES

**PROPERTY LIMITS DELINEATION**

**WARNING**  
NOTIFY THE GAS COMPANY OF THE PROPOSED LOCATION OF EXCAVATION. TAKE PRECAUTION TO AVOID DAMAGE TO GAS COMPANY INSTALLATIONS. SEE PROVINCIAL REGULATION 210/72 FOR DETAILS.

DELINEATION OF PROPERTY LIMITS AS SHOWN ON THIS DWG DOES NOT REPRESENT A "LEGAL SURVEY". KGS GROUP MAKES NO REPRESENTATION OR WARRANTY AS TO THE ACCURACY OF PROPERTY LIMITS DELINEATED ON THIS DWG, NOR ON THE DIMENSIONAL ACCURACY OF DWG FEATURES RELATIVE TO THOSE PROPERTY LIMITS.

**APEGM**  
Certificate of Authorization  
KGS Group  
No. 245

ENGINEER'S SEAL  
**R.B. OFFMAN**  
Member  
24704

**THE CITY OF WINNIPEG**  
PUBLIC WORKS DEPARTMENT  
TRANSPORTATION ENGINEERING DIVISION  
PROJECT TITLE  
**2015 ALLEY RENEWAL PROGRAM**  
CONTRACT 1  
NOTRE DAME SOUTH  
YOUNG ST TO SPENCE ST  
SHEET 11 OF 15  
COMPUTER FILE NAME  
14-0107-031\_Contract 1  
CITY DRAWING NUMBER  
C111

EXISTING	LEGEND-PLAN	PROPOSED	EXISTING	LEGEND-PLAN	PROPOSED	EXISTING	LEGEND-PROFILE	PROPOSED
300 LDS	LAND DRAINAGE SEWER	300 LDS	T	TEST HOLE		X-X	Q PROFILE	
250 WWS	WASTE WATER SEWER	250 WWS	- - -	GUY WIRE		□-□	N/W LANE EDGE	
	GAS		•••	LIGHT STANDARD		○-○	S/E LANE EDGE	
	HYDRO		---	BACK OF CURB		TTTT	PARKING/DRIVEWAY	
	M.T.S.		----	CONCRETE		+	WINDOW/DOOR SILL	
150 WM	WATERMAIN	150 WM	=====	ASPHALT				
⊕	HYDRANT	⊕	=====	SIDEWALK				
⊙	VALVE	⊙	=====	PROPERTY LINE				
○	MANHOLE	○	=====	SURVEY BAR				
□	CATCH BASIN	□	=====	GEODETIC BENCHMARK				
▽	CURB INLET	▽	=====	ELEVATION				
•	POLES T-HYDRO	•	=====					

**LOCATION APPROVED UNDERGROUND STRUCTURES**

SUPV. U/G STRUCTURES COMMITTEE DATE

NOTE:  
LOCATION OF UNDERGROUND STRUCTURES AS SHOWN ARE BASED ON THE BEST INFORMATION AVAILABLE BUT NO GUARANTEE IS GIVEN THAT ALL EXISTING UTILITIES ARE SHOWN OR THAT THE GIVEN LOCATIONS ARE EXACT. CONFIRMATION OF EXISTENCE AND EXACT LOCATION OF ALL SERVICES MUST BE OBTAINED FROM THE INDIVIDUAL UTILITIES BEFORE PROCEEDING WITH CONSTRUCTION.

NO.	REVISIONS	DATE	BY	DATE
0	ISSUED FOR TENDER	15/02/23	RBO	

B.M. ICGS BASE ELEV. DWG BASED ON C.S.R.C. NAD 83 SYSTEM UTM GRID BASE.

**KGS GROUP**  
CONSULTING ENGINEERS

DESIGNED BY	CHECKED BY
AKW	RBO
DRAWN BY	APPROVED BY
DMW	
HOR. SCALE:	RELEASED FOR CONSTRUCTION:
1:250	
VERTICAL:	DATE
1:50	

U:\ENR\14-0107-031\14-0107-031\_Contract 1.dwg - Tab: 111 Plotted By: glawen 02/23/2015 [Mon 9:37am] PLOT: 1:1: A-1