

**ALLEY PAVEMENT PROFILE**  
SCALE: 1:250 HOR  
1:10 VER

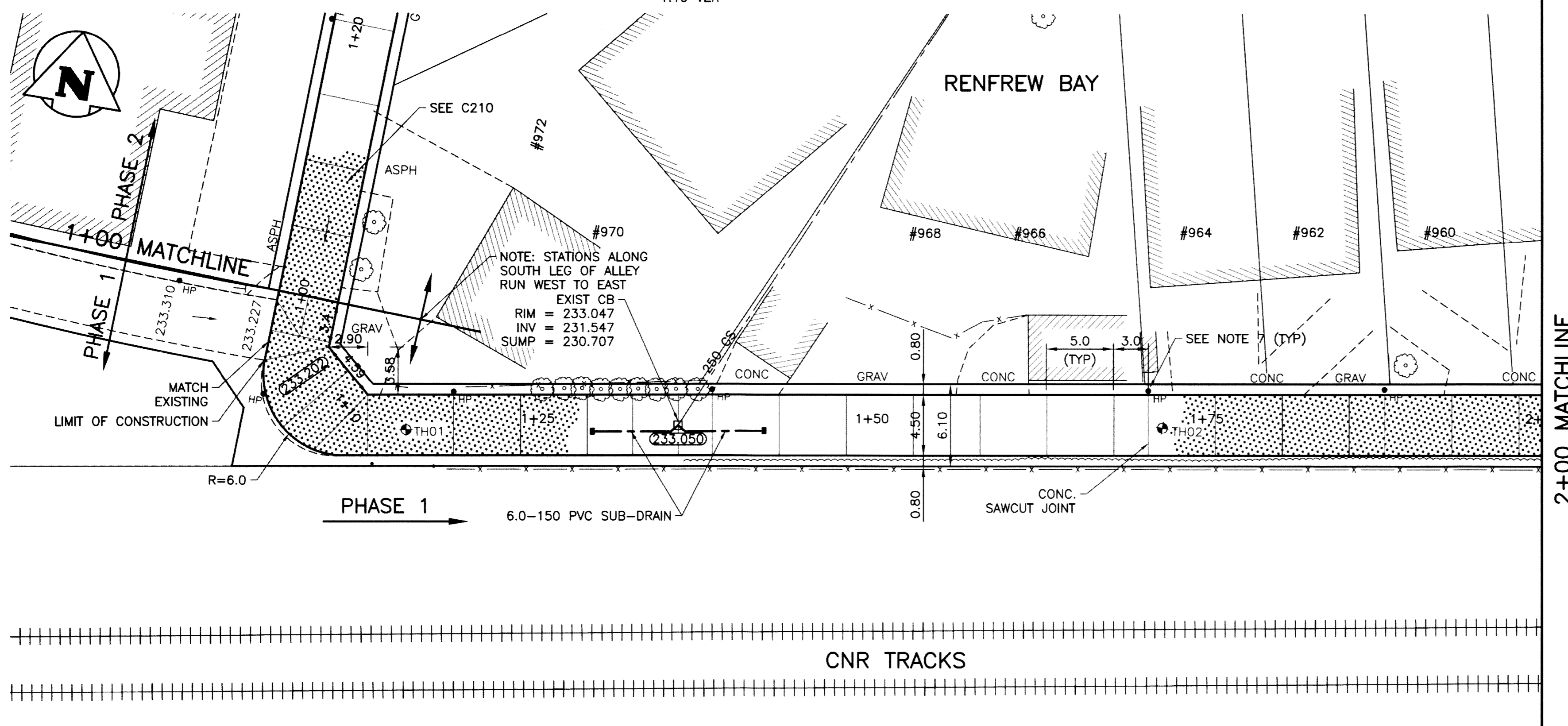

**ALLEY PAVEMENT PLAN**  
SCALE: 1:250 HOR

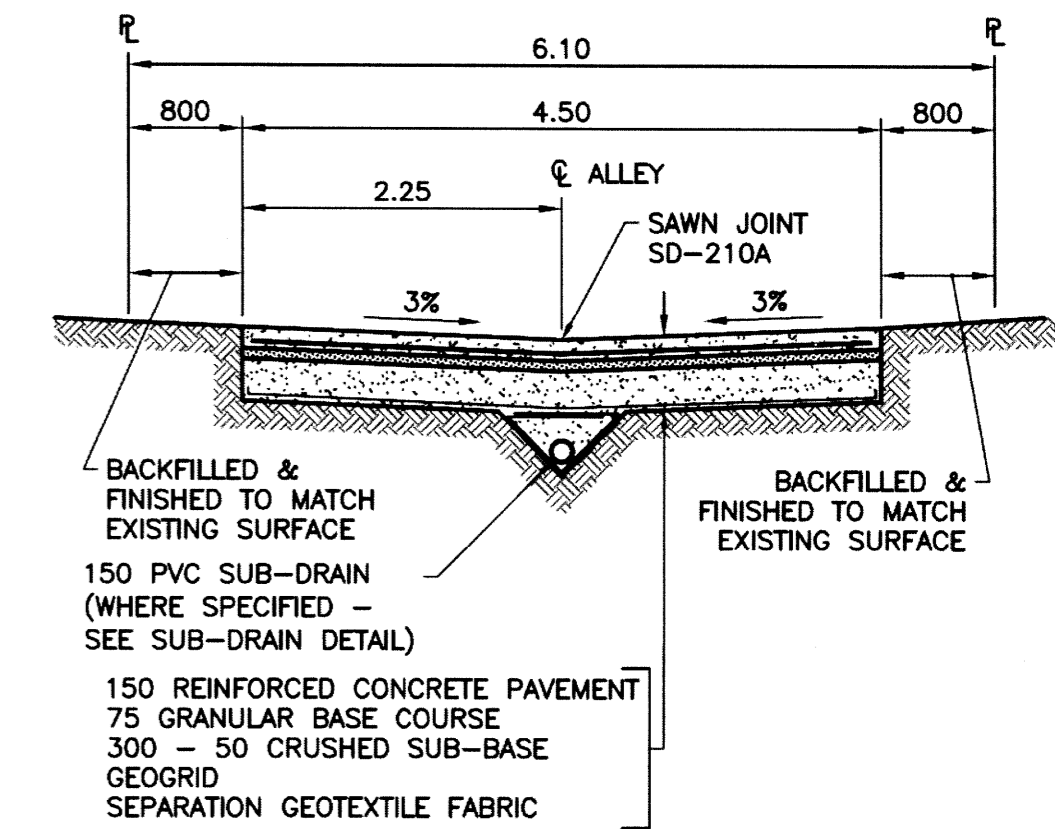

**TYPICAL CROSS SECTION**  
SCALE: 1:50

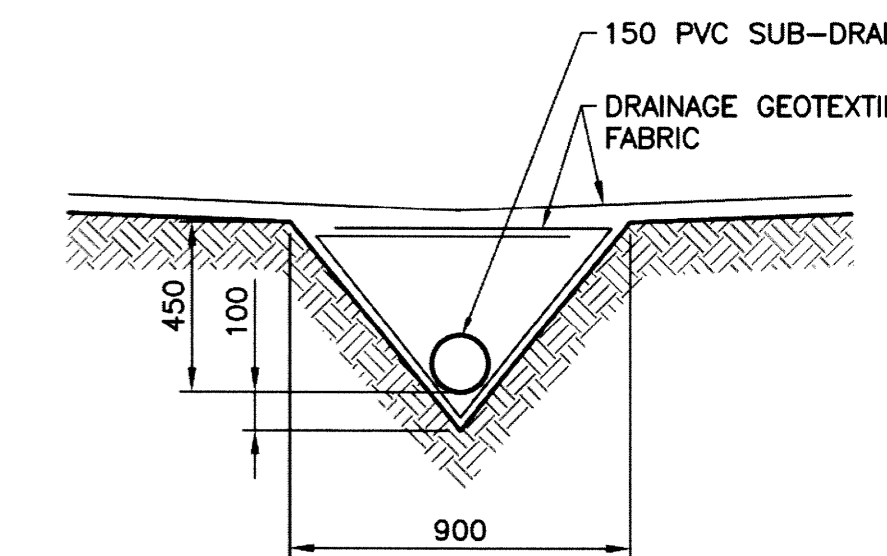

**SUB-DRAIN DETAIL**  
SCALE: 1:20

**NOTES**

1. STATION CHAINAGE IS BASED ON CENTERLINE OF ALLEY RIGHT OF WAY.
2. ADJUST MH AND CB RIMS TO NEW GRADES.
3. PLUG SUB-DRAINS AT TERMINAL ENDS.
4. REGRADE EXISTING PRIVATE SIDEWALKS AS REQUIRED.
5. INSTALLATION OF LIP CURBS AND THEIR EXTENTS TO BE DETERMINED BY THE CONTRACT ADMINISTRATOR.
6. LIGHT STANDARDS, HYDRO POLES AND ANCHORS MAY REQUIRE TEMPORARY SUPPORT/REMOVAL OR REPLACEMENT AT THE CONTRACTOR'S EXPENSE.
7. ISOLATE ALL POLES, BASES AND PILES WITHIN ALLEY RIGHT OF WAY (SD-228C).
8. AVOID DAMAGE TO EXISTING TREES WITHIN THE LIMITS OF CONSTRUCTION.
9. CITY OF WINNIPEG SURVEY MONUMENTS EXIST ON THIS SITE. CONTRACTOR TO CONTACT THE CITY OF WINNIPEG GEOMATICS BRANCH 5 WORKING DAYS IN ADVANCE OF CONSTRUCTION TO COORDINATE MONUMENT PROTECTION SERVICES (204-918-1360).
10. ALLEY TO BE CONSTRUCTED IN PHASES AS SHOWN.
11. ALL EXCAVATIONS WITHIN 1.0m OF ANY NATURAL GAS MAIN MUST BE COMPLETED BY HAND OR HYDRO EXCAVATION.

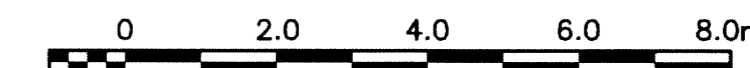

SCALE: 1:100m METRIC A1  
1:200m METRIC A3



SCALE: 1:10m METRIC A1  
1:20m METRIC A3

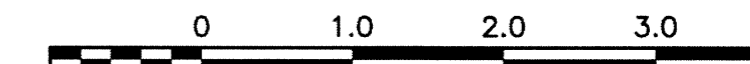

SCALE: 1:50m METRIC A1  
1:100m METRIC A3

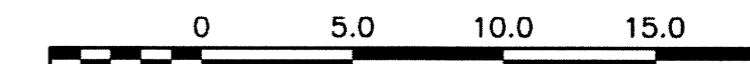

SCALE: 1:250m METRIC A1  
1:500m METRIC A3

**METRIC**

WHOLE NUMBERS INDICATE MILLIMETRES  
DECIMALIZED NUMBERS INDICATE METRES

**PROPERTY LIMITS DELINEATION**

**WARNING**

NOTIFY THE GAS COMPANY OF THE PROPOSED LOCATION OF EXCAVATION. TAKE PRECAUTION TO AVOID DAMAGE TO GAS COMPANY INSTALLATIONS. SEE PROVINCIAL REGULATION 210/72 FOR DETAILS.

DELINEATION OF PROPERTY LIMITS AS SHOWN ON THIS DWG DOES NOT REPRESENT A "LEGAL SURVEY". KGS GROUP MAKES NO REPRESENTATION OR WARRANTY AS TO THE ACCURACY OF PROPERTY LIMITS DELINEATED ON THIS DWG, NOR ON THE DIMENSIONAL ACCURACY OF DWG FEATURES RELATIVE TO THOSE PROPERTY LIMITS.

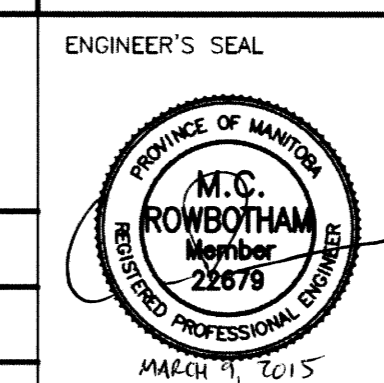

**THE CITY OF WINNIPEG**  
PUBLIC WORKS DEPARTMENT  
TRANSPORTATION ENGINEERING DIVISION

PROJECT TITLE  
**2015 ALLEY RENEWAL PROGRAM**  
**CONTRACT 2**  
**RENFREW BAY**  
TAYLOR AVE TO TAYLOR AVE  
STA 1+00 TO STA 2+47

SHEET 11 OF 15  
COMPUTER FILE NAME  
14-0107-031\_Contract 2  
CITY DRAWING NUMBER  
**C211**

300 LDS	LAND DRAINAGE SEWER	300 LDS	- x - x -	FENCE			
250 WWS	WASTE WATER SEWER	250 WWS	+	TEST HOLE			
	GAS		+	GUY WIRE			
	HYDRO		+	LIGHT STANDARD			
	M.T.S.		+	BACK OF CURB			
150 WM	WATERMAIN	150 WM	---	CONCRETE			
+	HYDRANT	+	+	ASPHALT			
+	VALVE	+	+	SIDEWALK			
○	MANHOLE	○	---	PROPERTY LINE			
□	CATCH BASIN	□	+	SURVEY BAR			
▽	CURB INLET	▽	+	GEODETIC BENCHMARK			
•	POLES	•	+	ELEVATION			
EXISTING	LEGEND-PLAN	PROPOSED	EXISTING	LEGEND-PLAN	PROPOSED	EXISTING	LEGEND-PROFILE

**LOCATION APPROVED UNDERGROUND STRUCTURES**

SUPV. U/G STRUCTURES COMMITTEE DATE

NOTE:  
LOCATION OF UNDERGROUND STRUCTURES AS SHOWN ARE BASED ON THE BEST INFORMATION AVAILABLE BUT NO GUARANTEE IS GIVEN THAT ALL EXISTING UTILITIES ARE SHOWN OR THAT THE GIVEN LOCATIONS ARE EXACT. CONFIRMATION OF EXISTENCE AND EXACT LOCATION OF ALL SERVICES MUST BE OBTAINED FROM THE INDIVIDUAL UTILITIES BEFORE PROCEEDING WITH CONSTRUCTION.

B.M. 51-003	S.W. Cor. Renfrew Bay E. & Taylor Ave., Tbt. in E. Conc. Foundation of No. 1600 Taylor Ave., 2.0 m S. of N.E. Cor. & 0.1 m below ground store of Bdy		
ELEV. 234.300			
NO.	REVISIONS	DATE	BY
0	ISSUED FOR TENDER	15/03/09	CR

**KGS GROUP CONSULTING ENGINEERS**

DESIGNED BY	GES	CHECKED BY	RBO
DRAWN BY	GES	APPROVED BY	CR
HOR. SCALE:	1:250	RELEASED FOR CONSTRUCTION:	
VERTICAL:	1:50	DATE	2015/02/05

P:\Projects\2014\14-0107-031\_Dwg\Main\14-0107-031\_Contract 2.dwg - Tab: C211 Plotted By: gloven 03/09/2015 [Mon 9:28am]  
 PLOT 1:1 A-1