

A1 SIZE 594mm x 841mm

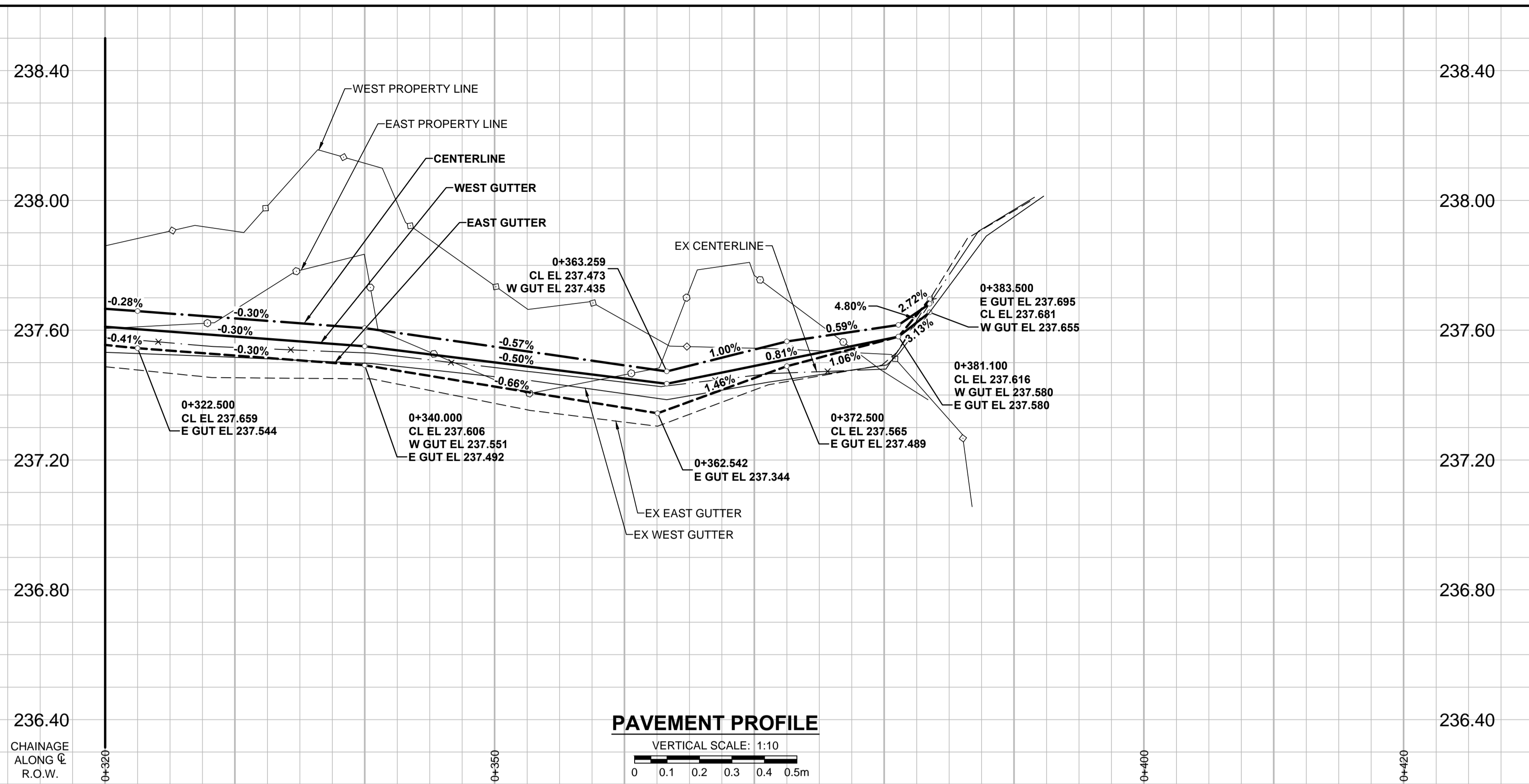

PLOT: 4/29/2015 5:49:49 PM

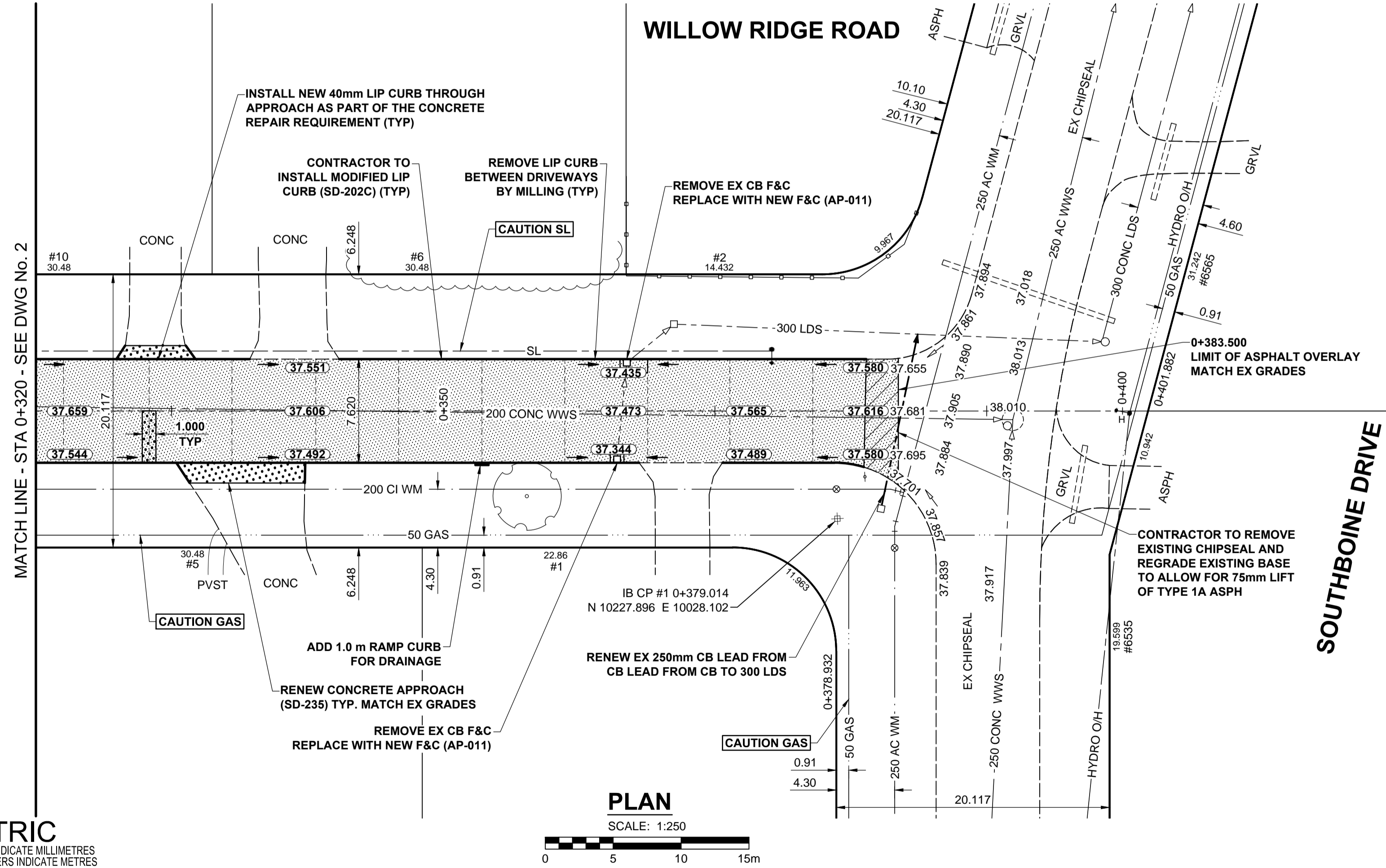

- NOTES**
1. ADJUST MH AND CB RIMS TO NEW GRADES.
 2. LAMP STANDARDS, HYDRO POLES, AND ANCHORS THAT REQUIRE TEMPORARY SUPPORT, REMOVAL OR REPLACEMENT, TO BE DONE SO AT THE EXPENSE OF THE CONTRACTOR AS NECESSARY.
 3. CONTRACTOR TO REGRADE/RENEW EXISTING PRIVATE SIDEWALKS TO LIMITS AS SHOWN. SIDEWALKS TO BE RENEWED WITH CONCRETE UNLESS NOTED OTHERWISE.
 4. CONTRACTOR TO TAKE PRECAUTIONARY STEPS TO PROTECT EXISTING TREES WITHIN THE LIMITS OF CONSTRUCTION FROM DAMAGE FROM CONSTRUCTION ACTIVITIES AS OUTLINED IN THE SPECIFICATIONS.
 5. CONTRACTOR TO CONFIRM THE LOCATION OF ALL UTILITIES/SERVICES IN THE FIELD PRIOR TO CONSTRUCTION.
 6. MODIFIED BARRIER CURB TO BE USED AT ALL INTERSECTION RADII, BACK LANE RADII AND BULLNOSES.
 7. CB SD-023 & SD-024 OFFSETS ARE DIMENSIONED TO BOC. CB SD-025 OFFSETS ARE DIMENSIONED O/C.
 8. REFER TO BID OPPORTUNITY FOR DETAILS REGARDING TRAFFIC MANAGEMENT.
 9. ADD 200.000m TO ABBREVIATED ELEVATIONS TO OBTAIN GEODETIC ELEVATIONS.

CONTROL LINE - COORDINATES		
NAME	NORTHING	EASTING
POT 0+100.000	9949.507	10007.832
POT 0+400.000	10249.213	10021.107

METRIC
WHOLE NUMBERS INDICATE MILLIMETRES
DECIMALIZED NUMBERS INDICATE METRES

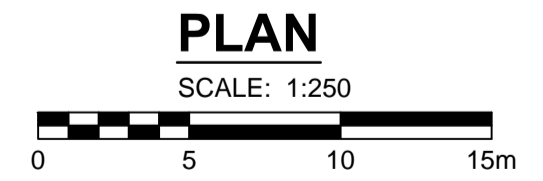

EXISTING	LEGEND - PLAN	NEW	EXISTING	LEGEND - PLAN	NEW	EXISTING	LEGEND - PLAN	NEW
○	GAS	○	MANHOLE	●	CONCRETE PAVEMENT	▨	CONC SIDEWALK / MEDIAN	▨
□	MTS	□	CATCH BASIN / CATCH PIT	■	CONC PAVEMENT	▨	ASPHALT PAVEMENT	▨
△	HYDRO	△	CURB INLET WITH BOX	▲	ASPHALT PAVEMENT	▨	PAVING STONE	▨
—	CATV / FIBRE OPTIC	—	TEST HOLE	—	GRAVEL	▨	RAMP CURB	▨
—	TRAFFIC SIGNALS / PIT	—	PROPERTY LINE	—	PLANNING / REMOVAL	▨		
—	LAND DRAINAGE SEWER	—	SURVEY BAR	—				
—	SANITARY/COMBINED SEWER	—	FENCE	—				
—	SEWER SERV/DRAINAGE CONN	—	BOC / EDGE OF PAVEMENT	—				
—	WATERMAIN	—	ELEVATION	—				
—	SUBDRAIN	—	TRAFFIC SIGN	—				
—	DITCH	—		—				

LOCATION APPROVED UNDERGROUND STRUCTURES

SUPR. U/G STRUCTURES DATE COMMITTEE

NOTE:
LOCATION OF UNDERGROUND STRUCTURES AS SHOWN ARE BASED ON THE BEST INFORMATION AVAILABLE. BUT NO GUARANTEE IS GIVEN THAT ALL EXISTING UTILITIES ARE SHOWN OR THAT THE GIVEN LOCATIONS ARE EXACT. CONFIRMATION OF EXISTENCE AND EXACT LOCATION OF ALL SERVICES MUST BE OBTAINED FROM THE INDIVIDUAL UTILITIES BEFORE PROCEEDING WITH CONSTRUCTION.

No.	REVISIONS	DATE	BY
B	ISSUED FOR TENDER	15/04/20	RPB
A	ISSUED FOR CITY REVIEW	15/04/28	RPB

MORRISON HERSHFIELD

DESIGNED BY: RPB
DRAWN BY: DML

CHECKED BY: WRJ
APPROVED BY: BWB

HOR. SCALE: 1:250
VERT. SCALE: 1:10

DATE: 15/04/28

PROFESSIONAL'S SEAL

PROVINCE OF MANITOBA

R.P. BRUCE

REGISTERED PROFESSIONAL ENGINEER

CONSULTANT DRAWING No. W150003 Willow-PP-03.dwg

THE CITY OF WINNIPEG
PUBLIC WORKS DEPARTMENT
ENGINEERING DIVISION

2015 LOCAL STREET & ALLEY RENEWAL PROGRAM

WILLOW RIDGE ROAD
ROBLIN BV TO SOUTHBONE DR
REHABILITATION
HORIZONTAL AND VERTICAL ALIGNMENT
STA 0+320 TO STA 0+420

CITY DRAWING NUMBER: N/A
SHEET 3 OF 31
DRAWING No. 3
REV B

BID OPPORTUNITY No. 18-2015

FILE NAME: W150003 Willow-PP-03.dwg Saved By: diane