

A1 SIZE 594mm x 841mm  
PLOT: 4/29/2015 5:50:36 PM  
FILE NAME: W150003.Buckle-PP-01.dwg Saved By: diane

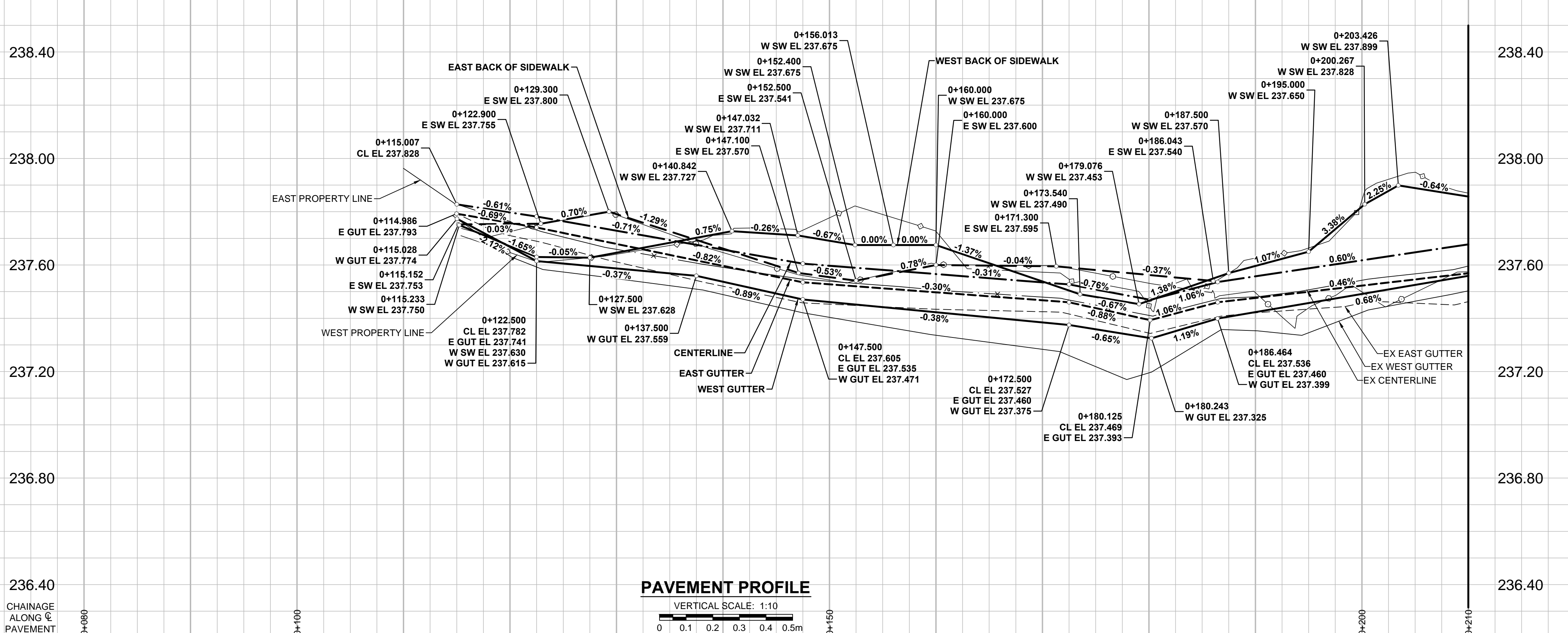

**PAVEMENT PROFILE**  
VERTICAL SCALE: 1:10  
0 0.1 0.2 0.3 0.4 0.5m

- NOTES**
- ADJUST MH AND CB RIMS TO NEW GRADES.
  - LAMP STANDARDS, HYDRO POLES, AND ANCHORS THAT REQUIRE TEMPORARY SUPPORT, REMOVAL OR REPLACEMENT, TO BE DONE SO AT THE EXPENSE OF THE CONTRACTOR AS NECESSARY.
  - CONTRACTOR TO REGRADE/RENEW EXISTING PRIVATE SIDEWALKS TO LIMITS AS SHOWN. SIDEWALKS TO BE RENEWED WITH CONCRETE UNLESS NOTED OTHERWISE.
  - CONTRACTOR TO TAKE PRECAUTIONARY STEPS TO PROTECT EXISTING TREES WITHIN THE LIMITS OF CONSTRUCTION FROM DAMAGE FROM CONSTRUCTION ACTIVITIES AS OUTLINED IN THE SPECIFICATIONS.
  - CONTRACTOR TO CONFIRM THE LOCATION OF ALL UTILITIES/SERVICES IN THE FIELD PRIOR TO CONSTRUCTION.
  - MODIFIED BARRIER CURB TO BE USED AT ALL INTERSECTION RADII, BACK LANE RADII AND BULLNOSES.
  - CONTRACTOR TO OVERLAY DRIVEWAYS TO ENSURE POSITIVE DRAINAGE TO NEW STREET GRADES. FINAL LIMITS TO BE DETERMINED IN THE FIELD BY CONTRACT ADMINISTRATOR.
  - CB SD-023 & SD-024 OFFSETS ARE DIMENSIONED TO BOC. CB SD-025 OFFSETS ARE DIMENSIONED O/C.
  - REFER TO BID OPPORTUNITY FOR DETAILS REGARDING TRAFFIC MANAGEMENT.
  - ADD 200.000m TO ABBREVIATED ELEVATIONS TO OBTAIN GEODETIC ELEVATIONS.

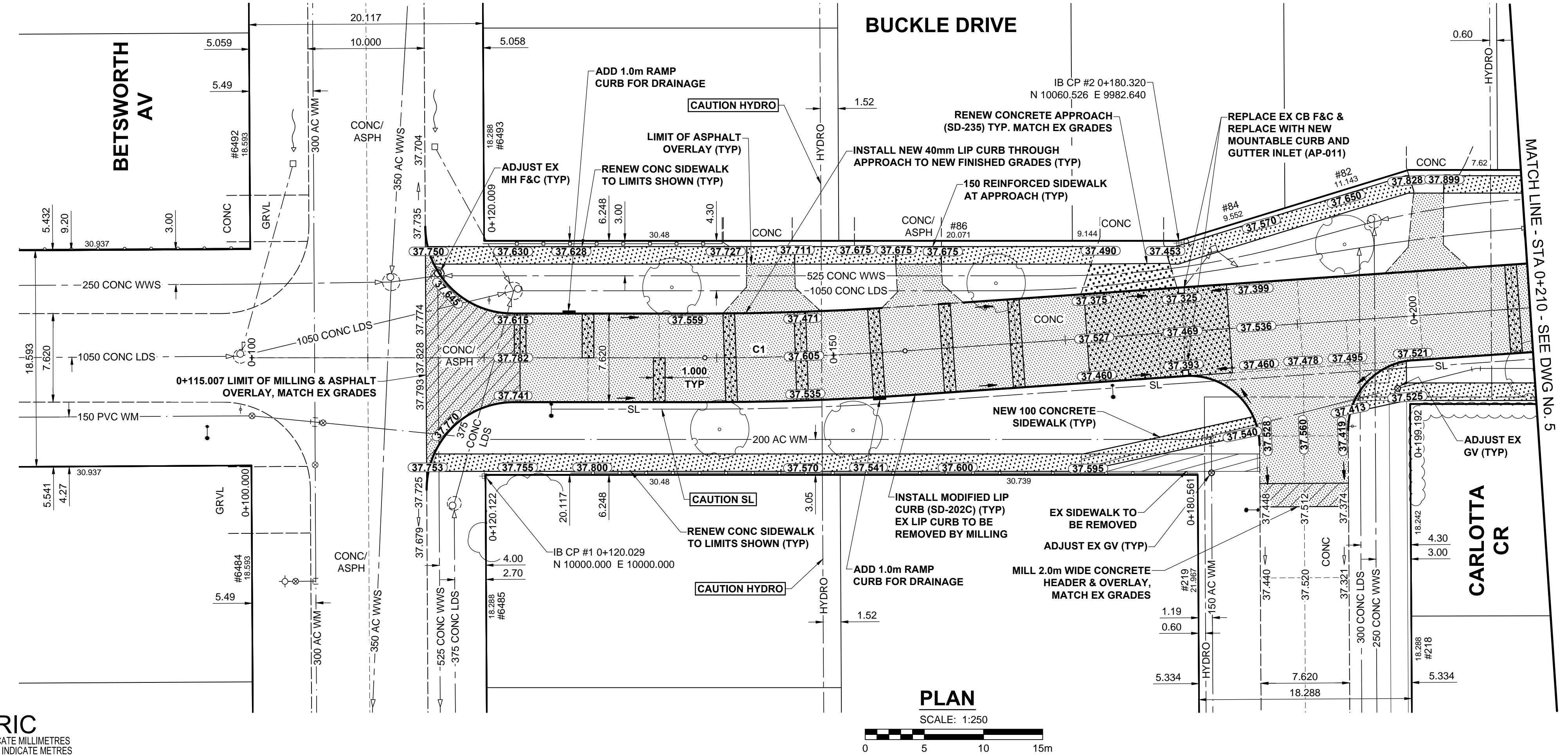

**PLAN**  
SCALE: 1:250  
0 5 10 15m

CONTROL LINE - COORDINATES		
NAME	NORTHING	EASTING
POT 0+100.000	9980.442	9988.962
PC 0+138.982	10019.386	9990.693
PT 0+156.204	10036.604	9990.865
PC 0+229.729	10110.107	9989.067

CONTROL LINE - CURVES				
CURVE	RADIUS	LENGTH	DELTA	TANGENT
C1	250.000	17.222	3°56'49"	8.614

**METRIC**  
WHOLE NUMBERS INDICATE MILLIMETRES  
DECIMALIZED NUMBERS INDICATE METRES

EXISTING	LEGEND - PLAN	NEW	EXISTING	LEGEND - PLAN	NEW	EXISTING	LEGEND - PLAN	NEW
○	GAS	○	MANHOLE	●	CONCRETE PAVEMENT	▨	LOCATION APPROVED UNDERGROUND STRUCTURES	▨
□	MTS	□	CATCH BASIN / CATCH PIT	■	CONC SIDEWALK / MEDIAN	▨	CONCRETE PAVEMENT	▨
△	HYDRO	△	CURB INLET WITH BOX	▲	ASPHALT PAVEMENT	▨	ASPHALT PAVEMENT	▨
—	CATV / FIBRE OPTIC	—	TREE	—	PAVING STONE	▨	PAVING STONE	▨
—	TRAFFIC SIGNALS / PIT	—	TEST HOLE	—	GRAVEL	▨	GRAVEL	▨
—	LAND DRAINAGE SEWER	—	PROPERTY LINE	—	RAMP CURB	▨	RAMP CURB	▨
—	SANITARY/COMBINED SEWER	—	SURVEY BAR	—	PLANING / REMOVAL	▨	PLANING / REMOVAL	▨
—	SEWER SER/ DRAINAGE CONN	—	FENCE	—				
—	WATERMAIN	—	BOC / EDGE OF PAVEMENT	—				
—	SUBDRAIN	—	ELEVATION	—				
—	DITCH	—	TRAFFIC SIGN	—				

**LOCATION APPROVED UNDERGROUND STRUCTURES**

DATE COMMITTEE

**NOTE:**  
LOCATION OF UNDERGROUND STRUCTURES AS SHOWN ARE BASED ON THE BEST INFORMATION AVAILABLE. BUT NO GUARANTEE IS GIVEN THAT ALL EXISTING UTILITIES ARE SHOWN OR THAT THE GIVEN LOCATIONS ARE EXACT. CONFIRMATION OF EXISTENCE AND EXACT LOCATION OF ALL SERVICES MUST BE OBTAINED FROM THE INDIVIDUAL UTILITIES BEFORE PROCEEDING WITH CONSTRUCTION.

DESIGNED BY	RPB	CHECKED BY	WRJ
DRAWN BY	DML	APPROVED BY	BWB
HOR. SCALE	1:250	RELEASED FOR CONSTRUCTION	
VERT. SCALE	1:10		
DATE	15/04/28	DATE	

PROFESSIONAL'S SEAL  
PROVINCE OF MANITOBA  
REGISTERED PROFESSIONAL ENGINEER  
**R.P. BRUCE**  
CONSULTANT DRAWING No.  
W150003.Buckle-PP-01.dwg

**THE CITY OF WINNIPEG**  
PUBLIC WORKS DEPARTMENT  
ENGINEERING DIVISION

2015 LOCAL STREET & ALLEY RENEWAL PROGRAM  
**BUCKLE DRIVE**  
BETSWORTH AV TO CARLOTTA CR  
REHABILITATION  
HORIZONTAL AND VERTICAL ALIGNMENT  
STA 0+080 TO STA 0+210

CITY DRAWING NUMBER N/A  
SHEET 4 OF 31  
DRAWING No. 4  
REV B

**APEGM**  
Certificate of Authorization  
MORRISON HERSHFELD  
No. 1736  
BID OPPORTUNITY No. 18-2015