

A1 SIZE 594mm x 841mm

PLOT: 4/29/2015 5:55:13 PM

FILE NAME: W150003.Clarence-PP-02.dwg, Saved By: dlane

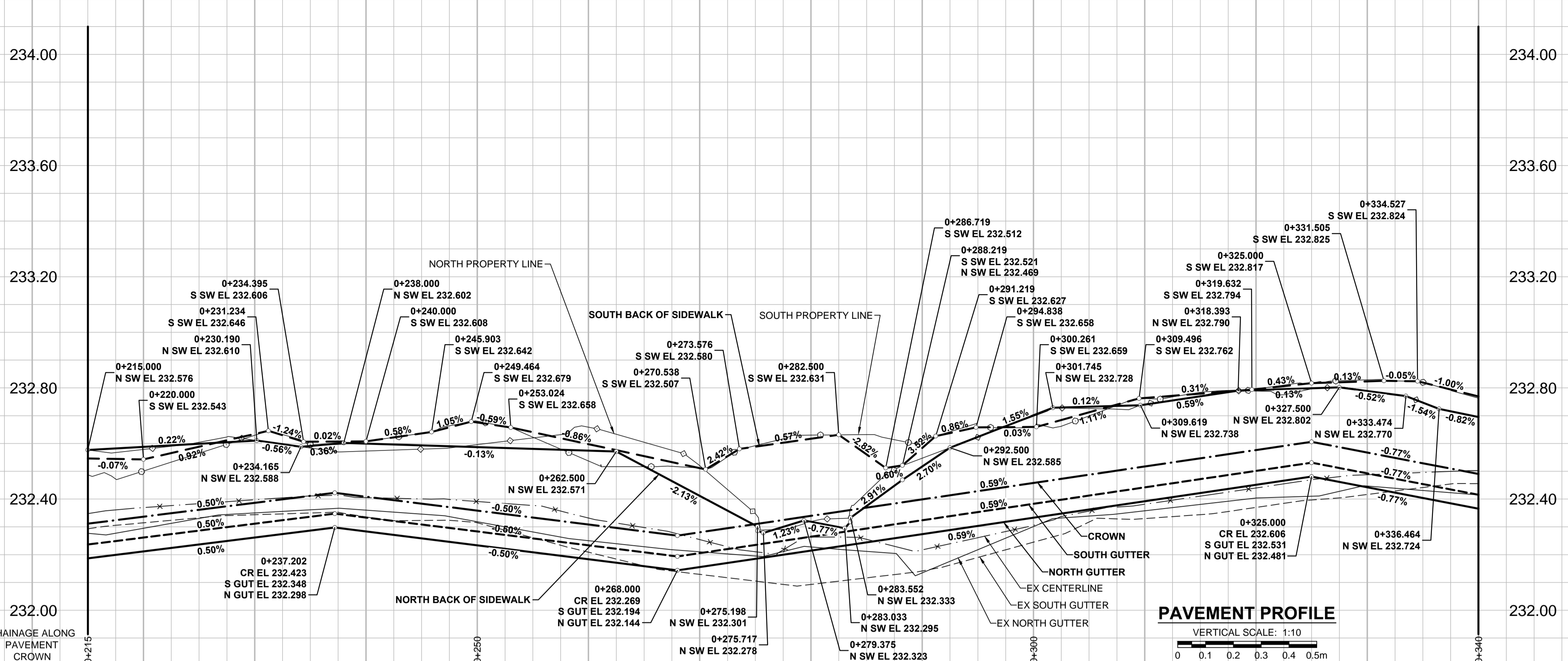

- NOTES**
- ADJUST MH AND CB RIMS TO NEW GRADES.
  - LAMP STANDARDS, HYDRO POLES, AND ANCHORS THAT REQUIRE TEMPORARY SUPPORT, REMOVAL OR REPLACEMENT, TO BE DONE SO AT THE EXPENSE OF THE CONTRACTOR AS NECESSARY.
  - CONTRACTOR TO REGRADE/RENEW EXISTING PRIVATE SIDEWALKS TO LIMITS AS SHOWN. SIDEWALKS TO BE RENEWED WITH CONCRETE UNLESS NOTED OTHERWISE.
  - CONTRACTOR TO TAKE PRECAUTIONARY STEPS TO PROTECT EXISTING TREES WITHIN THE LIMITS OF CONSTRUCTION FROM DAMAGE FROM CONSTRUCTION ACTIVITIES AS OUTLINED IN THE SPECIFICATIONS.
  - CONTRACTOR TO CONFIRM THE LOCATION OF ALL UTILITIES/SERVICES IN THE FIELD PRIOR TO CONSTRUCTION.
  - CB SD-023 & SD-024 OFFSETS ARE DIMENSIONED TO BOC. CB SD-025 OFFSETS ARE DIMENSIONED O/C.
  - MODIFIED BARRIER CURB & GUTTER INLET FRAME & COVER TF-122.
  - IN GENERAL, PAVEMENT AND SIDEWALK AREAS TO BE REMOVED. MATCH RECONSTRUCTION LIMITS.
  - REFER TO BID OPPORTUNITY FOR DETAILS REGARDING TRAFFIC MANAGEMENT.
  - ADD 200.000m TO ABBREVIATED ELEVATIONS TO OBTAIN GEODETIC ELEVATIONS.

CONTROL LINE - COORDINATES		
NAME	NORTHING	EASTING
POT 0+100.000	9907.454	9856.608
POT 0+600.000	10150.002	10293.838

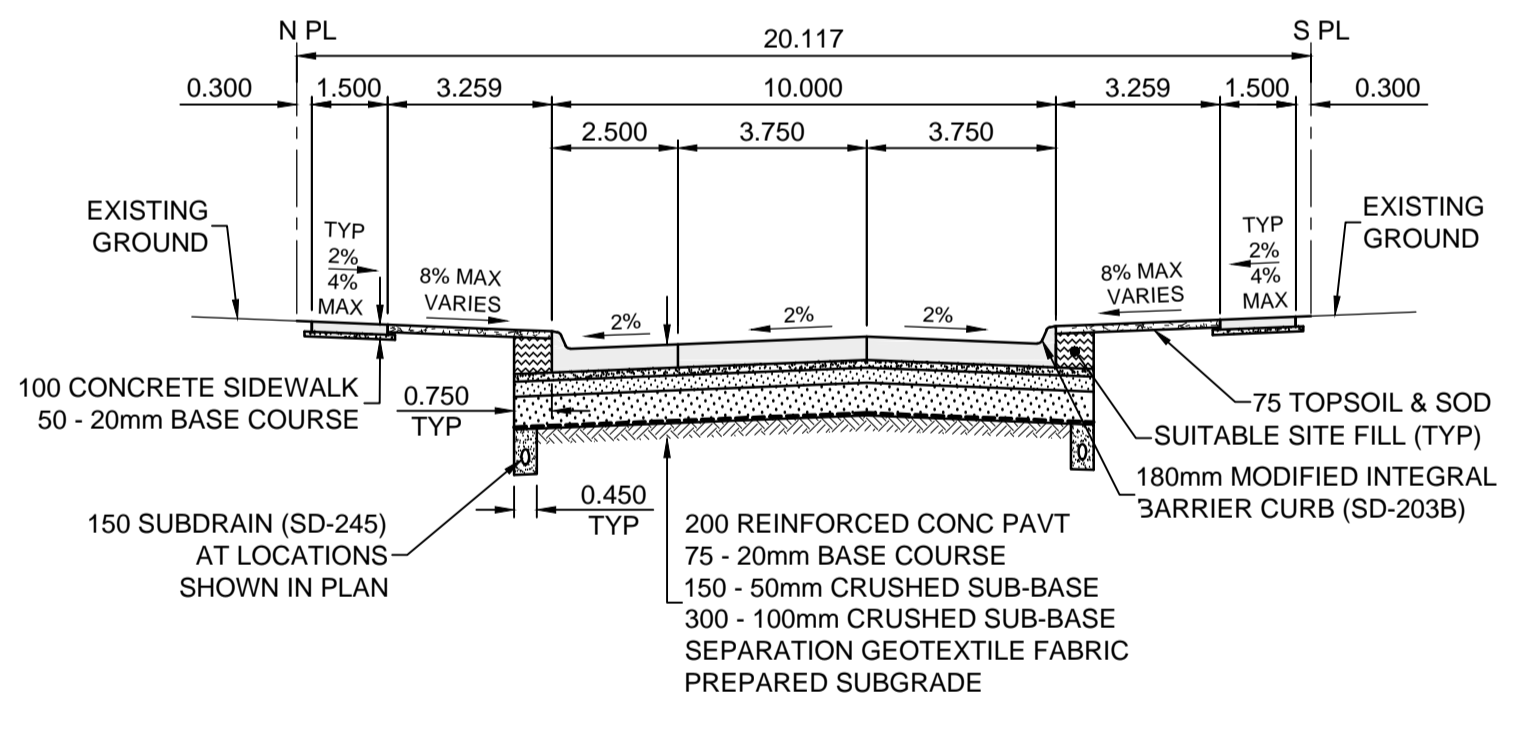
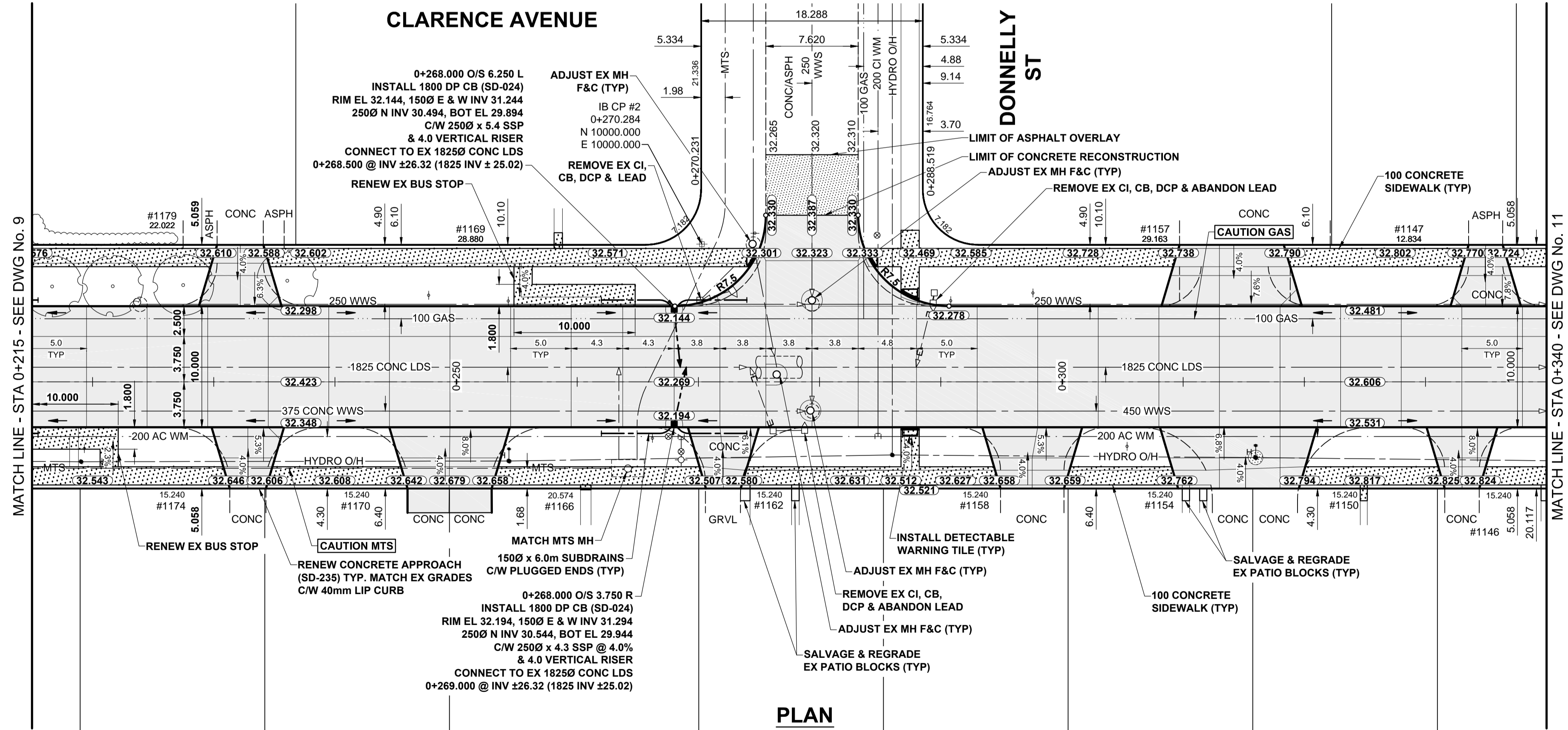

**TYPICAL PAVEMENT SECTION**  
CONCRETE PAVEMENT STRUCTURE  
SCALE: NTS

**METRIC**  
WHOLE NUMBERS INDICATE MILLIMETRES  
DECIMALIZED NUMBERS INDICATE METRES

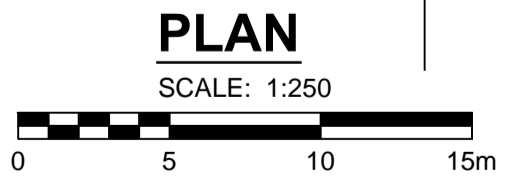

EXISTING	LEGEND - PLAN	NEW	EXISTING	LEGEND - PLAN	NEW	EXISTING	LEGEND - PLAN	NEW	
	GAS		MANHOLE		CONCRETE PAVEMENT		LOCATION APPROVED		GAS
	MTS		CATCH BASIN / CATCH PIT		CONC SIDEWALK / MEDIAN		LOCATION APPROVED		HYDRO
	HYDRO		CURB INLET WITH BOX		ASPHALT PAVEMENT		LOCATION APPROVED		CATV / FIBRE OPTIC
	CATV / FIBRE OPTIC		TREE		PAVING STONE		LOCATION APPROVED		TRAFFIC SIGNALS / PIT
	TRAFFIC SIGNALS / PIT		TEST HOLE		GRAVEL		LOCATION APPROVED		LAND DRAINAGE SEWER
	LAND DRAINAGE SEWER		PROPERTY LINE		RAMP CURB		LOCATION APPROVED		SANITARY/COMBINED SEWER
	SANITARY/COMBINED SEWER		SURVEY BAR		PLANING / REMOVAL		LOCATION APPROVED		SEWER SERV/DRAINAGE CONN
	SEWER SERV/DRAINAGE CONN		FENCE				LOCATION APPROVED		WATERMAIN
	WATERMAIN		BOC / EDGE OF PAVEMENT				LOCATION APPROVED		SUBDRAIN
	SUBDRAIN		ELEVATION				LOCATION APPROVED		DITCH
	DITCH		TRAFFIC SIGN				LOCATION APPROVED		

**LOCATION APPROVED UNDERGROUND STRUCTURES**

GBM 65-018  
ELEV 233.049

S.E. Cor. Clarence Ave. & Marshall Bay, T26, W1 E.  
Conc. foundation of No. 1198 Clarence Ave., 4.0 m S.  
& 0.2 m below street of N.E. Cor. Bldg.

DATE: 15/04/28

DESIGNED BY	JGK	CHECKED BY	WRJ
DRAWN BY	DML	APPROVED BY	BWB
HOR. SCALE	1:250	RELEASED FOR CONSTRUCTION	
VERT. SCALE	1:10	DATE	15/04/28

PROFESSIONAL'S SEAL

PROVINCE OF MANITOBA

J.G. KENNEDY  
Member  
22326

REGISTERED PROFESSIONAL ENGINEER

CONSULTANT DRAWING No.  
W150003.Clarence-PP-02.dwg

**THE CITY OF WINNIPEG**  
PUBLIC WORKS DEPARTMENT  
ENGINEERING DIVISION

2015 LOCAL STREET & ALLEY RENEWAL PROGRAM  
**CLARENCE AVENUE**  
MARSHALL BAY (W LEG) TO HUDSON ST  
CONCRETE RECONSTRUCTION  
HORIZONTAL AND VERTICAL ALIGNMENT  
STA 0+215 TO STA 0+340

CITY DRAWING NUMBER: N/A  
SHEET 10 OF 31  
DRAWING No. 10  
REV B

**APEGM**  
Certificate of Authorization  
MORRISON HERSHFELD  
No. 1736

BID OPPORTUNITY No. 18-2015