

A1 SIZE 594mm x 841mm
PLOT: 4/29/2015 5:56:00 PM
FILE NAME: W150003.Clarence-PP-03.dwg, Saved By: dlane

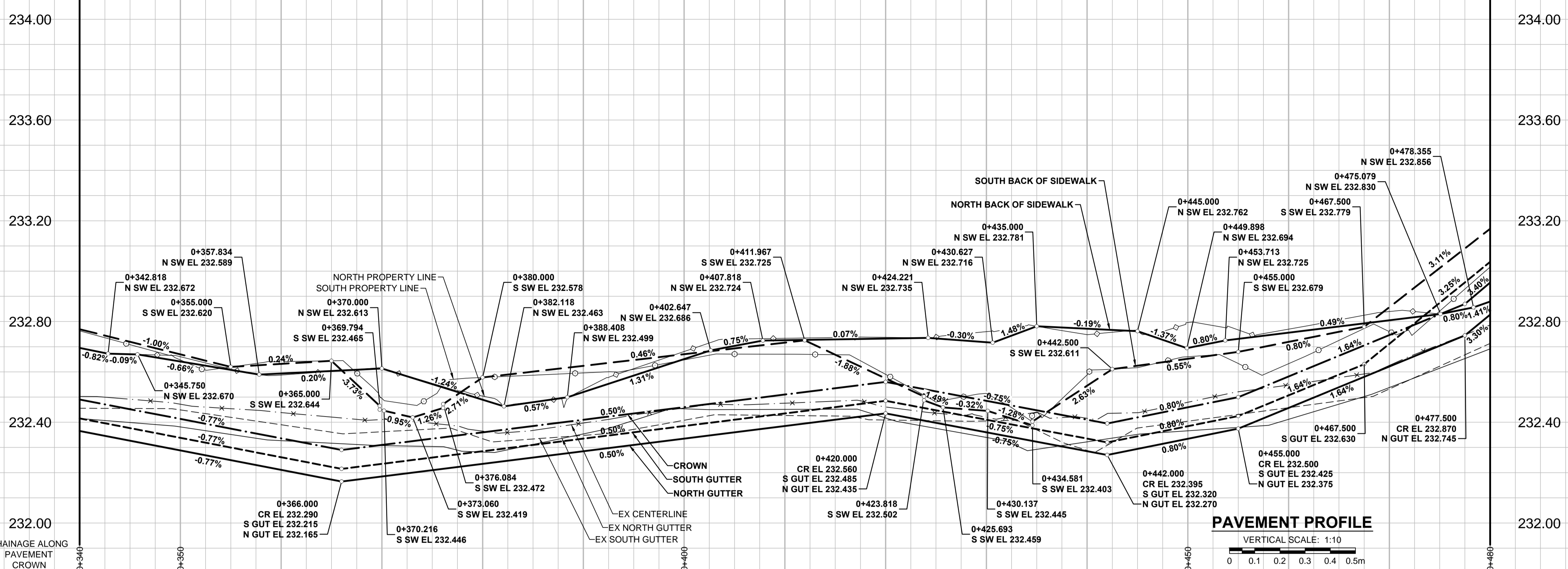

- NOTES**
- ADJUST MH AND CB RIMS TO NEW GRADES.
 - LAMP STANDARDS, HYDRO POLES, AND ANCHORS THAT REQUIRE TEMPORARY SUPPORT, REMOVAL OR REPLACEMENT, TO BE DONE SO AT THE EXPENSE OF THE CONTRACTOR AS NECESSARY.
 - CONTRACTOR TO REGRADE/RENEW EXISTING PRIVATE SIDEWALKS TO LIMITS AS SHOWN. SIDEWALKS TO BE RENEWED WITH CONCRETE UNLESS NOTED OTHERWISE.
 - CONTRACTOR TO TAKE PRECAUTIONARY STEPS TO PROTECT EXISTING TREES WITHIN THE LIMITS OF CONSTRUCTION FROM DAMAGE FROM CONSTRUCTION ACTIVITIES AS OUTLINED IN THE SPECIFICATIONS.
 - CONTRACTOR TO CONFIRM THE LOCATION OF ALL UTILITIES/SERVICES IN THE FIELD PRIOR TO CONSTRUCTION.
 - CB SD-023 & SD-024 OFFSETS ARE DIMENSIONED TO BOC. CB SD-025 OFFSETS ARE DIMENSIONED O/C.
 - MODIFIED BARRIER CURB & GUTTER INLET FRAME & COVER TF-122.
 - IN GENERAL, PAVEMENT AND SIDEWALK AREAS TO BE REMOVED. MATCH RECONSTRUCTION LIMITS.
 - REFER TO BID OPPORTUNITY FOR DETAILS REGARDING TRAFFIC MANAGEMENT.
 - ADD 200.000m TO ABBREVIATED ELEVATIONS TO OBTAIN GEODETIC ELEVATIONS.

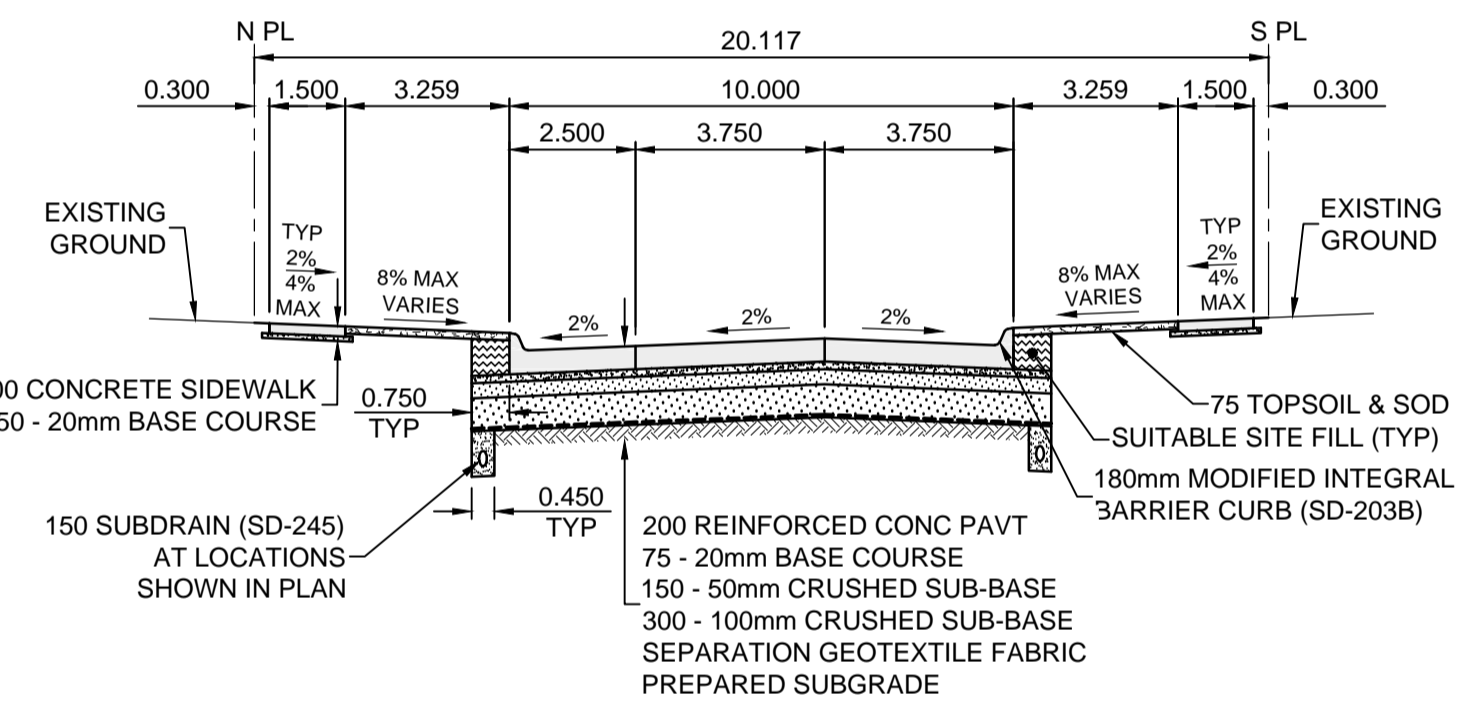
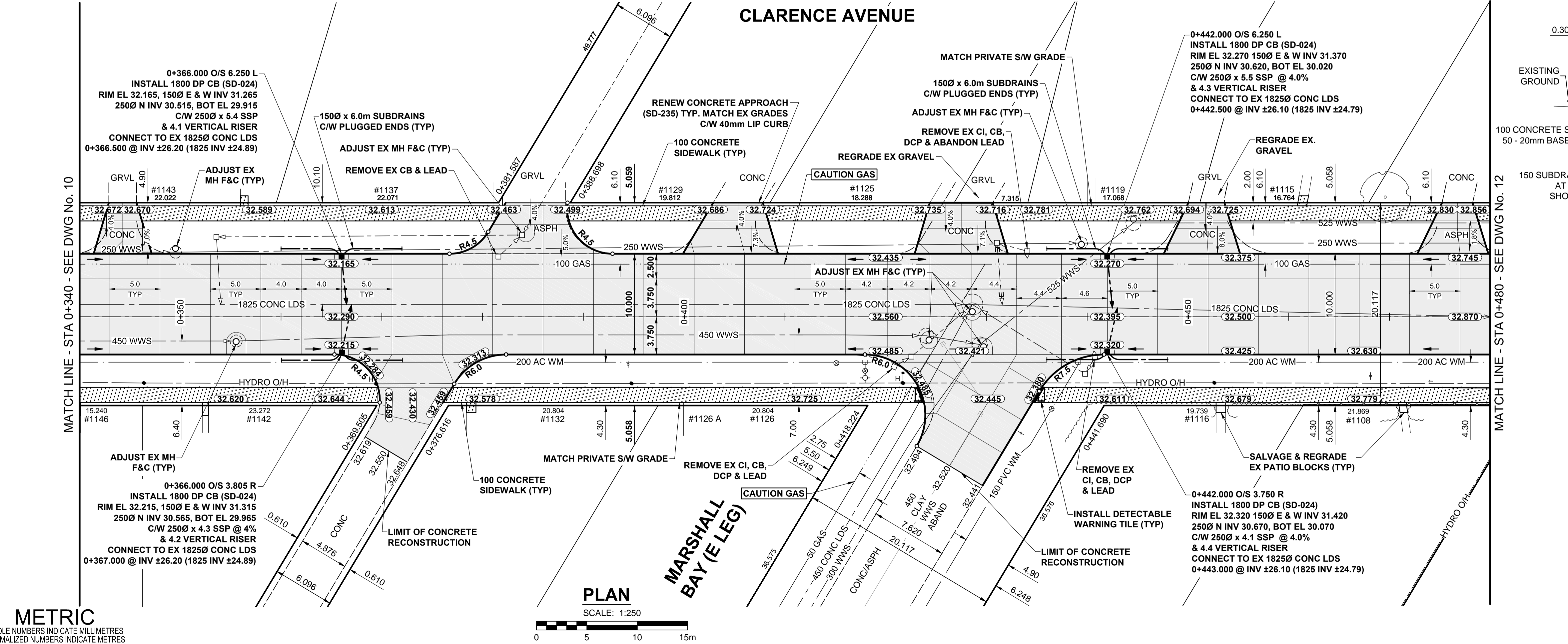
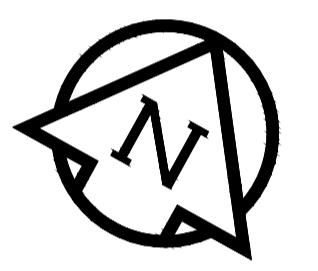

TYPICAL PAVEMENT SECTION
CONCRETE PAVEMENT STRUCTURE
SCALE: NTS

| CONTROL LINE - COORDINATES | | |
|----------------------------|-----------|-----------|
| NAME | NORTHING | EASTING |
| POT 0+100.000 | 9907.454 | 9856.608 |
| POT 0+600.000 | 10150.002 | 10293.838 |

METRIC
WHOLE NUMBERS INDICATE MILLIMETRES
DECIMALIZED NUMBERS INDICATE METRES

| EXISTING | LEGEND - PLAN | NEW | EXISTING | LEGEND - PLAN | NEW | EXISTING | LEGEND - PLAN | NEW | |
|----------|--------------------------|-----|-------------------------|---------------|------------------------|----------|--|-----|------------------------|
| | GAS | | MANHOLE | | CONCRETE PAVEMENT | | LOCATION APPROVED | | UNDERGROUND STRUCTURES |
| | MTS | | CATCH BASIN / CATCH PIT | | CONC SIDEWALK / MEDIAN | | SUPR. U/G STRUCTURES | | DATE |
| | HYDRO | | CURB INLET WITH BOX | | ASPHALT PAVEMENT | | NOTE: | | INFORMATION AVAILABLE |
| | CATV / FIBRE OPTIC | | TREE | | PAVING STONE | | GUARANTEE IS GIVEN THAT ALL EXISTING UTILITIES ARE SHOWN OR THAT THE GIVEN LOCATIONS ARE EXACT. CONFIRMATION OF EXISTENCE AND EXACT LOCATION OF ALL SERVICES MUST BE OBTAINED FROM THE INDIVIDUAL UTILITIES BEFORE PROCEEDING WITH CONSTRUCTION. | | ISSUED FOR TENDER |
| | TRAFFIC SIGNALS / PIT | | TEST HOLE | | GRAVEL | | ISSUED FOR CITY REVIEW | | REVISIONS |
| | LAND DRAINAGE SEWER | | PROPERTY LINE | | RAMP CURB | | DATE | | BY |
| | SANITARY/COMBINED SEWER | | SURVEY BAR | | PLANING / REMOVAL | | ISSUED FOR TENDER | | DATE |
| | SEWER SERV/DRAINAGE CONN | | FENCE | | LOCATION APPROVED | | ISSUED FOR CITY REVIEW | | REVISIONS |
| | WATERMAIN | | BOC / EDGE OF PAVEMENT | | LOCATION APPROVED | | ISSUED FOR TENDER | | DATE |
| | SUBDRAIN | | ELEVATION | | LOCATION APPROVED | | ISSUED FOR CITY REVIEW | | REVISIONS |
| | DITCH | | TRAFFIC SIGN | | LOCATION APPROVED | | ISSUED FOR TENDER | | DATE |

| | |
|----------------------------|--|
| GBM 65-018 ELEV 233.049 | S.E. Cor. Clarence Ave. & Marshall Bay, 7th. W.E. Conc. foundation of No. 1198 Clarence Ave., 4.0 m S. & 0.2 m below street of N.E. Cor. Bldg. |
| | MORRISON HERSHFELD |
| DESIGNED BY: JGK | CHECKED BY: WRJ |
| DRAWN BY: DML | APPROVED BY: BWB |
| HOR. SCALE: 1:250 | RELEASED FOR CONSTRUCTION |
| VERT. SCALE: 1:10 | |
| DATE: 15/04/28 | DATE: |

| | |
|--|--|
| PROFESSIONAL'S SEAL | |
| PROVINCE OF MANITOBA | |
| REGISTERED PROFESSIONAL ENGINEER | |
| J.G. KENNEDY Member 22326 | |
| CONSULTANT DRAWING No. W150003 Clarence-PP-03.dwg | |

THE CITY OF WINNIPEG
PUBLIC WORKS DEPARTMENT
ENGINEERING DIVISION

2015 LOCAL STREET & ALLEY RENEWAL PROGRAM
CLARENCE AVENUE
MARSHALL BAY (W LEG) TO HUDSON ST
CONCRETE RECONSTRUCTION
HORIZONTAL AND VERTICAL ALIGNMENT
STA 0+340 TO STA 0+480

CITY DRAWING NUMBER: N/A
SHEET 11 OF 31
DRAWING No. 11
REV B

BID OPPORTUNITY No. 18-2015