

A1 SIZE 594mm x 841mm
PLOT: 4/29/2015 5:57:31 PM
FILE NAME: W150003.Swan Lake-PP-01.dwg, Saved By: diane

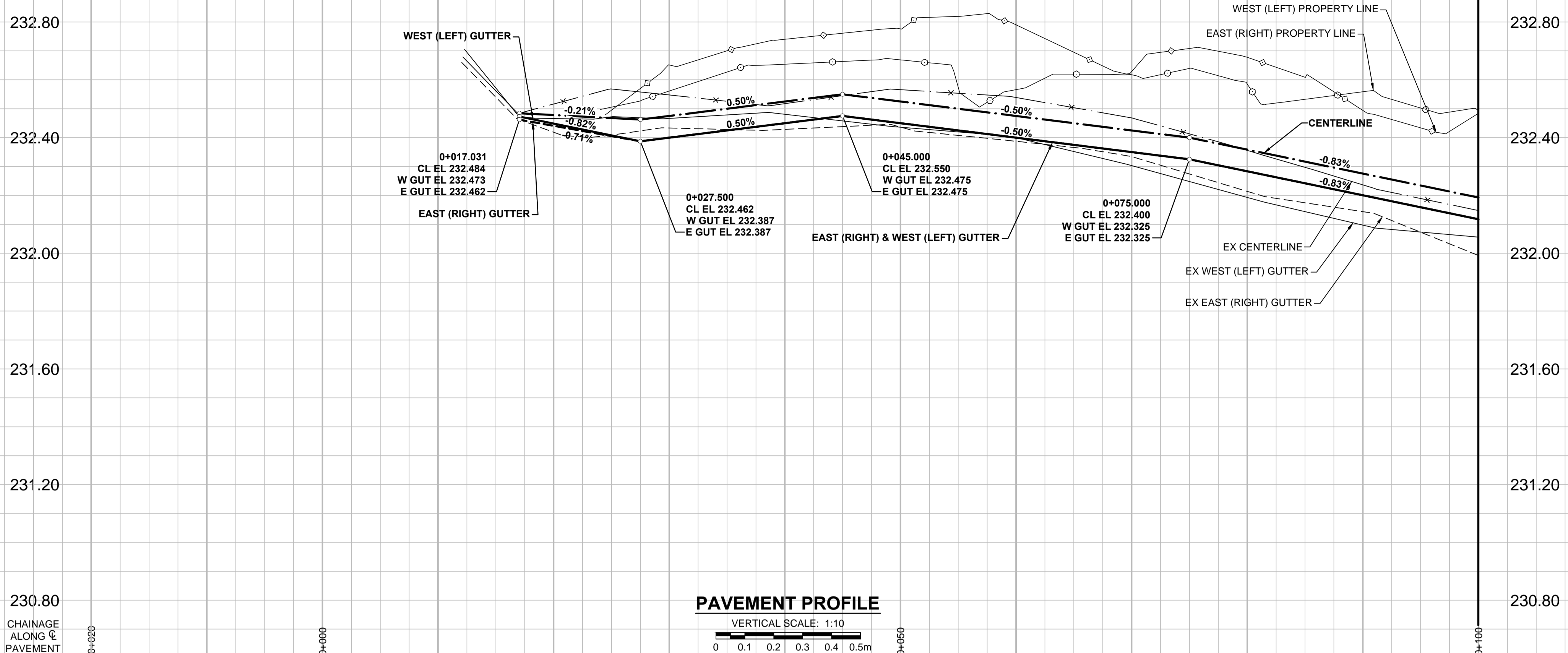

- NOTES**
- ADJUST MH AND CB RIMS TO NEW GRADES.
 - LAMP STANDARDS, HYDRO POLES, AND ANCHORS THAT REQUIRE TEMPORARY SUPPORT, REMOVAL OR REPLACEMENT, TO BE DONE SO AT THE EXPENSE OF THE CONTRACTOR AS NECESSARY.
 - CONTRACTOR TO REGRADE/RENEW EXISTING PRIVATE SIDEWALKS TO LIMITS AS SHOWN. SIDEWALKS TO BE RENEWED WITH CONCRETE UNLESS NOTED OTHERWISE.
 - CONTRACTOR TO TAKE PRECAUTIONARY STEPS TO PROTECT EXISTING TREES WITHIN THE LIMITS OF CONSTRUCTION FROM DAMAGE FROM CONSTRUCTION ACTIVITIES AS OUTLINED IN THE SPECIFICATIONS.
 - CONTRACTOR TO CONFIRM THE LOCATION OF ALL UTILITIES/SERVICES IN THE FIELD PRIOR TO CONSTRUCTION.
 - MODIFIED BARRIER CURB TO BE USED AT ALL INTERSECTION RADII, BACK LANE RADII AND BULLNOSES.
 - CB SD-023 & SD-024 OFFSETS ARE DIMENSIONED TO BOC. CB SD-025 OFFSETS ARE DIMENSIONED O/C.
 - ADD 200.000m TO ABBREVIATED ELEVATIONS TO OBTAIN GEODETIC ELEVATIONS.
 - IN GENERAL, PAVEMENT AND SIDEWALK AREAS TO BE REMOVED. MATCH RECONSTRUCTION LIMITS.
 - REFER TO BID OPPORTUNITY FOR DETAILS REGARDING TRAFFIC MANAGEMENT.

PAVEMENT PROFILE
VERTICAL SCALE: 1:10

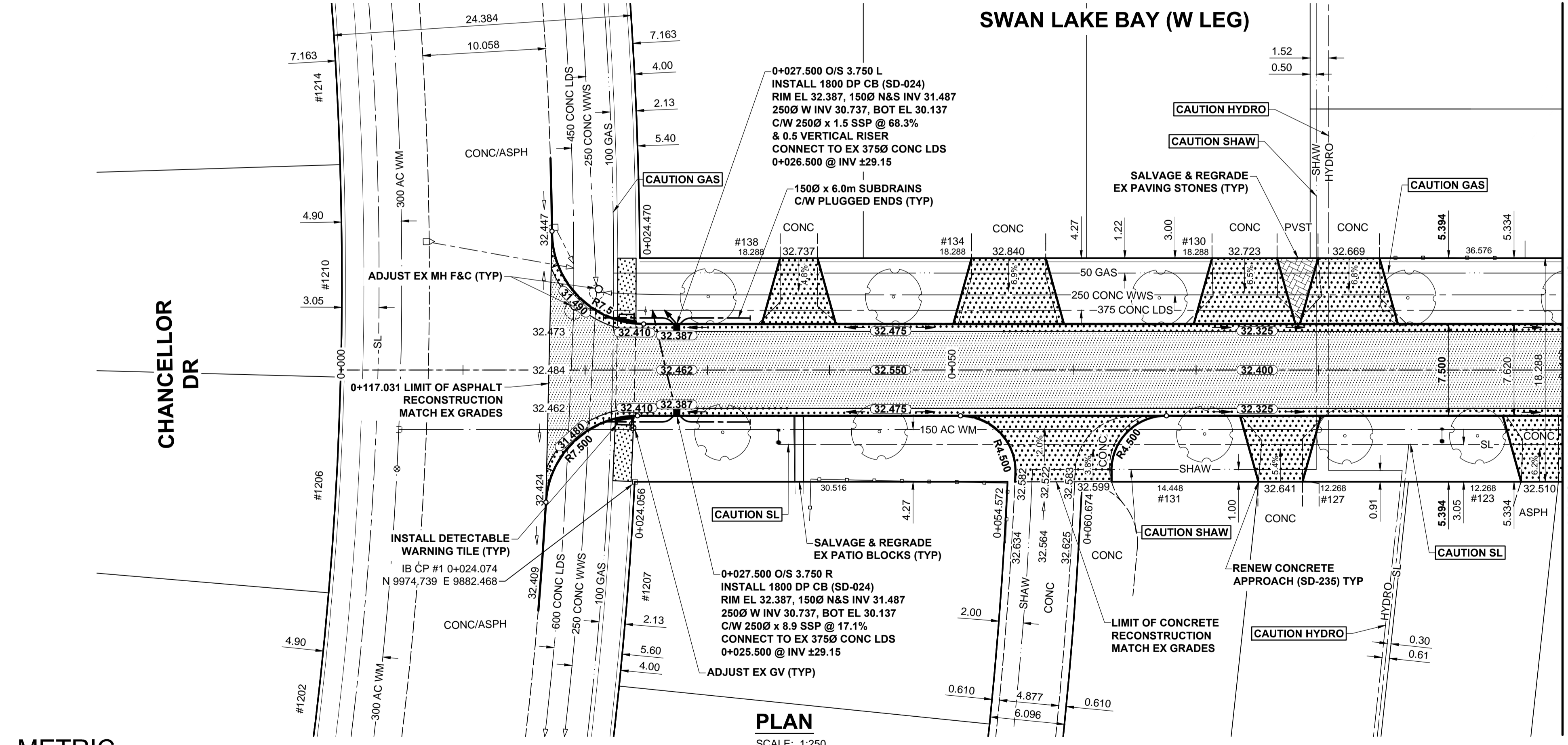

PLAN
SCALE: 1:250

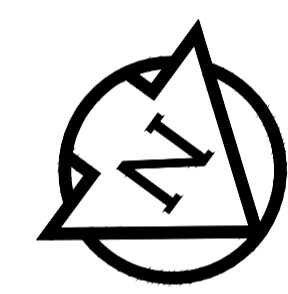

CONTROL LINE - COORDINATES		
NAME	NORTHING	EASTING
POT 0+000.000	9949.9190	9889.3440
PC 0+136.248	10059.7219	9808.6799

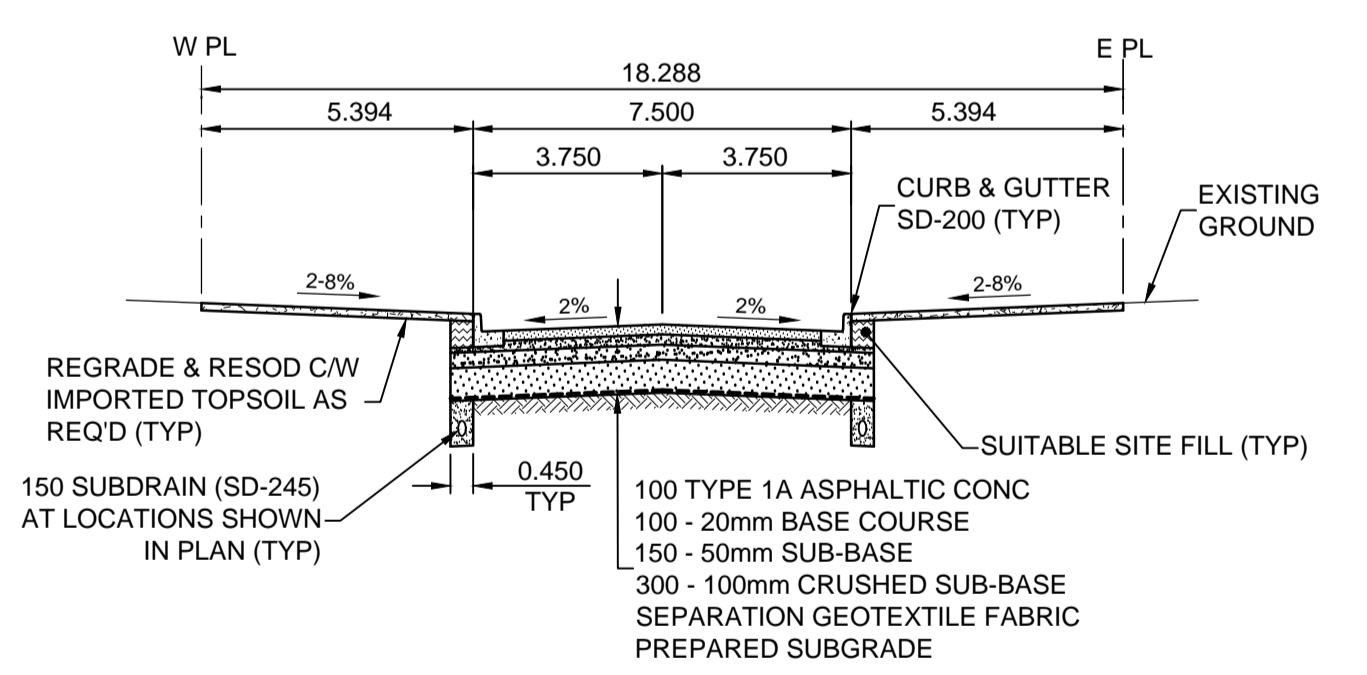

TYPICAL PAVEMENT SECTION
ASPHALT PAVEMENT STRUCTURE
SCALE: NTS

METRIC
WHOLE NUMBERS INDICATE MILLIMETRES
DECIMALIZED NUMBERS INDICATE METRES

EXISTING	LEGEND - PLAN	NEW	EXISTING	LEGEND - PLAN	NEW	EXISTING	LEGEND - PLAN	NEW	
	GAS		MANHOLE		CONCRETE PAVEMENT		LOCATION APPROVED		GAS
	MTS		CATCH BASIN / CATCH PIT		CONC SIDEWALK / MEDIAN		UNDERGROUND STRUCTURES		HYDRO
	HYDRO		CURB INLET WITH BOX		ASPHALT PAVEMENT		SUPR. U/G STRUCTURES		CATV / FIBRE OPTIC
	CATV / FIBRE OPTIC		TREE		PAVING STONE		DATE		TRAFFIC SIGNALS / PIT
	TRAFFIC SIGNALS / PIT		TEST HOLE		GRAVEL		NOTE:		LAND DRAINAGE SEWER
	LAND DRAINAGE SEWER		PROPERTY LINE		RAMP CURB		LOCATION OF UNDERGROUND STRUCTURES AS SHOWN ARE BASED ON THE BEST INFORMATION AVAILABLE. BUT NO GUARANTEE IS GIVEN THAT ALL EXISTING UTILITIES ARE SHOWN OR THAT THE GIVEN LOCATIONS ARE EXACT. CONFIRMATION OF EXISTENCE AND EXACT LOCATION OF ALL SERVICES MUST BE OBTAINED FROM THE INDIVIDUAL UTILITIES BEFORE PROCEEDING WITH CONSTRUCTION.		SANITARY/COMBINED SEWER
	SANITARY/COMBINED SEWER		SURVEY BAR		PLANING / REMOVAL		INFORMATION AVAILABLE		SEWER SERV/DRAINAGE CONN
	SEWER SERV/DRAINAGE CONN		FENCE		RAMP CURB		NO GUARANTEE		WATERMAIN
	WATERMAIN		BOC / EDGE OF PAVEMENT		PLANING / REMOVAL		EXISTING UTILITIES		SUBDRAIN
	SUBDRAIN		ELEVATION		PLANING / REMOVAL		NEW UTILITIES		DITCH
	DITCH		TRAFFIC SIGN		PLANING / REMOVAL		INDIVIDUAL UTILITIES		EXISTING PAVEMENT

GBM 76-034	N.W. Cor. Chancellor Dr. & E. leg of Swan Lake Bay, Tbt.	PROFESSIONAL'S SEAL	
ELEV 231.884	on top of 0.05 m dia. x 2.4 m iron pipe, 0.6 m E. of W.L. of E. leg of Swan Lake Bay & 6.4 m S. of N.L. of Chancellor Dr.	REGISTERED PROFESSIONAL ENGINEER	
		CONSULTANT DRAWING No.	W150003 Swan Lane-PP-01.dwg
		DESIGNED BY	RPB
		CHECKED BY	WRJ
		DRAWN BY	DML
		APPROVED BY	BWB
		RELEASED FOR CONSTRUCTION	
		HOR. SCALE	1:250
		VERT. SCALE	1:10
		DATE	15/04/28
		DATE	

MORRISON HERSHFELD

DESIGNED BY: RPB
CHECKED BY: WRJ
DRAWN BY: DML
APPROVED BY: BWB

HOR. SCALE: 1:250
VERT. SCALE: 1:10
DATE: 15/04/28

THE CITY OF WINNIPEG
PUBLIC WORKS DEPARTMENT
ENGINEERING DIVISION

2015 LOCAL STREET & ALLEY RENEWAL PROGRAM
SWAN LAKE BAY
CHANCELLOR DR TO CHANCELLOR DR
ASPHALT RECONSTRUCTION
HORIZONTAL AND VERTICAL ALIGNMENT
STA 0+000 TO STA 0+100

CITY DRAWING NUMBER: N/A
SHEET 13 OF 31
DRAWING No. 13
REV B

BID OPPORTUNITY No. 18-2015