

A1 SIZE 594mm x 841mm

PLOT: 4/29/2015 6:01:54 PM

FILE NAME: W150003.Greyfriars-PP-02.dwg - Saved By: diane

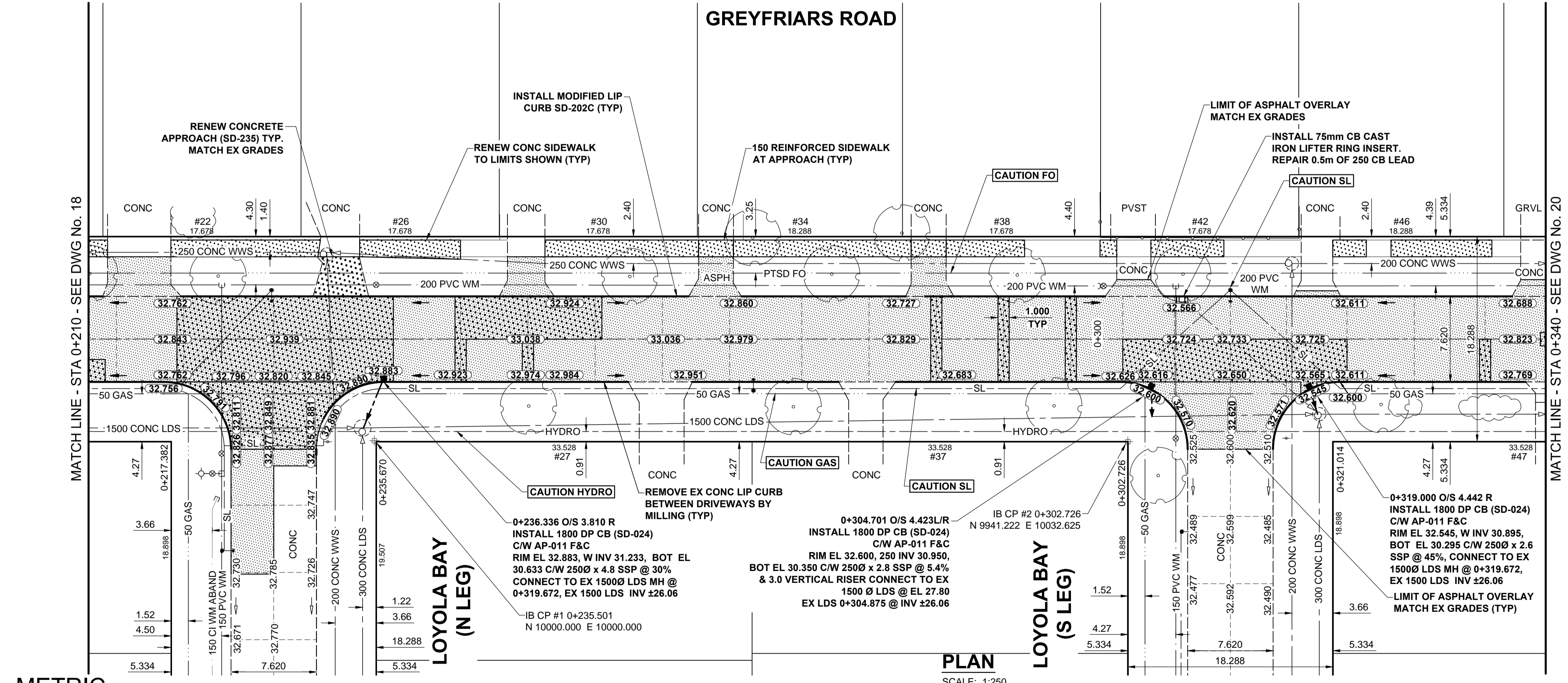
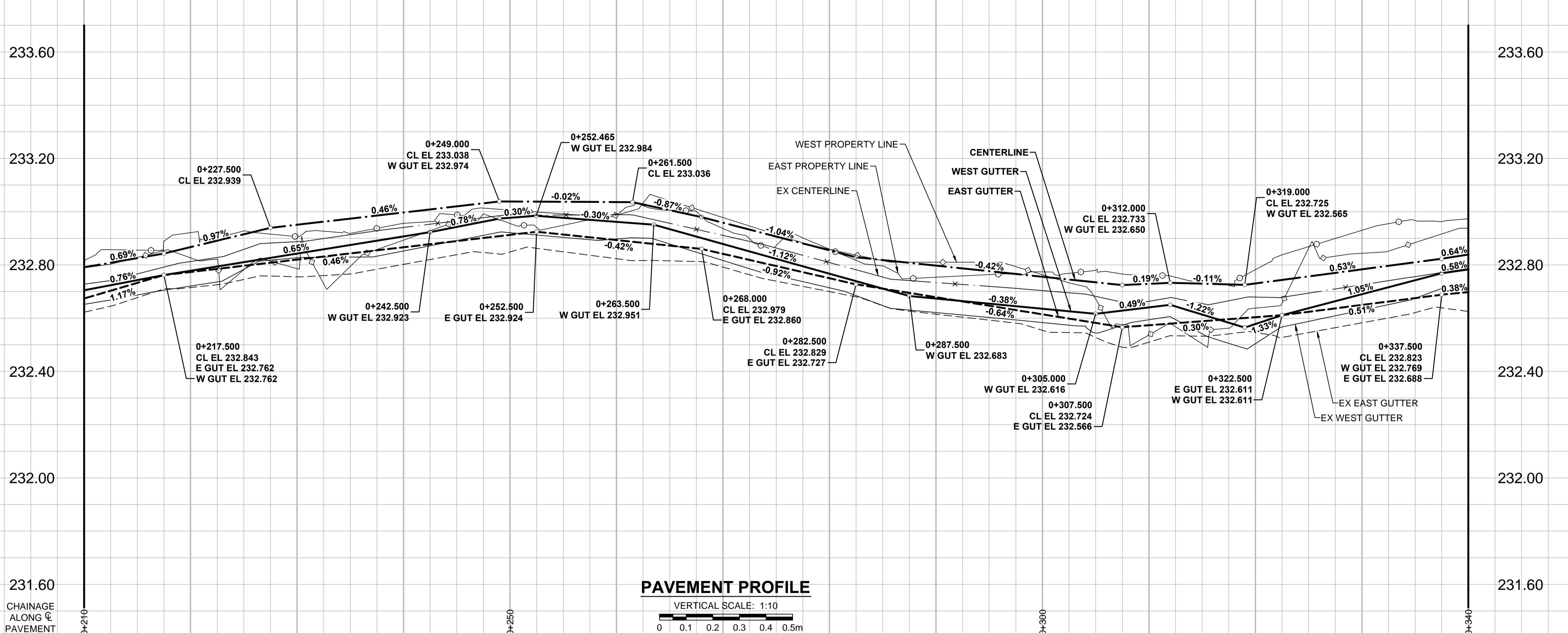

- NOTES**
- ADJUST MH AND CB RIMS TO NEW GRADES.
  - LAMP STANDARDS, HYDRO POLES, AND ANCHORS THAT REQUIRE TEMPORARY SUPPORT, REMOVAL OR REPLACEMENT, TO BE DONE SO AT THE EXPENSE OF THE CONTRACTOR AS NECESSARY.
  - REGRADE/RENEW EXISTING PRIVATE SIDEWALKS TO LIMITS AS SHOWN. SIDEWALKS TO BE RENEWED WITH CONCRETE UNLESS NOTED OTHERWISE.
  - TAKE PRECAUTIONARY STEPS TO PROTECT EXISTING TREES WITHIN THE LIMITS OF CONSTRUCTION FROM DAMAGE FROM CONSTRUCTION ACTIVITIES AS OUTLINED IN THE SPECIFICATIONS.
  - CONFIRM THE LOCATION OF ALL UTILITIES/SERVICES IN THE FIELD PRIOR TO CONSTRUCTION.
  - MODIFIED BARRIER CURB TO BE USED AT ALL INTERSECTION RADI, BACK LANE RADI AND BULLNOSES.
  - OVERLAY DRIVEWAYS TO ENSURE POSITIVE DRAINAGE TO NEW STREET GRADES. FINAL LIMITS TO BE DETERMINED IN THE FIELD BY CONTRACT ADMINISTRATOR.
  - CB SD-023 & SD-024 OFFSETS ARE DIMENSIONED TO BOC. CB SD-025 OFFSETS ARE DIMENSIONED O/C.
  - REFER TO BID OPPORTUNITY FOR DETAILS REGARDING TRAFFIC MANAGEMENT.
  - ADD 200.000m TO ABBREVIATED ELEVATIONS TO OBTAIN GEODETIC ELEVATIONS.

CONTROL LINE - COORDINATES		
NAME	NORTHING	EASTING
POT 0+100.000	10122.804	9942.019
PC 0+491.702	9780.549	10132.523

**METRIC**  
WHOLE NUMBERS INDICATE MILLIMETRES  
DECIMALIZED NUMBERS INDICATE METRES

EXISTING	LEGEND - PLAN	NEW	EXISTING	LEGEND - PLAN	NEW	EXISTING	LEGEND - PLAN	NEW	
	GAS		MANHOLE		CONCRETE PAVEMENT		LOCATION APPROVED		GAS
	MTS		CATCH BASIN / CATCH PIT		CONC SIDEWALK / MEDIAN		UNDERGROUND STRUCTURES		HYDRO
	HYDRO		CURB INLET WITH BOX		ASPHALT PAVEMENT		DATE		CATV / FIBRE OPTIC
	CATV / FIBRE OPTIC		TREE		PAVING STONE		COMMITTEE		TRAFFIC SIGNALS / PIT
	TRAFFIC SIGNALS / PIT		TEST HOLE		PAVING STONE		NOTE:		LAND DRAINAGE SEWER
	LAND DRAINAGE SEWER		PROPERTY LINE		GRAVEL		LOCATION APPROVED		SANITARY/COMBINED SEWER
	SANITARY/COMBINED SEWER		SURVEY BAR		RAMP CURB		LOCATION APPROVED		SEWER SERV/DRAINAGE CONN
	SEWER SERV/DRAINAGE CONN		FENCE		PLANING / REMOVAL		LOCATION APPROVED		WATERMAIN
	WATERMAIN		BOC / EDGE OF PAVEMENT		LOCATION APPROVED		LOCATION APPROVED		SUBDRAIN
	SUBDRAIN		ELEVATION		LOCATION APPROVED		LOCATION APPROVED		DITCH
	DITCH		TRAFFIC SIGN		LOCATION APPROVED		LOCATION APPROVED		EXISTING

**LOCATION APPROVED UNDERGROUND STRUCTURES**

DATE COMMITTEE

NOTE: LOCATION OF UNDERGROUND STRUCTURES AS SHOWN ARE BASED ON THE BEST INFORMATION AVAILABLE. BUT NO GUARANTEE IS GIVEN THAT ALL EXISTING UTILITIES ARE SHOWN OR THAT THE GIVEN LOCATIONS ARE EXACT. CONFIRMATION OF EXISTENCE AND EXACT LOCATION OF ALL SERVICES MUST BE OBTAINED FROM THE INDIVIDUAL UTILITIES BEFORE PROCEEDING WITH CONSTRUCTION.

GBM 82-014  
ELEV 233.134

S.E. Cor. Dalhousie Dr. & St. Edmund's Bay, 10m W. W. Conc. foundation of No. 3 St. Edmund's Bay, 3.0 m S. & 0.3 m below surface of N.W. Cor. of most W. wall of house.

B	ISSUED FOR TENDER	15/04/30	RPB
A	ISSUED FOR CITY REVIEW	15/04/28	RPB
No.	REVISIONS	YYMMDDI	BY

**MORRISON HERSHFIELD**

DESIGNED BY	WRJ	CHECKED BY	RPB
DRAWN BY	DML	APPROVED BY	BWB
HOR. SCALE	1:250	RELEASED FOR CONSTRUCTION	
VERT. SCALE	1:10	DATE	15/04/28

PROFESSIONAL'S SEAL

PROVINCE OF MANITOBA

R.P. BRUCE

REGISTERED PROFESSIONAL ENGINEER

CONSULTANT DRAWING No. W150003 Greyfriars-PP-02.dwg

**THE CITY OF WINNIPEG**  
PUBLIC WORKS DEPARTMENT  
ENGINEERING DIVISION

**2015 LOCAL STREET & ALLEY RENEWAL PROGRAM**  
**GREYFRIARS ROAD**  
KILLARNEY AV TO DALHOUSIE DR  
REHABILITATION  
HORIZONTAL AND VERTICAL ALIGNMENT  
STA 0+210 TO STA 0+340

CITY DRAWING NUMBER	N/A
SHEET	19 OF 31
DRAWING No.	19
REV	B

BID OPPORTUNITY No. 18-2015