

A1 SIZE 594mm x 841mm

FILE NAME: W150003.Greyfriars-PP-03.dwg. Saved By: diane

PLT: 4/29/2015 6:02:36 PM

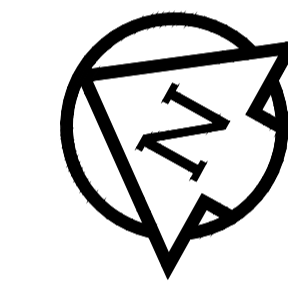
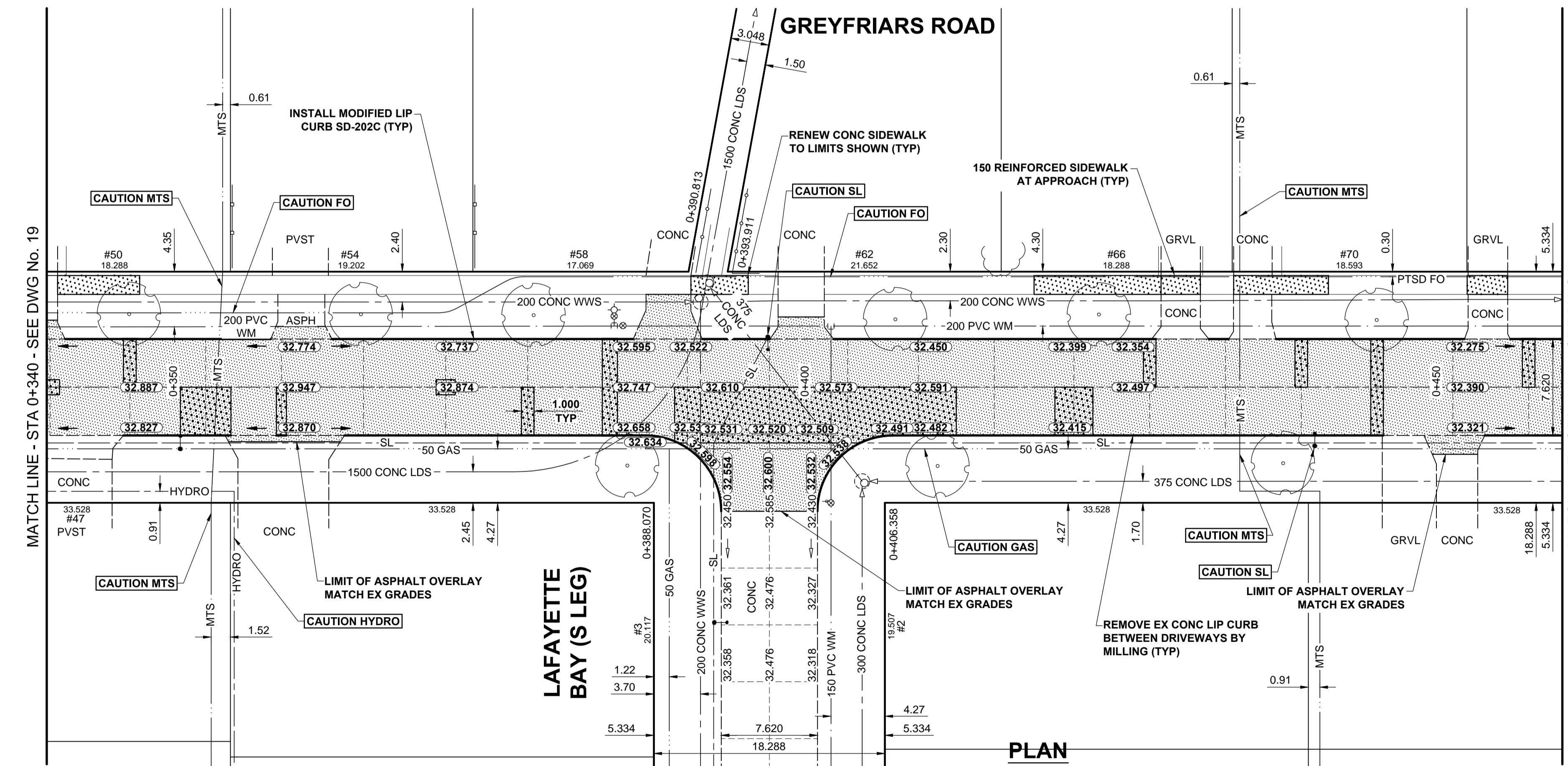
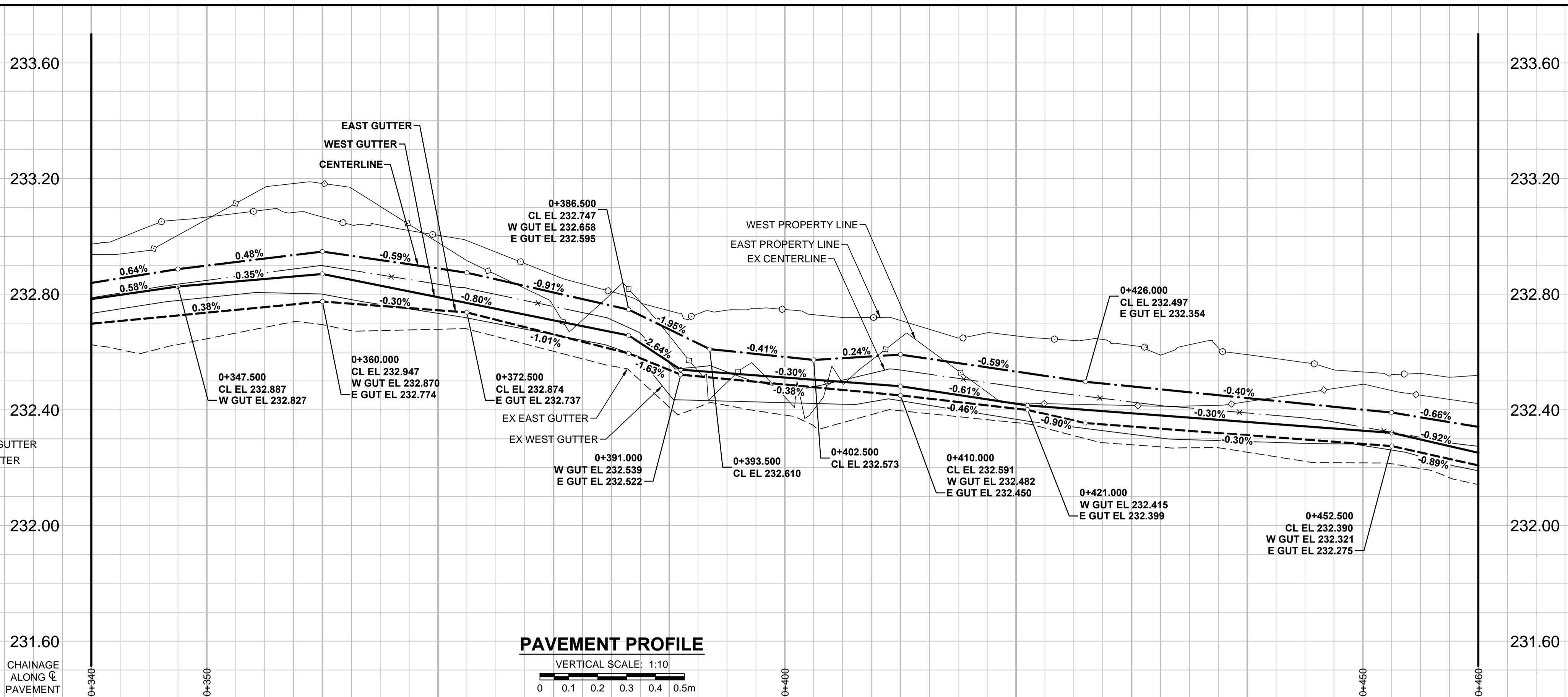

**NOTES**

- ADJUST MH AND CB RIMS TO NEW GRADES.
- LAMP STANDARDS, HYDRO POLES, AND ANCHORS THAT REQUIRE TEMPORARY SUPPORT, REMOVAL OR REPLACEMENT, TO BE DONE SO AT THE EXPENSE OF THE CONTRACTOR AS NECESSARY.
- REGRADE/RENEW EXISTING PRIVATE SIDEWALKS TO LIMITS AS SHOWN. SIDEWALKS TO BE RENEWED WITH CONCRETE UNLESS NOTED OTHERWISE.
- TAKE PRECAUTIONARY STEPS TO PROTECT EXISTING TREES WITHIN THE LIMITS OF CONSTRUCTION FROM DAMAGE FROM CONSTRUCTION ACTIVITIES AS OUTLINED IN THE SPECIFICATIONS.
- CONFIRM THE LOCATION OF ALL UTILITIES/SERVICES IN THE FIELD PRIOR TO CONSTRUCTION.
- MODIFIED BARRIER CURB TO BE USED AT ALL INTERSECTION RADI, BACK LANE RADI AND BULLNOSES.
- OVERLAY DRIVEWAYS TO ENSURE POSITIVE DRAINAGE TO NEW STREET GRADES. FINAL LIMITS TO BE DETERMINED IN THE FIELD BY CONTRACT ADMINISTRATOR.
- CB SD-023 & SD-024 OFFSETS ARE DIMENSIONED TO BOC. CB SD-025 OFFSETS ARE DIMENSIONED O/C.
- REFER TO BID OPPORTUNITY FOR DETAILS REGARDING TRAFFIC MANAGEMENT.
- ADD 200.000m TO ABBREVIATED ELEVATIONS TO OBTAIN GEODETIC ELEVATIONS.

CONTROL LINE - COORDINATES		
NAME	NORTHING	EASTING
POT 0+100.000	10122.804	9942.019
PC 0+491.702	9780.549	10132.523

**METRIC**  
WHOLE NUMBERS INDICATE MILLIMETRES  
DECIMALIZED NUMBERS INDICATE METRES

EXISTING	LEGEND - PLAN	NEW	EXISTING	LEGEND - PLAN	NEW	EXISTING	LEGEND - PLAN	NEW	
	GAS		MANHOLE		CONCRETE PAVEMENT		LOCATION APPROVED		GAS
	MTS		CATCH BASIN / CATCH PIT		CONC SIDEWALK / MEDIAN		SUPR. U/G STRUCTURES		HYDRO
	HYDRO		CURB INLET WITH BOX		ASPHALT PAVEMENT		DATE		CATV / FIBRE OPTIC
	CATV / FIBRE OPTIC		TREE		PAVING STONE		COMMITTEE		TRAFFIC SIGNALS / PIT
	LAND DRAINAGE SEWER		TEST HOLE		GRAVEL		NOTE:		LAND DRAINAGE SEWER
	SANITARY/COMBINED SEWER		PROPERTY LINE		RAMP CURB		LOCATION APPROVED		SANITARY/COMBINED SEWER
	SEWER SERV/DRAINAGE CONN		SURVEY BAR		PLANING / REMOVAL		LOCATION APPROVED		SEWER SERV/DRAINAGE CONN
	WATERMAIN		FENCE		PLANING / REMOVAL		LOCATION APPROVED		WATERMAIN
	SUBDRAIN		BOC / EDGE OF PAVEMENT		PLANING / REMOVAL		LOCATION APPROVED		SUBDRAIN
	DITCH		ELEVATION		PLANING / REMOVAL		LOCATION APPROVED		DITCH
	DITCH		TRAFFIC SIGN		PLANING / REMOVAL		LOCATION APPROVED		DITCH

GBM 82-014  
ELEV 233.134

S.E. Cor. Dalhousie Dr. & St. Edmund's Bay, 7th. W. W. Conc. foundation of No. 3 St. Edmund's Bay, 3.0 m S. & 0.3 m below surface of N.W. Cor. of most Wly. wall of house.

DATE: 15/04/28

DESIGNED BY	WRJ	CHECKED BY	RPB
DRAWN BY	DML	APPROVED BY	BWB
HOR. SCALE	1:250	RELEASED FOR CONSTRUCTION	
VERT. SCALE	1:10	DATE	15/04/28

PROFESSIONAL'S SEAL

PROVINCE OF MANITOBA

R.P. BRUCE

REGISTERED PROFESSIONAL ENGINEER

CONSULTANT DRAWING No. W150003 Greyfriars-PP-03.dwg

**THE CITY OF WINNIPEG**  
PUBLIC WORKS DEPARTMENT  
ENGINEERING DIVISION

2015 LOCAL STREET & ALLEY RENEWAL PROGRAM  
**GREYFRIARS ROAD**  
KILLARNEY AV TO DALHOUSIE DR  
REHABILITATION  
HORIZONTAL AND VERTICAL ALIGNMENT  
STA 0+340 TO STA 0+460

CITY DRAWING NUMBER: N/A  
SHEET 20 OF 31  
DRAWING No. 20  
REV B

BID OPPORTUNITY No. 18-2015